

NOTES:

1. PRIOR TO ANY EXCAVATION OR TREE CLEARING THE CLEARING LIMITS SHALL BE CLEARLY MARKED IN THE FIELD, AT WHICH TIME THE DEVELOPMENT REVIEW COORDINATOR SHALL BE CONTACTED FOR INSPECTION. NO EXCAVATION ACTIVITY OF ANY KIND SHALL TAKE PLACE UNTIL THE DEVELOPMENT REVIEW COORDINATOR HAS REVIEWED AND APPROVED THE WORK LIMITS. ADDITIONAL TREE PROTECTION MEASURES CAN BE DISCUSSED AT THE TIME OF THE PRECONSTRUCTION MEETING.
2. DISTURBANCE AND GRADING ASSOCIATED WITH BUILDING AND UTILITY CONSTRUCTION SHALL BE LIMITED TO THE EXTENT POSSIBLE AND SHALL IN NO INSTANCE EXCEED BEYOND THE LIMITS OF WORK. PRESERVE ALL TREES BEYOND LIMIT OF CONSTRUCTION DISTURBANCE.
3. NO CONSTRUCTION EQUIPMENT SHALL BE ALLOWED BEYOND THE LIMIT OF CONSTRUCTION DISTURBANCE SHOWN ON THIS PLAN.
4. TREE PROTECTION FENCING SHALL BE INSTALLED ALONG THE TREE PROTECTION LIMITS. IT MAY BE INSTALLED LINEARLY TO (OR CIRCULARLY) BEYOND THE TREE PROTECTION LIMITS. THE TREE PROTECTION LIMITS SHALL BE PRESERVED. IT SHALL BE INSTALLED AND MAINTAINED THROUGHOUT CONSTRUCTION PERIOD AND REMOVE AFTER FINAL ACCEPTANCE OF WORK. MAINTAIN IN GOOD CONDITION THROUGHOUT CONSTRUCTION PERIOD AND REMOVE AFTER FINAL ACCEPTANCE OF WORK.
5. EXCAVATION, BACKFILLING AND SOIL COMPACTION SHALL NOT OCCUR WITHIN OR BEYOND PROTECTIVE FENCING.
6. CONSTRUCTION ACCESS AND STAGING IS TO BE PROVIDED TO/FROM THE PROPOSED BUILDING AND PARKING AREAS. LEVELING AND TEMPORARY GRADING FOR CONSTRUCTION EQUIPMENT TO ACCESS EXCAVATION FOR FOUNDATIONS AND OTHER WORK ASSOCIATED WITH BUILDING CONSTRUCTION IS TO BE LIMITED TO THESE AREAS. THE CONTRACTOR PERFORMING THIS WORK IS REQUIRED TO USE EQUIPMENT AND METHODS THAT MEET THE REQUIREMENTS OF THE CONSTRUCTION MATERIALS VEHICLES, OR OTHER CONSTRUCTION RELATED ACTIVITIES IS TO OCCUR BEYOND THE LIMIT OF CONSTRUCTION DISTURBANCE OR WITHIN AREAS SURROUNDED BY PROTECTIVE FENCING.
7. EROSION CONTROL MIX FILTER BERM SHALL BE INSTALLED INSTEAD OF SILT FENCE IN WOODED AREAS.

UNION STATION PLAZA



ST. JOHN STREET

VETERANS MEMORIAL BRIDGE

CUMBERLAND COUNTY CORRECTIONAL FACILITY

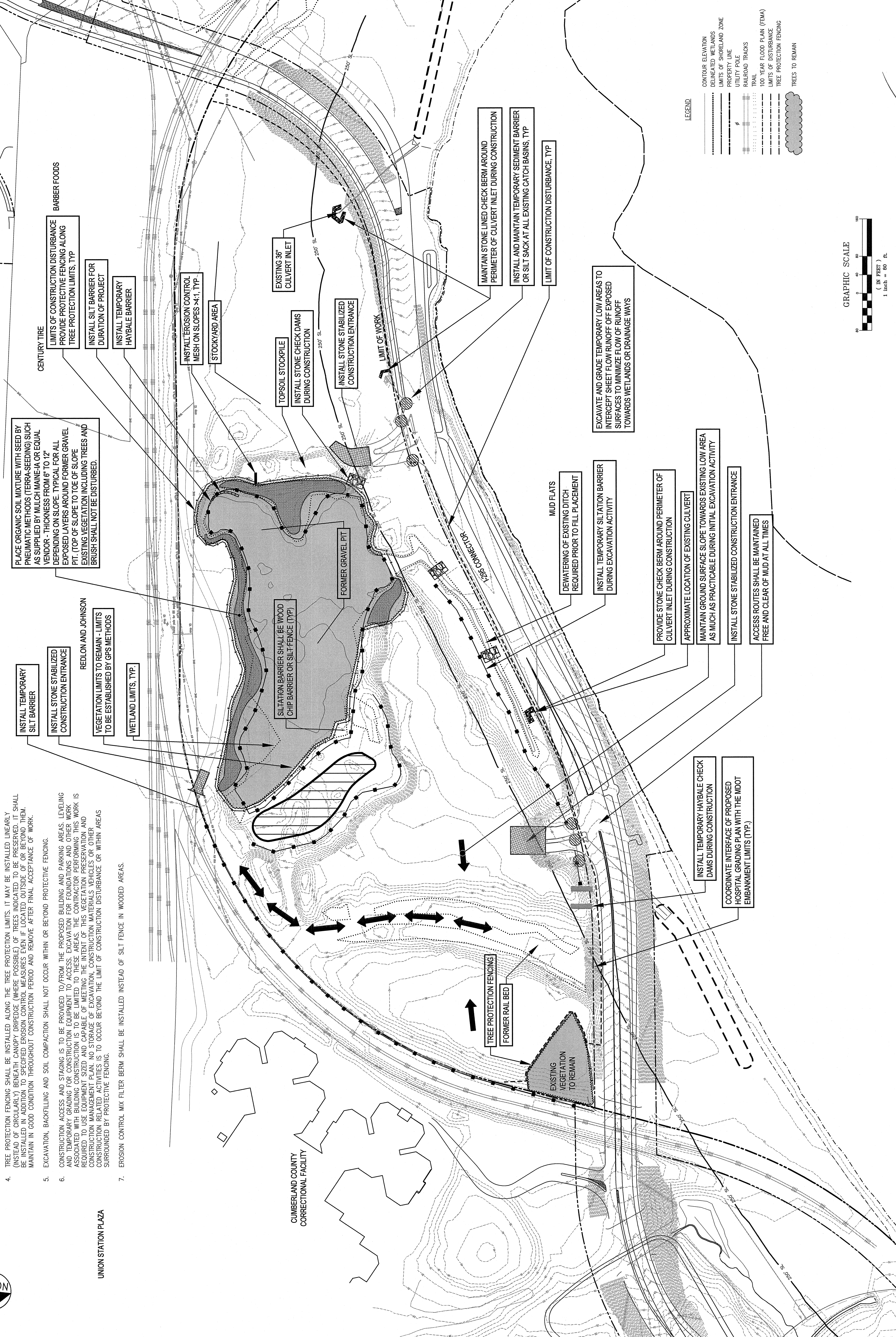

- LEGEND
- CONTOUR ELEVATION
 - - - DELINEATED WETLANDS
 - - - LIMITS OF SHORELAND ZONE
 - - - PROPERTY LINE
 - - - UTILITY POLE
 - - - RAILROAD TRACKS
 - - - TRAIL
 - - - 100 YEAR FLOOD PLAN (FEWA)
 - - - LIMITS OF DISTURBANCE
 - - - TREE PROTECTION FENCING
 - TREES TO REMAIN

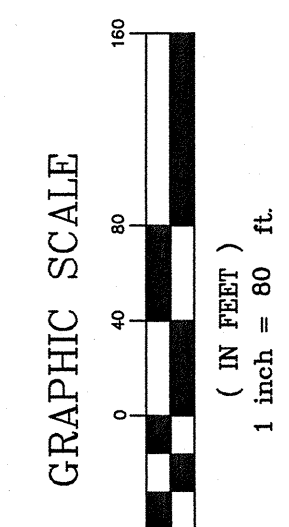

PROJECT		MERCY AT THE FORE	
SHEET TITLE		TREE PROTECTION AND VEGETATION MANAGEMENT PLAN	
CLIENT		MERCY HOSPITAL	
DESIGNED		P.E. STEPHEN R. BUSHEY	
CHECKED		LIC #7429	
DATE		2/14/07	
DRAWN		C-40	
SCALE		1"=100'	
SHEET		2143.01	
DATE		SEPT 2001	
DRAWN		DAULICA-HOFFMAN ASSOCIATES, INC.	
SCALE		1"=100'	
SHEET		2143.01	
DATE		SEPT 2001	

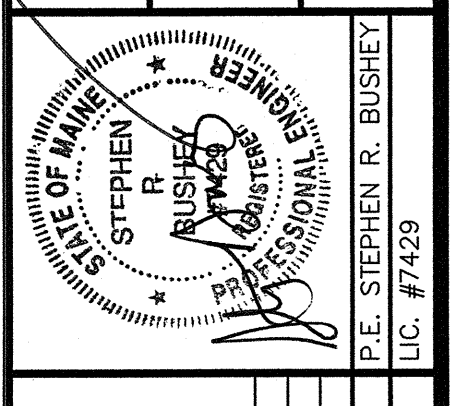

REV.	DATE	DESCRIPTION
1	08.08.06	SUBMITTED TO CITY
2	11.15.06	FINAL - ISSUED FOR CONSTRUCTION
3	11.15.06	FINAL - APPROVAL PLANS SUBMITTED TO CITY OF PORTLAND

REV.	DATE	DESCRIPTION
1	08.08.06	SUBMITTED TO CITY
2	11.15.06	FINAL - ISSUED FOR CONSTRUCTION
3	11.15.06	FINAL - APPROVAL PLANS SUBMITTED TO CITY OF PORTLAND

REV.	DATE	DESCRIPTION
1	08.08.06	SUBMITTED TO CITY
2	11.15.06	FINAL - ISSUED FOR CONSTRUCTION
3	11.15.06	FINAL - APPROVAL PLANS SUBMITTED TO CITY OF PORTLAND

REV.	DATE	DESCRIPTION
1	08.08.06	SUBMITTED TO CITY
2	11.15.06	FINAL - ISSUED FOR CONSTRUCTION
3	11.15.06	FINAL - APPROVAL PLANS SUBMITTED TO CITY OF PORTLAND

REV.	DATE	DESCRIPTION
1	08.08.06	SUBMITTED TO CITY
2	11.15.06	FINAL - ISSUED FOR CONSTRUCTION
3	11.15.06	FINAL - APPROVAL PLANS SUBMITTED TO CITY OF PORTLAND

REV.	DATE	DESCRIPTION
1	08.08.06	SUBMITTED TO CITY
2	11.15.06	FINAL - ISSUED FOR CONSTRUCTION
3	11.15.06	FINAL - APPROVAL PLANS SUBMITTED TO CITY OF PORTLAND

REV.	DATE	DESCRIPTION
1	08.08.06	SUBMITTED TO CITY
2	11.15.06	FINAL - ISSUED FOR CONSTRUCTION
3	11.15.06	FINAL - APPROVAL PLANS SUBMITTED TO CITY OF PORTLAND

REV.	DATE	DESCRIPTION
1	08.08.06	SUBMITTED TO CITY
2	11.15.06	FINAL - ISSUED FOR CONSTRUCTION
3	11.15.06	FINAL - APPROVAL PLANS SUBMITTED TO CITY OF PORTLAND

REV.	DATE	DESCRIPTION
1	08.08.06	SUBMITTED TO CITY
2	11.15.06	FINAL - ISSUED FOR CONSTRUCTION
3	11.15.06	FINAL - APPROVAL PLANS SUBMITTED TO CITY OF PORTLAND

REV.	DATE	DESCRIPTION
1	08.08.06	SUBMITTED TO CITY
2	11.15.06	FINAL - ISSUED FOR CONSTRUCTION
3	11.15.06	FINAL - APPROVAL PLANS SUBMITTED TO CITY OF PORTLAND

REV.	DATE	DESCRIPTION
1	08.08.06	SUBMITTED TO CITY
2	11.15.06	FINAL - ISSUED FOR CONSTRUCTION
3	11.15.06	FINAL - APPROVAL PLANS SUBMITTED TO CITY OF PORTLAND

REV.	DATE	DESCRIPTION
1	08.08.06	SUBMITTED TO CITY
2	11.15.06	FINAL - ISSUED FOR CONSTRUCTION
3	11.15.06	FINAL - APPROVAL PLANS SUBMITTED TO CITY OF PORTLAND

REV.	DATE	DESCRIPTION
1	08.08.06	SUBMITTED TO CITY
2	11.15.06	FINAL - ISSUED FOR CONSTRUCTION
3	11.15.06	FINAL - APPROVAL PLANS SUBMITTED TO CITY OF PORTLAND

REV.	DATE	DESCRIPTION
1	08.08.06	SUBMITTED TO CITY
2	11.15.06	FINAL - ISSUED FOR CONSTRUCTION
3	11.15.06	FINAL - APPROVAL PLANS SUBMITTED TO CITY OF PORTLAND