

NORTH DRIVEWAY

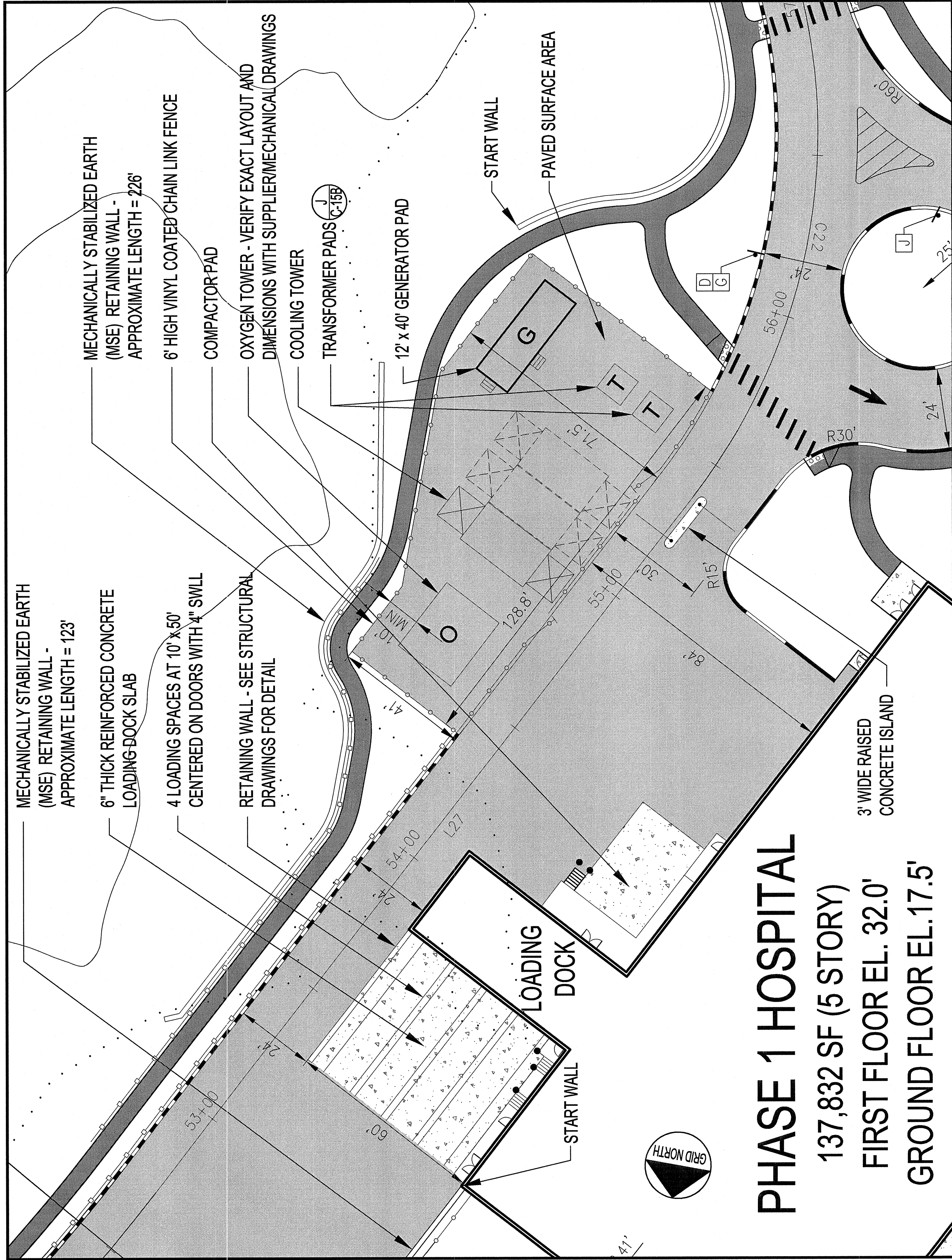

PHASE 1 HOSPITAL
 137,832 SF (5 STORY)
 FIRST FLOOR EL. 32.0'
 GROUND FLOOR EL. 17.5'

SERVICE AREA

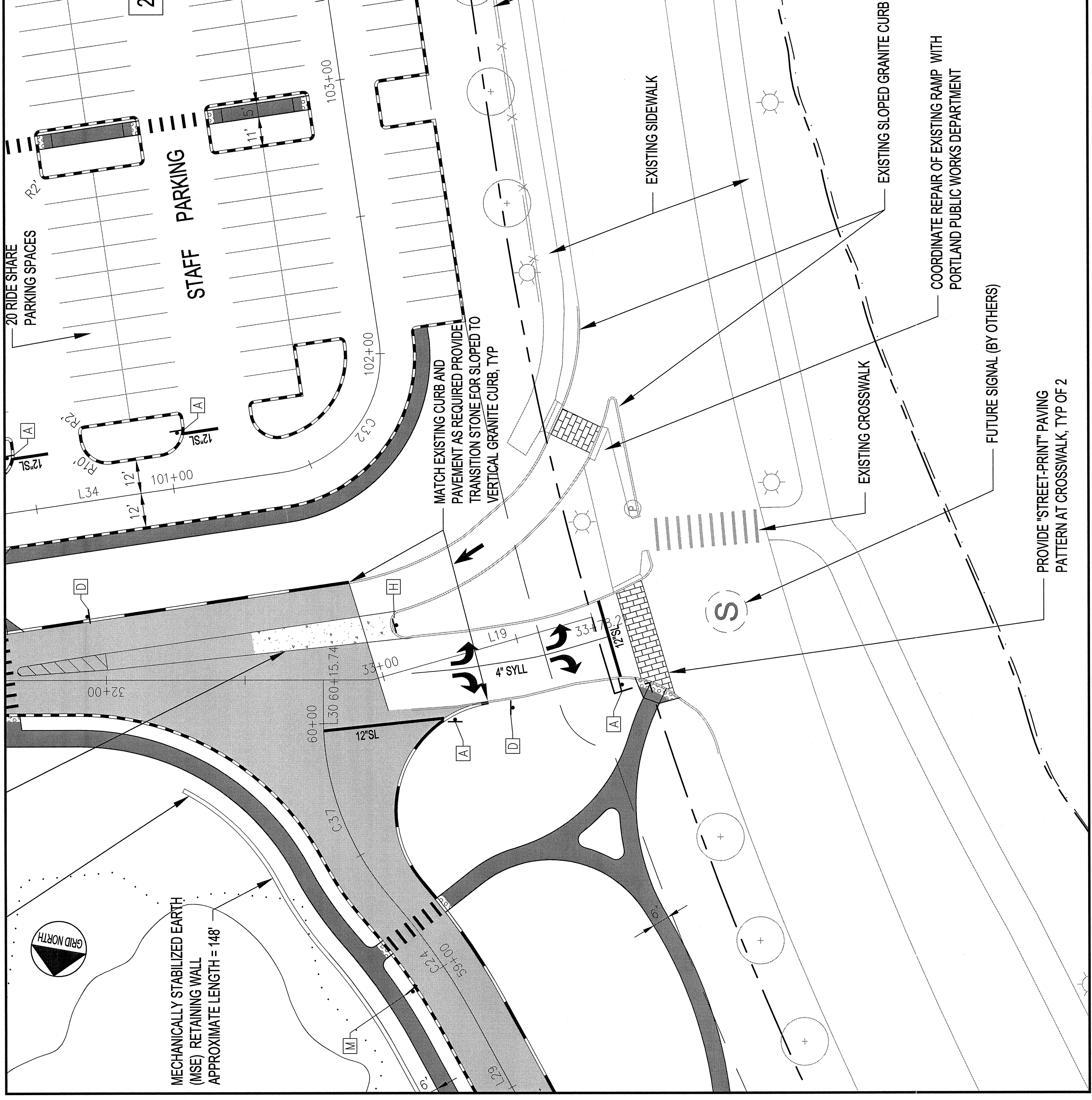

SOUTH DRIVEWAY



PROJECT: MERCY AT THE FORE SHEET TITLE: 20 SCALE SELECT VIEWS CLIENT: MERCY HOSPITAL	
DRAWN: DEE DATE: 11.01.01 DESIGNED: SRB SCALE: 1"=20' CHECKED: SRB DATE: 11.01.01 FILE NAME: 2142.01.WP3	LIC #7429 P.E. STEPHEN R. BUSHEY
2 7.28.08 RELEASED TO CONSTRUCTION MANAGER 1 7.28.08 RESUBMITTED TO CITY OF PORTLAND	REVISIONS