

CONSULTANT
 CIVIL ENGINEER
 Associates, Inc.
 278 Main Street, Suite 806
 Portland, Maine 04102
 Phone: (207) 725-1121
 Fax: (207) 893-0886

CONSULTANT
 MECHANICAL/ELECTRICAL ENGINEER
 BORD, ROY & ARTHURS Consulting Engineers, LLC
 311 Kennel Street
 Portland, ME 04102
 Phone: (207) 772-3846
 Fax: (207) 772-1070

CONSULTANT
 EQUIPMENT PLANNING
 GORDON, BROWN & ASSOCIATES
 144 Fore Street P.O. Box 618
 Portland, ME 04102
 Phone: (207) 772-3846
 Fax: (207) 772-1070

CONSULTANT
 CONSTRUCTION MANAGER
 CONSTRUCTION MANAGER
 7 Jackson Way
 Providence, Rhode Island 02903
 Phone: (401) 458-5516
 Fax: (401) 458-5516

DATE
 10.02.06
 FOR CONSTRUCTION
 DRAWN BY
 MAF/JLV/CLB/CLJ/LMS
 SCALE
 AS NOTED

Francis
 Cauffman

Roley
 Hoffmann

Mercy Health
 System of Maine
 FORE RIVER SHORT
 STAY HOSPITAL

Project Number
 F05-4989
 Drawing Title and Number
 Wall Section Details

A7.18

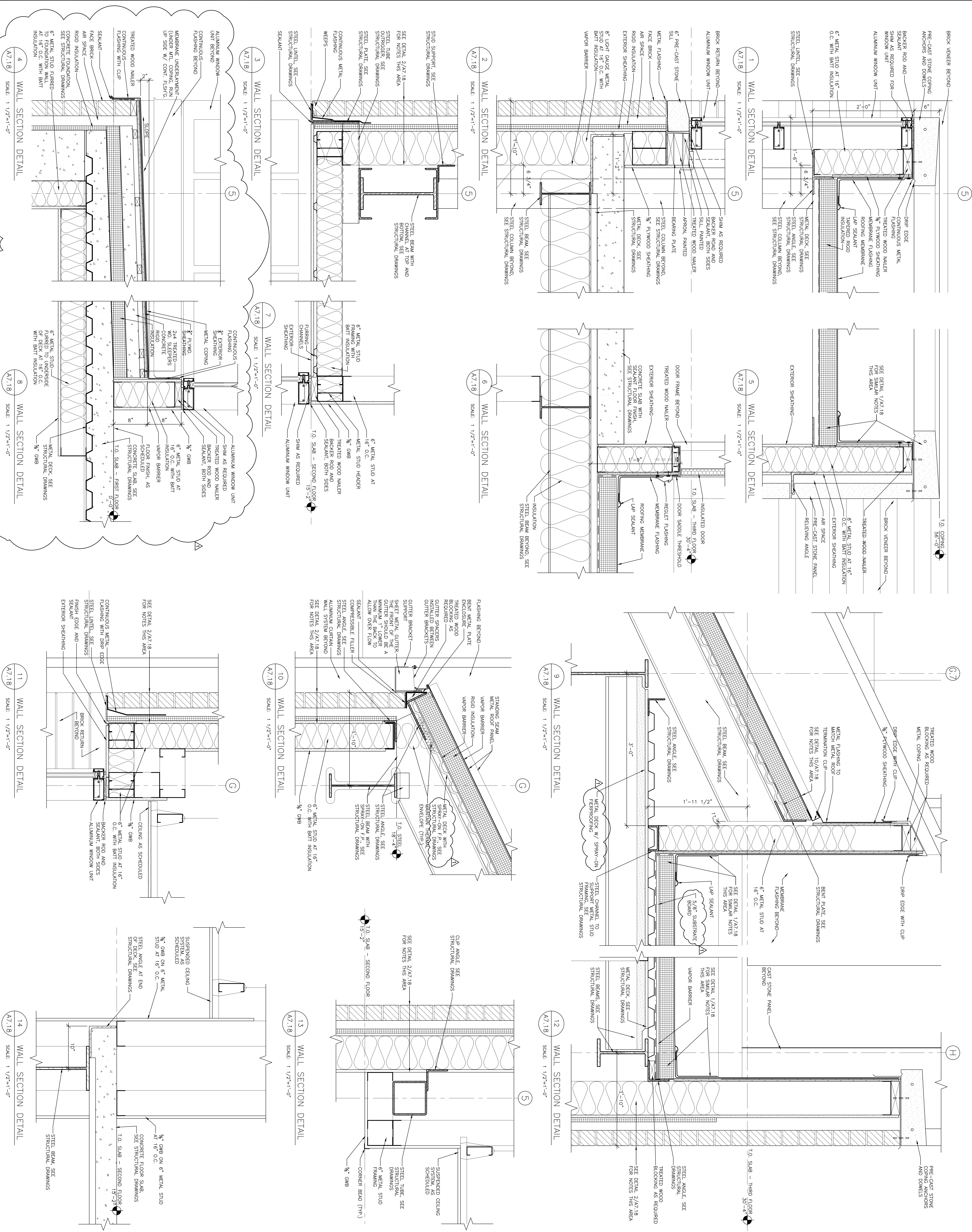

A7.18

A7.18

A7.18

A7.18

A7.18

A7.18

A7.18

A7.18