

**GENERAL CEILING CONSTRUCTION NOTES:**

1. CEILING HEIGHT: 9'-0" A.F.F. UNLESS NOTED OTHERWISE
2. SOFFIT ABOVE WALL CABINETS: 7'-0" A.F.F. UNLESS NOTED OTHERWISE

**CEILING SYMBOL LEGEND**

	RECESSED 4'-0" FIXTURE (A1)		2'x2' RECESSED LIGHT FIXTURE		SPEAKER		GNB CEILING OR SOFFIT
	RECESSED LINEAR WALL WASH (A15A)		2'x2' RECESSED LIGHT FIXTURE		EXHAUST FAN		ACP GRID
	COMPACT FLUORESCENT DOWNLIGHT (A17)		SCONCE LIGHT		2'x2' MECH. SUPPLY REGISTER		
	COMPACT FLUORESCENT WALLWASH (A18)		RECESSED ADJUSTABLE DOWNLIGHT (G8)		2'x2' MECH. RETURN REGISTER		
	COMPACT FLUORESCENT WET LOCATION (A22)		ADJUSTABLE PINHOLE (G9)		ACCESS PANEL		
	DIRECT/INDIRECT FLUORESCENT (AV2X2)		2'-0" RECESSED WALL FIXTURE (O1)		SMOKE DETECTOR		
	CEILING HUNG INDIRECT FLUORESCENT (B150)		X-X' CEILING HEIGHT				

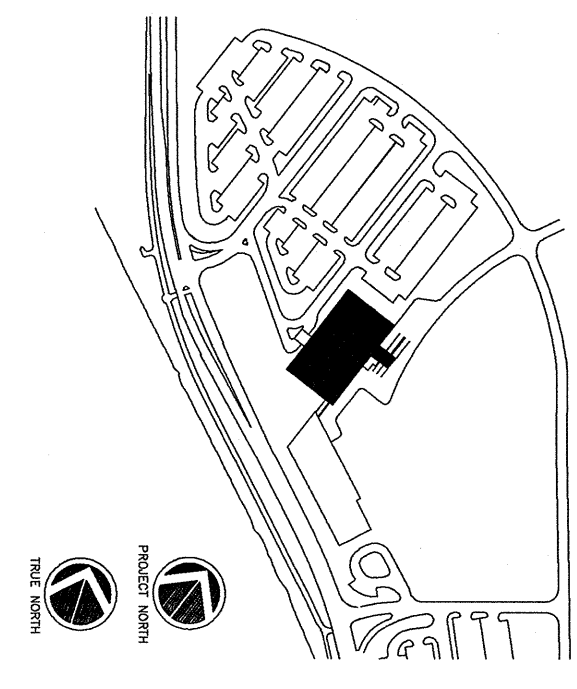
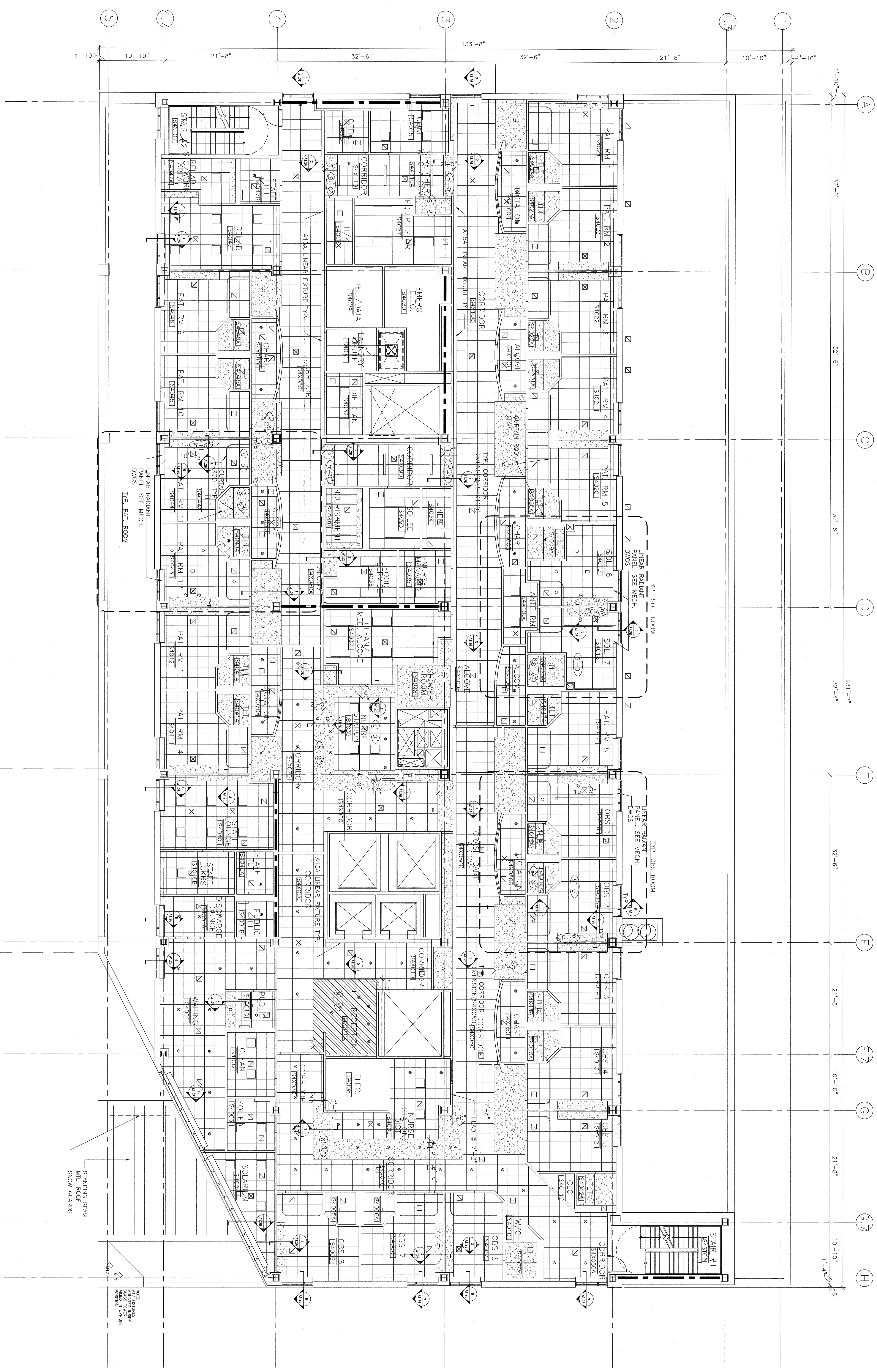

**Consultant**  
 CIVIL ENGINEER  
 Associated, Inc.  
 778 Main Street, Suite 8  
 South Portland, ME 04106  
 Phone: (207) 711-1101  
 Fax: (207) 879-0888

**Consultant**  
 ASSOCIATE ARCHITECT/STRUCTURAL ENGINEER  
 144 Fox Street P.O. Box 618  
 Portland, ME 04101  
 Phone: (207) 772-4846  
 Fax: (207) 772-1070

**Consultant**  
 GENERAL ELECTRICAL ENGINEER  
 Bird, Beal & Associates  
 The Arsenal on the Clarks  
 Waterbury, MA 02272-5789  
 Phone: (508) 752-1101  
 Fax: (517) 224-3329

**Consultant**  
 EQUIPMENT PLANNING  
 Gene Burton & Associates  
 1808 West End Ave. Suite 1400  
 Nashville, TN 37203-5991  
 Phone: (615) 376-3100  
 Fax: (615) 376-3114

**Consultant**  
 CONSTRUCTION MANAGER  
 Gilbane Building Company  
 Providence, Rhode Island 02903  
 Phone: (401) 452-9265  
 Fax: (401) 452-9518

**Consultant**  
 FOOD SERVICE  
 Food Service, Inc., LLC  
 1808 West End Ave. Suite 1400  
 Nashville, TN 37203-5991  
 Phone: (615) 376-3100  
 Fax: (615) 376-3114

**It is the responsibility of the Construction Sub-contractors to verify all dimensions and notes before proceeding with any work.**

Date: 11/10/06  
 Drawn by: Frial-Island For Construction  
 ART/KD  
 Scale:  
 AS NOTED

**Francis**

**Caufman**

**Foley**

**Hoffmann**

**Francis Cauffman**  
 2120 Main Street  
 Portland, ME 04103  
 Architects Ltd.  
 215-568-8250

Mercy Health Core  
 System of Maine  
 FORE RIVER SHORT  
 STAY HOSPITAL

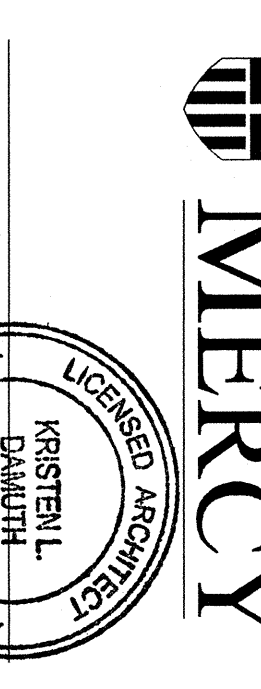

Project Number: FD-4989  
 Drawing Title and Number: Fourth Floor Reflected Ceiling Plan  
 Date: 11/10/06  
 Scale: AS NOTED

**A5.04**