

Consultant  
 CIVIL ENGINEER  
 Smart Engineering Associates, Inc.  
 778 Main Street, Suite 806  
 Franklin, Tennessee 37067  
 Phone: (607) 772-1121  
 Fax: (607) 879-0896

Consultant  
 ARCHITECT/STRUCTURAL ENGINEER  
 SMART ARCHITECT/STRUCTURAL ENGINEER  
 144 Fox Street P.O. Box 618  
 Franklin, Tennessee 37067  
 Phone: (607) 772-3846  
 Fax: (607) 772-1070

Consultant  
 MECHANICAL/ELECTRICAL ENGINEER  
 Bert, Rod & Athans Consulting Engineers, LLC  
 311 Kessel Street  
 Wadsworth, TN 37180  
 Phone: (615) 924-3339  
 Fax: (615) 924-3339

Consultant  
 EQUIPMENT PLANNING  
 Greg Burton & Associates  
 10000 Highway 101  
 Franklin, Tennessee 37067  
 Phone: (615) 321-3114  
 Fax: (615) 321-3114

Consultant  
 CONSTRUCTION MANAGER  
 MAF/MLB/CLB/CLV/LMS  
 7 Jackson Highway  
 Providence, Rhode Island 02903  
 Phone: (401) 458-5516  
 Fax: (401) 458-5516

Consultant  
 FOOD SERVICE  
 FRODO SERVICE, LLC  
 1808 West End Ave, Suite 1400  
 Nashville, Tennessee 37203  
 Phone: (615) 321-5591  
 Fax: (615) 321-5689

It is the responsibility of the Construction Manager/General Contractor and all persons and subcontractors to verify all dimensions and conditions of prior work, by reference to drawings and specifications, before proceeding with any work.

Date: CORE & SHELL ISSUED  
 10.02.06 FOR CONSTRUCTION

Drawn By: MAF/MLB/CLB/CLV/LMS

Scale: AS NOTED

Francis

Caufman

Foley

Hoffmann

Francis Cauffman  
 Foley Hoffmann  
 Architects Ltd.  
 2120 Acin Street  
 Philadelphia, PA 19103  
 215-968-8250

Project Title  
 Mercy Health  
 System of Maine  
 FORE RIVER SHORT  
 STAY HOSPITAL



Project Number  
 F05-4898  
 Drawing Title and Number  
 WALL SECTIONS

A3.06

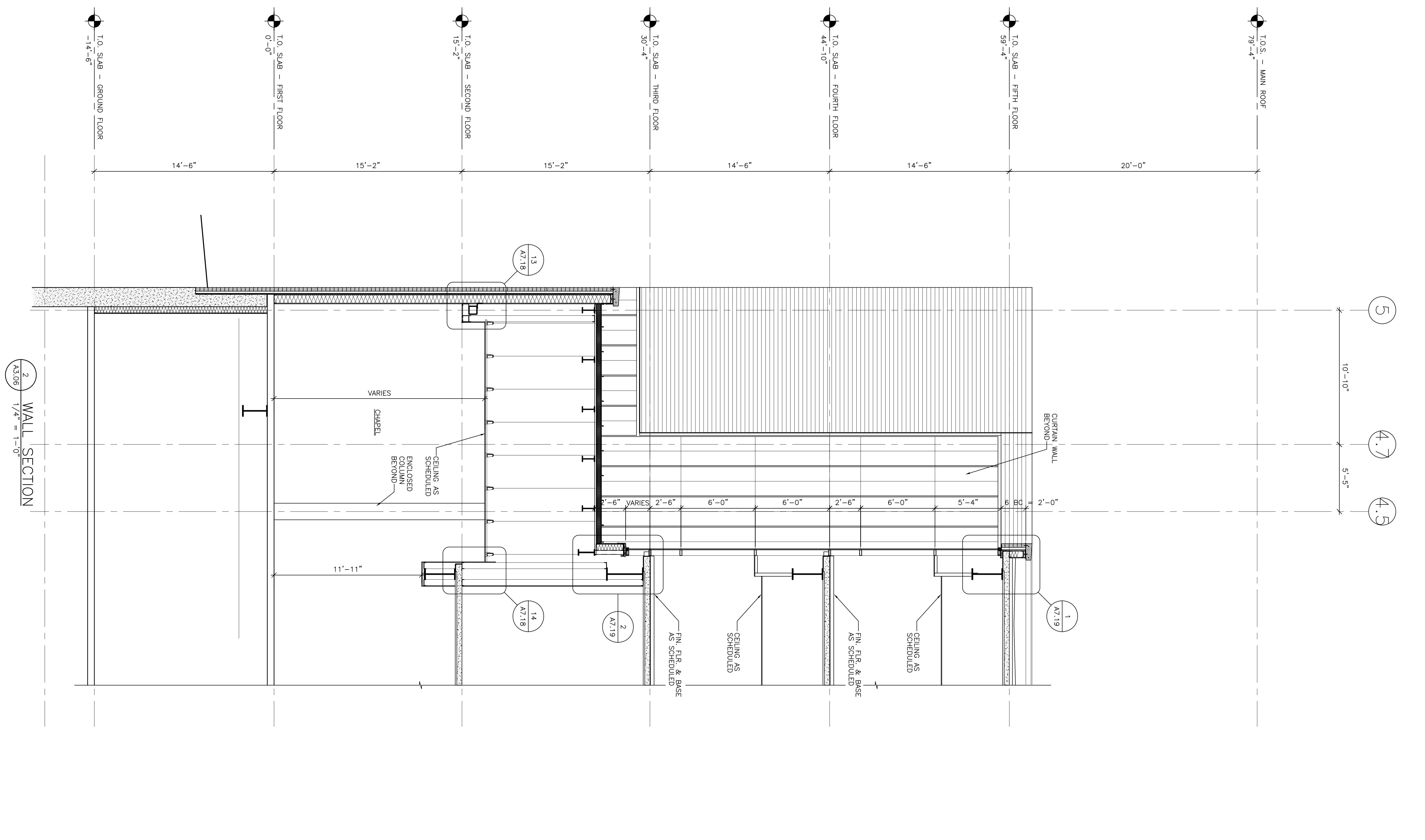
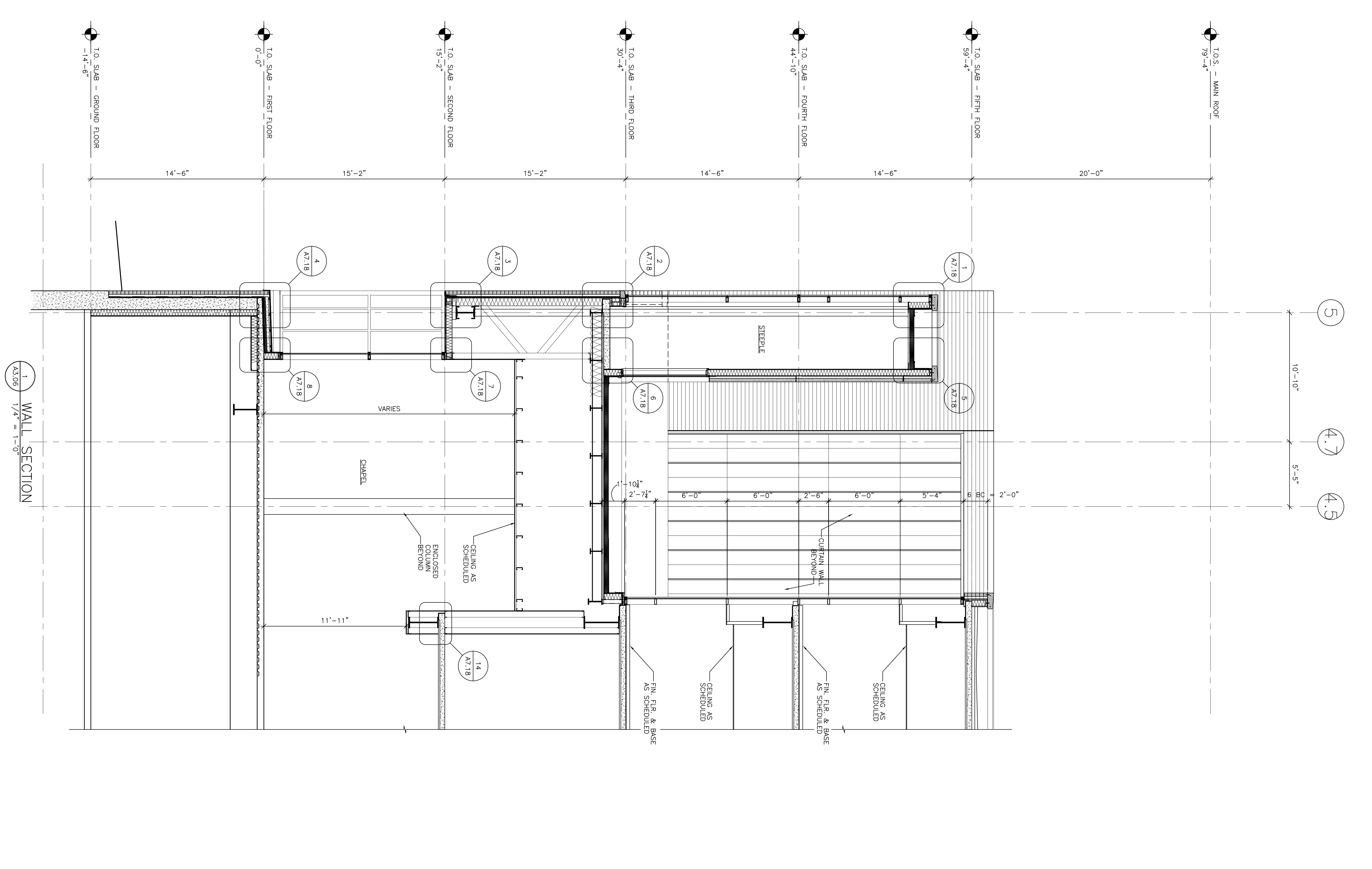

1 WALL SECTION  
 A3.06 1/4" = 1'-0"

2 WALL SECTION  
 A3.06 1/4" = 1'-0"