

- GENERAL NOTES:
1. LOCATION OF PROPOSED CONNECTIONS ARE APPROXIMATE. CONTRACTOR TO CONTACT ENGINEER IF FIELD INFORMATION VARIES FROM INFORMATION ON PLANS.
 2. CONTRACTOR IS TO BE CAUTIONED THAT CERTAIN LOCATIONS AND/OR ELEVATIONS OF EXISTING UTILITIES HAVE BEEN PROVIDED THROUGH UTILITY COORDINATION OR OTHER OBSERVATIONS. INFORMATION IS NOT TO BE RELIED UPON AS EXACT OR COMPLETE. CONTRACTOR TO FIELD VERIFY AND COORDINATE WITH UTILITY COMPANY AND DIG SAFE NO LESS THAN 72 HOURS PRIOR TO ANY EXCAVATION TO REQUEST EXACT FIELD LOCATION OF ALL UTILITIES. IT SHALL BE THE RESPONSIBILITY OF THE CONTRACTOR TO RELOCATE ALL EXISTING UTILITIES WHICH CONFLICT WITH THE PROPOSED IMPROVEMENTS INDICATED IN THE CONTRACT DOCUMENTS. CONTRACTOR TO NOTIFY ENGINEER OF ANY DIFFERENTIATIONS FROM EXISTING CONDITIONS, INCLUDING UTILITY INFORMATION, PRIOR TO ANY CHANGES.
 3. FOR ALL UTILITIES, ACORN ENGINEERING DESIGN LIMITS END AT EXTERIOR WALL OF BUILDING. METERING OF UTILITIES TO BE COMPLETED BY M.E.P. UNLESS SPECIFIED OTHERWISE.
 4. CONTRACTOR TO COORDINATE WITH ARCHITECT ON FINAL UTILITY CONNECTIONS WITHIN THE BUILDING.
 5. SEWER UTILITIES: CONTRACTOR TO COORDINATE WITH ARCHITECT FOR FINAL SERVICE CONNECTION. SEWER UTILITIES TO BE CONSTRUCTED IN ACCORDANCE WITH CITY OF PORTLAND TECHNICAL STANDARDS. VALVE FOR BACKFLOW PREVENTION SHALL BE INSTALLED WITHIN THE PROPERTY LINES FOR EACH CITY SEWER CONNECTION. CONTRACT ENGINEER IF INVERT FIELD CONDITIONS VARY FROM DESIGN.
 6. WATER UTILITIES: FINAL PIPE SIZING PROVIDED BY M.E.P. ENGINEER AND FIRE PROTECTION DESIGNER. INTERNAL METERING, BACKFLOW PREVENTION, AND PRESSURE REDUCERS TO BE COMPLETED BY M.E.P. ENGINEER. DOMESTIC WATER PIPE SIZES WILL DETERMINE THE FINAL WATER METERING OPTIONS. METER MAY BE SMALLER THAN PROPOSED WATER MAIN. WATER METERING, PRESSURE REDUCER AND BACKFLOW PREVENTION TO BE IN ACCORDANCE WITH THE PORTLAND WATER DISTRICT STANDARDS. CONTRACTOR TO FOLLOW METERING GUIDELINES OF THE PORTLAND WATER DISTRICT AND CITY OF PORTLAND.
 7. GAS UTILITIES: PROJECT GAS LOAD, GAS UTILITY DESIGN, AND FINAL GAS SERVICE LOCATION AND METERS TO BE DEFINED BY M.E.P. AND IN ACCORDANCE WITH UNIFIL.
 8. ELECTRIC UTILITIES: ELECTRIC DESIGN TO BE FINALIZED BY M.E.P. ENGINEER. ELECTRICAL LOAD TO BE DETERMINED BY M.E.P. ENGINEER. METER LOCATION AND TRANSFORMER SIZE, IF NECESSARY DEFINED BY M.E.P. ENGINEER. TO FINALIZE SERVICE CONNECTION TO BUILDING. ALL ELECTRIC CONSTRUCTION SHALL CONFORM TO CMP GUIDEBOOK OF STANDARD REQUIREMENTS, MOST RECENT EDITION. DESIGN SUBJECT TO FINAL APPROVAL FROM CMP.
 9. CABLE AND TELEPHONE PULLBOXES AND PEDESTAL LOCATIONS TO BE DETERMINED BY CHARTER COMMUNICATIONS AND FAIRPOINT PRIOR TO CONSTRUCTION. CONTRACTOR TO COORDINATE INSTALLATION OF UNDERGROUND UTILITIES WITH ALL UTILITY COMPANIES INVOLVED.

MINIMUM HORIZONTAL UTILITY SEPARATION						
UTILITY	UGE/T/C	WATER	SEWER	GAS	STORMWATER	
UGE/T/C	-	6'	5'	4'	6'	
WATER	6'	-	5'	6'	3'	
SEWER	5'	5'	-	5'	10'	
GAS	4'	6'	5'	-	3'	
STORMWATER	6'	3'	10'	3'	-	

EX. SEWER STRUCTURE SCHEDULE			
STRUCTURE	RIM	INVERT IN	INVERT OUT
SMH #1	15.47'		10.52'
SMH #2	26.96'		8.11'
SMH #3	26.94'		7.69' (CL)
SMH #4	17.32'	7.72' (42" RCP) 9.32' (8" PVC)	7.62'

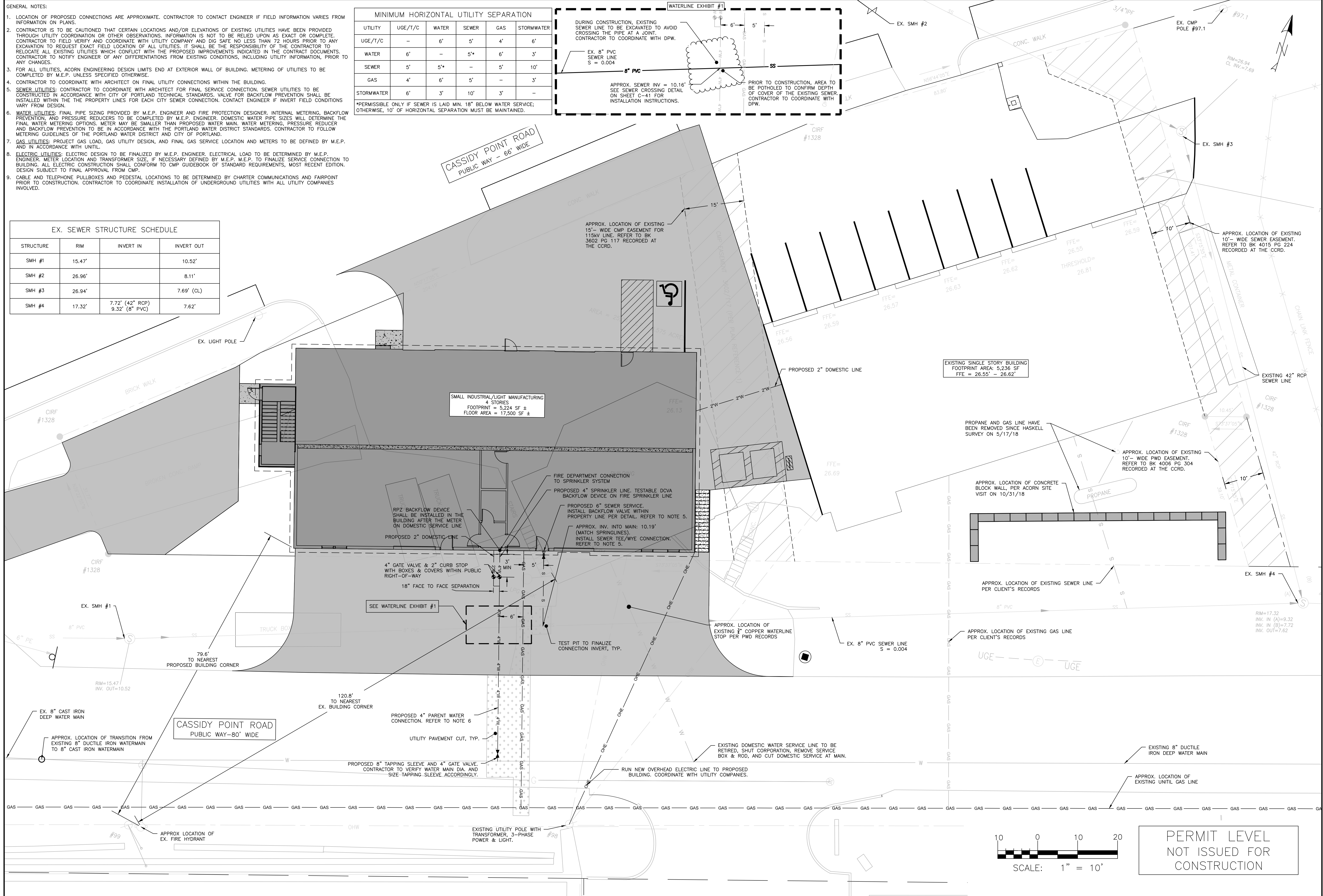

ISSUED FOR	BY	DATE
PRELIMINARY PLAN	FRT	11/15/18
PWD ABILITY TO SERVE	FRT	11/29/18
PWD ABILITY TO SERVE	FRT	12/3/18
LEVEL II SITE PLAN	WHS	12/14/18
LEVEL II SITE PLAN	WHS	1/2/19

UTILITY PLAN
CASSIDY POINT REDEVELOPMENT
 PROJECT NAME:
 PROJECT MANAGEMENT, INC.
 CLIENT:
 225 COMMERCIAL STREET, SUITE 502 PORTLAND, ME 04101

ACORN ENGINEERING, INC.
 ENGINEERING, INC.
 158 DANFORTH ST., PORTLAND, MAINE 04102
 (207) 775-2855

THIS PLAN SHALL NOT BE MAINTAINED WITHOUT WRITTEN PERMISSION FROM ACORN ENGINEERING, INC. ANY ALTERATIONS, AUTHORIZED OR UNAUTHORIZED, SHALL BE AT THE USER'S SOLE RISK AND WITHOUT LIABILITY TO ACORN ENGINEERING, INC.

FILE: 1113_CIVIL
 JN: 1113
 SCALE: AS NOTED
 DESIGNED BY: FRT
 DRAWN BY: FRT
 CHECKED BY: WHS

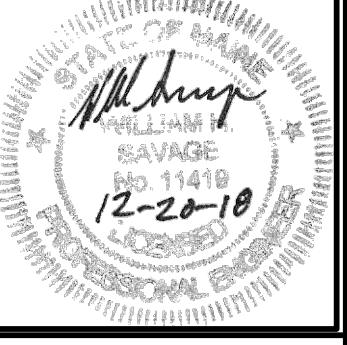

DRAWING NO.
C-20

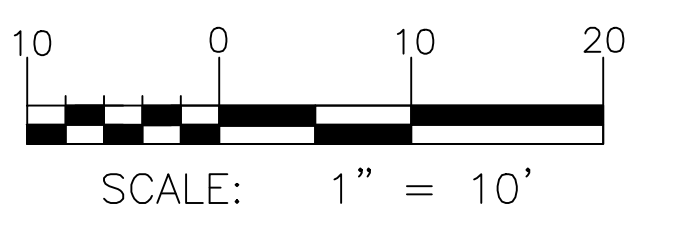

PERMIT LEVEL
 NOT ISSUED FOR
 CONSTRUCTION