

City of Portland, Maine - Building or Use Permit Application

389 Congress Street, 04101 Tel: (207) 874-8703, Fax: (207) 874-8716

Permit No: 04-1580	Issue Date: 10/19/04	CBL: 072 A004001
-----------------------	-------------------------	---------------------

Location of Construction: 366 West Commercial St	Owner Name: Eleven Cousins Limited	Owner Address: 200 Middlesex Turnpike	Phone:
Business Name:	Contractor Name: Cianbro Corp.	Contractor Address: 328 W. Commercial Street Portland	Phone: 2077735852
Lessee/Buyer's Name	Phone:	Permit Type: Signs - Permanent	Zone: LUPDZ

Past Use: Commercial	Proposed Use: Commercial / install 1.6' x 6' sign and one 1x4 sign	Permit Fee: \$62.00	Cost of Work: \$62.00	CEO District: 2
Proposed Project Description: install 1.6' x 6' sign and one 1x4 sign		FIRE DEPT: <i>NA</i>	INSPECTION: Use Group: <i>Sign</i> Type: <i>TBC 2003</i>	
		Signature:	Signature:	

PEDESTRIAN ACTIVITIES DISTRICT (P.A.D.)	
Action: <input type="checkbox"/> Approved <input type="checkbox"/> Approved w/Conditions <input checked="" type="checkbox"/> Denied	Signature: _____ Date: _____

Permit Taken By: Idobson	Date Applied For: 10/20/2004	Zoning Approval
-----------------------------	---------------------------------	------------------------

- This permit application does not preclude the Applicant(s) from meeting applicable State and Federal Rules.
- Building permits do not include plumbing, septic or electrical work.
- Building permits are void if work is not started within six (6) months of the date of issuance. False information may invalidate a building permit and stop all work..

Special Zone or Reviews <input type="checkbox"/> Shoreland <input checked="" type="checkbox"/> Wetland <i>should NOT block traffic views when exiting</i> <input type="checkbox"/> Flood Zone <input type="checkbox"/> Subdivision <input type="checkbox"/> Site Plan Maj <input type="checkbox"/> Minor <input type="checkbox"/> MM <input type="checkbox"/> Date: <i>OK 11/19/04</i>	Zoning Appeal <input type="checkbox"/> Variance <input type="checkbox"/> Miscellaneous <input type="checkbox"/> Conditional Use <input type="checkbox"/> Interpretation <input type="checkbox"/> Approved <input type="checkbox"/> Denied Date: _____	Historic Preservation <input checked="" type="checkbox"/> Not in District or Landmark <input type="checkbox"/> Does Not Require Review <input type="checkbox"/> Requires Review <input type="checkbox"/> Approved <input type="checkbox"/> Approved w/Conditions <input type="checkbox"/> Denied Date: <i>[Signature]</i>
--	---	---

CERTIFICATION

I hereby certify that I am the owner of record of the named property, or that the proposed work is authorized by the owner of record and that I have been authorized by the owner to make this application as his authorized agent and I agree to conform to all applicable laws of this jurisdiction. In addition, if a permit for work described in the application is issued, I certify that the code official's authorized representative shall have the authority to enter all areas covered by such permit at any reasonable hour to enforce the provision of the code(s) applicable to such permit.

SIGNATURE OF APPLICANT	ADDRESS	DATE	PHONE
RESPONSIBLE PERSON IN CHARGE OF WORK, TITLE		DATE	PHONE

Signage/Awning Permit Application

If you or the property owner owes real estate or personal property taxes or user charges on any property within the City, payment arrangements must be made before permits of any kind are accepted.

Location/Address of Construction: <u>366 WEST COMMERCIAL ST</u>		
Total Square Footage of Proposed Structure <u>13 s.f.</u>	Square Footage of Lot <u>55,500 s.f.</u>	
Tax Assessor's Chart, Block & Lot Chart# <u>22</u> Block# <u>A</u> Lot# <u>4</u>	Owner: <u>CIAMBRO CORPORATION</u>	Telephone: <u>416 8350</u>
Lessee/Buyer's Name (If Applicable)	Applicant name, address & telephone: <u>ED JONES</u> <u>CIAMBRO CORP.</u> <u>366 WEST COMMERCIAL ST</u> <u>PORTLAND, ME 04102</u>	Total s.f. of signage x \$2.00 per s.f. plus \$30.00/\$65.00 for H.D. signage = Total Fee: \$ <u>108 s.f. x 2 = 216 + 30 = 246</u> Awning Fee = Cost Of Work: \$ _____ Total Fee: \$ <u>246</u>
Current use: <u>OFFICE</u> <u>WAREHOUSE</u>		
If the location is currently vacant, what was prior use: _____		
Approximately how long has it been vacant: _____		
Proposed use: <u>1.6 x 6.00 Sign</u>		DEPT. OF BUILDING INSPECTION CITY OF PORTLAND, ME OCT 19 2004 RECEIVED
Project description: <u>6' x 12' Sign / 1 x 4 Sign</u>		
Contractor's name, address & telephone: <u>CIAMBRO CORPORATION</u>		
Whom should we contact when the permit is ready: <u>ED JONES (416-8350)</u>		
Mailing address: <u>366 WEST COMMERCIAL ST</u> <u>PORTLAND, ME 04102</u>		
We will contact you by phone when the permit is ready. You must come in and pick up the permit and review the requirements before starting any work, with a Plan Reviewer. A STOP WORK ORDER will be issued and a \$100.00 fee if any work starts before the permit is picked up. PHONE: <u>416-8350</u>		

IF THE REQUIRED INFORMATION IS NOT INCLUDED IN THE SUBMISSIONS THE PERMIT WILL BE AUTOMATICALLY DENIED AT THE DISCRETION OF THE BUILDING/PLANNING DEPARTMENT. WE MAY REQUIRE ADDITIONAL INFORMATION IN ORDER TO APPROVE THIS PERMIT.

I hereby certify that I am the Owner of record of the named property, or that the owner of record authorizes the proposed work and that I have been authorized by the owner to make this application as his/her authorized agent. I agree to conform to all applicable laws of this jurisdiction. In addition, if a permit for work described in this application is issued, I certify that the Code Official's authorized representative shall have the authority to enter all areas covered by this permit at any reasonable hour to enforce the provisions of the codes applicable to this permit.

Signature of applicant: [Signature] Date: 10/13/04

This is NOT a permit, you may not commence ANY work until the permit is issued.

Table 2.12 *IL, ILb, Im, Ima, Imb, IA, IAb* 2/5/97
Industrial ~~I-1, I-2, I-2b, I-3, I-3b, I-4~~ and Waterfront Port Development Zones

Freestanding Signs

	Single Tenant Buildings	Multi-Tenant Buildings
Maximum Permitted Area	35 sq. ft.	70 sq. ft.
Height	10 ft.	15 ft.
Setback	5 ft.	5 ft.
# Freestanding signs per lot	1 (a)	1 (a)

(a) If lot fronts on more than one street, one freestanding sign of equivalent permitted sign area is allowed for each additional frontage, provided such signs are not readily concurrently visible.

Building Signs

Attached to Bldgs

	Single Tenant Buildings	Multi-Tenant Buildings	
Maximum permitted sign area	na	na	
Max % of wall area on which sign(s) is(are) to be placed	6%	Principal Facade(s) 8%	All Other Facade(s) 2%
# bldg. signs permitted per lot	2/building face	1/tenant plus 1 additional per building face (a)	

ACORD. CERTIFICATE OF LIABILITY INSURANCE

DATE (MM/DD/YYYY)
10/13/04

PRODUCER The Dunlap Corporation, an HRH Company 31 Court Street - P.O. Box 40 Auburn, ME 04212-0040		THIS CERTIFICATE IS ISSUED AS A MATTER OF INFORMATION ONLY AND CONFERS NO RIGHTS UPON THE CERTIFICATE HOLDER. THIS CERTIFICATE DOES NOT AMEND, EXTEND OR ALTER THE COVERAGE AFFORDED BY THE POLICIES BELOW.	
INSURED Cianbro Corporation Hunnewell Square - P.O. Box 1000 Pittsfield, ME 04967		INSURERS AFFORDING COVERAGE INSURER A: St. Paul Fire & Marine INSURER B: ME Approved Self-Ins. INSURER C: INSURER D: INSURER E:	NAIC # 24767

COVERAGES

THE POLICIES OF INSURANCE LISTED BELOW HAVE BEEN ISSUED TO THE INSURED NAMED ABOVE FOR THE POLICY PERIOD INDICATED. NOTWITHSTANDING ANY REQUIREMENT, TERM OR CONDITION OF ANY CONTRACT OR OTHER DOCUMENT WITH RESPECT TO WHICH THIS CERTIFICATE MAY BE ISSUED OR MAY PERTAIN, THE INSURANCE AFFORDED BY THE POLICIES DESCRIBED HEREIN IS SUBJECT TO ALL THE TERMS, EXCLUSIONS AND CONDITIONS OF SUCH POLICIES. AGGREGATE LIMITS SHOWN MAY HAVE BEEN REDUCED BY PAID CLAIMS.

INSR ADD'L TR	INSR	TYPE OF INSURANCE	POLICY NUMBER	POLICY EFFECTIVE DATE (MM/DD/YYYY)	POLICY EXPIRATION DATE (MM/DD/YYYY)	LIMITS
A		GENERAL LIABILITY <input checked="" type="checkbox"/> COMMERCIAL GENERAL LIABILITY (CLAIMS MADE) <input checked="" type="checkbox"/> OCCUR GEN'L AGGREGATE LIMIT APPLIES PER: <input type="checkbox"/> POLICY <input type="checkbox"/> PROJE <input type="checkbox"/> LOC	KK02900325	01/01/04	01/01/05	EACH OCCURRENCE \$1,000,000 DAMAGE TO RENTED PREMISES (EA OCCUR) \$100,000 MED EXP (Any one person) \$10,000 PERSONAL & ADV INJURY \$1,000,000 GENERAL AGGREGATE \$2,000,000 PRODUCTS - COM/POP AGG \$2,000,000
A		AUTOMOBILE LIABILITY <input checked="" type="checkbox"/> ANY AUTO ALL OWNED AUTOS SCHEDULED AUTOS <input checked="" type="checkbox"/> HIRED AUTOS <input checked="" type="checkbox"/> NON-OWNED AUTOS GARAGE LIABILITY ANY AUTO	KA02900046	01/01/04	01/01/05	COMBINED SINGLE LIMIT (Ea accident) \$1,000,000 BODILY INJURY (Per person) \$ BODILY INJURY (Per accident) \$ PROPERTY DAMAGE (Per accident) \$ AUTO ONLY - EA ACCIDENT \$ OTHER THAN AUTO ONLY: EA ACC \$ AGG \$
A		EXCESS/UMBRELLA LIABILITY <input checked="" type="checkbox"/> OCCUR <input type="checkbox"/> CLAIMS MADE IN EXCESS OF \$	KG02901369	01/01/04	01/01/05	EACH OCCURRENCE \$2,000,000 AGGREGATE \$2,000,000 \$ \$
A		WORKERS COMPENSATION AND EMPLOYERS' LIABILITY ANY PROPRIETOR/PARTNER/EXECUTIVE OFFICER/OWNER IS EXCLUDED? If yes, describe such SPECIAL PROVISIONS below OTHER	WVK2900919 --Excess W.C.	01/01/04 01/01/04	01/01/05 01/01/05	<input checked="" type="checkbox"/> WC STATUTORY LIMITS <input type="checkbox"/> OTHER EL EACH ACCIDENT \$1,000,000 EL DISEASE - EA EMPLOYER \$1,000,000 EL DISEASE - POLICY LIMIT \$1,000,000

DESCRIPTION OF OPERATIONS / LOCATIONS / VEHICLES / EXCLUSIONS ADDED BY ENDORSEMENT / SPECIAL PROVISIONS
 Erection of a sign on Cianbro Corporation's property and a portion of the sign is on the public right of way. City of Portland is an Additional Insured in regard to General Liability.

DEPT. OF BUILDINGS
 CITY OF PORTLAND
 OCT 19 2004

CERTIFICATE HOLDER City of Portland 380 Congress Street Portland, ME 04101	CANCELLATION SHOULD ANY OF THE ABOVE DESCRIBED POLICIES BE CANCELLED BEFORE THE EXPIRATION DATE THEREOF, THE ISSUING INSURER WILL ENDEAVOR TO MAIL 30 DAYS WRITTEN NOTICE TO THE CERTIFICATE HOLDER NAMED TO THE LEFT, BUT FAILURE TO DO SO SHALL IMPOSE NO OBLIGATION OR LIABILITY OF ANY KIND UPON THE INSURER, ITS AGENTS OR REPRESENTATIVES. AUTHORIZED REPRESENTATIVE <i>David J. Kelly</i>
--	--

IMPORTANT

If the certificate holder is an ADDITIONAL INSURED, the policy(ies) must be endorsed. A statement on this certificate does not confer rights to the certificate holder in lieu of such endorsement(s).

If SUBROGATION IS WAIVED, subject to the terms and conditions of the policy, certain policies may require an endorsement. A statement on this certificate does not confer rights to the certificate holder in lieu of such endorsement(s).

DISCLAIMER

The Certificate of Insurance on the reverse side of this form does not constitute a contract between the issuing insurer(s), authorized representative or producer, and the certificate holder, nor does it affirmatively or negatively amend, extend or alter the coverage afforded by the policies listed thereon.

DEPT. OF BUILDING INSPECTIO.
CITY OF PORTLAND, ME

OCT 19 2004

SIGNAGE/AWNING PRE-APPLICATION QUESTIONNAIRE

PLEASE COMPLETE ALL INFORMATION

ADDRESS: 366 WEST COMMERCIAL ST ZONE: WPDZ

CBL: _____

SINGLE TENANT LOT? YES NO _____ MULTI TENANT LOT? YES _____ NO _____

MORE THAN ONE SIGN TOTAL WITH PROPOSED SIGN? YES _____ NO

TENANT/ALLOCATED BUILDING SPACE FRONTAGE (FEET):

Length: 180' Height: 20'

INFORMATION ON PROPOSED SIGN(S):

FREESTANDING (e.g., pole) SIGN? YES NO _____ DIMENSIONS PROPOSED: SEE ATTACHED SKETCH

BLDG. WALL SIGN? (attached to bldg) YES _____ NO _____ DIMENSIONS PROPOSED: 1'-6" x 6'-0" 12SF

1'-0" x 4'-0" 4SF

INFORMATION ON ALREADY EXISTING AND PERMITTED SIGN(S): NA

FREESTANDING (e.g., pole) SIGN? YES _____ NO _____ DIMENSIONS: _____

BLDG. WALL SIGN(attached to bldg)? YES _____ NO _____ DIMENSIONS: _____

AWNING? YES _____ NO _____ DIMENSIONS: _____

LOT FRONTAGE (FEET): 242'

AWNING YES _____ NO IS AWNING BACKLIT? YES _____ NO

HEIGHT OF AWNING: _____ LENGTH OF AWNING: _____ DEPTH: _____

IS THERE ANY COMMUNICATION, MESSAGE, TRADEMARK OR SYMBOL ON IT? YES _____ NO _____

IF YES, TOTAL S.F. OF PANELS WITH COMMUNICATIONS/MESSAGE/TRADEMARK/SYMBOL? _____ s.f.

A SITE SKETCH AND BUILDING SKETCH SHOWING EXACTLY WHERE EXISTING AND NEW SIGNAGE IS LOCATED MUST BE PROVIDED. SKETCHES AND/OR PICTURES OF PROPOSED SIGNAGE ARE ALSO REQUIRED.

SIGNATURE OF APPLICANT: [Signature] DATE: 10/13/04

DEPT. OF BUILDING
CITY OF FORT LAUDERDALE

OCT 19 2004

*****FOR OFFICE USE ONLY*****

single tenant Bldg
MAX AREA: 35 # — 13# shown
MAX height: 10' — 8' shown
min setback: 5' — 8' shown

1.5 x 6 = 9
1 x 4 = 4

13#

[Signature]

CHECKLIST FOR SIGN/AWNING APPLICATION

Applicants for a sign or awning permit are required to submit the following information to the Code Enforcement Office at the time of application:

- _____ Certificate of Liability listing the City as additional insured if any portion of the sign abuts or encroaches on any public right of way, or can fall into any public right of way. Amount must equal \$400,000.00.
- _____ Letter of permission from the owner indicating the permissions granted and the tenant/space building frontage.
- ✓ _____ A sketch plan of lot, indicating location of buildings, driveways, and any abutting streets or rights of way, lengths of building frontages, street frontages, and all existing setbacks. Indicate on the plan all existing and proposed signs with their dimensions and specific locations. Be sure to include distance from the ground and building facade dimensions for any signage attached to a building.
- ✓ _____ A sketch or photo of any proposed sign(s) indicating *content, dimensions, materials, source of illumination, and construction method, as well as specifics of installation/attachment.*
- 4/8 _____ Certificate of Flammability required for awning or canopy at time of application.
- _____ UL# required for lighted signs at the time of Final Inspection. Failure to provide this information will invalidate the Sign Permit.
- ✓ _____ Pre-Application Questionnaire completed and attached. Photos of existing signage attached.

**Permit Fee for signage or awning-with-signage:
\$30.00 plus \$2.00 per square foot of sign.**

**Permit Fee for awning-without-signage is based on cost of work:
\$30.00 for the first \$1,000.00, plus \$9.00 for each additional \$1,000.00.**

Base Application Fee for any Historic District signage is \$65.00 instead of \$30.00

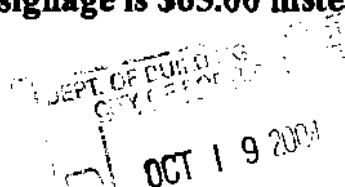

Sidewalk Signs

Design, Location, and Construction Standards

Quantity

One sign per establishment for each street frontage having a public entrance, provided that all dimension and location standards are met. When standards would not otherwise permit a sign, a sign may consist of multiple listings.

Sign Dimensions

Single Listing: Maximum width is 24 inches or such lesser width sufficient to retain 4 ½ feet of unobstructed sidewalk width perpendicular to major flows. Maximum height is 40 inches to top of sign in place. Minimum height is 30 inches to top of sign in place.

Multiple: Maximum width is 30 inches or such lesser width sufficient to retain 4 ½ feet of unobstructed sidewalk width perpendicular to major flows. Maximum height is 40 inches to top of sign in place. Minimum height is 30 inches to top of sign in place.

Location

Minimum distance between signs is 20 feet. Maximum distance of sign from public entrance of advertiser is 20 feet. The City may vary these distances for exceptional physical circumstances where public safety and streetscape aesthetics will be maintained. However, under no circumstances shall signs obstruct vehicular stops, benches, fire hydrants, or other street visual amenities. Signs shall be located near the curb rather than the building face.

Materials and Graphics

All signs shall be of an A-Frame type design, shall be constructed of durable, weather-resistant materials and finish, shall have no moving parts, and shall be non-electrified. All signs shall be maintained in a clean and original appearance. Sign materials, graphics, and finish shall be of a unified design and shall be compatible with the local streetscape. All signs shall have horizontal braces spanning each side of the sign to assure rigid support. Lettering shall be legible and consistent.

Sign Removal

All signs shall be removed when the business is closed or while any snow or ice exists on the walk within eight feet of the sign in any direction.

Insurance

No permit shall be issued unless the applicant has posted in advance with the City a Certificate of Liability listing the City as additional insured in the amount of \$400,000.00.

Enforcement

A sign may be removed after notice to the owner and the permit, if issued, may be revoked if the sign does not conform to the standards herein.

For a sidewalk sign permit, come to City Hall, 389 Congress Street, Room 315, with:

- _____ Certificate of Liability Insurance
- _____ Drawing of sign showing dimensions and design work
- _____ Payment of \$30.00 plus \$2.00 per s.f. of signage.
- _____ Complete application with pre-application questionnaire and checklist completed.

DEPT. OF PUBLIC WORKS
CITY OF BOSTON
OCT 19 2001

306 West Commercial St.
Portland, Maine 04102
TEL 207-416-8350, FAX 207-773-7617

**Pine Tree Council , B.S.A.
Cianbro Corporation - Agent**

Alton E. "Chuck" Cianchette Scout Service Center

Fax

To:	Tammy Munson	From:	Ed Jones
Fax:	874-8716	Pages:	1
Phone:		Date:	12/2/04
Re:	UL Listing on sign	CC:	

Urgent For Review Please Comment Please Reply Please Recycle

● **Comments:**

Tammy,

I talked with Mark Dube of Dube Signs. He fabricated the metal sign. He gave me his UL file # E-192360. There is also a UL sticker on the sign which is DA010674. Please call me if you have any questions at 416-8350.

Thanks Ed

Print	11290	Other	41580
04-1580	365	West Commercial St	10/19/2004
Permitting HS	Signs - Permanent		
072 A004001	2	\$62.00	

Idobson

10/20/2004

Idobson

10/20/2004

City of Portland, Maine - Building or Use Permit

389 Congress Street, 04101 Tel: (207) 874-8703, Fax: (207) 874-8716

Permit No: 04-1580	Date Applied For: 10/19/2004	CBL: 072 A004001
-----------------------	---------------------------------	---------------------

Location of Construction: 366 West Commercial St	Owner Name: Eleven Cousins Limited	Owner Address: 200 Middlesex Turnpike	Phone:
Business Name:	Contractor Name: Cianbro Corp.	Contractor Address: 328 W. Commercial Street Portland	Phone (207) 773-5852
Lessee/Buyer's Name	Phone:	Permit Type: Signs - Permanent	

Proposed Use: Commercial / install 1.6' x 6' sign and one 1x4 sign	Proposed Project Description: install 1.6' x 6' sign and one 1x4 sign
---	--

Dept: Zoning	Status: Approved	Reviewer: Marge Schmuckal	Approval Date: 11/19/2004
Note:			Ok to Issue: <input checked="" type="checkbox"/>
Dept: Building	Status: Approved with Conditions	Reviewer: Tammy Munson	Approval Date: 12/03/2004
Note:			Ok to Issue: <input checked="" type="checkbox"/>
1) Signage Installation to comply with Chapter 31 of the IBC 2003 building code.			

Comments: 11/30/04-tmm: need UL info for illumination - spoke w/ED Jones - said he'd fax it. 12/3/04-tmm: ok -rec'd info
--



CITY OF PORTLAND, MAINE
Department of Building Inspections

10.15 2001

Issued from Ciabro
Name of Work 316 W Commercial

Amount of Registration \$
\$6200

Plumbing (15) Electrical (12) Site Plan (12)

Other Sign

172 A 4

Check # Car- Total Collected \$ 6200

THIS IS NOT A PERMIT

No work is to be started until PERMIT CARD is actually posted
over the premises. Acceptance of fee is no guarantee that permit will
be granted. PRESERVE THIS RECEIPT. In case permit cannot be
obtained the amount of the fee will be refunded upon return of the
receipt less \$10.00 or 10% whichever is greater.

WHITE - Applicant's Copy
YELLOW - Office Copy
PINK - Permit Copy



CITY OF PORTLAND, MAINE

Department of Building Inspections

Oct 21 20 04

Charley Plumbing & Heating
301 Valley St.

Permit Fee \$ 46.00

Plan Printing (15) Electrical (12) ___ Site Plan (12) ___

Permit # 10120

Total Collected \$ 46.00

THIS IS NOT A PERMIT

No work is to be started until PERMIT CARD is actually posted upon the premises. Acceptance of fee is no guarantee that permit will be granted. PRESERVE THIS RECEIPT. In case permit cannot be granted the amount of the fee will be refunded upon return of the receipt less \$10.00 or 10% whichever is greater.

WHITE - Applicant's Copy
YELLOW - Office Copy
PINK - Permit Copy

Donna

DISPLAY THIS CARD ON PRINCIPAL FRONTAGE OF WORK CITY OF PORTLAND

BUILDING INSPECTION

Please Read Application And Notes, If Any, Attached

PERMIT TO OCCUPY
Permit Number: 041580
DEC 03 2004
CITY OF PORTLAND

This is to certify that Eleven Cousins Limited/Ciar Corp.

has permission to install 1.6' x 6' sign and one sign

AT 366 West Commercial St

072 A004001

provided that the person or persons, firm or corporation accepting this permit shall comply with all of the provisions of the Statutes of Maine and of the ordinances of the City of Portland regulating the construction, maintenance and use of buildings and structures, and of the application on file in this department.

Apply to Public Works for street line and grade if nature of work requires such information.

Notification of Inspection must be given and written permission procured before this building or part thereof is leased or otherwise closed-in. **HEAR NOTICE IS REQUIRED.**

A certificate of occupancy must be procured by owner before this building or part thereof is occupied.

OTHER REQUIRED APPROVALS

Fire Dept. _____
Health Dept. _____
Appeal Board _____
Other _____

Department Name

Director - Building & Inspection Services

[Handwritten Signature]
12/03/04

PENALTY FOR REMOVING THIS CARD

BUILDING PERMIT INSPECTION PROCEDURES

Please call 874-8703 or 874-8693 to schedule your inspections as agreed upon

Permits expire in 6 months, if the project is not started or ceases for 6 months.

The Owner or their designee is required to notify the inspections office for the following inspections and provide adequate notice. Notice must be called in 48-72 hours in advance in order to schedule an inspection:

By initializing at each inspection time, you are agreeing that you understand the inspection procedure and additional fees from a "Stop Work Order" and "Stop Work Order Release" will be incurred if the procedure is not followed as stated below.

A Pre-construction Meeting will take place upon receipt of your building permit.

N/A Footing/Building Location Inspection: Prior to pouring concrete
N/A Re-Bar Schedule Inspection: Prior to pouring concrete
N/A Foundation Inspection: Prior to placing ANY backfill
Call Framing/Rough Plumbing/Electrical: Prior to any insulating or drywalling
Call Final/Certificate of Occupancy: Prior to any occupancy of the structure or use. NOTE: There is a \$75.00 fee per inspection at this point.

Certificate of Occupancy is not required for certain projects. Your inspector can advise you if your project requires a Certificate of Occupancy. All projects DO require a final inspection

 If any of the inspections do not occur, the project cannot go on to the next phase, REGARDLESS OF THE NOTICE OR CIRCUMSTANCES.

 CERTIFICATE OF OCCUPANCIES MUST BE ISSUED AND PAID FOR, BEFORE THE SPACE MAY BE OCCUPIED

Bob [Signature] 12/6/04
Signature of Applicant/Designer Date
[Signature] 12/6/04
Signature of Inspections Official Date

CBL: 080 7005 Building Permit #: 041557

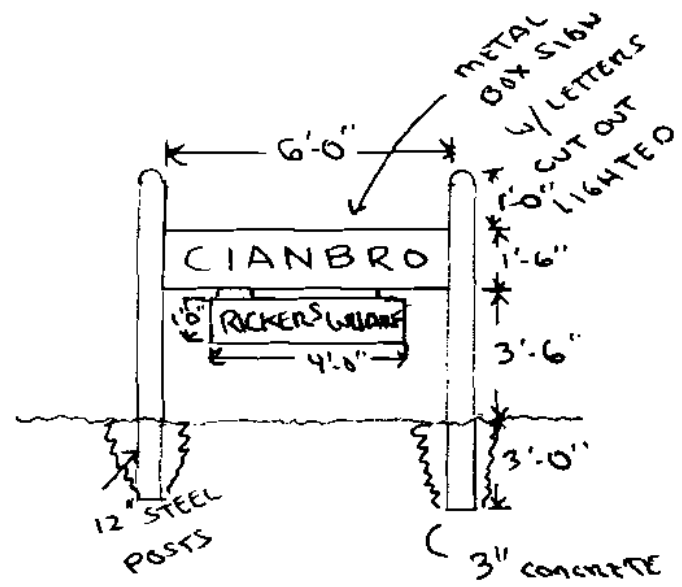

SECTION "AA"

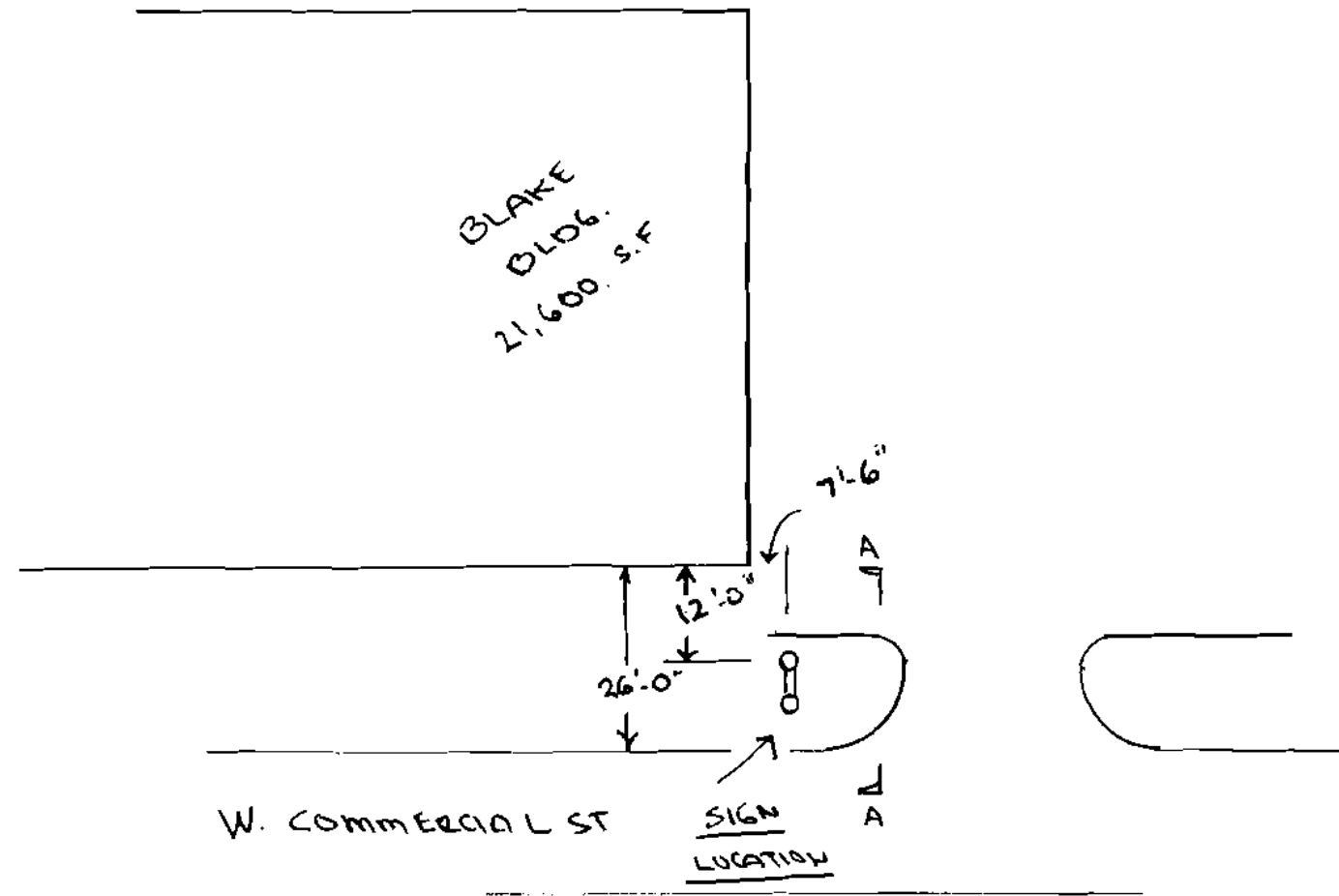

$$\begin{array}{r} 12 \\ 6 \\ \hline 18 \end{array} \quad \begin{array}{r} 26 \\ -18 \\ \hline 8' \end{array}$$

OCT 19 2004

from property line

CIANBRO
 THE CONSTRUCTORS
 Hunnewell Square
 PITTSFIELD, MAINE 04967
 (207) 487-3311

JOB 366 W. COMMERCIAL ST.
 SHEET NO. 1 OF 1 SCALE NONE
 CALCULATED BY _____ DATE _____
 CHECKED BY _____ DATE _____
 DWG/SUBJECT _____