

25 ARTIC FIRE DOGWOOD | 2 FOX VALLEY RIVER BIRCH | 19 CREEPING JUNIPER (MILTON) | 7 DUTCHMANS PIPE (ON TRELLIS STRUCTURE) | 25 ARTIC FIRE DOGWOOD | 1 FOX VALLEY RIVER BIRCH

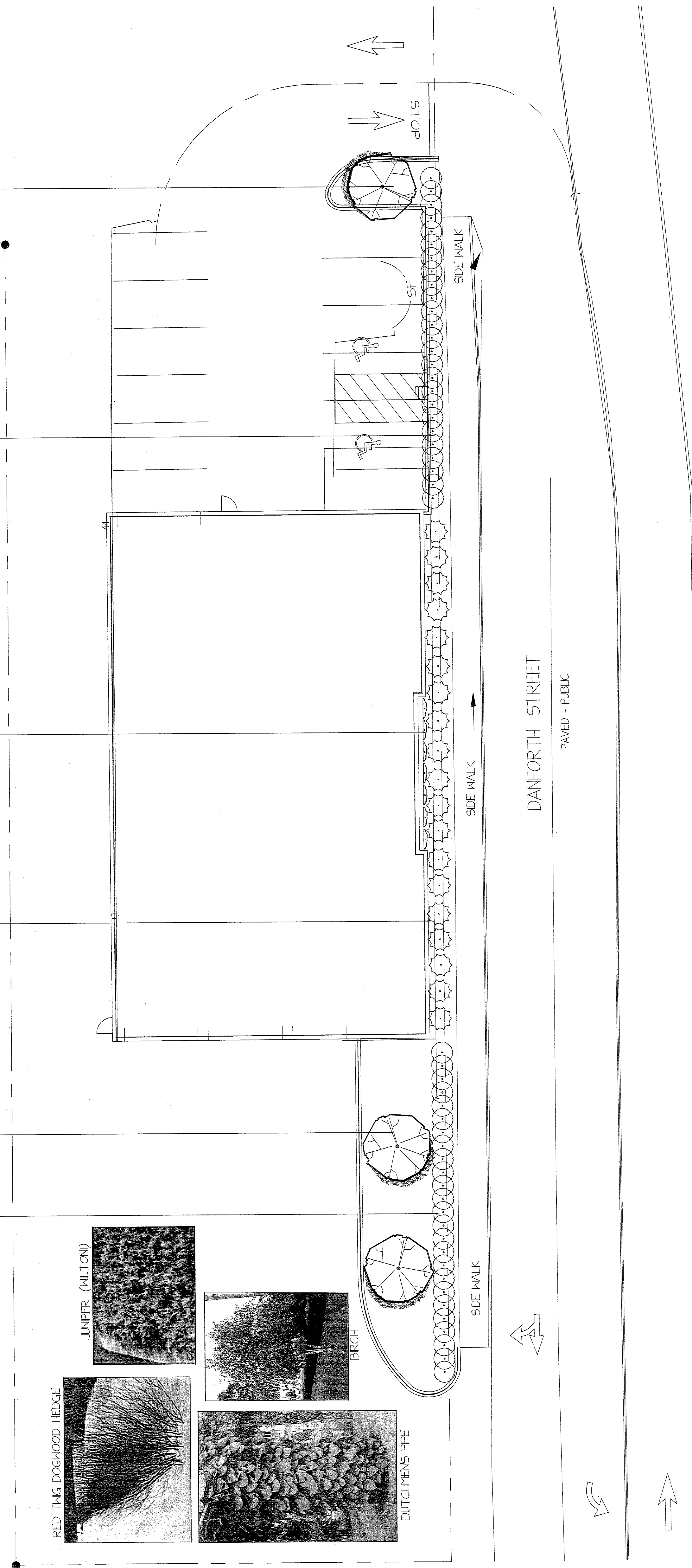
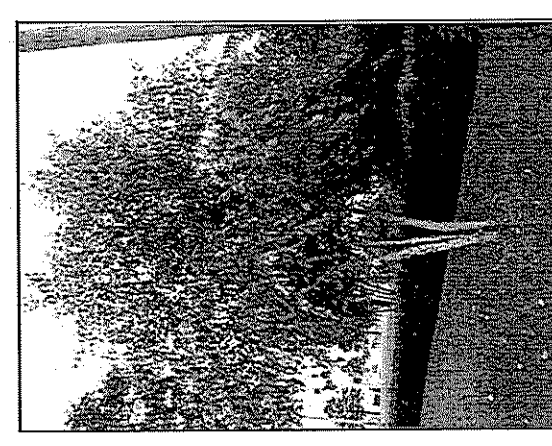
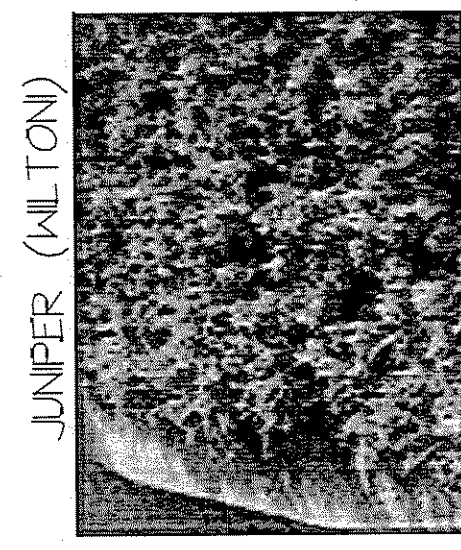
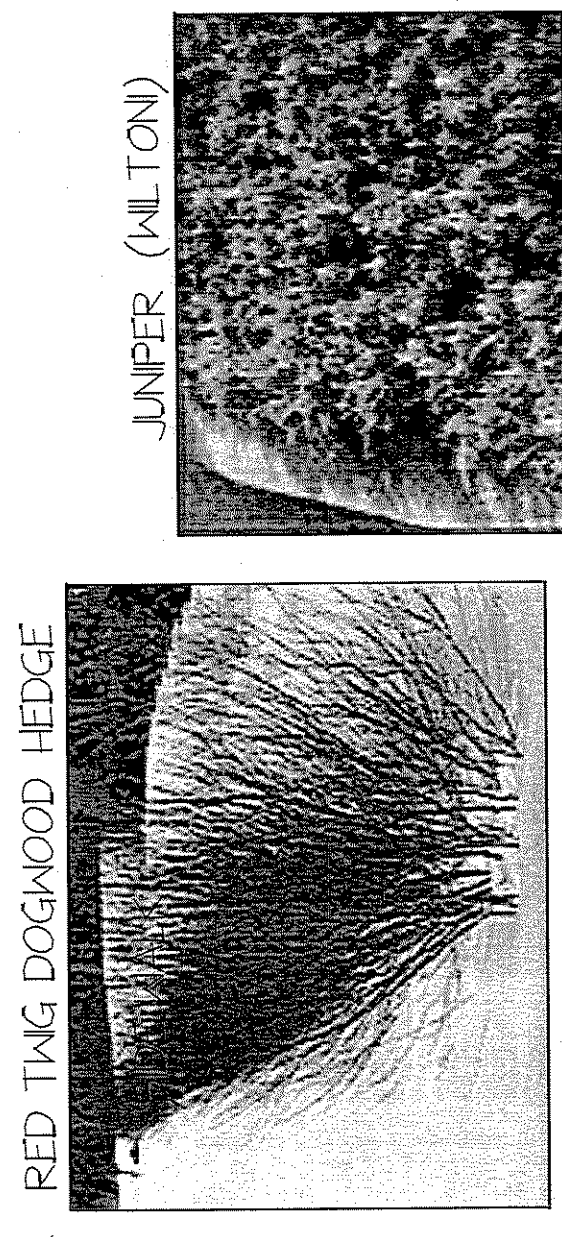

PLANT SCHEDULE

Qty	Botanical Name	Common Name	Size/Condition	Remarks
<b>Trees</b>				
3	Betula nigra	Little King FOX VALLEY RIVER BIRCH	6-7 B#B	CLUMP
<b>Shrubs</b>				
50	Cornus sericea	Farrow ARTIC FIRE DOGWOOD	3 GALLON	2' ON CENTER
<b>Groundcovers</b>				
19	Juniperus horizontalis	CREEPING JUNIPER	5 GALLON	EQUALLY SPACED
<b>Vines</b>				
7	Aristolochia macrophylla	DUTCHMANS PIPE		

NOTE  
 DUTCHMANS PIPE IS A VIGOROUS, TWINING VINE THAT GROWS 20-30' IT IS PRIMARILY GROWN FOR ITS FOLIAGE  
 6-10" HEART SHAPED LEAVES PREFERRED MOST BUT WELL DRAINED SOL SUN TO PARTIAL SHADE GROWS 3-6"/YEAR

501 DANFORTH STREET

PROJECT: NOBLE LANDSCAPE DESIGN  
 148 PINE STREET  
 PORTLAND, MAINE 04102  
 PREPARED BY: 207-650-6200

SCALE: 1" = 20'

DATE: MARCH 8, 2000

DRAWING: LANDSCAPE PLAN