

523-529 DANFORTH STREET

SHAW-WALKER

# Certificate of Flame Resistance



REGISTERED  
APPLICATION  
CONCERN No.

F 75.2

ISSUED BY  
GRANTVILLE COMPANY  
WOODHEAD DIVISION  
FIRE CHIEF

Date Work Performed

3/6/82

This is to certify that the materials described on the reverse side hereof have been flame-retardant treated (or are inherently nonflammable).

FOR THE ASTRUP COMPANY AT 2937 WEST 25TH ST.  
CITY CLEVELAND STATE OHIO

Certification is hereby made that: (Check "a" or "b")

(a) The articles described on the reverse side of this Certificate have been treated with a flame-retardant chemical approved and registered by the State Fire Marshal and that the application of said chemical was done in conformance with the laws of the State of California and the Rules and Regulations of the State Fire Marshal.

Name of chemical used..... Chem. Reg. No.....  
Method of application.....

(b) The articles described on the reverse side hereof are made from a flame-retardant fabric or material registered and approved by the State Fire Marshal for such use.

Trade name of flame-resistant fabric or material used GALA FIRECHIEF Reg. No. F 75.2

The Flame Retardant Process Used WILL NOT Be Removed By Washing  
(will or will not)

Name of Production Superintendent

By PAUL .....  
DIRECTOR OF Title RESEARCH

We hereby certify this to be a true copy of the original "CERTIFICATE OF FLAME RESISTANCE" issued to us, "original copy" of which has been filed with the California State Fire Marshal.

RECEIVED  
DEPT. OF BLDG. INSP.  
CITY OF PORTLAND

The ASTRUP COMPANY  
2937 WEST 25TH ST.  
CLEVELAND OHIO 44117

By *J. E. Bell*  
J. E. BELL



O'Verly  
June 26, 1982

LAND FILL AREA

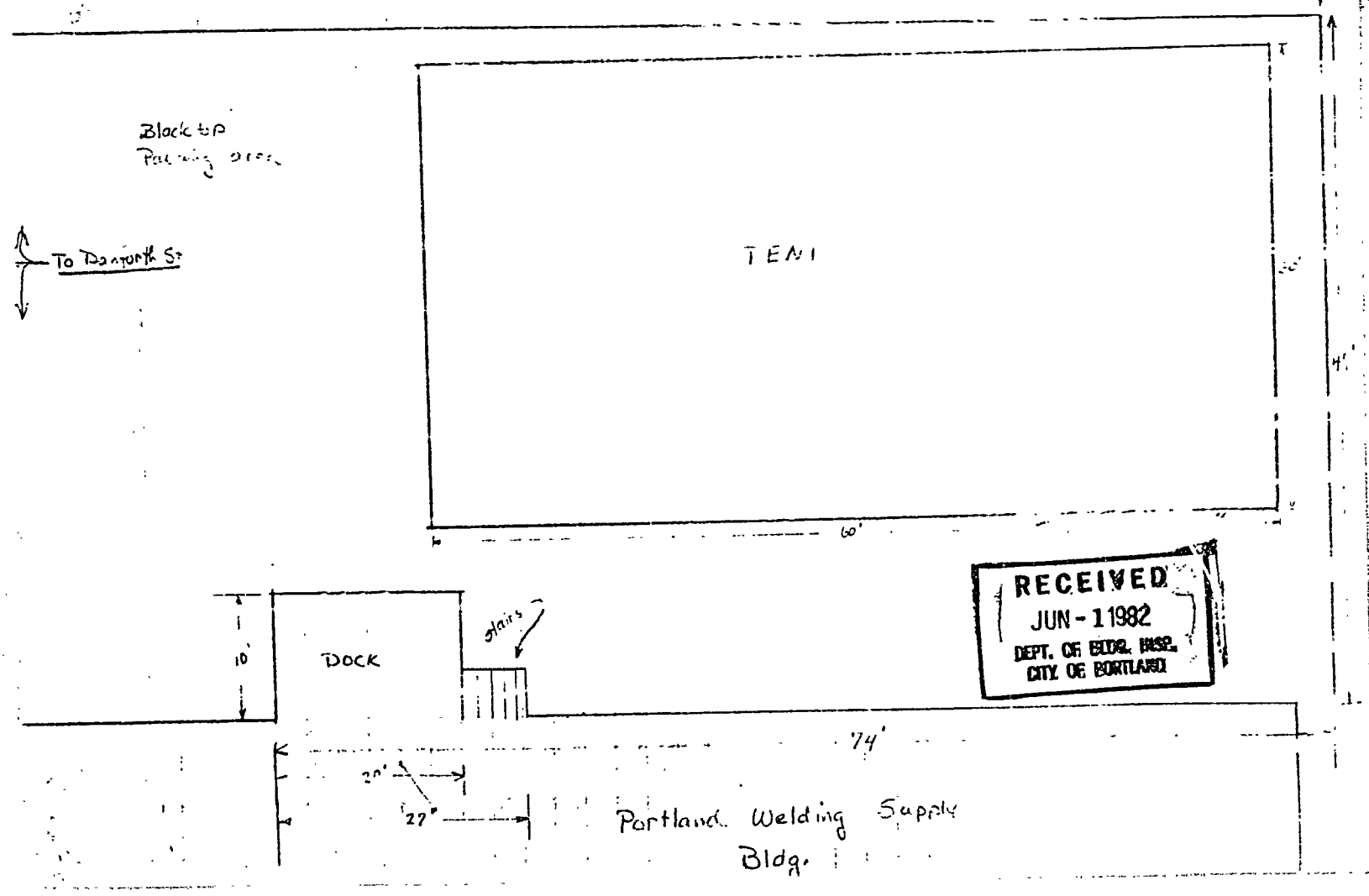

APPLICATION FOR PERMIT

B.O.C.A. USE GROUP .....
B.O.C.A. TYPE OF CONSTRUCTION ..... 00377
ZONING LOCATION ..... PORTLAND, MAINE June 17 1962

PERMIT ISSUED

JUN 2 1962

To the CHIEF OF BUILDING & INSPECTION SERVICES, PORTLAND, MAINE

CITY OF PORTLAND

The undersigned hereby applies for a permit to erect, alter, repair, demolish, move or install the following building, structure, equipment or change use in accordance with the Laws of the State of Maine, the Portland B.O.C.A. Building Code and Zoning Ordinance of the City of Portland with plans and specifications, if any, submitted herewith and the following specifications:

LOCATION 527 Danforth Street Fire District #1 [ ] #2 [ ]
1. Owner's name and address Portland Welding Supply - same Telephone 772-3746
2. Lessee's name and address Telephone
3. Contractor's name and address Bay Canvas Telephone 773-2261
Proposed use of building tent for promotional sale No. families
Last use No. families
Material No. stories Heat Style of roof Roofing
Other buildings on same lot
Estimated contractual cost \$

FIELD INSPECTOR—Mr. @ 775-5451

Appeal Fees \$
Base Fee 35.00
Late Fee
TOTAL \$ 35.00

To erect 30' x 60' tent to be used for promotional sales, June 26, 1962

Stamp of Special Conditions

send permit to # 04102
P. O. Box 8361 04104

NOTE TO APPLICANT: Separate permits are required by the installers and subcontractors of heating, plumbing, electrical and mechanicals.

DETAILS OF NEW WORK

Is any plumbing involved in this work? Is any electrical work involved in this work?
Is connection to be made to public sewer? If not, what is proposed for sewage?
Has septic tank notice been sent? Form notice sent?
Height average grade to top of plate Height average grade to highest point of roof
Size, front depth No. stories solid or filled land? earth or rock?
Material of foundation Thickness, top bottom cellar
Kind of roof Rise per foot Roof covering
No. of chimneys Material of chimneys of lining Kind of heat fuel
Framing Lumber—Kind Dressed or full size? Corner posts Sills
Size Girder Columns under girders Size Max. on centers
Studs (outside walls and carrying partitions) 2x4-16" O. C. Bridging in every floor and flat roof span over 8 feet.
Joists and rafters: 1st floor, 2nd, 3rd, roof
On centers: 1st floor, 2nd, 3rd, roof
Maximum span: 1st floor, 2nd, 3rd, roof
If one story building with masonry walls, thickness of walls? height?

IF A GARAGE

No. cars now accommodated on same lot, to be accommodated, number commercial cars to be accommodated
Will automobile repairing be done other than minor repairs to cars habitually stored in the proposed building?

APPROVALS BY: DATE MISCELLANEOUS
BUILDING INSPECTION—PLAN EXAMINER Will work require disturbing of any tree on a public street?
ZONING:
BUILDING CODE: Will there be in charge of the above work a person competent
Fire Dept.: to see that the State and City requirements pertaining thereto
Health Dept.: are observed?
Others:

Signature of Applicant James Whidden Phone # same
Type Name of above James Whidden for 1 [ ] 2 [ ] 3 [X] 4 [ ]
Portland Welding Supply Other and Address

# 5

FIELD INSPECTOR'S COPY APPLICANT'S COPY OFFICE FILE COPY

NOTES

7-12-81 ~~Final has been removed. It was put up when I was on vacation.~~

Permit No. 821377

Location 537 Danforth St.

Owner Cottland Holdings Inc. Supply

Date of permit 6-1-82

Approved 6-2-82

Dwelling

Garage

Alteration

~~Blank~~

Large grid area with horizontal and vertical lines, mostly blank.

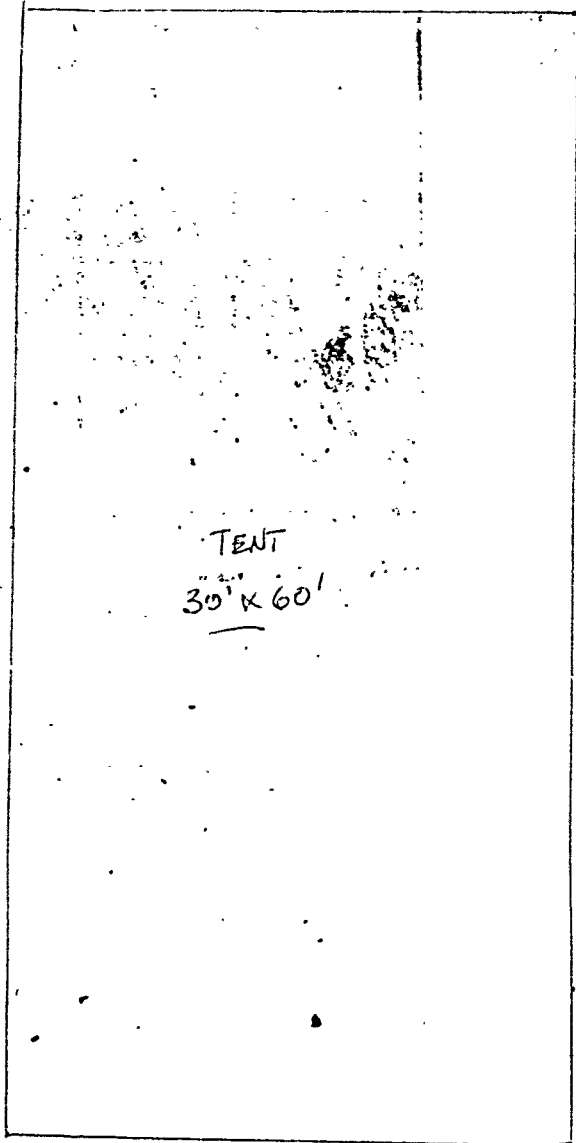

TENT  
30' x 60'

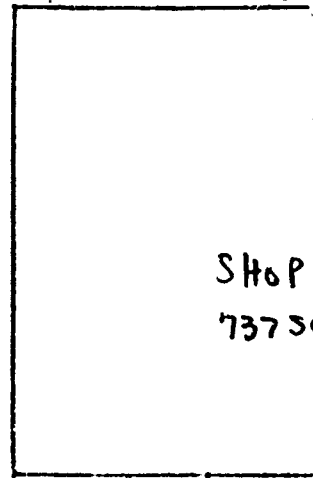

SHOP  
73750

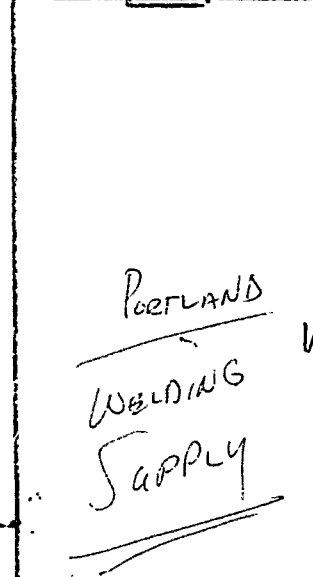

PORTLAND  
WELDING  
SUPPLY

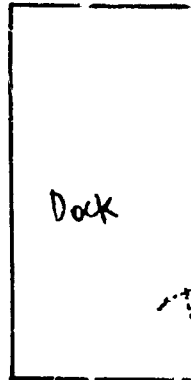

Dock



41

BLACK TO  
PARKING AREA

WHISE.

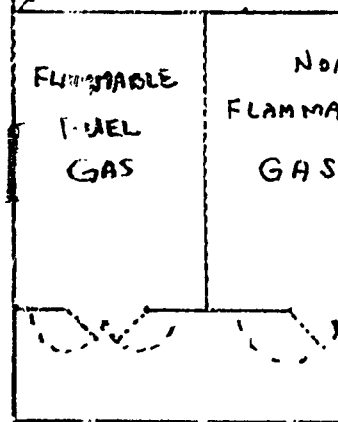

FLAMMABLE  
FUEL  
GAS

NON  
FLAMMABLE  
GAS

RECEIVED  
JUN - 11 1982  
DEPT. OF INDUSTRY  
CITY OF PORTLAND

PANFORTH ST.

ESTABLISHED 1919

AREA CODE 207 - 774 5611

**LEAVITT & PARRIS, INC.**

TWO-THIRTY COMMERCIAL STREET, PORTLAND, MAINE 04111

MANUFACTURERS OF CANVAS PRODUCTS  
FOR HOME, INDUSTRY AND MARINE

July 18, 1980.

To Whom It May Concern:

This is to certify that the tents supplied Portland Wedding Co are certified flame-resistant that meets the requirements of the California Fire Marshall, Underwriters Laboratory Test Flamability 354-H and Government spec. CCC-C-428A.

Yours very truly,

LEAVITT & PARRIS, INC.

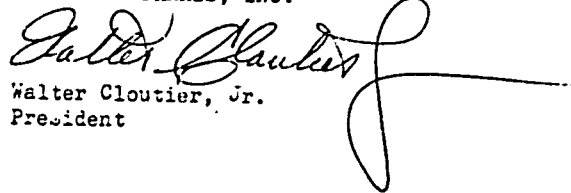
  
Walter Cloutier, Jr.  
President

To be erected August 6, 1980.

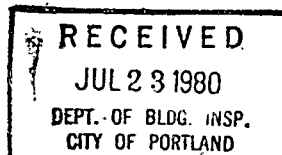

RENTORS OF QUALITY TENTS, CANOPIES AND COMPLETE ACCESSORIES



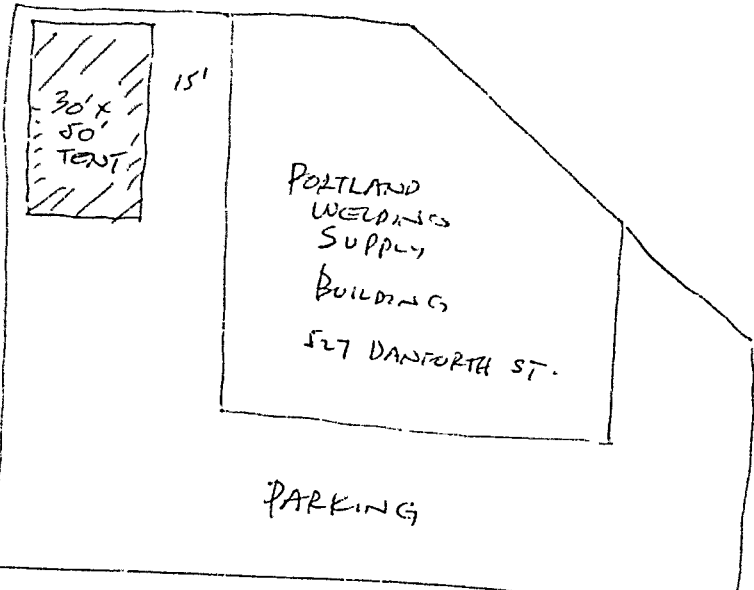

RECEIVED  
JUL 23 1980  
DEPT. OF BLDG. INSP.  
CITY OF PORTLAND



APPLICATION FOR PERMIT

PERMIT ISSUED

B.O.C.A. USE GROUP .....

B.O.C.A. TYPE OF CONSTRUCTION .....

ZONING LOCATION \_\_\_\_\_ PORTLAND, MAINE, ... July 23, 1980

AUG 1 1980

00 589

CITY OF PORTLAND

To the DIRECTOR OF BUILDING & INSPECTION SERVICES, PORTLAND, MAINE

The undersigned hereby applies for a permit to erect, alter, repair, demolish, move or install the following building, structure, equipment or change use in accordance with the Laws of the State of Maine, the Portland B.O.C.A. Building Code and Zoning Ordinance of the City of Portland with plans and specifications, if any, submitted herewith and the following specifications:

LOCATION 527 Danforth St. 04102 Fire District #1 [ ], #2 [ ]
1. Owner's name and address Portland Welding Supply - same Telephone 772-3746
2. Lessee's name and address Telephone
3. Contractor's name and address Leavitt & Parris - 230 Commercial St Telephone 774-5618
4. Architect Specifications Plans No. of sheets
Proposed use of building sales promotion of merchandise No. families
Last use No. families
Material No. stories Heat Style of roof Roofing
Other buildings on same lot
Estimated contractual cost \$ Fee \$ 35.00

FIELD INSPECTOR—Mr. GENERAL DESCRIPTION

This application is for: @ 775-5451
Dwelling Ext. 234
Garage
Masonry Bldg.
Metal Bldg.
Alterations
Demolitions
Change of Use
Other

To erect tent, 30 x 50 tent to be used for promotion of merchandise sales, to be used August 7th, 1980 as per plans. 1 sheet of plans. Stamp of Special Conditions

NOTE TO APPLICANT: Separate permits are required by the installers and subcontractors of heating, plumbing, electrical and mechanicals.

PERMIT IS TO BE ISSUED TO [x] 2 [ ] 3 [ ] 4 [ ]
Other: .....

DETAILS OF NEW WORK

Is any plumbing involved in this work? Is any electrical work involved in this work?
Is connection to be made to public sewer? If not, what is proposed for sewage?
Has septic tank notice been sent? Form notice sent?
Height average grade to top of plate Height average grade to highest point of roof
Size, front depth No. stories solid or filled land? earth or rock?
Material of foundation Thickness, top bottom cellar
Kind of roof Rise per foot Roof covering
No. of chimneys Material of chimneys of lining Kind of heat fuel
Framing Lumber—Kind Dressed or full size? Corner posts Sills
Size Girder Columns under girders Size Max. on centers
Studs (outside walls and carrying partitions) 2x4-16" O. C. Bridging in every floor and flat roof span over 8 feet.
Joists and rafters: 1st floor, 2nd, 3rd, roof
On centers: 1st floor, 2nd, 3rd, roof
Maximum span: 1st floor, 2nd, 3rd, roof
If one story building with masonry walls, thickness of walls? height?

IF A GARAGE

No. cars now accommodated on same lot, to be accommodated number commercial cars to be accommodated
Will automobile repairing be done other than minor repairs to cars habitually stored in the proposed building?

APPROVALS BY: DATE MISCELLANEOUS
BUILDING INSPECTION—PLAN EXAMINER Will work require disturbing of any tree on a public street?
ZONING:
BUILDING CODE: Will there be in charge of the above work a person competent
Fire Dept.: to see that the State and City requirements pertaining thereto
Health Dept.: are observed?
Others:

Signature of Applicant [Signature] Phone # same
Type Name of above Portland Welding Supply 1 [x] 2 [ ] 3 [ ] 4 [ ]

FIELD INSPECTOR'S COPY

Other and Address .....

NOTES

8-6-80 Tail is up  
8-11-80 tail is down

Permit No. 80/580  
Location 507 Newborn St  
Owner Residential Holdings  
Date of permit 8-4-80  
Approved - [Signature] Aug 7

~~[Large handwritten mark]~~

Two columns of horizontal lines for notes, separated by a vertical line.

**CERTIFICATE OF APPROVAL**

FOR INTERNAL PLUMBING FOR THE TOWN/CITY OF Quincy

Town/City Code: 05710      LPI Number: 0723      Date Issued:    /    /     
Month's Day Year

**No 24045 IC**  
 Certificate of App. Number

Installer's Name:    Last Name      F. I. M. I.   

Installer Code:  1  
 2  
 3  
 4  
 5  
 6

- 1. Owner
- 2. Licensed Master Plumber
- 3. Licensed Oil Burnerman
- 4. Employees of Public Utilities
- 5. Manufactured Housing Dealer
- 6. Manufactured Housing Mechanic

Owner:     
 Address:     
Location where plumbing was done and inspected.

THE INTERNAL PLUMBING INSTALLED PURSUANT TO THE ABOVE CERTIFICATE OF APPROVAL NUMBER HAS BEEN TESTED IN MY PRESENCE, FOUND TO BE FREE FROM LEAKS, AND WAS INSTALLED IN COMPLIANCE WITH THE MUNICIPAL AND STATE PLUMBING REGULATIONS.

*Emilio J. Rodriguez*

Signature of LPI     
 Date Inspected **MAY 25 1979**

STATE OFFICE USE ONLY  
 Control Number:   

ORIGINAL—To be sent to: Department of Human Services, Division of Health Engineering, Augusta, Maine 04333

**INTERNAL PLUMBING PERMIT FOR THE TOWN/CITY OF Quincy**

Town/City Code: 05710      LPI Number: 0723      Date Issued:    /    /     
Month Day Year      License Number:    /    /   

**No 24045 IP**  
 PERMIT NUMBER

Address of Where Plumbing Is Done:     
St./Lot Number      Street, Road Name/Subdivision      St., Rd., Av., Lot

- Issue 1. Owner  2. Licensed Master Plumber  3. Licensed Oil Burnerman  4. Employees of Public Utilities  5. Manufactured Housing Dealer  6. Manufactured Housing Mechanic

Name of Owner:    Last Name      F. I. M. I.         Mailing Address:         Zip Code:   

Type of Construction:  1. New     2. Remodeling     3. Addition     4. Remodeling & Addition     5. Replacement of Hot Water Heater     6. Hook-up of Mobile Home     7. Hook-up of Mobile Home     8. Other (Specify)   

Plumbing To Serve:  1. Single (Res)     2. Multi-Fam (Res)     3. Mobile Home     4. Modular Home     5. Commercial     6. School     7. Other (Specify)   

Number of Fixtures or Hook-Ups: Sinks       Toilets       Bathtubs       Lavatories       Showers       Urinals     
 Clothes Washers       Dish-Washers       Hot Water Heater       Floor Drains       Hook-Ups   

This "Internal Plumbing Permit" is invalid if work is not commenced within six(6) months from date of issuance. Upon completion of work a "Certificate of Approval" must be obtained from the LPI.

**SCHEDULE OF "FEES"**  
(See section 1.12 of the Part I Code)

1-10 Fixtures	\$2.00 each
11-20 Fixtures	\$1.00 each
21 Fixtures on up	\$.50 each
Hook-Ups	\$2.00 each

APR 9 - 1979      Fixtures Fee:     
 APR 26      Administrative Fee:     
 1979      Total Fee:     
 If Double Fee Check ( ) Box

STATE OFFICE USE ONLY  
 Control Number:       Administrative Code:   

NOTE: Hotwater Heater (Tank or Tankless) is a Fixture!

Signature of LPI:

*Save this copy  
attach to field copy*

These plans ( / sheets) and the specifications accompanying the same, covering construction work on PROPOSED LARSON'S PLATFORM FOR PORTLAND WELDING SUPPLY PT. 527 DORFORTH ST. STEEL ONLY FOR STRUCTURAL

have been designed and drawn up by the undersigned according to the latest rules of engineering practice and to comply with the allowable working stresses, floor loads, etc. in accordance with Sec. 113.7 & 702.1 of the amendments to the Portland B.O.C.A. Building Code.

(Signature) *Alfred W. Tupper*

By: \_\_\_\_\_

This statement is to be signed by the individual qualified and responsible for the design, and he should indicate in the blank provided the particular work to which the statement applies.

Section 113.7 (ENGINEERING DETAILS) is amended by adding at the end thereof the following new sentence:

"Where structural analysis is required, a certificate of design shall be afforded the Director of Building Inspections and it shall be signed by the person qualified for such design."

Section 702.1 (STRUCTURAL ANALYSIS) is amended by adding at the end thereof the following new sentence:

"All structural design computations and all stress diagrams for trusses shall be filed with the Inspector, if he deems it necessary, upon application for a building permit."



CITY OF PORTLAND, MAINE  
Department of Building Inspection

# Certificate of Occupancy

LOCATION

527 Danforth St.

Issued to **Portland Welding Supply**

Date of Issue **12-13-79**

This is to certify that the building, premises, or part thereof, at the above location, built—altered—changed as to use under Building Permit No. **79/337**, has had final inspection, has been found to conform substantially to requirements of Zoning Ordinance and Building Code of the City, and is hereby approved for occupancy or use, limited or otherwise, as indicated below.

PORTION OF BUILDING OR PREMISES

APPROVED OCCUPANCY

**Entire**

**office & warehouse addition**

Limiting Conditions:

This certificate supersedes  
certificate issued

Approved:

12-13-79  
(Date)

Inspector

Inspector of Buildings

Notice: This certificate identifies lawful use of building or premises, and ought to be transferred from owner to owner when property changes hands. Copy will be furnished to owner or lessee for one dollar.

CITY OF PORTLAND, MAINE

MEMORANDUM

TO: George Stanford Inc.

DATE: 5/8/79

FROM: Fire Prevention Bureau

SUBJECT: 527 Danforth St.

Approval is hereby given for a building permit  
from this Department subject to the following requirements/reasons:

- 1) The rear exit leading to the loading dock will require stairs leading from the loading dock to the ground.
- 2) An approved automatic extinguishing system shall be installed at the tank storage areas.
- 3) Emergency lighting shall be provided for all exits and paths to reach same.
- 4) An approved automatic alarm system shall be installed. This system shall be approved through this office.

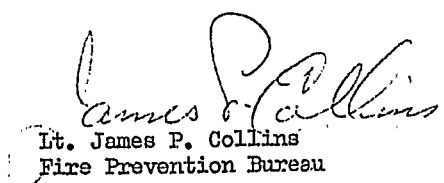
  
Lt. James P. Collins  
Fire Prevention Bureau



# APPLICATION FOR PERMIT

B.O.C.A. USE GROUP ..... 000333  
B.O.C.A. TYPE OF CONSTRUCTION .....

ZONING LOCATION T-3B PORTLAND, MAINE, ... May 1, 1979

**PERMIT ISSUED**

MAY 9 1979

**CITY of PORTLAND**

To the DIRECTOR OF BUILDING & INSPECTION SERVICES, PORTLAND, MAINE

The undersigned hereby applies for a permit to erect, alter, repair, demolish, move or install the following building, structure, equipment or change use in accordance with the Laws of the State of Maine, the Portland B.O.C.A. Building Code and Zoning Ordinance of the City of Portland with plans and specifications, if any, submitted herewith and the following specifications:

LOCATION ..... 527 Danforth Street ..... Fire District #1 , #2

1. Owner's name and address Portland Welding Supply - same ..... Telephone 772-3748

2. Lessee's name and address ..... Telephone .....

3. Contractor's name and address George Stanford Inc. - 191 Spurwink Rd. Telephone 799-0411

4. Architect ..... Specifications Scarboro 04074 Plans ..... No. of sheets .....

Proposed use of building ..... welding supply ..... No. families .....

Last use ..... No. families .....

Material ..... No. stories ..... Heat ..... Style of roof ..... Roofing .....

Other buildings on same lot .....

Estimated contractual cost \$ 230,000 ..... Fee \$ 1,036.00

### FIELD INSPECTOR—Mr. .... GENERAL DESCRIPTION

This application is for: @ 775-5451

- Dwelling ..... Ext. 234
- Garage .....
- Masonry Bldg. ....
- Metal Bldg. ....
- Alterations XX ..... Sent to Fire Dept. 5-2-79
- Demolitions ..... Rec'd from Fire Dept. 5-2-79
- Change of Use .....
- Other .....

To make alterations to building, to construct 2nd floor to be used for office and warehouse, also 25 x 30 addition ramp of Special Conditions on rear of building, as per plans 7 sheets of plans.

NOTE TO APPLICANT: Separate permits are required by the installers and subcontractors of heating, plumbing, electrical and mechanicals.

PERMIT IS TO BE ISSUED TO 1  2  3  4

Other: .....

### DETAILS OF NEW WORK

Is any plumbing involved in this work? ..... Is any electrical work involved in this work? .....

Is connection to be made to public sewer? ..... If not, what is proposed for sewage? .....

Has septic tank notice been sent? ..... Form notice sent? .....

Height average grade to top of plate ..... Height average grade to highest point of roof .....

Size, front depth ..... No. stories ..... solid or filled land? ..... earth or rock? .....

Material of foundation ..... Thickness, top ..... bottom ..... cellar .....

Kind of roof ..... Rise per foot ..... Roof covering .....

No. of chimneys ..... Material of chimneys ..... of lining ..... Kind of heat ..... fuel .....

Framing Lumber—Kind ..... Dressed or full size? ..... Corner posts ..... Sills .....

Size Girder ..... Columns under girders ..... Size ..... Max. on centers .....

Studs (outside walls and carrying partitions) 2x4-16" O. C. Bridging in every floor and flat roof span over 8 feet.

Joists and rafters: 1st floor ....., 2nd ....., 3rd ....., roof .....

On centers: 1st floor ....., 2nd ....., 3rd ....., roof .....

Maximum span: 1st floor ....., 2nd ....., 3rd ....., roof .....

If one story building with masonry walls, thickness of walls? ..... height? .....

### IF A GARAGE

No. cars now accommodated on same lot ....., to be accommodated ... number commercial cars to be accommodated ... Will automobile repairing be done other than minor repairs to cars habitually stored in the proposed building? .....

APPROVALS BY: DATE

BUILDING INSPECTION—PLAN EXAMINER .....

ZONING: A.R. ... 5/1/79 .....

BUILDING CODE: J. ... .....

Fire Dept.: J. ... .....

Health Dept.: J. ... .....

Others: .....

### MISCELLANEOUS

Will work require disturbing of any tree on a public street? ... Will there be in charge of the above work a person competent to see that the State and City requirements pertaining thereto are observed? .....

Signature of Applicant George W. Stanford, Jr. Phone # ..... Same

Type Name of above George Stanford, Inc. 1  2  3  4

Other ..... and Address .....

FIELD INSPECTOR'S COPY

**PERMIT ISSUED WITH LETTER**

*Filed*



NOTES

7-5-79 Started erecting steel beams  
 on RPAR for 2nd floor addition - u O  
 8-1-79 Started pouring of footing on  
 RPAR/Adit 10:00 hours tomorrow morning  
 4' in diameter -  
 8-25-79 RPAR for pour part of footing and  
 part of steel foundation (on RPAR addition)  
 9-28-79 2nd floor addition is finishing up the  
 RPAR - will RPAR in a class. Act -  
 9-28-79 No calls by close in - mostly all  
 closed in - Not using 5/8" sheet  
 Rock on both sides of stair  
 tower all over - just in  
 some places - A check of  
 plans show that the original  
 specs don't have 5/8"  
 on both sides. Specs accepted  
 by Fire Dept & our dept -  
 12-6-79 Ready for final  
 RPAR section completed -  
 emergency lights & exit  
 lights are in - has  
 sprinklers in tank  
 Area - Alarm system  
 is in. will check with  
 the permission on their  
 approval -  
 12-12-79 OK by FFB -  
 issue C.O. -

Permit No. 79/837  
 Location 387 Capital Hill  
 Owner Eastland Holdings  
 Date of permit 5-1-79  
 Approved G-9-79 2nd floor addition on RPAR



APPLICATION FOR PERMIT

PERMIT ISSUED

000006 JAN 3 1979

B.O.C.A. USE GROUP

B.O.C.A. TYPE OF CONSTRUCTION

ZONING LOCATION 2-3 B PORTLAND, MAINE, Jan. 3, 1979

CITY of PORTLAND

To the DIRECTOR OF BUILDING & INSPECTION SERVICES, PORTLAND, MAINE

The undersigned hereby applies for a permit to erect, alter, repair, demolish, move or install the following building, structure, equipment or change use in accordance with the Laws of the State of Maine, the Portland B.O.C.A. Building Code and Zoning Ordinance of the City of Portland with plans and specifications, if any, submitted herewith and the following specifications:

LOCATION ... 527 Danforth St. Fire District #1 [ ], #2 [ ]
1. Owner's name and address Portland Welding & Supply Telephone ...
2. Lessee's name and address Telephone 799-0411
3. Contractor's name and address George Stanford, Inc. 191 Spurwink Rd. Telephone ...
4. Architect Specifications Plans No. of sheets
Proposed use of building office & warehouse No. families
Last use No. families
Material No. stories Heat Style of roof Roofing
Other buildings on same lot
Estimated contractual cost \$ 12,000 Fee \$ 48

FIELD INSPECTOR—Mr. GENERAL DESCRIPTION
This application is for: @ 775-5451 Ext. 234 To construct foundation and dock area for Portland Welding & supply as per plans.
Dwelling
Garage
Masonry Bldg. Stamp of Special Conditions
Metal Bldg.
Alterations
Demolitions
Change of Use
Other

NOTE TO APPLICANT: Separate permits are required by the installers and subcontractors of heating, plumbing, electrical and mechanicals.

PERMIT IS TO BE ISSUED TO 1 [ ] 2 [ ] 3 [x] 4 [ ]
Other: .....

DETAILS OF NEW WORK

Is any plumbing involved in this work? Is any electrical work involved in this work?
Is connection to be made to public sewer? If not, what is proposed for sewage?
Has septic tank notice been sent? Form notice sent?
Height average grade to top of plate Height average grade to highest point of roof
Size, front depth No. stories solid or filled land? earth or rock?
Material of foundation Thickness, top bottom cellar
Kind of roof Rise per foot Roof covering
No. of chimneys Material of chimneys of lining Kind of heat fuel
Framing Lumber—Kind Dressed or full size? Corner posts Sills
Size Girder Columns under girders Size Max. on centers
Studs (outside walls and carrying partitions) 2x4-16" O. C. Bridging in every floor and flat roof span over 8 feet.
Joists and rafters: 1st floor 2nd 3rd roof
On centers: 1st floor 2nd 3rd roof
Maximum span: 1st floor 2nd 3rd roof
If one story building with masonry walls, thickness of walls? height?

IF A GARAGE

No. cars now accommodated on same lot, to be accommodated number commercial cars to be accommodated
Will automobile repairing be done other than minor repairs to cars habitually stored in the proposed building?

APPROVALS BY: DATE
BUILDING INSPECTION—PLAN EXAMINER
ZONING: A.R.M.G.O. 1/3/79
BUILDING CODE: R.L.S.
Fire Dept.
Health Dept.
Others:

MISCELLANEOUS
Will work require disturbing of any tree on a public street?
Will there be in charge of the above work a person competent to see that the State and City requirements pertaining thereto are observed? Yes...

Signature of Applicant George W. Stanford, Jr. Phone #
Type Name of above George Stanford, Jr. 1 [ ] 2 [ ] 3 [ ] 4 [ ]
Other and Address

FIELD INSPECTOR'S COPY

NOTES

1-9-79 Not started work yet

2-5-79 just starting some excavation work

2-8-79 Ready to pour foundation footing on side additional - lot lines 1/4" per zoning slip - will have area heated (enclosed with plastic)

2-13-79 12" wall - reinforced - anchored into wall

2-28-79 Not in. Fin. up rest yet

3-16-79 Has steel decking up

4-14-79 Ready to pour footings for front part of 2nd floor

5-9-79 Getting ready to pour rest of footings on the front loading dock

7-5-79 Foundation work completed - some masonry and framing in front part of bldg. See comments on rear 2nd floor addition

Permit No. 78 / 6

Location 527 Danforth St.

Owner For the Building & Dept

Date of permit 1-3-79

Approved Foundation Dept. Mayor

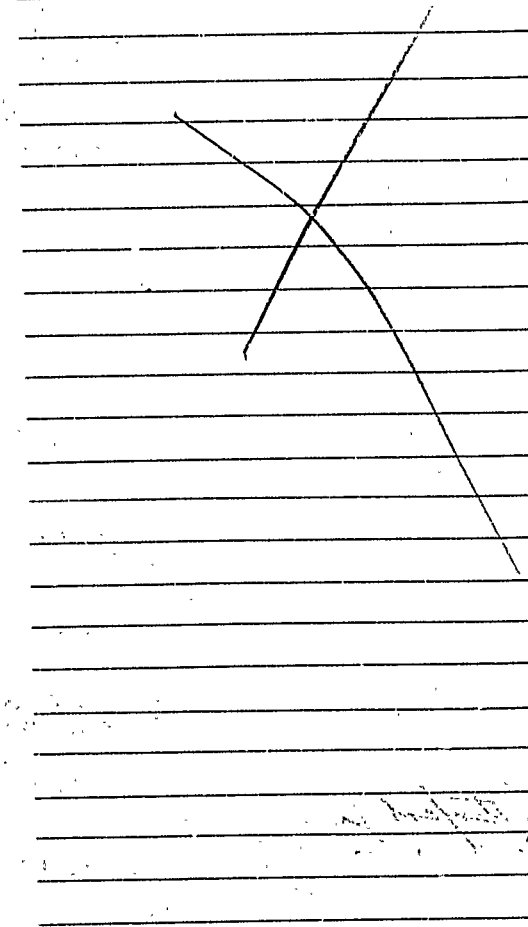

FILL IN AND SIGN WITH INK

000198

PERMIT ISSUED

APPLICATION FOR PERMIT FOR HEATING, COOKING OR POWER EQUIPMENT

APR 2 1979

Portland, Maine, April 2, 1979

CITY OF PORTLAND



To the INSPECTOR OF BUILDINGS, PORTLAND, ME.

The undersigned hereby applies for a permit to install the following heating, cooking or power equipment in accordance with the Laws of Maine, the Building Code of the City of Portland, and the following specifications:

Location 527 Danforth St. Use of Building No. Stories New Building Existing
Name and address of owner of appliance Portland Welding Co. - same
Installer's name and address Canon & Waltz - 416 Preble St. So. Portland Telephone 799-2228

General Description of Work

To install forced hot water boiler & burner - replacement

IF HEATER, OR POWER BOILER

Location of appliance basement Any burnable material in floor surface or beneath? no
If so, how protected? Kind of fuel? # 2 fuel oil
Minimum distance to burnable material, from top of appliance or casing top of furnace 2 ft.
From top of smoke pipe From front of appliance From sides or back of appliance
Size of chimney flue 8 x 12 Other connections to same flue none
If gas fired, how vented? Rated maximum demand per hour
Will sufficient fresh air be supplied to the appliance to insure proper and safe combustion? yes

IF OIL BURNER

Name and type of burner A.B.C. - gun Labelled by underwriters' laboratories? yes
Will operator be always in attendance? no Does oil supply line feed from top or bottom of tank? bottom
Type of floor beneath burner concrete Size of vent pipe 1 1/2
Location of oil storage basement Number and capacity of tanks 1-275 gal.
Low water shut off yes Make McDonald Miller No.
Will all tanks be more than five feet from any flame? yes How many tanks enclosed? none
Total capacity of any existing storage tanks for furnace burners 265 gal. existing

IF COOKING APPLIANCE

Location of appliance Any burnable material in floor surface or beneath?
If so, how protected? Height of Legs, if any
Skirting at bottom of appliance? Distance to combustible material from top of appliance?
From front of appliance From sides and back From top of smokepipe
Size of chimney flue Other connections to same flue
Is hood to be provided? If so, how vented? Forced or gravity?
If gas fired, how vented? Rated maximum demand per hour

MISCELLANEOUS EQUIPMENT OR SPECIAL INFORMATION

Amount of fee enclosed? 5.00

APPROVED: [Signature line]

Will there be in charge of the above work a person competent to see that the State and City requirements pertaining thereto are observed?

Signature of Installer Joseph St. Jean, P.R.E.S.

CS 300

INSPECTION COPY

NOTES

5-9-79 Not installed yet (will do when  
put 2nd floor on - 2)

12-12-79 Completed - 0

Permit No. 79/1981  
 Location 527 Clarendon St. C  
 Owner G. Williams & Co. Heating Co.  
 Date of permit 1-2-79  
 Approved 1-2-79 G. Williams & Co. Heating Co.  
 1-2-79 G. Williams & Co. Heating Co.

1. 1/2" RISE PIPE
2. 1/2" RISE PIPE
3. RISE OF PIPE
4. RISE OF PIPE & Support
5. RISE OF PIPE
6. RISE OF PIPE
7. RISE OF PIPE
8. Main Water Supply
9. Main Water Supply
10. High Water Control
11. High Water Control
12. Valve for High Water Control
13. Control of High Water
14. Control of High Water
15. Oil pipes
16. Instruction Card
17. Oil pipes
18. Adequate ventilation
19. Smoke alarm combustible
20. Thermal Control switch



**APPLICATION FOR PERMIT**  
 DEPARTMENT OF BUILDING INSPECTIONS SERVICES  
 ELECTRICAL INSTALLATIONS

Date Feb. 4, 19 80  
 Receipt and Permit number 45831

To the CHIEF ELECTRICAL INSPECTOR, Portland, Maine:

The undersigned hereby applies for a permit to make electrical installations in accordance with the laws of Maine, the Portland Electrical Ordinance, the National Electrical Code and the following specifications:

LOCATION OF WORK: 527 Danforth Street  
 OWNER'S NAME: Portland Welding Supply ADDRESS: same

	FEES
OUTLETS: Receptacles _____ Switches _____ Plugmold _____ ft. TOTAL _____	
FIXTURES: (number of)	
Incandescent _____ Flourescent <u>63</u> (not strip) TOTAL <u>63</u>	<u>8.30</u>
Strip Flourescent _____ ft. ....	
SERVICES:	
Overhead _____ Underground _____ Temporary _____ TOTAL amperes _____	
METERS: (number of) _____	
MOTORS: (number of)	
Fractional _____	
1 HP or over _____	
RESIDENTIAL HEATING:	
Oil or Gas (number of units) _____	
Electric (number of rooms) _____	
COMMERCIAL OR INDUSTRIAL HEATING:	
Oil or Gas (by a main boiler) _____	
Oil or Gas (by separate units) _____	
Electric Under 20 kws _____ Over 20 kws _____	
APPLIANCES: (number of)	
Ranges _____ Water Heaters _____	
Cook Tops _____ Disposals _____	
Wall Ovens _____ Dishwashers _____	
Dryers _____ Compactors _____	
Fans _____ Others (denote) _____	
TOTAL _____	
MISCELLANEOUS: (number of)	
Branch Panels _____	
Transformers _____	
Air Conditioners Central Unit _____	
Separate Units (windows) <u>6</u>	<u>12.00</u>
Signs 20 sq. ft. and under _____	
Over 20 sq. ft. _____	
Swimming Pools Above Ground _____	
In Ground _____	
Fire/Burglar Alarms Residential _____	
Commercial _____	
Heavy Duty Outlets, 220 Volt (such as welders) 30 amps and under _____	
over 30 amps _____	
Circus, Fairs, etc. _____	
Alterations to wires _____	
Repairs after fire _____	
Emergency Lights, battery _____	
Emergency Generators _____	
INSTALLATION FEE DUE: _____	
FOR ADDITIONAL WORK NOT ON ORIGINAL PERMIT ..... DOUBLE FEE DUE: _____	
FOR REMOVAL OF A "STOP ORDER" (304-16.b) .....	
TOTAL AMOUNT DUE: _____	<u>20.30</u>

INSPECTION:  
 Will be ready on \_\_\_\_\_, 19\_\_; or Will Call \_\_\_\_\_  
 CONTRACTOR'S NAME: Bennett L. Stanford  
 ADDRESS: P. O. Box 330 - North Windham, Me.  
 TEL.: \_\_\_\_\_  
 MASTER LICENSE NO.: 2934 SIGNATURE OF CONTRACTOR: \_\_\_\_\_  
 LIMITED LICENSE NO.: \_\_\_\_\_

INSPECTOR'S COPY — WHITE  
 OFFICE COPY — CANARY  
 CONTRACTOR'S COPY — GREEN

ELECTRICAL INSTALLATIONS -

Permit Number 45531

Location 527 DuPont St

Owner Portland Welding

Date of Permit 2-11-80

Final Inspection 2-11-80

By Inspector Willy

Permit Application Register Page No. 48

INSPECTIONS: Service \_\_\_\_\_ by \_\_\_\_\_

Service called in \_\_\_\_\_

Closing-in \_\_\_\_\_ by \_\_\_\_\_

PROGRESS INSPECTIONS: 2-11-80 / \_\_\_\_\_ / \_\_\_\_\_

\_\_\_\_\_ / \_\_\_\_\_ / \_\_\_\_\_

\_\_\_\_\_ / \_\_\_\_\_ / \_\_\_\_\_

\_\_\_\_\_ / \_\_\_\_\_ / \_\_\_\_\_

\_\_\_\_\_ / \_\_\_\_\_ / \_\_\_\_\_

\_\_\_\_\_ / \_\_\_\_\_ / \_\_\_\_\_

\_\_\_\_\_ / \_\_\_\_\_ / \_\_\_\_\_

\_\_\_\_\_ / \_\_\_\_\_ / \_\_\_\_\_

\_\_\_\_\_ / \_\_\_\_\_ / \_\_\_\_\_

\_\_\_\_\_ / \_\_\_\_\_ / \_\_\_\_\_

\_\_\_\_\_ / \_\_\_\_\_ / \_\_\_\_\_

\_\_\_\_\_ / \_\_\_\_\_ / \_\_\_\_\_

\_\_\_\_\_ / \_\_\_\_\_ / \_\_\_\_\_

\_\_\_\_\_ / \_\_\_\_\_ / \_\_\_\_\_

\_\_\_\_\_ / \_\_\_\_\_ / \_\_\_\_\_

\_\_\_\_\_ / \_\_\_\_\_ / \_\_\_\_\_

\_\_\_\_\_ / \_\_\_\_\_ / \_\_\_\_\_

\_\_\_\_\_ / \_\_\_\_\_ / \_\_\_\_\_

\_\_\_\_\_ / \_\_\_\_\_ / \_\_\_\_\_

\_\_\_\_\_ / \_\_\_\_\_ / \_\_\_\_\_

\_\_\_\_\_ / \_\_\_\_\_ / \_\_\_\_\_

\_\_\_\_\_ / \_\_\_\_\_ / \_\_\_\_\_

\_\_\_\_\_ / \_\_\_\_\_ / \_\_\_\_\_

\_\_\_\_\_ / \_\_\_\_\_ / \_\_\_\_\_

\_\_\_\_\_ / \_\_\_\_\_ / \_\_\_\_\_

\_\_\_\_\_ / \_\_\_\_\_ / \_\_\_\_\_

\_\_\_\_\_ / \_\_\_\_\_ / \_\_\_\_\_

\_\_\_\_\_ / \_\_\_\_\_ / \_\_\_\_\_

\_\_\_\_\_ / \_\_\_\_\_ / \_\_\_\_\_

\_\_\_\_\_ / \_\_\_\_\_ / \_\_\_\_\_

\_\_\_\_\_ / \_\_\_\_\_ / \_\_\_\_\_

CODE  
COMPLIANCE  
COMPLETED  
DATE 2-11-80

REMARKS:

00.55

00.30

Approved by \_\_\_\_\_  
Date \_\_\_\_\_  
Inspector \_\_\_\_\_



**APPLICATION FOR PERMIT**  
 DEPARTMENT OF BUILDING INSPECTIONS SERVICES  
 ELECTRICAL INSTALLATIONS

Date Mon Aug. 1, 19 79  
 Receipt and Permit number A 28900

To the CHIEF ELECTRICAL INSPECTOR, Portland, Maine:

The undersigned hereby applies for a permit to make electrical installations in accordance with the laws of Maine, the Portland Electrical Ordinance, the National Electrical Code and the following specifications:

LOCATION OF WORK: 527 Danforth Street  
 OWNER'S NAME: Portland Welding Supply ADDRESS: same

OUTLETS:		FEES
Receptacles _____	Switches _____	Plugmold _____ ft. TOTAL <u>31-60</u> ..... <u>5.00</u>
FIXTURES: (number of)		
Incandescent _____	Flourescent _____ (not strip)	TOTAL _____
Strip Flourescent _____	ft. _____	_____
SERVICES:		
Overhead <input checked="" type="checkbox"/>	Underground _____	Temporary _____ TOTAL amperes <u>400</u> .. <u>6.00</u>
METERS: (number of) <u>1</u>	_____	_____ <u>.50</u>
MOTORS: (number of)		
Fractional _____	_____	_____
1 HP or over _____	_____	_____
RESIDENTIAL HEATING:		
Oil or Gas (number of units) _____	_____	_____
Electric (number of rooms) _____	_____	_____
COMMERCIAL OR INDUSTRIAL HEATING:		
Oil or Gas (by a main boiler) _____	_____	_____
Oil or Gas (by separate units) _____	_____	_____
Electric Under 20 kws _____	Over 20 kws <u>40</u> x	_____ <u>10.00</u>
APPLIANCES: (number of)		
Ranges _____	<u>x</u>	Water Heaters _____
Cook Tops _____	_____	Disposals _____
Wall Ovens _____	_____	Dishwashers _____
Dryers _____	_____	Compactors _____
Fans _____	<u>2</u>	Others (denote) _____
TOTAL _____	_____	_____ <u>4.50</u>
MISCELLANEOUS: (number of)		
Branch Panels _____	_____	_____ <u>4.00</u>
Transformers <u>2</u>	_____	_____ <u>10.00</u>
Air Conditioners Central Unit _____	_____	_____
Separate Units (windows) <u>5</u>	_____	_____
Signs 20 sq. ft. and under _____	_____	_____
Over 20 sq. ft. _____	_____	_____
Swimming Pools Above Ground _____	_____	_____
In Ground _____	_____	_____
Fire/Burglar Alarms Residential _____	_____	_____
Commercial <u>x</u>	_____	_____ <u>2.00</u>
Heavy Duty Outlets, 220 Volt (such as welders) 30 amps and under _____	_____	_____
over 30 amps _____	_____	_____
Circus, Fairs, etc. _____	_____	_____
Alterations to wires _____	_____	_____
Repairs after fire _____	_____	_____
Emergency Lights, battery <u>3</u>	_____	_____ <u>.50</u>
Emergency Generators _____	_____	_____
FOR ADDITIONAL WORK NOT ON ORIGINAL PERMIT .....	INSTALLATION FEE DUE:	_____
FOR REMOVAL OF A "STOP ORDER" (304-16.b) .....	DOUBLE FEE DUE:	_____
TOTAL AMOUNT DUE:		<u>42.50</u>

INSPECTION:

Will be ready on \_\_\_\_\_, 19\_\_; or Will Call xx

CONTRACTOR'S NAME: Bennett L. Stanford

ADDRESS: P. O. Box 330

TEL.: 892-4059

MASTER LICENSE NO.: 2934

LIMITED LICENSE NO.: \_\_\_\_\_

SIGNATURE OF CONTRACTOR:  
*Bennett L. Stanford*

INSPECTOR'S COPY — WHITE  
 OFFICE COPY — CANARY  
 CONTRACTOR'S COPY — GREEN





PERMIT ISSUED  
WITH LETTER

527 Danforth Street

June 17, 1974

cc to: Portland Welding Supply  
527 Danforth Street

George H. Stanford  
191 Spurwink Road  
Scarborough

Dear Mr. Stanford:

Permit to construct an addition on the right side of existing building as per plans is issued herewith subject to the following BOCA International Building Code requirements:

Anchor bolts are required to be spaced not farther apart than 8' o. c's., and at the corners.

The upper right member of the box sill is required to be doubled at the ends of the building.

Please call this office and tell us what size timber or piece of steel you are to use where the lally column is shown in the center of the span.

Very truly yours,

Earle S. Smith  
Plan Examiner

ESS:m



APPLICATION FOR PERMIT

PERMIT ISSUED

B.O.C.A. USE GROUP ..... B.O.C.A. TYPE OF CONSTRUCTION ..... 00546 JUN 17 1974

ZONING LOCATION ..... PORTLAND, MAINE, June 13, 1974. CITY of PORTLAND

To the DIRECTOR OF BUILDING & INSPECTION SERVICES, PORTLAND, MAINE

The undersigned hereby applies for a permit to erect, alter, repair, demolish, move or install the following building, structure, equipment or change use in accordance with the Laws of the State of Maine, the Portland B.O.C.A. Building Code and Zoning Ordinance of the City of Portland with plans and specifications, if any, submitted herewith and the following specifications:

LOCATION ~~255 DANFORTH ST~~ 527 Danforth St. Fire District #1 [ ], #2 [ ]
1. Owner's name and address Portland Welding Supply same Telephone
2. Lessee's name and address Scarborough Telephone
3. Contractor's name and address George H. Stanford 191 Spruwick Rd. Telephone 799-0411
4. Architect Specifications Plans yes No. of sheets 2
Proposed use of building office No. families
Last use No. families
Material No. stories Heat Style of roof Roofing
Other buildings on same lot
Estimated contractual cost \$ 9500 Fee \$ 40

FIELD INSPECTOR—Mr. Cartwright GENERAL DESCRIPTION

This application is for: Cartwright @ 775-5451
Dwelling Ext. 234 To construct on right hand side of existing bldg as per plans
Garage
Masonry Bldg.
Metal Bldg.
Alterations
Demolitions
Change of Use
Other

PERMIT ISSUED WITH LETTER

NOTE TO APPLICANT: Separate permits are required by the installers and subcontractors of heating, plumbing, electrical and mechanicals.

PERMIT IS TO BE ISSUED TO 1 [ ] 2 [ ] 3 [ ] 4 [ ] Other: .....

DETAILS OF NEW WORK

Is any plumbing involved in this work? Is any electrical work involved in this work?
Is connection to be made to public sewer? If not, what is proposed for sewage?
Has septic tank notice been sent? Form notice sent?
Height average grade to top of plate Height average grade to highest point of roof
Size, front depth No. stories solid or filled land? earth or rock?
Material of foundation Thickness, top bottom cellar
Kind of roof Rise per foot Roof covering
No. of chimneys Material of chimneys of lining Kind of heat fuel
Framing Lumber—Kind Dressed or full size? Corner posts Sills
Size Girder Columns under girders Size Max. on centers
Studs (outside walls and carrying partitions) 2x4-16" O. C. Bridging in every floor and flat roof span over 8 feet.
Joists and rafters: 1st floor, 2nd, 3rd, roof
On centers: 1st floor, 2nd, 3rd, roof
Maximum span: 1st floor, 2nd, 3rd, roof
If one story building with masonry walls, thickness of walls? height?

IF A GARAGE

No. cars now accommodated on same lot, to be accommodated number commercial cars to be accommodated
Will automobile repairing be done other than minor repairs to cars habitually stored in the proposed building?

APPROVALS BY: DATE MISCELLANEOUS
BUILDING INSPECTION—PLAN EXAMINER Will work require disturbing of any tree on a public street?
ZONING: C.P.H. N.G.C. 5/14/74
BUILDING CODE: E.S.S. n.v.s. Will there be in charge of the above work a person competent to see that the State and City requirements pertaining thereto are observed? yes
Others: George H. Stanford

Signature of Applicant, George H. Stanford, Jr. Phone # 799-0411
Type Name of above 1 [ ] 2 [ ] 3 [ ] 4 [ ]

FIELD INSPECTOR'S COPY

Other and Address

NOTES

7-8-74 Poured without FORM INSPN  
GAVE OK TO BACK FILL RAY R  
7-22-74 Platform framing started  
8-27-74 OK to close in SD  
10-10-74 Completed SD

Permit No. 74/546  
Location 527 DANFORTH ST  
Owner PORTLAND WEIZOUR SUPPLY  
Date of permit 7/17/74  
Approved

Molson

poor outside  
conc. steps SD

CITY OF PORTLAND, MAINE  
 Application for Permit to Install Wires

Permit No. 2158  
 Issued 9/3/74  
 Portland, Maine , 19

To the City Electrician, Portland, Maine:

The undersigned hereby applies for a permit to install wires for the purpose of conducting electric current, in accordance with the laws of Maine, the Electrical Ordinance of the City of Portland, and the following specifications:

#2501

(This form must be completely filled out - Minimum Fee, \$1.00) 827 DANFORTH

Owner's Name and Address PORTLAND WELDING SUPPLY Tel. 772-3746  
 Contractor's Name and Address CLAYTON E. SKILLINGS, JR Tel. 799-5807  
 Location 527 DANFORTH Use of Building OFFICE  
 Number of Families \_\_\_\_\_ Apartments \_\_\_\_\_ Stores \_\_\_\_\_ Number of Stories \_\_\_\_\_  
 Description of Wiring: New Work  Additions \_\_\_\_\_ Alterations \_\_\_\_\_  
 Pipe \_\_\_\_\_ Cable \_\_\_\_\_ Metal Molding \_\_\_\_\_ BX Cable \_\_\_\_\_ Plug Molding (No. of feet) 30  
 No. Light Outlets \_\_\_\_\_ Plugs 30 Light Circuits \_\_\_\_\_ Plug Circuits \_\_\_\_\_  
 FIXTURES: No. \_\_\_\_\_ Fluor. or Strip Lighting (No. feet) 30  
 SERVICE: Pipe \_\_\_\_\_ Cable \_\_\_\_\_ Underground \_\_\_\_\_ No. of Wires \_\_\_\_\_ Size \_\_\_\_\_  
 METERS: Relocated \_\_\_\_\_ Added \_\_\_\_\_ Total No. Meters \_\_\_\_\_  
 MOTORS: Number \_\_\_\_\_ Phase \_\_\_\_\_ H. P. \_\_\_\_\_ Amps \_\_\_\_\_ Volts \_\_\_\_\_ Starter \_\_\_\_\_  
 HEATING UNITS: Domestic (Oil) \_\_\_\_\_ No. Motors \_\_\_\_\_ Phase \_\_\_\_\_ H.P. \_\_\_\_\_  
 Commercial (Oil) \_\_\_\_\_ No. Motors \_\_\_\_\_ Phase \_\_\_\_\_ H.P. \_\_\_\_\_  
 Electric Heat (No. of Rooms) \_\_\_\_\_  
 APPLIANCES: No. Ranges \_\_\_\_\_ Watts \_\_\_\_\_ Brand Feeds (Size and No.) \_\_\_\_\_  
 Elec. Heaters \_\_\_\_\_ Watts \_\_\_\_\_  
 Miscellaneous \_\_\_\_\_ Watts \_\_\_\_\_ Extra Cabinets or Panels \_\_\_\_\_  
 Transformers \_\_\_\_\_ Air Conditioners (No. Units)  Signs (No. Units) \_\_\_\_\_  
 Will commence \_\_\_\_\_ 19. Ready to cover in \_\_\_\_\_ 19. Inspection \_\_\_\_\_ 19  
 Amount of Fee \$ \_\_\_\_\_  
 Signed Clayton E. Skillings, Jr

*will call*

DO NOT WRITE BELOW THIS LINE

SERVICE \_\_\_\_\_ METER \_\_\_\_\_ GROUND \_\_\_\_\_  
 VISITS: 1 \_\_\_\_\_ 2 \_\_\_\_\_ 3 \_\_\_\_\_ 4 \_\_\_\_\_ 5 \_\_\_\_\_ 6 \_\_\_\_\_  
 7 \_\_\_\_\_ 8 \_\_\_\_\_ 9 \_\_\_\_\_ 10 \_\_\_\_\_ 11 \_\_\_\_\_ 12 \_\_\_\_\_

REMARKS:

*ok*

INSPECTED BY

*Libby*

(OVER)

CITY OF PORTLAND, MAINE  
PERMIT REQUIRED BY  
FIRE PREVENTION CODE  
Chapter 321

No. 33

THIS IS GRANTED TO:

Name Portland Welding Supply  
Doing Business as same  
at 527 Danforth St.  
Portland, Maine

For

Containers for welding and cutting cases At Fee of \$ 5.00  
Subject to Limiting Conditions

Conformance to all provisions of Article 30 of the  
Fire Prevention Code.

This permit is granted subject to strict observance of all laws, ordinances and regulations enacted for the protection of the City so far as they may apply, and is to continue in force until Dec. 31, 1973, unless sooner revoked.

Issued by *R. Lowell Jewer*  
Director of Building & Inspection  
Services

Approved by *Joseph R. Ramo*  
Chief of Portland Fire Department

THIS PERMIT IS NOT TRANSFERABLE

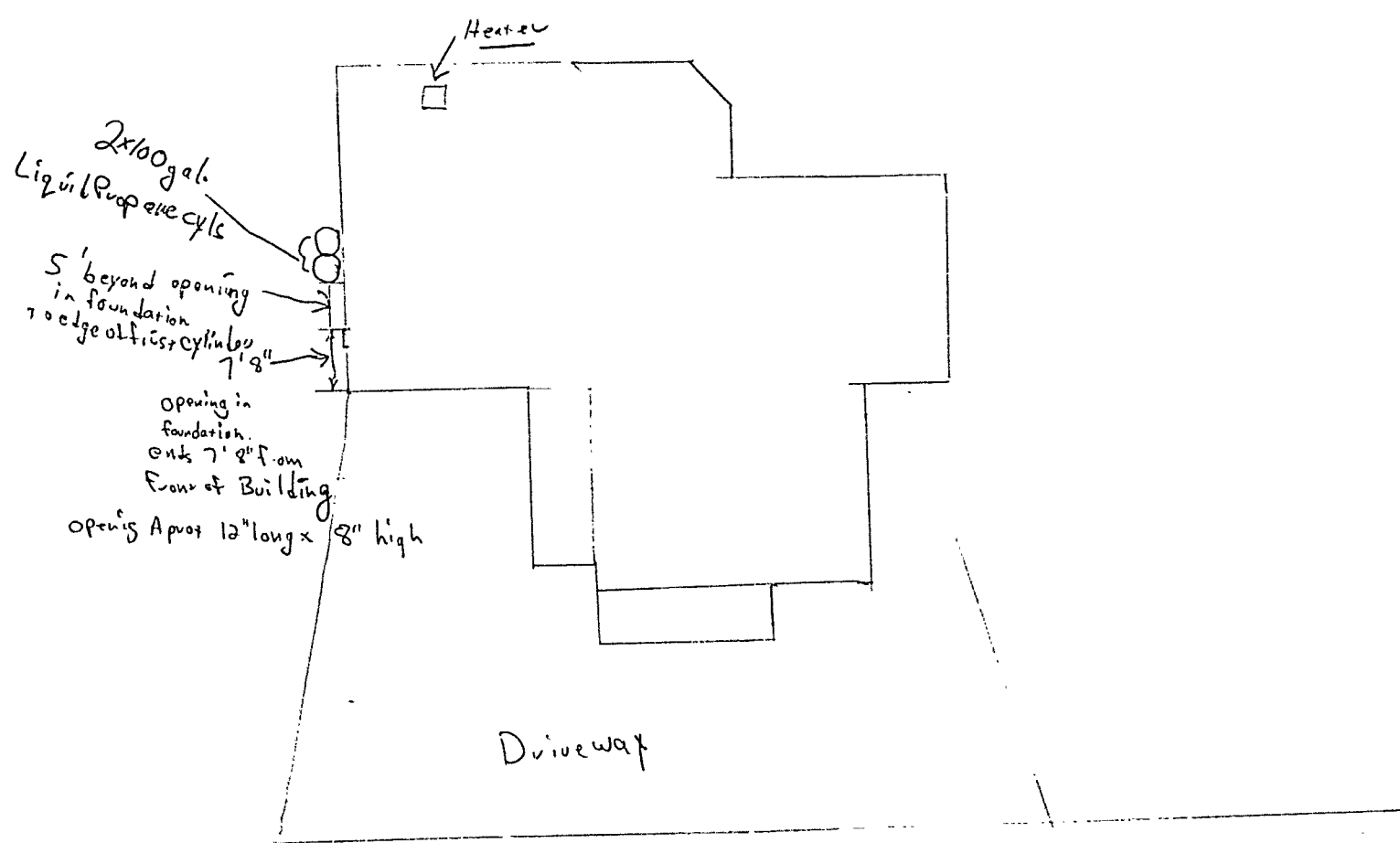

Danforth Street

Building located at 527 Danforth Street

ADDRESS 527 Vanport St  
1/4/74

ROUTING SLIP  
FROM

DEPARTMENT OF BUILDING AND INSPECTION SERVICES

- FIRE DEPARTMENT
- PLANNING BOARD
- RENEWAL
- MAINE WAY
- OTHERS

APPROVED

DISAPPROVED BY REASON OF

(quote section of pertinent ordinance or other governing factors)

SPECIAL COMMENTS \_\_\_\_\_  
\_\_\_\_\_

KEEP SECOND COPY AND RETURN ORIGINAL TO BUILDING AND INSPECTION SERVICES



ADDRESS 527 DANFORTH ST

1/4/74

ROUTING SLIP

FROM

DEPARTMENT OF BUILDING AND INSPECTION SERVICES

- FIRE DEPARTMENT
- PLANNING BOARD
- RENEWAL
- MAINE WAY
- OTHERS

APPROVED *of m. Planning FCB.*

DISAPPROVED BY REASON OF  
(quote section of pertinent ordinance or other governing factors)

SPECIAL COMMENTS

---

---

KEEP SECOND COPY AND RETURN ORIGINAL TO BUILDING AND INSPECTION SERVICES



APPLICATION FOR PERMIT

PERMIT ISSUED

B.O.C.A. USE GROUP .....

B.O.C.A. TYPE OF CONSTRUCTION .....

ZONING LOCATION PORTLAND, MAINE, January 4, 1974

JAN 10 1974

00034

CITY of PORTLAND

To the DIRECTOR OF BUILDING & INSPECTION SERVICES, PORTLAND, MAINE

The undersigned hereby applies for a permit to erect, alter, repair, demolish, move or install the following building, structure, equipment or change use in accordance with the Laws of the State of Maine, the Portland B.O.C.A. Building Code and Zoning Ordinance of the City of Portland with plans and specifications, if any, submitted herewith and the following specifications:

LOCATION 527 Danforth St Fire District #1 [ ], #2 [ ]
1. Owner's name and address C.&L. McDonald, same Telephone
2. Lessee's name and address Telephone
3. Contractor's name and address Biddeford-Saco Gas Co Telephone
4. Architect Specifications Plans No. of sheets
Proposed use of building welding supply company No. families
Last use No. families
Material frame No. stories Heat Style of roof Roofing
Other buildings on same lot
Estimated contractual cost \$ Fee \$6.00

FIELD INSPECTOR—Mr. Cartwright GENERAL DESCRIPTION

This application is for: @ 775-5451
Dwelling Ext. 234 to install 2 100 gal propane gas tanks per plan.
Garage
Masonry Bldg.
Metal Bldg. Stamp of Special Conditions
Alterations
Demolitions
Change of Use
Other

NOTE TO APPLICANT: Separate permits are required by the installers and subcontractors of heating, plumbing, electrical and mechanicals.

PERMIT IS TO BE ISSUED TO 1 [x] 2 [ ] 3 [ ] 4 [ ]
Other: .....

DETAILS OF NEW WORK

Is any plumbing involved in this work? Is any electrical work involved in this work?
Is connection to be made to public sewer? If not, what is proposed for sewage?
Has septic tank notice been sent? Form notice sent?
Height average grade to top of plate Height average grade to highest point of roof
Size, front depth No. stories solid or filled land? earth or rock?
Material of foundation Thickness, top bottom cellar
Kind of roof Rise per foot Roof covering
No. of chimneys Material of chimneys of lining Kind of heat fuel
Framing Lumber—Kind Dressed or full size? Corner posts Sills
Size Girder Columns under girders Size Max. on centers
Studs (outside walls and carrying partitions) 2x4-16" O. C. Bridging in every floor and flat roof span over 8 feet.
Joists and rafters: 1st floor, 2nd, 3rd, roof
On centers: 1st floor, 2nd, 3rd, roof
Maximum span: 1st floor, 2nd, 3rd, roof
If one story building with masonry walls, thickness of walls? height?

IF A GARAGE

No. cars now accommodated on same lot ... to be accommodated ... number commercial cars to be accommodated ...
Will automobile repairing be done other than minor repairs to cars habitually stored in the proposed building? .....

APPROVALS BY: N.F.C. DATE 1-10-74 MISCELLANEOUS
BUILDING INSPECTION—PLAN EXAMINER Will work require disturbing of any tree on a public street? ..
ZONING:
BUILDING CODE: Will there be in charge of the above work a person competent
Fire Dept. Wm. Hammond F.P.B. to see that the State and City requirements pertaining thereto
Health Dept.: are observed? yes
Others:

PORTLAND FIRE DEPT. Signature of Applicant Jane White Phone # 772-3746

REC'D. 1-7-74 Type Name of above 1 [ ] 2 [ ] 3 [ ] 4 [ ]

RETURNED 1-7-74 Other
FIELD INSPECTOR'S COPY and Address
BY C. Feigen

NOTES

REC'D

*[A large handwritten 'X' is drawn across the top section of the lined notes area.]*

Approved

Date of permit

1-11-74

Owner

C. J. McDonald

Location

527 W. 1st St.

Permit No.

74/34

*McLan*

*[Empty lined area for notes, with some faint, illegible markings.]*

*[Empty lined area for notes, with some faint, illegible markings.]*

REC'D

RECEIVED

RECEIVED



1-3 INDUSTRIAL HOME

### APPLICATION FOR PERMIT

PERMIT ISSUED

SEP 21 1972

01124  
CITY OF PORTLAND

Class of Building or Type of Structure \_\_\_\_\_  
Portland, Maine, Sept. 14, 1972

To the INSPECTOR OF BUILDINGS, PORTLAND, MAINE

The undersigned hereby applies for a permit to erect alter repair demolish install the following building structure equipment in accordance with the Laws of the State of Maine, the Building Code and Zoning Ordinance of the City of Portland, plans and specifications, if any, submitted herewith and the following specifications:

Location 527 Danforth St. Within Fire Limits? same Dist. No. \_\_\_\_\_  
 Owner's name and address Portland Welding Supply Telephone \_\_\_\_\_  
 Lessee's name and address \_\_\_\_\_ Telephone \_\_\_\_\_  
 Contractor's name and address George H. Stanford, Inc., 191 Spurwink Rd. Telephone 799-0411  
 Architect \_\_\_\_\_ Specifications \_\_\_\_\_ Plans \_\_\_\_\_ No. of sheets \_\_\_\_\_  
 Proposed use of building storage & Sales & Service No. families \_\_\_\_\_  
 Last use \_\_\_\_\_ No. families \_\_\_\_\_  
 Material \_\_\_\_\_ No. stories \_\_\_\_\_ Heat \_\_\_\_\_ Style of roof \_\_\_\_\_ Roofing \_\_\_\_\_  
 Other buildings on same lot \_\_\_\_\_  
 Estimated cost \$ 16,000. Fee \$ 48.

#### General Description of New Work

To construct addition on left rear of existing bldg, as per plans.

It is understood that this permit does not include installation of heating apparatus which is to be taken out separately by and in the name of the heating contractor. PERMIT TO BE ISSUED TO contractor

#### Details of New Work

Is any plumbing involved in this work? \_\_\_\_\_ Is any electrical work involved in this work? \_\_\_\_\_  
 Is connection to be made to public sewer? \_\_\_\_\_ If not, what is proposed for sewage? \_\_\_\_\_  
 Has septic tank notice been sent? \_\_\_\_\_ Form notice sent? \_\_\_\_\_  
 Height average grade to top of plate \_\_\_\_\_ Height average grade to highest point of roof \_\_\_\_\_  
 Size, front \_\_\_\_\_ depth \_\_\_\_\_ No. stories \_\_\_\_\_ solid or filled land? \_\_\_\_\_ earth or rock? \_\_\_\_\_  
 Material of foundation \_\_\_\_\_ Thickness, top \_\_\_\_\_ bottom \_\_\_\_\_ cellar \_\_\_\_\_  
 Kind of roof \_\_\_\_\_ Rise per foot \_\_\_\_\_ Roof covering \_\_\_\_\_  
 No. of chimneys \_\_\_\_\_ Material of chimneys \_\_\_\_\_ of lining \_\_\_\_\_ Kind of heat \_\_\_\_\_ fuel \_\_\_\_\_  
 Framing Lumber—Kind \_\_\_\_\_ Dressed or full size? \_\_\_\_\_ Corner posts \_\_\_\_\_ Sills \_\_\_\_\_  
 Size Girder \_\_\_\_\_ Columns under girders \_\_\_\_\_ Size \_\_\_\_\_ Max. on centers \_\_\_\_\_  
 Studs (outside walls and carrying partitions) 2x4-16" O. C. Bridging in every floor and flat roof span over 8 feet.  
 Joists and rafters: 1st floor \_\_\_\_\_, 2nd \_\_\_\_\_, 3rd \_\_\_\_\_, roof \_\_\_\_\_  
 On centers: 1st floor \_\_\_\_\_, 2nd \_\_\_\_\_, 3rd \_\_\_\_\_, roof \_\_\_\_\_  
 Maximum span: 1st floor \_\_\_\_\_, 2nd \_\_\_\_\_, 3rd \_\_\_\_\_, roof \_\_\_\_\_  
 If one story building with masonry walls, thickness of walls? \_\_\_\_\_ height? \_\_\_\_\_

#### If a Garage

No. cars now accommodated on same lot \_\_\_\_\_, to be accommodated \_\_\_\_\_ number commercial cars to be accommodated \_\_\_\_\_  
 Will automobile repairing be done other than minor repairs to cars habitually stored in the proposed building? \_\_\_\_\_

#### Miscellaneous

Will work require disturbing of any tree on a public street? \_\_\_\_\_  
 Will there be in charge of the above work a person competent to see that the State and City requirements pertaining thereto are observed? yes

George H. Stanford, Inc.

APPROVED:  
2009/21/72  
 \_\_\_\_\_  
 \_\_\_\_\_  
 \_\_\_\_\_

CS 301

INSPECTION COPY

Signature of owner

George H. Stanford, Inc.

NOTES

10-21-72 Work not started.

10-10-72 GAVE PERMISSION TO PLACE FOOTING, SEE NOTE ON PLOT PLAN. O.K. BY MR. BROWN.

10-19-72 GAVE PERMISSION TO PLACE FOUNDATION WALL.

11-27-72 Work going well.

12-15-72 FRAMMING STARTED

1-22-73 WORK GOING AS PER PLAN

2-20-73 WORK COMPLETE C.D.

X

X

Permit No. 731 1124  
 Location 527 Woodville St.  
 Owner Portland Welding Shop  
 Date of permit 9/21/72  
 Notif. closing-in  
 Inspn. closing-in  
 Final Notif.  
 Final Inspn.  
 Cert. of Occupancy issued  
 Staking Out Notice  
 Form Check Notice

**CITY OF PORTLAND, MAINE**  
**Application for Permit to Install Wires**

Permit No. 143  
 Issued  
 Portland, Maine January 5, 1922

To the City Electrician, Portland, Maine:

The undersigned hereby applies for a permit to install wires for the purpose of conducting electric current, in accordance with the laws of Maine, the Electrical Ordinance of the City of Portland, and the following specifications:

*(This form must be completely filled out — Minimum Fee, \$1.00)*

Owner's Name and Address PORTLAND WELDING CO., 527 BANGOR ST. Tel. ....

Contractor's Name and Address GEORGE H. STANFORD, INC. Tel. 797-0911

Location ..... Use of Building .....

Number of Families ..... Apartments ..... Stores ..... Number of Stories .....

Description of Wiring: New Work ..... Additions ..... Alterations .....

Pipe ..... Cable ..... Metal Molding ..... BX Cable ..... Plug Molding (No. of feet) .....

No. Light Outlets ..... Plugs ..... Light Circuits ..... Plug Circuits .....

FIXTURES: No. ..... Fluor. or Strip Lighting (No. feet) .....

SERVICE: Pipe ..... Cable ..... Underground ..... No. of Wires ..... Size 200 AMP DISCONNECT

METERS: Relocated  Added ..... Total No. Meters .....

MOTORS: Number ..... Phase ..... H. P. ..... Amps ..... Volts ..... Starter .....

HEATING UNITS: Domestic (Oil) ..... No. Motors ..... Phase ..... H.P. ....

Commercial (Oil) ..... No. Motors ..... Phase ..... H.P. ....

Electric Heat (No. of Rooms) .....

APPLIANCES: No. Ranges ..... Watts ..... Brand Feeds (Size and No.) .....

Elec. Heaters ..... Watts ..... Extra Cabinets or Panels .....

Miscellaneous ..... Watts ..... Signs (No. Units) .....

Transformers ..... Air Conditioners (No. Units) ..... 19 Inspection 19

Will commence 1-10 19 Ready to cover in 19

Amount of Fee \$ 1.00 Signed Clayton C. Stelling, Jr. 7.501

DO NOT WRITE BELOW THIS LINE

SERVICE	METER	GROUND
1	2	3
4	5	6
7	8	9
10	11	12

REMARKS: .....

INSPECTED BY [Signature] (OVER)

LOCATION Danforth St. 527  
 INSPECTION DATE 1/22/73  
 WORK COMPLETED 1/22/73  
 TOTAL NO. INSPECTIONS 1  
 REMARKS:

FEES FOR WIRING PERMITS EFFECTIVE JULY 31, 1963

WIRING

1 to 30 Outlets ..... \$ 2.00  
 31 to 60 Outlets ..... 3.00  
 Over 60 Outlets, each Outlet ..... .05  
 (Each twelve feet or fraction thereof of fluorescent lighting or  
 any type of plug molding will be classed as one outlet).

SERVICES

Single Phase ..... 2.00  
 Three Phase ..... 4.00

MOTORS

Not exceeding 50 H.P. .... 3.00  
 Over 50 H.P. .... 4.00

HEATING UNITS

Domestic (Oil) ..... 2.00  
 Commercial (Oil) ..... 4.00  
 Electric Heat (Each Room) ..... .75

APPLIANCES

Range, Cooking Tops, Oven, Water Heaters, Disposals, Built-in  
 Dishwashers, Dryers, and any permanent built-in appliance — each  
 unit

William M. Lunt III  
Custom Builder  
16 Lunt Road  
Falmouth, Maine 04105

sketch for putting a roof on storage dock at  
Portland Welding Supply :

Roof covering to be corrugated fiberglass sheeting.

Chain link fencing to be installed on the inside of the walls.

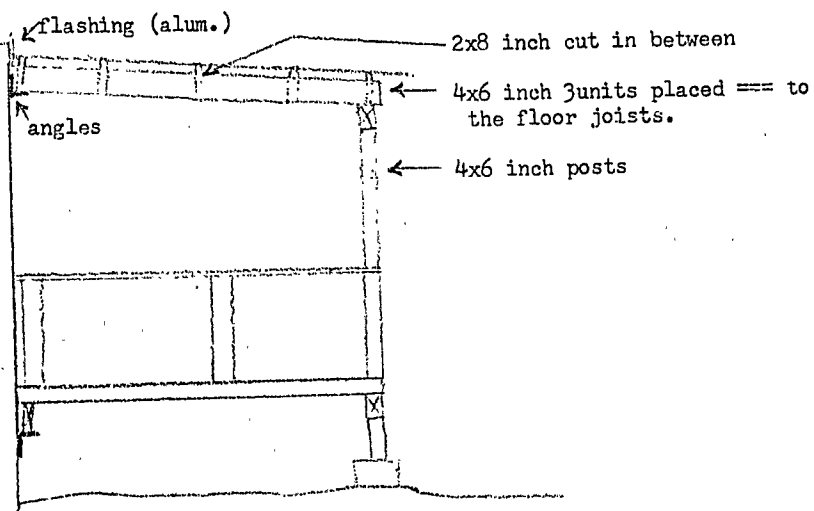

The \$800.00 on the first permit was to build the dock and the roof  
and not the Chain Link fencing, this will add about \$200.00 to the  
cost of the total job.





# APPLICATION FOR AMENDMENT TO PERMIT

Amendment No. 1  
Portland, Maine, Nov. 5, 1971

PERMIT ISSUED

NOV 16 1971

CITY OF PORTLAND

To the INSPECTOR OF BUILDINGS, PORTLAND, MAINE

The undersigned hereby applies for amendment to Permit No.                      pertaining to the building or structure comprised in the original application in accordance with the Laws of the State of Maine, the Building Code and Zoning Ordinance of the City of Portland, plans and specifications, if any, submitted herewith, and the following specifications:

Location 527 Danforth St. Within Fire Limits?                      Dist. No.                       
 Owner's name and address Portland Welding Supply Telephone                       
 Lessee's name and address                      Telephone                       
 Contractor's name and address William M. Lunt III, 16 Lunt Rd., Falmouth Telephone                       
 Architect                      Plans filed                      No. of sheets                       
 Proposed use of building storage dock No. families                       
 Last use " " No. families                       
 Increased cost of work \$200. Additional fee \$3.00

### Description of Proposed Work

To roof over existing storage dock, as per plan.  
Roof covering to be corrugated fiberglass sheeting.

### Details of New Work

*send to Wm Lunt III*

Is any plumbing involved in this work?                      Is any electrical work involved in this work?                       
 Height average grade to top of plate                      Height average grade to highest point of roof                       
 Size, front                      depth                      No. stories                      solid or filled land?                      earth or rock?                       
 Material of foundation                      Thickness, top                      bottom                      cellar                       
 Material of underpinning                      Height                      Thickness                       
 Kind of roof                      Rise per foot                      Roof covering                       
 No. of chimneys                      Material of chimneys                      of lining                       
 Framing lumber—Kind                      Dressed or full size?                       
 Corner posts                      Sills                      Girt or ledger board?                      Size                       
 Girders                      Size                      Columns under girders                      Size                      Max. on centers                       
 Studs (outside walls and carrying partitions) 2x4-16" O. C. Bridging in every floor and flat roof span over 8 feet.  
 Joists and rafters: 1st floor                     , 2nd                     , 3rd                     , roof                       
 On centers: 1st floor                     , 2nd                     , 3rd                     , roof                       
 Maximum span: 1st floor                     , 2nd                     , 3rd                     , roof                     

Approved:                     

Signature of Owner William M. Lunt III

Approved: [Signature] Inspector of Buildings

INSPECTION COPY  
CS-105

Portland Welding Supply  
537 Danforth Street  
Portland 772-3746

Loading and Storage  
for Propane Tanks

10 FT. x 30 FT. figured to hold up to 90  
full tanks weighing 115 lbs. each. This makes  
a total live load of 51.8 lbs per square foot  
and a dead load of 5 lbs per sq. ft.

Using a 16 inch center spacing this means  
a total load of 757 lbs per joist allowing  
the use of 2"x8" joists.

The 6"x8" will carry 3781 lbs uniform  
loading. With a 10'0" span the figured load would  
be 2840 lbs.

The 4"x8" will carry 4984 lbs at 5 ft span. With  
the figured load at 1420 lbs this is over sized.

The above figures are taken from Wood  
Structural Design Data. copyright 1957 by the  
National Lumber Manufacturers Association.

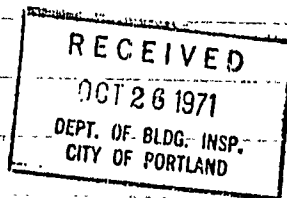



<sup>B</sup>  
I-3 INDUSTRIAL ZONE

### APPLICATION FOR PERMIT

Class of Building or Type of Structure \_\_\_\_\_

Portland, Maine, October 26, 1971

PERMIT ISSUED

OCT 27 1971

1337

CITY OF PORTLAND

To the INSPECTOR OF BUILDINGS, PORTLAND, MAINE

The undersigned hereby applies for a permit to erect alter repair demolish install the following building structure equipment in accordance with the Laws of the State of Maine, the Building Code and Zoning Ordinance of the City of Portland, plans and specifications, if any, submitted herewith and the following specifications:

Location 527 Danforth Street Within Fire Limits? \_\_\_\_\_ Dist. No. \_\_\_\_\_  
 Owner's name and address Portland Welding Supply, 527 Danforth St. Telephone \_\_\_\_\_  
 Lessee's name and address \_\_\_\_\_ Telephone \_\_\_\_\_  
 Contractor's name and address William Lunt, 16 Lunt Rd., Falmouth Telephone 781-3514  
 Architect \_\_\_\_\_ Specifications \_\_\_\_\_ Plans yes No. of sheets 1  
 Proposed use of building Warehouse and office No. families \_\_\_\_\_  
 Last use \_\_\_\_\_ " \_\_\_\_\_ No. families \_\_\_\_\_  
 Material \_\_\_\_\_ No. stories \_\_\_\_\_ Heat \_\_\_\_\_ Style of roof \_\_\_\_\_ Roofing \_\_\_\_\_  
 Other buildings on same lot \_\_\_\_\_ Fee \$ 5.00  
 Estimated cost \$ 800.

#### General Description of New Work

To construct 20'x10' loading dock on side of building as per plan (for propane tanks)

It is understood that this permit does not include installation of heating apparatus which is to be taken out separately by and in the name of the heating contractor. **PERMIT TO BE ISSUED TO** contractor

#### Details of New Work

Is any plumbing involved in this work? \_\_\_\_\_ Is any electrical work involved in this work? \_\_\_\_\_  
 Is connection to be made to public sewer? \_\_\_\_\_ If not, what is proposed for sewage? \_\_\_\_\_  
 Has septic tank notice been sent? \_\_\_\_\_ Form notice sent? \_\_\_\_\_  
 Height average grade to top of plate \_\_\_\_\_ Height average grade to highest point of roof \_\_\_\_\_  
 Size, front \_\_\_\_\_ depth \_\_\_\_\_ No. stories \_\_\_\_\_ solid or filled land? \_\_\_\_\_ earth or rock? \_\_\_\_\_  
 Material of foundation \_\_\_\_\_ Thickness, top \_\_\_\_\_ bottom \_\_\_\_\_ cellar \_\_\_\_\_  
 Kind of roof \_\_\_\_\_ Rise per foot \_\_\_\_\_ Roof covering \_\_\_\_\_  
 No. of chimneys \_\_\_\_\_ Material of chimneys \_\_\_\_\_ of lining \_\_\_\_\_ Kind of heat \_\_\_\_\_ fuel \_\_\_\_\_  
 Framing Lumber—Kind \_\_\_\_\_ Dressed or full size? \_\_\_\_\_ Corner posts \_\_\_\_\_ Sills \_\_\_\_\_  
 Size Girder \_\_\_\_\_ Columns under girders \_\_\_\_\_ Size \_\_\_\_\_ Max. on centers \_\_\_\_\_  
 Studs (outside walls and carrying partitions) 2x4-16" O. C. Bridging in every floor and flat roof span over 8 feet.

Joists and rafters: 1st floor \_\_\_\_\_, 2nd \_\_\_\_\_, 3rd \_\_\_\_\_, roof \_\_\_\_\_  
 On centers: 1st floor \_\_\_\_\_, 2nd \_\_\_\_\_, 3rd \_\_\_\_\_, roof \_\_\_\_\_  
 Maximum span: 1st floor \_\_\_\_\_, 2nd \_\_\_\_\_, 3rd \_\_\_\_\_, roof \_\_\_\_\_

If one story building with masonry walls, thickness of walls? \_\_\_\_\_ height? \_\_\_\_\_

#### If a Garage

No. cars now accommodated on same lot \_\_\_\_\_, to be accommodated \_\_\_\_\_ number commercial cars to be accommodated \_\_\_\_\_  
 Will automobile repairing be done other than minor repairs to cars habitually stored in the proposed building? \_\_\_\_\_

APPROVED:

O.K. E.S. 10/27/71

#### Miscellaneous

Will work require disturbing of any tree on a public street? \_\_\_\_\_  
 Will there be in charge of the above work a person competent to see that the State and City requirements pertaining hereto are observed? yes  
 Portland Welding Supply

CS 301

INSPECTION COPY

Signature of owner

By: William M. Lunt

NOTES

11-1-71  
SONOTUBES IN GROUND  
ONE AT 4'-0" BELOW GRADE  
ONE AT 21'-0" ONE AT 3'-0"

*[Signature]*

11-3-71  
SONOTUBES 2' 10" 10" 10"  
GRADE DOWN, RESTING ON  
7" CONCRETE SLAB.

11-16-71 *[Signature]*  
Final Inspect. in place  
and ok!

11-22-71 Same as above

11-29-71 *[Signature]*

12-8-71 Same *[Signature]*

12-15-71 WORK COMPLETE  
AS PER PLAN. *[Signature]*

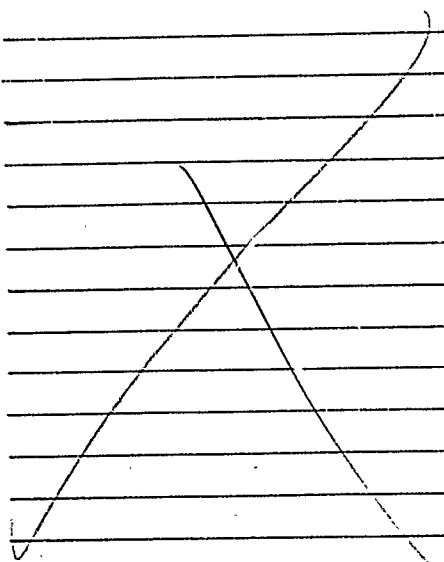

Permit No.	71/1337
Location	587 Mansfield St.
Owner	Portland Milling Corp.
Date of permit	10/27/71
Notif. closing-in	
Inspn. closing-in	
Final Notif.	
Final Inspn.	
Cert. of Occupancy issued	
Building Certificate	S.A.M.
Form Check Notice	

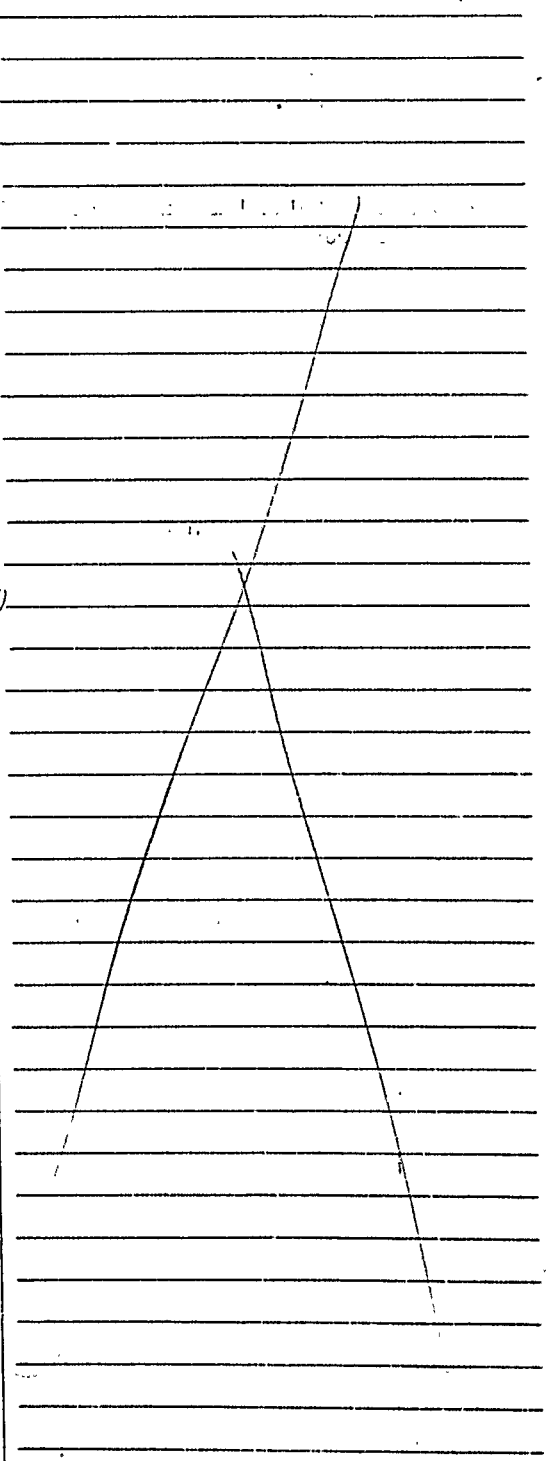



APPLICATION FOR AMENDMENT TO PERMIT

Amendment No. 1

Portland, Maine, Nov. 5, 1971

PERMIT ISSUED

NOV 16 1971

CITY OF PORTLAND

To the INSPECTOR OF BUILDINGS, PORTLAND, MAINE

The undersigned hereby applies for amendment to Permit No. ... pertaining to the building or structure comprised in the original application in accordance with the Laws of the State of Maine, the Building Code and Zoning Ordinance of the City of Portland, plans and specifications, if any, submitted herewith, and the following specifications:

Location ... 527 Danforth St. ... Within Fire Limits? ... Dist. No. ...
Owner's name and address ... Portland Welding Supply ... Telephone ...
Lessee's name and address ...
Contractor's name and address ... William M. Lunt III, 16 Lunt Rd., Falmouth ... Telephone ...
Architect ... Plans filed ... No. of sheets ...
Proposed use of building ... storage dock ... No. families ...
Last use ... " " ... No. families ...
Increased cost of work ... \$200. ... Additional fee ... \$3.00

Description of Proposed Work

To roof over existing storage dock, as per plan.
Roof covering to be corrugated fiberglass sheeting.

Details of New Work

Is any plumbing involved in this work? ... Is any electrical work involved in this work? ...
Height average grade to top of plate ... Height average grade to highest point of roof ...
Size, front ... depth ... No. stories ... solid or filled land? ... earth or rock? ...
Material of foundation ... Thickness, top ... bottom ... cellar ...
Material of underpinning ... Height ... Thickness ...
Kind of roof ... Rise per foot ... Roof covering ...
No. of chimneys ... Material of chimneys ... of lining ...
Framing lumber—Kind ... Dressed or full size? ...
Corner posts ... Sills ... Girt or ledger board? ... Size ...
Girders ... Size ... Columns under girders ... Size ... Max. on center ...
Studs (outside walls and carrying partitions) 2x4-10" O. C. Bridging in every floor and flat roof span over 8 feet.
Joists and rafters: 1st floor ... , 2nd ... , 3rd ... , roof ...
On centers: 1st floor ... , 2nd ... , 3rd ... , roof ...
Maximum span: 1st floor ... , 2nd ... , 3rd ... , roof ...

Approved:

Signature of Owner ... William M. Lunt III

Approved:

Inspector of Buildings

FILE COPY
CS-106

**CITY OF PORTLAND, MAINE**  
**Application for Permit to Install Wires**

Permit No. 9/14/70  
 District 54281

Portland, Maine

To the City Electrician, Portland, Maine:

The undersigned hereby applies for a permit to install wires for the purpose of conducting electric current, in accordance with the laws of Maine, the Electrical Ordinance of the City of Portland, and the following specifications:

(This form must be completely filled out - Minimum Fee \$1.00)

Owner's Name and Address PORT. WIRE SUPPLY Tel. \_\_\_\_\_  
 Contractor's Name and Address ES, BOWEN CO. Tel. 775-3256  
 Location 527 DAWFORTH Use of Building COMMERCIAL  
 Number of Families \_\_\_\_\_ Apartments \_\_\_\_\_ Stores \_\_\_\_\_ Number of Stories 1  
 Description of Wiring: New Work \_\_\_\_\_ Additions \_\_\_\_\_ Alterations \_\_\_\_\_

Pipe \_\_\_\_\_ Cable \_\_\_\_\_ Metal Molding \_\_\_\_\_ BX Cable \_\_\_\_\_ Plug Molding (No. of feet) \_\_\_\_\_

No. Light Outlets \_\_\_\_\_ Plugs \_\_\_\_\_ Light Circuits \_\_\_\_\_ Plug Circuits \_\_\_\_\_

FIXTURES: No. \_\_\_\_\_ Fluor. or Strip Lighting (No. feet) \_\_\_\_\_

SERVICE: Pipe  Cable \_\_\_\_\_ Underground \_\_\_\_\_ No. of Wires 3 Size 7/8

METERS: Relocated \_\_\_\_\_ Added \_\_\_\_\_ Total No. Meters \_\_\_\_\_

MOTORS: Number \_\_\_\_\_ Phase \_\_\_\_\_ H. P. \_\_\_\_\_ Amps \_\_\_\_\_ Volts \_\_\_\_\_ Starter \_\_\_\_\_

HEATING UNITS: Domestic (Oil) \_\_\_\_\_ No. Motors \_\_\_\_\_ Phase \_\_\_\_\_ H.P. \_\_\_\_\_

Commercial (Oil) \_\_\_\_\_ No. Motors \_\_\_\_\_ Phase \_\_\_\_\_ H.P. \_\_\_\_\_

Electric Heat (No. of Rooms) \_\_\_\_\_

APPLIANCES: No. Ranges \_\_\_\_\_ Watts \_\_\_\_\_ Brand Feeds (Size and No.) \_\_\_\_\_

Flec. Heaters \_\_\_\_\_ Watts \_\_\_\_\_

Miscellaneous \_\_\_\_\_ Watts \_\_\_\_\_ Extra Cabinets or Panels \_\_\_\_\_

Transformers \_\_\_\_\_ Air Conditioners (No. Units) \_\_\_\_\_ Signs (No. Units) \_\_\_\_\_

Will commence \_\_\_\_\_ 19 \_\_\_\_\_ Ready to cover in \_\_\_\_\_ 19 \_\_\_\_\_ Inspection \_\_\_\_\_

Amount of Fee \$ 2.00

Signed Albert J. Rodman Jr.

DO NOT WRITE BELOW THIS LINE

SERVICE	METER		GROUND		
VISITS: 1	2	3	4	5	6
7	8	9	10	11	12

REMARKS:

... P.R. 9/24/70 INSPECTED BY Joe Ak... (OVER)  
NR 10/8/70

LOCATION DANFORTH ST 527  
 INSPECTION DATE 12/16/70  
 WORK COMPLETED 12/16/70  
 TOTAL NO. INSPECTIONS 1  
 REMARKS:

FEE SCHEDULE FOR WIRING PERMITS EFFECTIVE JULY 31, 1968

WIRING

1 to 30 Outlets ..... \$ 2.00  
 31 to 60 Outlets ..... 3.00  
 Over 60 Outlets, each Outlet ..... .05  
 (Each twelve feet or fraction thereof of fluorescent lighting or  
 any type of plug molding will be classed as one outlet).

SERVICES

Single Phase ..... 2.00  
 Three Phase ..... 4.00

MOTORS

Not exceeding 50 H.P. .... 3.00  
 Over 50 H.P. .... 4.00

HEATING UNITS

Domestic (Oil) ..... 2.00  
 Commercial (Oil) ..... 4.00  
 Electric Heat (Each Room) ..... .75

APPLIANCES

Ranges, Cooking Tops, Ovens, Water Heaters, Disposals, Built-in  
 Dishwashers, Dryers, and any permanent built-in appliance — each  
 unit ..... 1.50

MISCELLANEOUS

Temporary Service, Single Phase ..... 1.00  
 Temporary Service, Three Phase ..... 2.00  
 Circuses, Carnivals, Fairs, etc. .... 10.00  
 Meters, relocate ..... 1.00  
 Distribution Cabinet or Panel, per unit ..... 1.00  
 Transformers, per unit ..... 2.00  
 Air Conditioners, per unit ..... 2.00  
 Signs, per unit ..... 2.00

ADDITIONS

5 Outlets, or less ..... 1.00  
 Over 5 Outlets, Regular Wiring Rates

**CITY OF PORTLAND, MAINE**  
**Application for Permit to Install Wires**

Permit No. 56674  
 Issued 3/18/68

Portland, Maine ..... 19.....

To the City Electrician, Portland, Maine:

The undersigned hereby applies for a permit to install wires for the purpose of conducting electric current, in accordance with the laws of Maine, the Electrical Ordinance of the City of Portland, and the following specifications:

*(This form must be completely filled out — Minimum Fee, \$1.00)*

Owner's Name and Address PORTLAND WELDING SUPPLY Tel. ....

Contractor's Name and Address GEO. H. STANFORD Tel. 739-0411

Location 527 DANFORTH Use of Building OFFICE

Number of Families ..... Apartments ..... Stores ..... Number of Stories 1

Description of Wiring: New Work ..... Additions X ..... Alterations .....

Pipe ..... Cable ..... Metal Molding ..... BX Cable ..... Plug Molding (No. of feet) 30

No. Light Outlets ..... Plugs ..... Light Circuits ..... Plug Circuits .....

FIXTURES: No. .... Light Switches 4 .... Fluor. or Strip Lighting (No. feet) 32

SERVICE: Pipe ..... Cable ..... Underground ..... No. of Wires ..... Size .....

METERS: Relocated ..... Added ..... Total No. Meters .....

MOTORS: Number ..... Phase ..... H. P. .... Amps ..... Volts ..... Starter .....

HEATING UNITS: Domestic (Oil) ..... No. Motors ..... Phase ..... H.P. ....

Commercial (Oil) ..... No. Motors ..... Phase ..... H.P. ....

Electric Heat (No. of Rooms) .....

APPLIANCES: No. Ranges ..... Watts ..... Brand Feeds (Size and No.) .....

Elec. Heaters ..... Watts .....

Miscellaneous ..... Watts ..... Extra Cabinets or Panels .....

Transformers ..... Air Conditioners (No. Units) ..... Signs (No. Units) .....

Will commence ..... 19..... Ready to cover in NR 19 1968 Inspection ..... 19.....

Amount of Fee \$ 2.00

Signed Clayton C. Shillingo

DO NOT WRITE BELOW THIS LINE

SERVICE ..... METER ..... GROUND .....

VISITS: 1 ..... 2 ..... 3 ..... 4 ..... 5 ..... 6 .....

..... 7 ..... 8 ..... 9 ..... 10 ..... 11 ..... 12 .....

REMARKS:

INSPECTED BY .....

(OVER)



PERMIT TO INSTALL PLUMBING

Date Issued **2/5/68**  
 Portland Plumbing Inspector  
 By **ERNOLD R. GOODWIN**

Address **527 Danforth Street** PERMIT NUMBER **19032**  
 Installation For: **Welding Supply**  
 Owner of Bldg: **Portland Welding Company**  
 Owner's Address: **527 Danforth Street**  
 Plumber: **Fred P. Miller, Jr.** Date: **2/5/68**

App. First Insp.  
 Date **2-5-68**  
 By **ERM**

App. Final Insp.  
 Date **FEB - 5 1968**  
 By **ERNOLD R. GOODWIN**

- TYPE OF BLDG:
- Commercial
  - Residential
  - Single
  - Multi Family
  - New Construction
  - Remodeling

NEW	REPL		NO	FEE
		SINKS		
		LAVATORIES		
		TOILETS		
		BATH TUBS		
		SHOWERS		
		DRAINS FLOOR SURFACE		
		HOT WATER TANKS		
		TANKLESS WATER HEATERS		
		GARBAGE DISPOSALS		
✓	1	SEPTIC TANKS	1	2.00
		HOUSE SEWERS		
		ROOF LEADERS		
		AUTOMATIC WASHERS		
		DISHWASHERS		
		OTHER		
			<b>TOTAL</b>	<b>2.00</b>

Building and Inspection Services Dept., Plumbing Inspection

*Ray*  
*E. J.*

AP - 527 Danforth St.

January 15, 1968

George H. Stanford, Inc.  
Box 278  
Scarborough, Maine

cc: Portland Welding Supply Co.  
527 Danforth Street

**Gentlemen:**

Permit to construct a one-story frame addition 18'x24' on side of existing building at the above named location is being issued subject to plans received with the application and in compliance with Building Code restrictions as follows:

1. If there are ever to be more than 20 people in the entire building at any one time then a rear exit door will be required with exit signs adequate in location to indicate the rear means of egress from the building and all doors involved in a means of egress are required to be equipped with at least a vestibule latchset.
2. Toilet room will need to be vented as required by the Plumbing Inspector.
3. Anchor bolts for the sillie will need to be spaced not more than six feet on centers instead of the eight feet shown on the plans. Anchor bolts will also be required at each corner.
4. The 4-2x10's making up the girder to carry the floor load will need to be at least fir members or graded fir 1500 F.B.I. on an 8-foot span.
5. The rear section which will be for light storage will need to be posted with signs allowing a storage capacity of not over 160 pounds per square foot are to be installed in conspicuous locations.
6. If partitions are to be installed then amendment to this permit will be needed or a permit will need to be applied for at a later date if this work is to be done.

Very truly yours,

Gerald E. Hayberry  
Director

*GH*



# APPLICATION FOR AMENDMENT TO PERMIT

Amendment No. #1  
Portland, Maine, March 18, 1968

RECEIVED  
MAR 19 1968  
CITY OF PORTLAND

To the INSPECTOR OF BUILDINGS, PORTLAND, MAINE

The undersigned hereby applies for amendment to Permit No. 68/42 pertaining to the building or structure comprised in the original application in accordance with the Laws of the State of Maine, the Building Code and Zoning Ordinance of the City of Portland, plans and specifications, if any, submitted herewith, and the following specifications:

Location 527 Danforth St. Within Fire Limits? Dist. No.  
Owner's name and address Portland Welding Supply Company, 527 Danforth St. Telephone  
Lessee's name and address Telephone  
Contractor's name and address George H. Stanford Inc. Box 278 Scarborough Me. Telephone 799-0411  
Architect Plans filed Yes No. of sheets  
Proposed use of building Welding Supplies & Office No. families  
Last use No. families  
Increased cost of work 200.00 Additional fee .50

### Description of Proposed Work

To erect (1) non-bearing partition (in new addition) for office space.  
2x4 studs 16" o.c. covered with 1/2" plywood.

*wp*  
*Stanford*

### Details of New Work permit to contractor

Is any plumbing involved in this work? Is any electrical work involved in this work?  
Height average grade to top of plate Height average grade to highest point of roof  
Size, front depth No. stories solid or filled land? earth or rock?  
Material of foundation Thickness, top bottom cellar  
Material of underpinning Height Thickness  
Kind of roof Rise per foot Roof covering  
No. of chimneys Material of chimneys of lining  
Framing lumber—Kind Dressed or full size?  
Girders Size Columns under girders Size Max. on centers  
Studs (outside walls and carrying partitions) 2x4-16" O. C. Bridging in every floor and flat roof span over 8 feet.  
Joists and rafters: 1st floor, 2nd, 3rd, roof  
On centers: 1st floor, 2nd, 3rd, roof  
Maximum span: 1st floor, 2nd, 3rd, roof

Approved: 3/19/68  
Portland Welding Supply Company  
George H. Stanford Inc.  
Signature of Owner by: *George H. Stanford*  
Approved: *G. Allen Paul*  
Inspector of Buildings

INSPECTION COPY

AP - 527 Danforth St.

January 15, 1968

George H. Stanford, Inc.  
Box 278  
Scarborough, Maine

cc: Portland Welding Supply Co.  
527 Danforth Street

Gentlemen:

Permit to construct a one-story frame addition 18'x24' on side of existing building at the above named location is being issued subject to plans received with the application and in compliance with Building Code restrictions as follows:

1. If there are ever to be more than 20 people in the entire building at any one time then a rear exit door will be required with exit signs adequate in location to indicate the rear means of egress from the building and all doors involved in a means of egress are required to be equipped with at least a vestibule latchset.
2. Toilet room will need to be vented as required by the Plumbing Inspector.
3. Anchor bolts for the sills will need to be spaced not more than six feet on centers instead of the eight feet shown on the plans. Anchor bolts will also be required at each corner.
4. The 4-2x10's making up the girder to carry the floor load will need to be at least fir members or graded for 1500 P.S.I. on an 8-foot span.
5. The rear section which will be for light storage will need to be posted with signs allowing a storage capacity of not over 160 pounds per square foot are to be installed in conspicuous locations.
6. If partitions are to be installed then amendment to this permit will be needed or a permit will need to be applied for at a later date if this work is to be done.

Very truly yours,

Gerald E. Mayberry  
Director

GEH/h



1-2 INDUSTRIAL ZONE

PERMIT ISSUED

JAN 15 1968

CITY OF PORTLAND

### APPLICATION FOR PERMIT

Class of Building or Type of Structure Second Class & Third Cl.

Portland, Maine, December 26 1967

To the INSPECTOR OF BUILDINGS, PORTLAND, MAINE

The undersigned hereby applies for a permit to erect alter repair demolish install the following building structure equipment in accordance with the Laws of the State of Maine, the Building Code and Zoning Ordinance of the City of Portland, plans and specifications, if any, submitted herewith and the following specifications:

Location 527 Danforth St. Within Fire Limits? Yes Dist. No. \_\_\_\_\_  
 Owner's name and address Portland Welding Supply Company, 527 Danforth St. Telephone \_\_\_\_\_  
 Lessee's name and address \_\_\_\_\_ Telephone \_\_\_\_\_  
 Contractor's name and address George H Stanford Inc. Box 278 Scarborough Me. Telephone 799-0411  
 Architect \_\_\_\_\_ Specifications \_\_\_\_\_ Plans yes No. of sheets 1  
 Proposed use of building Welding Supplies & Office No. families \_\_\_\_\_  
 Last use \_\_\_\_\_ " " & Office No. families \_\_\_\_\_  
 Material \_\_\_\_\_ No. stories 1 Heat \_\_\_\_\_ Style of roof \_\_\_\_\_ Roofing \_\_\_\_\_  
 Other buildings on same lot \_\_\_\_\_  
 Estimated cost \$ 7500.00 Fee \$ 16.00

#### General Description of New Work

To construct 1-story frame addition 18' x 24' on side of building.

It is understood that this permit does not include installation of heating apparatus which is to be taken out separately by and in the name of the heating contractor. **PERMIT TO BE ISSUED TO** contractor

#### Details of New Work

Is any plumbing involved in this work? no Is any electrical work involved in this work? yes  
 Is connection to be made to public sewer? \_\_\_\_\_ If not, what is proposed for sewage? \_\_\_\_\_  
 Has septic tank notice been sent? \_\_\_\_\_ Form notice sent? yes  
 Height average grade to top of plate 12' Height average grade to highest point of roof 12'  
 Size, front 18' depth 24' No. stories 1 solid or filled land? solid earth or rock? earth  
 Material of foundation 8" concrete blocks with 10x24 footing Thickness, top \_\_\_\_\_ bottom \_\_\_\_\_ cellar \_\_\_\_\_  
 Kind of roof flat Rise per foot \_\_\_\_\_ Roof covering tar and gravel  
 No. of chimneys \_\_\_\_\_ Material of chimneys \_\_\_\_\_ of lining \_\_\_\_\_ Kind of heat \_\_\_\_\_ fuel \_\_\_\_\_  
 Framing Lumber—Kind hemlock Dressed or full size? dressed Corner posts 4x6 Sills 4x6  
 Size Girder \_\_\_\_\_ Columns under girders \_\_\_\_\_ Size \_\_\_\_\_ Max. on centers \_\_\_\_\_  
 Studs (outside walls and carrying partitions) 2x4-16" O.C. Bridging in every floor and flat roof span over 8 feet.  
 Joists and rafters: 1st floor 2x10 2nd \_\_\_\_\_ 3rd \_\_\_\_\_ roof 2x12d.f.  
 On centers: 1st floor 16" 2nd \_\_\_\_\_ 3rd \_\_\_\_\_ roof 16"  
 Maximum span: 1st floor 12' 2nd \_\_\_\_\_ 3rd \_\_\_\_\_ roof 18'  
 If one story building with masonry walls, thickness of walls? \_\_\_\_\_ height? \_\_\_\_\_

#### If a Garage

No. cars now accommodated on same lot \_\_\_\_\_, to be accommodated \_\_\_\_\_ number commercial cars to be accommodated \_\_\_\_\_  
 Will automobile repairing be done other than minor repairs to cars habitually stored in the proposed building? \_\_\_\_\_

APPROVED:

O.K. - 1/15/68 - Allen W. Little

#### Miscellaneous

Will work require disturbing of any tree on a public street? no  
 Will there be in charge of the above work a person competent to see that the State and City requirements pertaining thereto are observed? yes

Portland Welding Supply Company  
George H Stanford Inc.

CS 301

INSPECTION COPY

Signature of owner by:

by:

George H Stanford

gm

NOTES

1-16-68 - left work for time  
Municipal to call - P.M.

2-5-68 Footings for  
walls OK to pour

3-20-68 OK to close  
ins

X

Permit No. 68142

Location 537 Vandeventer St.

Owner Robert M. Baker, Appleton, Wis.

Date of permit 1/15/68

Notif. closing-in

Inspn. closing-in

Final Notif.

Final Inspn.

Cert. of Occupancy issued

Staking Out Notice

Form Check Notice



INDUSTRIAL SECTION  
**APPLICATION FOR PERMIT**

**PERMIT ISSUED**

00076

JAN 23 1956

CITY OF PORTLAND

Class of Building or Type of Structure.....

Portland, Maine, January 9, 1956

To the INSPECTOR OF BUILDINGS, PORTLAND, MAINE

The undersigned hereby applies for a permit to erect ~~alter or repair~~ the following building structure equipment in accordance with the Laws of the State of Maine, the Building Code and Zoning Ordinance of the City of Portland, plans and specifications, if any, submitted herewith and the following specifications:

Location..... 527 Danforth St..... Within Fire Limits?..... Dist. No.....  
 Owner's name and address..... The Portland Welding Co., 527 Danforth St..... Telephone.....  
 Lessee's name and address..... John Donnelley & Sons, 73 Main St..... Telephone.....  
 Contractor's name and address..... John Donnelley & Sons, 73 Main St., So. Portland..... Telephone.....  
 Architect..... Specifications..... Plans yes..... No. of sheets 2  
 Proposed use of building..... Business building..... No. families.....  
 Last use..... " "..... No. families.....  
 Material..... No. stories..... Heat..... Style of roof..... Roofing.....  
 Other building on same lot.....  
 Estimated cost \$..... Fee \$ 2.00

**General Description of New Work**

To erect roof sign 2 1/2' x 30' (oval in center 5'6" x 9') as per plan  
Masonite face, steel frame

It is understood that this permit does not include installation of heating apparatus which is to be taken out separately by and in the name of the heating contractor. **PERMIT TO BE ISSUED TO** John Donnelley & Sons

**Details of New Work**

Is any plumbing involved in this work?..... Is any electrical work involved in this work?.....  
 Is connection to be made to public sewer?..... If not, what is proposed for sewage?.....  
 Has septic tank notice been sent?..... Form notice sent?.....  
 Height average grade to top of plate..... Height average grade to highest point of roof.....  
 Size, front..... depth..... No. stories..... solid or filled land?..... earth or rock?.....  
 Material of foundation..... Thickness, top..... bottom..... cellar.....  
 Material of underpinning..... Height..... Thickness.....  
 Kind of roof..... Rise per foot..... Roof covering.....  
 No. of chimneys..... Material of chimneys..... of lining..... Kind of heat..... fuel.....  
 Framing lumber—Kind..... Dressed or full size?.....  
 Corner posts..... Sills..... Girt or ledger board?..... Size.....  
 Girders..... Size..... Columns under girders..... Size..... Max. on centers.....  
 Studs (outside walls and carrying partitions) 2x4-16" O. C. Bridging in every floor and flat roof span over 8 feet.  
 Joists and rafters: 1st floor....., 2nd....., 3rd....., roof.....  
 On centers: 1st floor....., 2nd....., 3rd....., roof.....  
 Maximum span: 1st floor....., 2nd....., 3rd....., roof.....  
 If one story building with masonry walls, thickness of walls?..... height?.....

**If a Garage**

No. cars now accommodated on same lot....., to be accommodated..... number commercial cars to be accommodated.....  
Will automobile repairing be done other than minor repairs to cars habitually stored in the proposed building?.....

APPROVED:

**Miscellaneous**

Will work require disturbing of any tree on a public street? no  
Will there be in charge of the above work a person competent to see that the State and City requirements pertaining thereto are observed? yes

John Donnelley & Sons

*John J. Donnelley*

Signature of owner By:

INSPECTION COPY

C16-254-1M-Marks

*NTS*

NOTES

1-27-56 Not started RP

2-14-56 Not finished RP

3-5-56 " " RP

3-23-56 " " RP

4-12-56 Portland Welding

phonad. Donnalloy Co.

Mr. Helbride reports

still no steel shortage. RP

4/13/56 Mr. Zwahlen

of Donnalloy's

phone and said

again they could

not start. Would

have that we should

expect sign to be

completed by 4/15/56

He said he would

get right after that

and let us know

when completed. RP

4-20-56 Completed RP

~~XXXXXX~~

~~XXXXXX~~

~~XXXXXX~~

~~XXXXXX~~

Permit No.	56/76
Location	527 Grandville Rd
Owner	Portland Welding Co.
Date of permit	4/23/56
Notif. closing-in	
Insp. closing-in	
Final Notif.	
Final Insp.	
Cert. of Occupancy issued	
Staking Out Notice	
Form Check Notice	

2-23

INSPECTOR SIGNATURE AREA





FILL IN AND SIGN WITH INK

**APPLICATION FOR PERMIT FOR  
HEATING, COOKING OR POWER EQUIPMENT**

Portland, Maine, Nov. 15, 1955

To the INSPECTOR OF BUILDINGS, PORTLAND, ME.

The undersigned hereby applies for a permit to install the following heating, cooking or power equipment in accordance with the Laws of Maine, the Building Code of the City of Portland, and the following specifications:

Location 527 Danforth St. Use of Building Wording supplies No. Stories  New Building  
Name and address of owner of appliance Portland Welding Supply Co., 1 Lincoln St., So. Portland  
Installer's name and address Herbert W. Horn, 276 ~~Lincoln St.~~ Harvard St. Telephone 2-8114

**General Description of Work**

To install forced hot water heating system and oil burning equipment

**IF HEATER, OR POWER BOILER**

Location of appliance workshop Any burnable material in floor surface or beneath?  No  
If so, how protected? Kind of fuel? oil  
Minimum distance to burnable material, from top of appliance or casing top of furnace 3 1/2'  
From top of smoke pipe 4' From front of appliance over 4' From sides or back of appliance over 3' 15\*\*  
Size of chimney flue 8 1/2 x 13 Other connections to same flue none  
If gas fired, how vented? Rated maximum demand per hour  
Will sufficient fresh air be supplied to the appliance to insure proper and safe combustion?  yes

**IF OIL BURNER**

Name and type of burner Quiet Heat Labelled by Underwriters' Laboratories?  yes  
Will operator be always in attendance? Does oil supply line feed from top or bottom of tank? bottom  
Type of floor beneath burner concrete Size of vent pipe 1 1/2"  
Location of oil storage outside aboveground Number and capacity of tanks 1-275 gal.  
Low water shut off Make No.  
Will all tanks be more than five feet from any flame?  yes How many tanks etc. listed?  
Total capacity of any existing storage tanks for furnace burners

**IF COOKING APPLIANCE**

Location of appliance Any burnable material in floor surface or beneath?  
If so, how protected? Height of legs, if any  
Skirting at bottom of appliance? Distance to combustible material from top of appliance?  
From front of appliance From sides and back From top of smoke pipe  
Size of chimney flue Other connections to same flue  
Is hood to be provided? If so, how vented? Forced or gravity?  
If gas fired, how vented? Rated maximum demand per hour

**MISCELLANEOUS EQUIPMENT OR SPECIAL INFORMATION**

\*Wall in back of furnace will be covered with asbestosboard.  
...Tank will set on 4" reinforced concrete slab.

Amount of fee enclosed? 2.00 (\$2.00 for one heater, etc. 30 cents additional for each additional heater, etc. in same building at same time.)

APPROVED:  
11-17-55 H.W.C.  
*Herbert W. Horn*

Will there be in charge of the above work a person competent to see that the State and City requirements pertaining thereto are observed?  yes

Portland Welding Supply Co.

Signature of installer: *Herbert W. Horn*

INSPECTION COPY

617-2511

NOTES

1	Year of Installation	11-29-55
2	Year of Purchase	
3	Kind of Structure	0. Green oak floor
4	Barren	
5	Name of Club	12-29-55 Compacter
6	Street	
7	City	
8	State	
9	County	
10	Parcel No.	
11	Map No.	
12	Block No.	
13	Lot No.	
14	Other	
15	Remarks	

Permit No. 55/2159  
 Location 527 Randolph St.  
 Owner C. Howard Williams & W. C.  
 Date of Permit 11/18/56  
 Approved [Signature]

16		
17		
18		
19		
20		
21		
22		
23		
24		
25		
26		
27		
28		
29		
30		
31		
32		
33		
34		
35		
36		
37		
38		
39		
40		
41		
42		
43		
44		
45		
46		
47		
48		
49		
50		

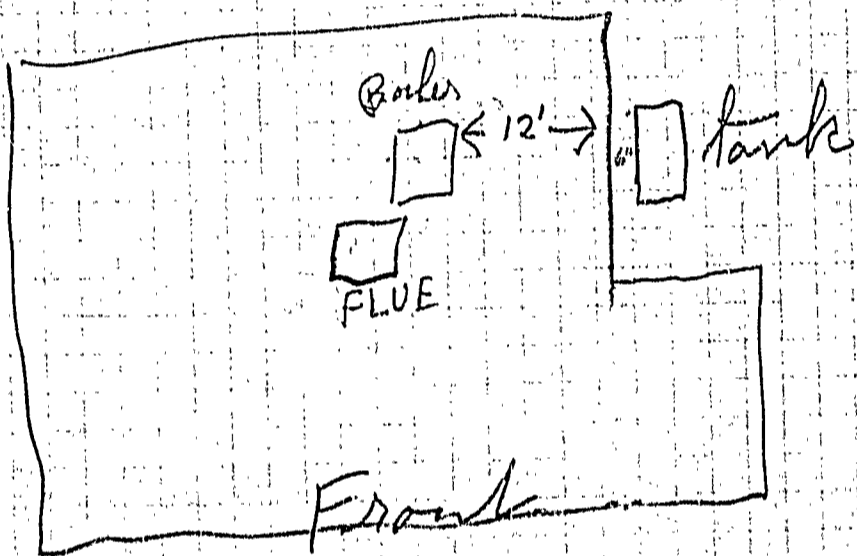

Portland Welding Supply  
527 Danforth St.



# APPLICATION FOR PERMIT

Class of Building or Type of Structure.....

Portland, Maine, June 27, 1955

PERMIT ISSUED  
00981  
JUN 27 1955  
CITY OF PORTLAND

To the INSPECTOR OF BUILDINGS, PORTLAND, MAINE

The undersigned hereby applies for a permit to ~~erect~~ <sup>remove</sup> ~~alter~~ ~~repair~~ ~~construct~~ ~~install~~ the following ~~building~~ ~~work~~ ~~equipment~~ in accordance with the Laws of the State of Maine, the Building Code and Zoning Ordinance of the City of Portland, plans and specifications, if any, submitted herewith and the following specifications:

Location ..... 527 Danforth St. .... Within Fire Limits?  NO ..... Dist. No. ....  
 Owner's name and address ..... Esso Standard Oil Co., Lincoln St., So. Portland Telephone .....  
 Lessee's name and address ..... Telephone .....  
 Contractor's name and address Portland Pump Co., 321 Lincoln St., So. Portland Telephone .....  
 Architect ..... Specifications ..... Plans no. .... No. of sheets .....  
 Proposed use of building ..... No. families .....  
 Last use ..... service station ..... No. families .....  
 Material ..... No. stories ..... Heat ..... Style of roof ..... Roofing .....  
 Other building on same lot .....  
 Estimated cost \$ ..... Fee \$ 1.00 .....

### General Description of New Work

To remove 1-4000 gallon and 2-2000 gallon gasoline storage tanks.

CERTIFICATE OF OCCUPANCY  
REQUIREMENT IS WAIVED

It is understood that this permit does not include installation of heating apparatus which is to be taken out separately by and in the name of the heating contractor. PERMIT TO BE ISSUED TO Portland Pump Co.

### Details of New Work

Is any plumbing involved in this work? ..... Is any electrical work involved in this work? .....  
 Is connection to be made to public sewer? ..... If not, what is proposed for sewage? .....  
 Has septic tank notice been sent? ..... Form notice sent? .....  
 Height average grade to top of plate ..... Height average grade to highest point of roof .....  
 Size, front ..... depth ..... No. stories ..... solid or filled land? ..... earth or rock? .....  
 Material of foundation ..... Thickness, top ..... bottom ..... cellar .....  
 Material of underpinning ..... Height ..... Thickness .....  
 Kind of roof ..... Rise per foot ..... Roof covering .....  
 No. of chimneys ..... Material of chimneys ..... of lining ..... Kind of heat ..... fuel .....  
 Framing lumber--Kind ..... Dressed or full size? .....  
 Corner posts ..... Sills ..... Girt or ledger board? ..... Size .....  
 Girders ..... Size ..... Columns under girders ..... Size ..... Max. on centers .....  
 Studs (outside walls and carrying partitions) 2x4-10" O. C. Bridging in every floor and flat roof span over 8 feet.  
 Joists and rafters: 1st floor ..... 2nd ..... 3rd ..... roof .....  
 On centers: 1st floor ..... 2nd ..... 3rd ..... roof .....  
 Maximum span: 1st floor ..... 2nd ..... 3rd ..... roof .....  
 If one story building with masonry walls, thickness of walls? ..... height? .....

### If a Garage

No. cars now accommodated on same lot....., to be accommodated..... number commercial cars to be accommodated.....  
 Will automobile repairing be done other than minor repairs to cars habitually stored in the proposed building? .....

APPROVED:

### Miscellaneous

Will work require disturbing of any tree on a public street?  NO ..  
 Will there be in charge of the above work a person competent to see that the State and City requirements pertaining thereto are observed?  YES .....

Esso Standard Oil Co.  
Portland Pump Co.

Signature of owner by:

Portland Pump Co. *L. G. Wilson*

INSPECTION COPY

C16-234-114-Maine