

75 ST. JOHN STREET

Mr. Ray Adams

29 Cliff Ave.

Cape Elizabeth, ME

Fire at 75 St. John St.

Dear Sir

On May 4, 1981, a fire occurred in the building listed above of which you are reported to be the owner.

If permanent repair work is required to this building, you must obtain a permit from the Building & Inspection Department in Cape Elizabeth before starting such work.

Sincerely Yours,

Chief of Fire Department

cc: Building & Inspection Department
Corporation Council
Health Department (Housing Div.)
City Assessor's (Mr. Lucci)
Heat from floodlight ignited cartons and scorched wooden frame



APPLICATION FOR PERMIT

0736

PERMIT ISSUED

SEP 11 1978

A.O.C.A. USE GROUP
B.O.C.A. TYPE OF CONSTRUCTION
ZONING LOCATION 1-2 PORTLAND, MAINE, 9-11-78

CITY OF PORTLAND

To the DIRECTOR OF BUILDING & INSPECTION SERVICES, PORTLAND, MAINE

The undersigned hereby applies for a permit to erect, alter, repair, demolish, move or install the following building, structure, equipment or change use in accordance with the Laws of the State of Maine, the Portland B.O.C.A. Building Code and Zoning Ordinance of the City of Portland with plans and specifications, if any, submitted herewith and the following specifications:

LOCATION 75 St. John Street Fire District #1 ☐ #2 ☐
1. Owner's name and address Colonial Supply Corp. - same Telephone 774-6191
2. Lessee's name and address same Telephone same
3. Contractor's name and address Malia Const. Co., 3 Simmons Rd., S.P. Telephone 799-4590
4. Architect same Specifications same Plans same No. of sheets 1
Proposed use of building Enclosing load platform No. families same
Material same No. stories same Heat same Style of roof same Roofing same
Other buildings on same lot same Fee \$ 12.00
Estimated contractual cost \$ 2,500

FIELD INSPECTOR—Mr. [Name] GENERAL DESCRIPTION

This application is for: @ 775-5451 Ext. 234 To Enclose loading platform with 6 inch block concrete walls, 20x60.
Dwelling ☐
Garage ☐
Masonry bldg. ☐
Metal Bldg. ☐
Alterations ☐
Demolitions ☐
Change of Use ☐
Other ☐

NOTE TO APPLICANT: Separate permits are required by the installers and subcontractors of heating, plumbing, electrical and mechanicals.

PERMIT IS TO BE ISSUED TO 1 ☐ 2 ☐ 3 ☒ 4 ☐
Other: ☐

DETAILS OF NEW WORK

Is any plumbing involved in this work? ☐ Is any electrical work involved in this work? ☐
Is connection to be made to public sewer? ☐ If not, what is proposed for sewage? ☐
Has septic tank notice been sent? ☐ Form notice sent? ☐
Height average grade to top of plate ☐ Height average grade to highest point of roof ☐
Size, front ☐ depth ☐ No. stories ☐ solid or filled land? ☐ earth or rock? ☐
Material of foundation ☐ Thickness, top ☐ bottom ☐ cellar ☐
Kind of roof ☐ Rise per foot ☐ Roof covering ☐
No. of chimneys ☐ Material of chimneys ☐ of lining ☐ Kind of heat ☐ fuel ☐
Framing lumber— Kind ☐ Dressed or full size? ☐ Corner posts ☐ Sills ☐
Size Girder ☐ Columns under girders ☐ Size ☐ Max. on centers ☐
Studs (outside walls and carrying partitions) 2x4-16" O.C. Bridging in every floor and flat roof span over ☐ feet.
Joists and rafters: 1st floor ☐ 2nd ☐ 3rd ☐ roof ☐
On centers: 1st floor ☐ 2nd ☐ 3rd ☐ roof ☐
Maximum span: 1st floor ☐ 2nd ☐ 3rd ☐ height? ☐
If one story building with masonry walls, thickness of walls? ☐

IF A GARAGE

No. cars now accommodated on same lot ☐ to be accommodated ☐ number commercial cars to be accommodated ☐
Will automobile repairing be done other than minor repairs to cars habitually stored in the proposed building? ☐

APPROVALS BY:

BUILDING INSPECTION—PLAN EXAMINER ☐
ZONING: ☐
BUILDING CODE: ☐
Fire Dept.: ☐
Health Dept.: ☐
Others: ☐

DATE

MISCELLANEOUS

Will work require disturbing of any tree on a public street? ☐
Will there be in charge of the above work a person competent to see that the State and City requirements pertaining thereto are observed? ☐

Signature of Applicant James Malia Phone # ☐
Type Name of above James Malia 1 ☐ 2 ☐ 3 ☒ 4 ☐
Other ☐
and Address ☐

FIELD INSPECTOR'S COPY

NOTES

9-18-78 Spent day in K - 9

9-21-78 went to K - 9

Permit No.	98/0786
Location	2501 Johnson Rd
Owner	Edward Murphy Corp
Date of permit	9-11-78
Approved	9-11-78



APPLICATION FOR PERMIT

B.O.C.A. USE GROUP

B.O.C.A. TYPE OF CONSTRUCTION

ZONING LOCATION I-2 PORTLAND, MAINE, 9, 1977

PERMIT ISSUED

MAY 13 1977

CITY of PORTLAND

To the DIRECTOR OF BUILDING & INSPECTION SERVICES, PORTLAND, MAINE

The undersigned hereby applies for a permit to erect, alter, repair, demolish, move or install the following building, structure, equipment or change use in accordance with the Laws of the State of Maine, the Portland B.O.C.A. Building Code and Zoning Ordinance of the City of Portland with plans and specifications, if any, submitted herewith and the following specifications:

LOCATION 75 St. John St. Fire District #1 ☐ #2 ☐
1. Owner's name and address Colonial Supply Corp. - same Telephone 774-6191
2. Lessee's name and address _____ Telephone _____
3. Contractor's name and address Malia Constr. Co. - 63 Simmons Rd. So. Portland, Me. Telephone 799-4590
4. Architect _____ Specifications _____ Plans _____ No. of sheets _____
Proposed use of building loading platform - plumbing supply warehouse No. families _____
Last use _____ No. families _____
Material _____ No. stories _____ Heat _____ Style of roof _____ Roofing _____
Other buildings on same lot _____
Estimated contractual cost \$ 24,000 Fee \$ 96.00

FIELD INSPECTOR—Mr. _____ GENERAL DESCRIPTION

This application is for. @ 775-5451

Dwelling _____ Ext. 234

Garage _____

Masonry Bldg. _____

Metal Bldg. _____

Alterations _____

Demolitions _____

Change of Use _____

Other plumbing warehouse supply

Permit to construct loading platform to be connected to existing bldg. adding barjoise and 2nd floor to bldg. as per plans. 3 sheets of plans. Stamp of Special Conditions

NOTE TO APPLICANT: Separate permits are required by the installers and subcontractors of heating, plumbing, electrical and mechanicals.

PERMIT IS TO BE ISSUED TO 1 ☐ 2 ☐ 3 ☒ 4 ☐

Other: _____

DETAILS OF NEW WORK

Is any plumbing involved in this work? _____ Is any electrical work involved in this work? _____
Is a connection to be made to public sewer? _____ If not, what is proposed for sewage? _____
Has a septic tank notice been sent? _____ Form notice sent? _____
Height average grade to top of plate _____ Height average grade to highest point of roof _____
Size, front _____ depth _____ No. stories _____ solid or filled land? _____ earth or rock? _____
Material of foundation _____ Thickness, top _____ bottom _____ cellar _____
Kind of roof _____ Rise per foot _____ Roof covering _____
No. of chimneys _____ Material of chimneys _____ of lining _____ Kind of heat _____ fuel _____
Fire _____ Kind _____ Dressed or full size? _____ Corner posts _____ Sills _____
Size _____ Columns under girders _____ Size _____ Max. on centers _____
Studs (outside walls and carrying partitions) 2x4-16" O. C. Bridging in every floor and flat roof span over 8 feet.
Joists and rafters: 1st floor _____, 2nd _____, 3rd _____, roof _____
On centers: 1st floor _____, 2nd _____, 3rd _____, roof _____
Maximum span: 1st floor _____, 2nd _____, 3rd _____, roof _____
If one story building with masonry walls, thickness of walls? _____ height? _____

IF A GARAGE

No. cars now accommodated on same lot _____, to be accommodated _____ number commercial cars to be accommodated _____
Will automobile repairing be done other than minor repairs to cars habitually stored in the proposed building? _____

APPROVALS BY

DATE

BUILDING INSPECTION—PLAN EXAMINER

ZONING: OK M.A.W. 5/12/77

BUILDING CODE: OK 5/12/77

Fire Dept.: _____

Health Dept.: _____

Others: _____

MISCELLANEOUS

Will work require disturbing of any tree on a public street? ..

Will there be in charge of the above work a person competent to see that the State and City requirements pertaining thereto are observed? ..

Signature of Applicant James Malia Phone # same

Type Name of above James Malia 1 ☐ 2 ☐ 3 ☒ 4 ☐

Other _____
and Address _____

FIELD INSPECTOR'S COPY

NOTES

5-23-77 work not started yet - in S
6-20-77 started pouring - 1st floor of - in S
6-29-77 has steel & roof trusses up - getting ready
to pour floor - in S
7-11-77 floor poured & roof completed - in S

Permit No. 77/0320
Location 24th Street & P
Owner Chas. L. Long & Sons
Date of permit 5-9-77
Approved 5-13-77
City Engineer

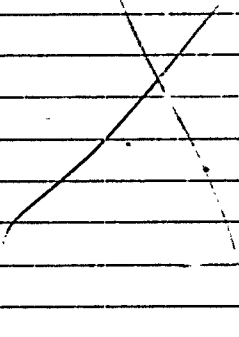



APPLICATION FOR PERMIT
DEPARTMENT OF BUILDING INSPECTIONS SERVICES
ELECTRICAL INSTALLATIONS

Date Jan. 26, 1977
Receipt and Permit number AA00165

To the CHIEF ELECTRICAL INSPECTOR, Portland, Maine:

The undersigned hereby applies for a permit to make electrical installations in accordance with the laws of Maine, the Portland Electrical Ordinance, the National Electrical Code and the following specifications:

LOCATION OF WORK: 75 St. John St.
OWNER'S NAME: Barber Foods ADDRESS: same

OUTLETS: (number of)
Lights _____
Receptacles 50 _____ FEES
Switches _____ 5.00
Plugmold _____ (number of feet) 17.00
TOTAL 180 fixtures _____

FIXTURES: (number of)
Incandescent _____
Fluorescent _____ (Do not include strip fluorescent)
TOTAL _____
Strip Fluorescent, in feet _____

SERVICES:
Permanent, total amperes _____
Temporary _____

METERS: (number of) _____

MOTORS: (number of)
Fractional _____ 2.00
1 HP or over 8 _____

RESIDENTIAL HEATING:
Oil or Gas (number of units) _____
Electric (number of rooms) _____

COMMERCIAL OR INDUSTRIAL HEATING:
Oil or Gas (by a main boiler) _____
Oil or Gas (by separate units) _____
Electric (total number of kw) _____

APPLIANCES: (number of)
Ranges _____ Water Heaters _____
Cook Tops _____ Disposals _____
Wall Ovens _____ Dishwashers _____
Dryers _____ Compactors _____
Fans _____ Others (denote) _____
TOTAL _____

MISCELLANEOUS: (number of)
Branch Panels _____
Transformers _____ 5.00
Air Conditioners 1 _____ 2.50
Signs 1 _____
Fire/Burglar Alarms _____
Circus, Fairs, etc. _____
Alterations to wires _____
Repairs after fire _____
Heavy Duty, 220v outlets _____
Emergency Lights, battery _____
Emergency Generators _____

INSTALLATION FEE DUE: 37.50

FOR ADDITIONAL WORK NOT ON ORIGINAL PERMIT DOUBLE FEE DUE: _____

FOR REMOVAL OF A "STOP ORDER" (304-16.b) _____

FOR PERFORMING WORK WITHOUT A PERMIT (304-9) 37.50

TOTAL AMOUNT DUE: 37.50

INSPECTION:
Will be ready on now, 19____, or Will Call _____

CONTRACTOR'S NAME: Associated Elec.
ADDRESS: 119 Holmes Rd. Scarborough
TEL.: 883-5461

MASTER LICENSE NO.: 2472 SIGNATURE OF CONTRACTOR: _____

LIMITED LICENSE NO.: _____

OFFICE COPY

Colony 11
Rep. must obtain permit from Dept of Building Inspection. - Please do soon as possible
Franklin Park

FLAME RESISTANCE
By **Company** Date AUGUST 22, 1973
DIVISION
CHIEF
REGISTERED 117-04889 and
date covered by our order no. 44113
REET, CLEVELAND, OHIO 44113
test in accordance with specification

GRANITEVILLE COMPANY

PAUL L. WEINLE
Sherman Converse, Director of Research

"MARK ON THE SELVAGE"

"CERTIFICATE OF FLAME RESISTANCE" issued
by California State Fire Marshal.
The ASTRUP COMPANY
2937 WEST 25TH STREET
Address CLEVELAND, OHIO 44113
Signed by *John Fell*
JOHN FELL

CERTIFICATE OF FLAME RESISTANCE

Issued By



Graniteville Company

WOODHEAD DIVISION

Date AUGUST 22, 1973

APPROVED AND LISTED UNDER THE
RE-EXAMINATION SERVICE OF UNDER-
WRITERS' LABORATORIES — FILE R5117

FIRE CHIEF

TRADE MARK & REG. STEREO

This is to certify that the fabric described on the reverse side of this certificate, covered by our order no. 117-04889 and
customer's order no. 41098
FOR THE ASTRUP COMPANY, 2937 WEST 25TH STREET, CLEVELAND, OHIO 44113
Was finished on 5-15-73 with our GALA Fire Chief in accordance with specification —
DATE

FIRE C

(Weather Resistant Interior or Outdoor Use)
WILL BE CERTIFIED ON REQUEST, UNDER
CALIFORNIA LAW

REGISTERED
APPLICATION
CONCERN NO. A-196



GRANITEVILLE COMPANY

PAUL L. WEINLE

Sherman Co. Inc., Director of Research

LOOK FOR THE FIRE CHIEF TRADE MARK ON THE SELVAGE

We hereby certify this to be a true copy of the original "CERTIFICATE OF FLAME RESISTANCE" issued
to us, "original copy" of which has been filed with the California Fire Marshal.

The ASTRUP COMPANY
2937 WEST 25TH STREET
Address CLEVELAND, OHIO 44113

Signed by John Fell
JOHN FELL

[illegible]

Sep
9/18

Colonial
Supply

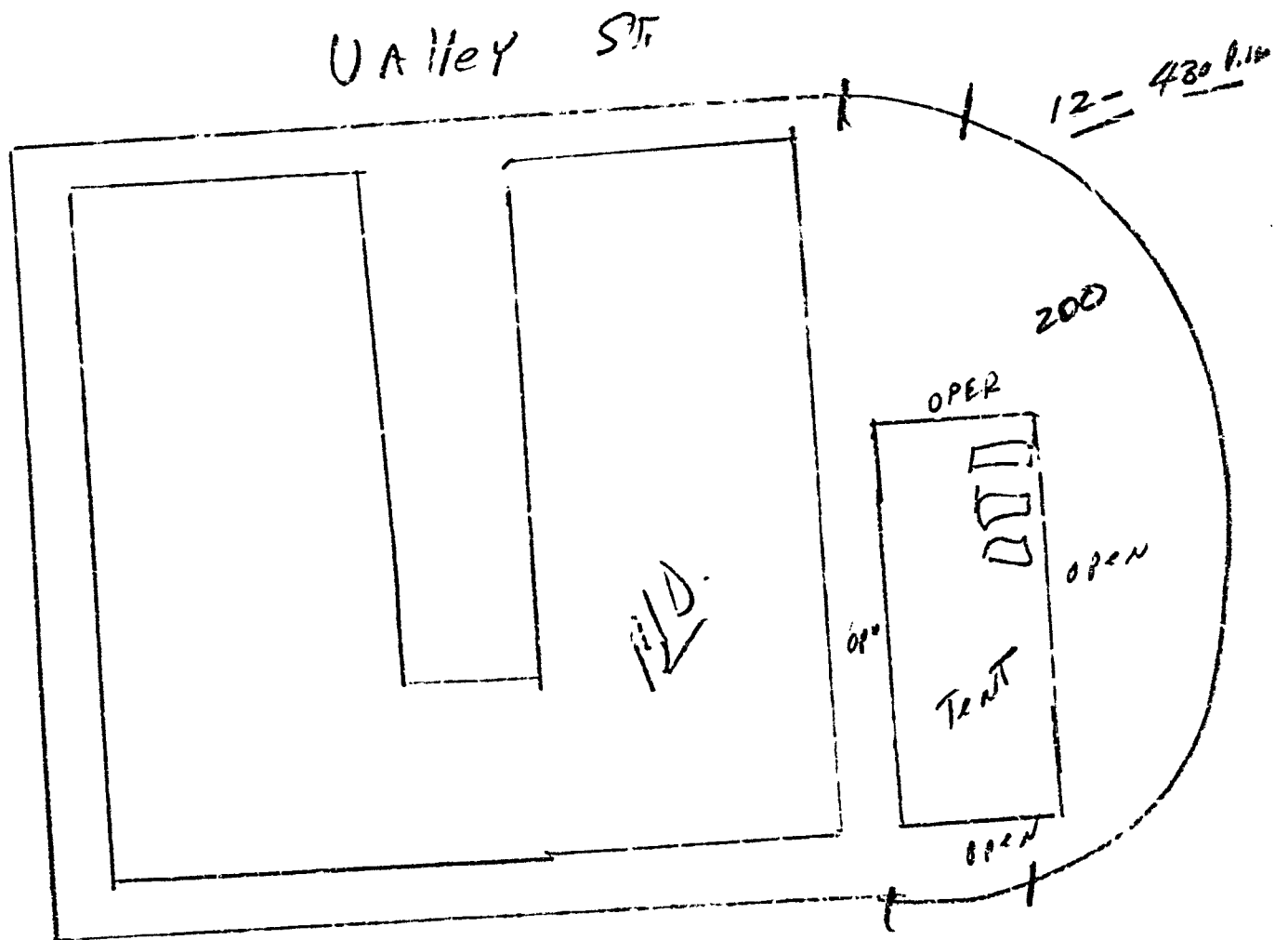

ST. John ST.

RECEIVED
SEP 1 1976
DEPT. OF BLDG. INSP
CITY OF PORTLAND



APPLICATION FOR PERMIT

B.O.C.A. USE GROUP

B.O.C.A. TYPE OF CONSTRUCTION

ZONING LOCATION PORTLAND, MAINE Sept. 1, 1976

PERMIT ISSUED

SEP 2 1976

6794
CITY of PORTLAND

To the DIRECTOR OF BUILDING & INSPECTION SERVICES, PORTLAND, MAINE

The undersigned hereby applies for a permit to erect, alter, repair, demolish, move or install the following building, structure, equipment or change use in accordance with the laws of the State of Maine, the Portland B.O.C.A. Building Code and Zoning Ordinance of the City of Portland with plans and specifications, if any, submitted herewith and the following specifications:

LOCATION 75 St. John St.

1. Owner's name and address Colonial Supply Co. same Fire District #1 ☐ #2 ☐
Telephone 774-6191
2. Lessee's name and address Leavitt & Parris - 230 Commercial St. Telephone
3. Contractor's name and address Telephone
4. Architect Specifications Plans No. of sheets
Proposed use of building tent No. families
Last use No. families
Material No. stories Heat Style of roof Roofing
Other buildings on same lot
Estimated contractual cost \$ Fee \$ 35.

FIELD INSPECTOR—Mr.

GENERAL DESCRIPTION

40' x 80'

This application is for:

@ 7' x 2'

To erect a tent for temporary use from
Sept. 17 to 21. For display and entertaining
(about 20 tables)

Stamp of Special Conditions

Dwelling Ext. 2'

Garage

Masonry Bldg.

Metal Bldg.

Alterations

Demolitions

Change of Use

Other

NOTE TO APPLICANT: Separate permits are required by the installers and subcontractors of heating, plumbing, electrical and mechanicals.

PERMIT IS TO BE ISSUED TO ☒ 1 ☐ 2 ☐ 3 ☐ 4

Other:

DETAILS OF NEW WORK

Is any plumbing involved in this work? Is any electrical work involved in this work?
Is connection to be made to public sewer? If not, what is proposed for ?
Has septic tank notice been sent? Form notice sent?
Height: average grade to top of plate Height average grade to highest point of roof
Size: front depth No. stories solid or filled earth or rock?
Material of foundation Thickness, top bottom cellar
Kind of roof Rise per foot Roof covering
No. of chimneys Material of chimneys of lining Kind of heat fuel
Framing Lumber—Kind Dressed or full size Corner posts Sills
Size Girder Columns under girders Size Max. on centers
Studs (outside walls and carrying partitions) 2x4-16" O. C. Bridging in every floor and flat roof span over 8 feet.
Joists and rafters: 1st floor 2nd 3rd roof
On centers: 1st floor 2nd 3rd roof
Maximum span: 1st floor 2nd 3rd roof
If one story building with masonry walls, thickness of walls? height?

IF A GARAGE

No. cars now accommodated on same lot , to be accommodated number cars to be accommodated
Will automobile repairing be done other than minor repairs to cars habitually stored in building?

APPROVALS BY:

DATE

PLAN NO.

BUILDING INSPECTION—PLAN EXAMINER

Will work require disturbing of any tree on a public street?

ZONING:

BUILDING CODE:

Will there be in charge of the above work a person competent to see that the State and City requirements pertaining thereto are observed? yes

Fire Dept.:

Health Dept.:

Others:

Signature of Applicant Ray Adams

Phone #

Type Name of above Ray Adams

1 ☐ 2 ☐ 3 ☐ 4 ☐

Other
and Address

FIELD INSPECTOR'S COPY

NOTES

1-22-76 tent down in S

Permit No. 16/194
Location 75 St John St
Owner Colonial Supply
Date of permit 9-2-76
Approved [Signature] 17th Nov 21/84



APPLICATION FOR PERMIT
DEPARTMENT OF BUILDING INSPECTIONS SERVICES
ELECTRICAL INSTALLATIONS

Date June 2, 1976, 19
Receipt and Permit number A 1886

To the CHIEF ELECTRICAL INSPECTOR, Portland, Maine.

The undersigned hereby applies for a permit to make electrical installations in accordance with the laws of Maine, the Portland Electrical Ordinance, the National Electrical Code and the following specifications:

LOCATION OF WORK: 75 St. John St.
OWNER'S NAME Colonial Supply ADDRESS: _____

OUTLETS: (number of)
Lights 12
Receptacles 12
Switches _____
Plugmold _____ (number of feet)
TOTAL 24 FEES 3.00

FIXTURES: (number of)
Incandescent _____
Fluorescent _____ (do not include strip fluorescent)
TOTAL _____
Strip Fluorescent, in feet _____

SERVICES:
Permanent, total amperes 400 6.00
Temporary _____

METERS: (number of) 1 .50

MOTORS: (number of)
Fractional _____
1 HP or over _____

RESIDENTIAL HEATING:
Oil or Gas (number of units) _____
Electric (number of rooms) _____

COMMERCIAL OR INDUSTRIAL HEATING:
Oil or Gas (by a main boiler) _____
Oil or Gas (by separate units) _____
Electric (total number of kws) _____

APPLIANCES: (number of)
Ranges _____ Water Heaters _____
Cook Tops _____ Disposals _____
Wall Ovens _____ Dishwashers _____
Dryers _____ Compactors _____
Fans _____ Others (denote) _____
TOTAL _____

MISCELLANEOUS: (number of)
E. Panels _____
Transformers _____
Air Condition _____
Signs _____
Fire/Burglar Alarms _____
Circus, Fairs, etc. _____
Alterations to wires _____
Repairs after fire _____
Heavy Duty, 220v outlets _____
Emergency Lights, battery _____
Emergency Generators _____

INSTALLATION FEE DUE: _____

FOR ADDITIONAL WORK NOT ON ORIGINAL PERMIT DOUBLE FEE DUE: _____

FOR REMOVAL OF A "STOP ORDER" (304-16.b) _____

FOR PERFORMING WORK WITHOUT A PERMIT (304-9) _____

TOTAL AMOUNT DUE: 9.50

INSPECTION:
Will be ready on _____, 19 ____; or Will Call ☒

CONTRACTOR'S NAME: Walsh Elec.
ADDRESS: 119 Four Winds Rd.
TEL.: _____

MASTER LICENSE NO.: 1740 SIGNATURE OF CONTRACTOR: [Signature]
LIMITED LICENSE NO.: _____

INSPECTOR'S COPY

Permit No. 10-10
 Location 11th Ave. S.
 Owner Edna E. Beck
 Date of Permit 10-27-76
 Final Inspection 9-27-76
 By Inspector Fieldy
 Permit Application Register Page No. 502

PROGRESS INSPECTIONS: D-11-76 _____, _____

CODE
COMPLIANCE
COMPLETED
DATE 9-27-76

DATE:

REMARKS:

REMARKS: Water from road bedded grt.

JK



FILL IN AND SIGN WITH INK

APPLICATION FOR PERMIT FOR
HEATING, COOKING OR POWER EQUIPMENT

Portland, Maine, 5/4/76

PERMIT ISSUED

MAY 6 1976

CITY of PORTLAND

To the INSPECTOR OF BUILDINGS PORTLAND, ME.

The undersigned hereby applies for a permit to install the following heating, cooking or power equipment in accordance with the Laws of Maine, the Building Code of the City of Portland, and the following specifications:

Location 75 St. John St. Use of Building supply No. Stories New Building
Name and address of owner of appliance Colonial Supply Existing "
Installer's name and address Breggy Oil 84 Congress St. Telephone 772-4531

General Description of Work

To install ~~new heating system~~ replace heating system

IF HEATER, OR POWER BOILER underground next to

Location of appliance outside under reproducible material in floor surface or beneath? no

If so, how protected Kind of fuel? #2

Minimum distance to burnable material, from top of appliance or casing top of furnace

From top of smoke pipe From front of appliance From sides or back of appliance

Size of chimney flue 10" Other connections to same flue

If gas fired, how vented? Rate, maximum demand per hour

Will sufficient fresh air be supplied to the appliance to insure proper and safe combustion?

IF OIL BURNER

Name and type of burner Armstrong Labelled by underwriters' laboratories? yes

Will operator be always in attendance? Does oil supply line feed from top or bottom of tank? top

Type of floor beneath burner Size of vent pipe 2"

Location of oil storage outside Number and capacity of tanks 1-4,000 gal

Low water shut off no Make No.

Will all tanks be more than five feet from any flame? Yes How many tanks enclosed?

Total capacity of any existing storage tanks for furnace burners 4,000

IF COOKING APPLIANCE

Location of appliance Any burnable material in floor surface or beneath?

If so, how protected? Height of Legs, if any

Skirting at bottom of appliance? Distance to combustible material from top of appliance?

From front of appliance From sides and back From top of smokepipe

Size of chimney flue Other connections to same flue

Is hood to be provided? If so, how vented? Forced or gravity?

If gas fired, how vented? Rated maximum demand per hour

MISCELLANEOUS EQUIPMENT OR SPECIAL INFORMATION

Amount of fee enclosed? 5.00

APPROVED:

O.K. E.A. 5/5/76

Will there be in charge of the above work a person competent to see that the State and City requirements pertaining thereto are observed? yes

CS 300

INSPECTION COPY

Signature of Installer

Completed *[Signature]*

NOTES

Permit No. 76/0348
Location 75.4th. John St.
Owner Richard H. Hefley
Date of permit 5/16/74
Approved _____

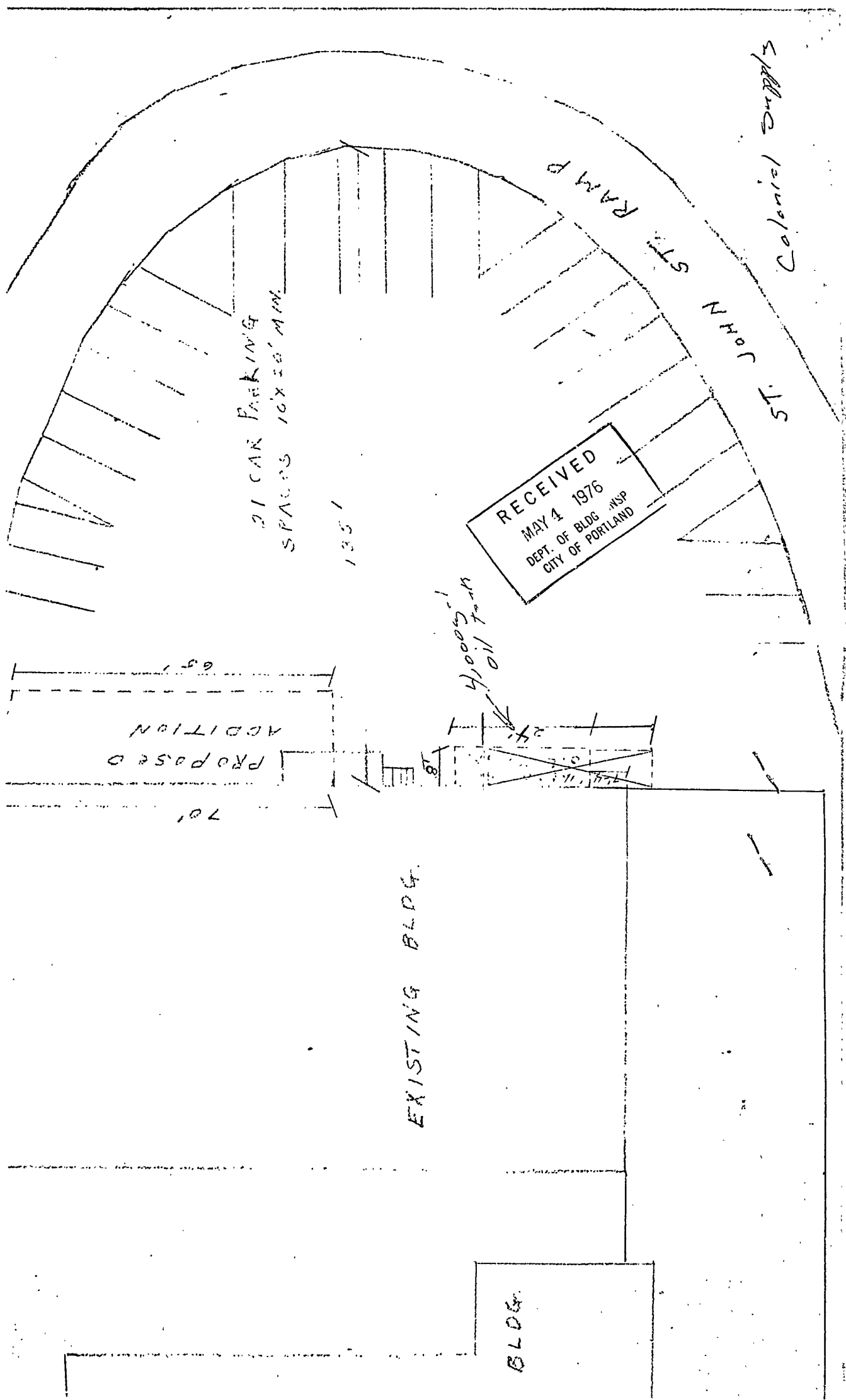

CITY OF PORTLAND, MAINE
FIRE DEPARTMENT



Clement O. Dodd
XXXXXXXXXXXXX
CHIEF

FIRE PREVENTION BUREAU
380 CONGRESS STREET
PORTLAND, MAINE

5 May 1976

To: Office of Building Inspection
Subj: Installation of 4000 gal underground tank at 75 St. John Street

Approved providing: Tank to bear approved label & painted with asphaltum. Tank to be anchored into pad. Piping to be provided with swivel type joints. Fire Prevention Bureau to be notified when pad and anchor bolts are ready and when piping is completed.

Display Area Colonial Supply
St. John St.

These plans (sheets) and the specifications
accompanying the same, covering construction
work on STEEL JOIST. F&I2.

Colonial Supply Addl.

have been designed and drawn up by the under-
signed according to the latest rules of
engineering practice and to comply with the
allowable working stresses, floor loads, etc.
in accordance with Sec. 113.7 & 702.1 of the
amendments to the Portland B.O.C.A. Building
Code.

(Signature)

By: William J. MEEHAN

This statement is to be signed by the individual
qualified and responsible for the design, and he
should indicate in the blank provided the
particular work to which the statement applies.

Section 113.7 (ENGINEERING DETAILS) is amended
by adding at the end thereof the following new
sentence:

"Where structural analysis is required, a
certificate of design shall be afforded
the Director of Building Inspections and
it shall be signed by the person qualified
for such design."

Section 702.1 (STRUCTURAL ANALYSIS) is amended
by adding at the end thereof the following new
sentence:

"All structural design computations and
all stress diagrams for trusses shall be
filed with the Inspector, if he deems it
necessary, upon application for a
building permit."

These plans (1 sheets) and specifications, covering construction work on Colonial Supply Co. Inc. Struct. Steel on Addition to Display Area, have been as far as drawn up by the undersigned and approved in latest rules of engineering practice and comply with the applicable building code, fire loads, etc., required by the Building Code of the City of New York.

MEMBER A.S.C.E. CORP.

By Clifford W. Tupper
Name and Title

This certification for furnishing one new lintel beam for a 16'-0" masonry opening in East wall of new addition. Beam will be W 8 x 24 + 8 x 4 bottom flange. End bearing to be 12" long.

Clifford W. Tupper
4/29/76



APPLICATION FOR PERMIT

B.O.C.A. USE GROUP 0324

B.O.C.A. TYPE OF CONSTRUCTION

ZONING LOCATION PORTLAND, MAINE, April 6, 1976.

PERMIT ISSUED

APR 30 1976

CITY of PORTLAND

To the DIRECTOR OF BUILDING & INSPECTION SERVICES, PORTLAND, MAINE

The undersigned hereby applies for a permit to erect, alter, repair, demolish, move or install the following building, structure, equipment or change use in accordance with the Laws of the State of Maine, the Portland B.O.C.A. Building Code and Zoning Ordinance of the City of Portland with plans and specifications, if any, submitted herewith and the following specifications:

LOCATION 75 St. Hohn St. Fire District #1 ☐, #2 ☐
1 Owner's name and address Colonial Supply Co. same Telephone
2 Lessee's name and address Telephone
3 Contractor's name and address Malia Const. 62 Simon S. Rd. S.P. Telephone 799-4590
4 Architect Specifications Plans No. of sheets
Proposed use of building Plumbing supplies No. families
Last use No. families
Material No. stories Heat Style of roof Roofing
Other buildings on same lot
Estimated contractual cost \$ 15,000 Fee \$ 60.00 pd. 4-29
5.00 appeal fee paid

FIELD INSPECTOR—Mr. Marge Schmuckal GENERAL DESCRIPTION

This application is for @ 775-5451 Addition (block) for display room
Dwelling Ext. 234 70'x20' as per plans

Garage
Masonry Bldg.
Metal Bldg.
Alterations
Demolitions
Change of Use
Other

Stamp of Special Conditions

Appeal sustained conditionally sub. cut side approved
by Traffic Engineer
Appeal sustained 4-28-76

NOTE TO APPLICANT: Separate permits are required by the installers and subcontractors of heating, plumbing, electrical and mechanicals.

PERMIT IS TO BE ISSUED TO 1 ☐ 2 ☐ 3 ☒ 4 ☐
Other:

DETAILS OF NEW WORK

Is any plumbing involved in this work? Is any electrical work involved in this work?
Is connection to be made to public sewer? If not, what is proposed for sewage?
Has septic tank notice been sent? Form notice sent?
Height average grade to top of plate Height average grade to highest point of roof
Size, front depth No. stories solid or filled land? earth or rock?
Material of foundation Thickness, top bottom cellar
Kind of roof Rise per foot Roof covering
No. of chimneys Material of chimneys of lining Kind of heat fuel
Framing Lumber—Kind Dressed or full size? Corner posts Sills
Size Girder Columns under girders Size Max. on centers
Studs (outside walls and carrying partitions) 2x4-16" O. C. Bridging in every floor and flat roof span over 8 feet.
Joists and rafters: 1st floor 2nd 3rd roof
On centers: 1st floor 2nd 3rd roof
Maximum span: 1st floor 2nd 3rd roof
If on story building with masonry walls, thickness of walls? height?

IF A GARAGE

No. cars now accommodated on same lot, to be accommodated ... number commercial cars to be accommodated ...
Will automobile repairing be done other than minor repairs to cars habitually stored in the proposed building?

APPROVALS BY:

BUILDING INSPECTION—PLAN EXAMINER
ZONING: APPEAL SUS.
BUILDING CODE: O.K. C.A. 4/28/76
Fire Dept.:
Health Dept.:
Others:

DATE

MISCELLANEOUS

Will work require disturbing of any tree on a public street? ..

Will there be in charge of the above work a person competent to see that the State and City requirements pertaining thereto are observed? YES ...

Signature of Applicant

Type Name of above

James Malia
James Malia

Phone #

1 ☐ 2 ☐ 3 ☐ 4 ☐

Other

and Address

INSPECTOR'S COPY

NOTES

5-4-76 - Not started yet - MC
5-28-76 foundation in Hugh Irving checked it
The day they poured - putting a brick veneer
on this bldg - MC
7-14-76 completed - checking on permit
for 2 signs - MC

Permit No. 76/12524
Location At home
Owner Chinail Supply
Date of permit 4/3/84
Approved 2-11-84 date

2

RECEIVED
JUL 19 1978
DEPT. OF JUDG. UN-SP
CITY OF PORTLAND

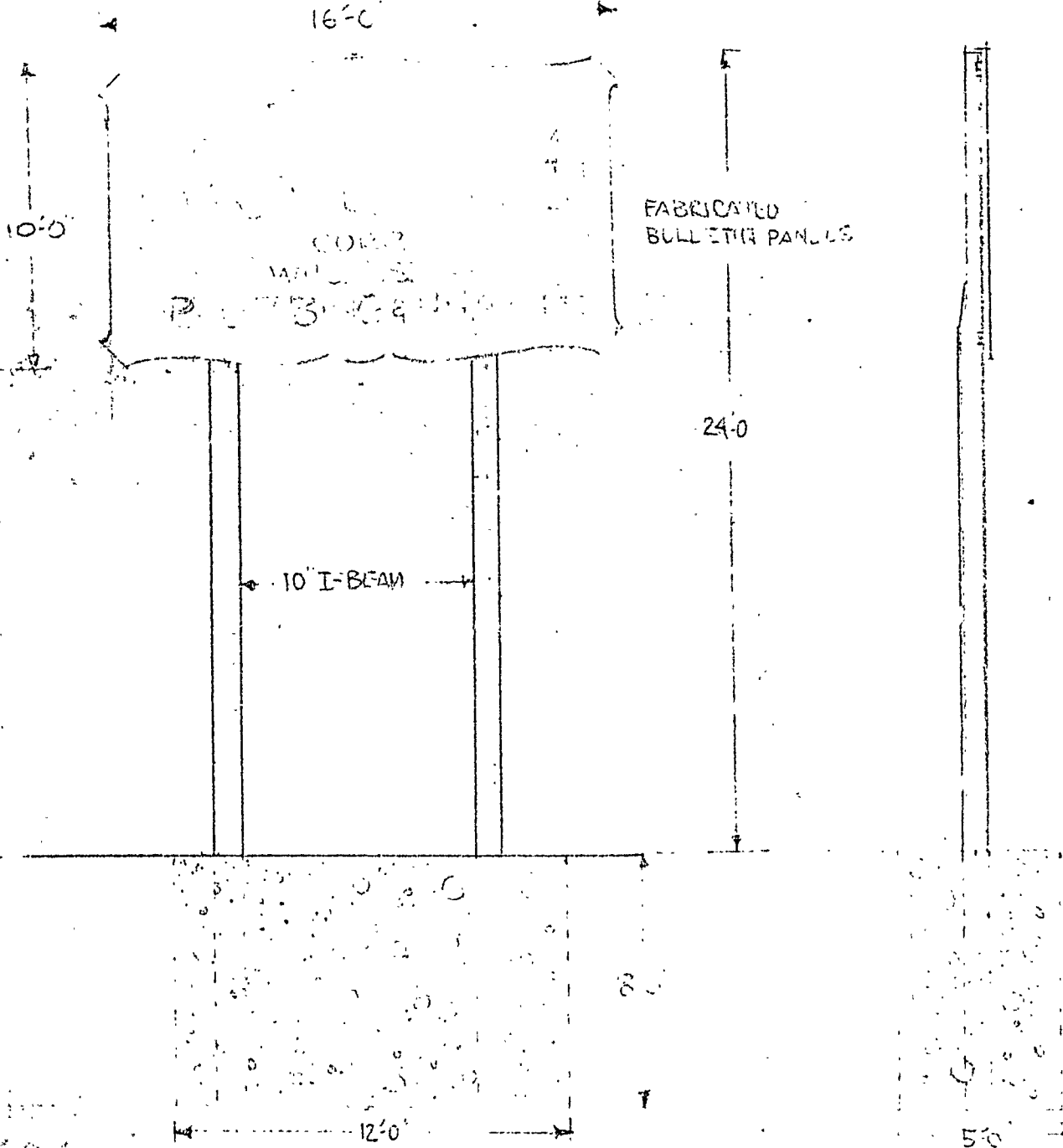

69 COVE STREET
PORTLAND, MAINE
04104

COLONIAL SUPPLY CORP.	SCALE 1/4" = 1'-0"	LOCATION 75 ST. JOHN ST. PORTLAND	DATE
-----------------------	--------------------	-----------------------------------	------



APPLICATION FOR PERMIT

B.O.C.A. USE GROUP

B.O.C.A. TYPE OF CONSTRUCTION

0645

ZONING LOCATION Z-1 PORTLAND, MAINE, July 19, 1976

To the DIRECTOR OF BUILDING & INSPECTION SERVICES, PORTLAND, MAINE

The undersigned hereby applies for a permit to erect, alter, repair, demolish, move or install the following building, structure, equipment or change use in accordance with the Laws of the State of Maine, the Portland B.O.C.A. Building Code and Zoning Ordinance of the City of Portland with plans and specifications, if any, submitted herewith and the following specifications:

LOCATION 75. St. John St. Fire District #1 ☐ #2 ☐
1. Owner's name and address Colonial Supply same Telephone
2. Lessee's name and address Telephone
3. Contractor's name and address Coyne Sign Co. 66 Gove St. Telephone 772-4144
4. Architect Specifications Plans No. of sheets
Proposed use of building plumbing supplies No. families
Last use No. families
Material No. stories Heat Style of roof Roofing
Other buildings on same lot
Estimated construction cost \$ Fee \$ 26.00

FIELD INSPECTOR—Mr. Marge GENERAL DESCRIPTION

This application is for: (e) 75-5451 EXT To relocate sign (detached pole)
Dwelling Ext. 234 160 sq. ft. as per plans.

Garage
Masonry Bldg.
Metal Bldg. Stamp of Special Conditions
Alterations
Demolitions
Change of Use
Other

NOTE TO APPLICANT. Separate permits are required by the installers and subcontractors of heating, plumbing, electrical and mechanicals.

PERMIT IS TO BE ISSUED TO 1 ☐ 2 ☐ 3 ☒ 4 ☐

Other:

DETAILS OF NEW WORK

Is any plumbing involved in this work? Is any electrical work involved in this work?
Is connection to be made to public sewer? If not, what is proposed for sewage?
Has septic tank notice been sent? Form notice sent?
Height average grade to top of plate Height average grade to highest point of roof
Size, front depth No. stories solid or filled land? earth or rock?
Material of foundation Thickness, top bottom cellar
Kind of roof Rise per foot Roof covering
No. of chimneys Material of chimneys of lining Kind of heat fuel
Framing Lumber—Kind Dressed or full size? Corner posts Sills
Size Girder Columns under girders Size Max. on centers
Studs (outside walls and carrying partitions) 2x4-16" O. C. Bridging in every floor and flat roof span over 8 feet.
Joists and rafters: 1st floor 2nd 3rd roof
On centers: 1st floor 2nd 3rd roof
Maximum span: 1st floor 2nd 3rd roof
If one story building with masonry walls, thickness of walls? height?

IF A GARAGE

No. cars now accommodated on same lot, to be accommodated number commercial cars to be accommodated
Will automobile repairing be done other than minor repairs to cars habitually stored in the proposed building?

APPROVALS BY:

DATE:

MISCELLANEOUS

BUILDING INSPECTION—PLAN EXAMINER

Will work require disturbing of any tree on a public street?

ZONING: O.R. 11/19/76

BUILDING CODE O.R. 2.8. 7/20/76

Will there be in charge of the above work a person competent to see that the State and City requirements pertaining thereto are observed? yes

Fire Dept:

Health Dept.:

Others:

Signature of Applicant

Stuart Small Phone #

Type Name of above Stuart Small 1 ☐ 2 ☐ 3 ☐ 4 ☐

Other
and Address

FIELD INSPECTOR'S COPY

NOTES

7-16-76 - Sign Already Erected - had sign
 Sign take out a panel on it - There are also
 2 smaller signs and: weath. The main one
 not shown on plans - 14' x 5'

Permit No. 76-10645
 Location 75 - 1st St. - 1st St.
 Owner Helen, and daughter
 Date of permit 7-30-76
 Approved J. L. S. S. S.

These plans (sheets) and the specifications accompanying the same, covering construction work on Colonial Supply Co. Inc. - St. John St.

Portland, Me. - Structural Steel Only

have been designed and drawn up by the undersigned according to the latest rules of engineering practice and to comply with the allowable working stresses, floor loads, etc. in accordance with Sec. 113.7 & 702.1 of the amendments to the Portland B.O.C.A. Building Code.

(Signature) Chas. H. Tupper

By: Alexander T. Tupper

This statement is to be signed by the individual qualified and responsible for the design, and he should indicate in the blank provided the particular work to which the statement applies.

Section 113.7 (ENGINEERING DETAILS) is amended by adding at the end thereof the following new sentence:

"Where structural analysis is required, a certificate of design shall be afforded the Director of Building Inspections and it shall be signed by the person qualified for such design."

Section 702.1 (STRUCTURAL ANALYSIS) is amended by adding at the end thereof the following new sentence:

"All structural design computations and all stress diagrams for trusses shall be filed with the Inspector, if he deems it necessary, upon application for a building permit."

These plans (/ sheets) and the specifications
accompanying the same, covering construction
work on STEEL DECK & METAL ROOF DECK

on General Supply Add

have been designed and drawn up by the under-
signed according to the latest rules of
engineering practice and to comply with the
allowable working stresses, floor loads, etc.,
in accordance with Sec. 113.7 & 702.1 of the
amendments to the Portland B.O.C.A. Building
Code.

(Signature) William J. McLean
By: _____

This statement is to be signed by the individual
qualified and responsible for the design, and he
should indicate in the blank provided the
particular work to which the statement applies.

Section 113.7 (ENGINEERING DETAILS) is amended
by adding at the end thereof the following new
sentence:

"Where structural analysis is required, a
certificate of design shall be afforded
the Director of Building Inspections and
it shall be signed by the person qualified
for such design."

Section 702.1 (STRUCTURAL ANALYSIS) is amended
by adding at the end thereof the following new
sentence:

"All structural design computations and
all stress diagrams for trusses shall be
filed with the Inspector, if he deems it
necessary, upon application for a
building permit."



APPLICATION FOR PERMIT

B.O.C.A. USE GROUP

B.O.C.A. TYPE OF CONSTRUCTION

ZONING LOCATION Zone 2 PORTLAND, MAINE, Nov. 4, 1976

PERMIT ISSUED

MAR 01 1977

CITY of PORTLAND

To the DIRECTOR OF BUILDING & INSPECTION SERVICES, PORTLAND, MAINE

The undersigned hereby applies for a permit to erect, alter, repair, demolish, move or install the following building, structure, equipment or change use in accordance with the Laws of the State of Maine, the Portland B.O.C.A. Building Code and Zoning Ordinance of the City of Portland with plans and specifications, if any, submitted herewith and the following specifications

LOCATION 75 St. John St. Fire District #1 ☐ #2 ☐
1 Owner's name and address St. John St. Corp. Telephone 776-6191
2 Lessee's name and address Telephone
3 Contractor's name and address to be let Malia Const. 63 Simons Rd. Sp. Phone 799-4590
4 Architect Specifications Plans No. of sheets
Proposed use of building warehouse No. families
Last use No. families
Material No. stories Heat Style of roof Roofing
Other buildings on same lot
Estimated contractual cost \$ 40,000 Fee \$ 160.00pd.

FIELD INSPECTOR--Mr.

GENERAL DESCRIPTION

This application is for:

@ 775-5451

To construct a concrete block one story addition to existing bldg. as per plans 29' in height

Dwelling

Ext. 234

*Addition 40'x161'

Garage

Masonry Bldg

Metal Bldg

Alterations

Demolitions

Change of Use

Other

Stamp of Special Conditions

Appeal sustained 11-26-76

This application is preliminary to get settled the question of zoning appeal. In the event the appeal is sustained the applicant will furnish complete information, estimated cost, legal fees.

NOTE TO APPLICANT: Separate permits are required by the installers and subcontractors of heating, plumbing, electrical and mechanicals.

PERMIT IS TO BE ISSUED TO 1 ☒ 2 ☐ 3 ☐ 4 ☐

Other

DETAILS OF NEW WORK

Is any plumbing involved in this work? Is any electrical work involved in this work?
Is connection to be made to public sewer? If not, what is proposed for sewage?
Has septic tank notice been sent? Form n e sent?
Height average grade to top of plate Height average grade to highest point of roof
Size, front depth No. stories solid or filled land? earth or rock?
Material of foundation Thickness, top bottom cellar
Kind of roof Rise per foot Roof covering
No. of chimneys Material of chimneys of lining Kind of heat fuel
Framing Lumber--Kind Dressed or full size? Corner posts Sills
Size Girder Columns under girders Size Max. on centers
Studs (outside walls and carrying partitions) 2x4-16" O. C. Bridging in every floor and flat roof span over 8 feet.
Joists and rafters: 1st floor 2nd 3rd roof
On centers: 1st floor 2nd 3rd roof
Maximum span: 1st floor 2nd 3rd roof
If one story building with masonry walls, thickness of walls? height?

IF A GARAGE

No. cars now accommodated on same lot to be accommodated number commercial cars to be accommodated
Will automobile repairing be done other than minor repairs to cars habitually stored in the proposed building?

APPROVALS BY:

DATE

MISCELLANEOUS

BUILDING INSPECTION--PLAN EXAMINER

Will work require disturbing of any tree on a public street?

ZONING: ADDED

BUILDING CODE: 0-18-3/27/76

Fire Dept.:

Will there be in charge of the above work a person competent to see that the State and City requirements pertaining thereto are observed? YES

Health Dept.:

Others:

Signature of Applicant Raymond Adams Phone # 776-6191

Type Name of above Raymond Adams 1 ☐ 2 ☐ 3 ☐ 4 ☐

Other and Address

FIELD INSPECTOR'S COPY

lak

NOTES

45-711 1st
4-1-76 2nd
4-1-76 3rd
4-1-76 4th
4-1-76 5th
4-1-76 6th
4-1-76 7th
4-1-76 8th
4-1-76 9th
4-1-76 10th
4-1-76 11th
4-1-76 12th
4-1-76 13th
4-1-76 14th
4-1-76 15th
4-1-76 16th
4-1-76 17th
4-1-76 18th
4-1-76 19th
4-1-76 20th
4-1-76 21st
4-1-76 22nd
4-1-76 23rd
4-1-76 24th
4-1-76 25th
4-1-76 26th
4-1-76 27th
4-1-76 28th
4-1-76 29th
4-1-76 30th
4-1-76 31st
4-1-76 32nd
4-1-76 33rd
4-1-76 34th
4-1-76 35th
4-1-76 36th
4-1-76 37th
4-1-76 38th
4-1-76 39th
4-1-76 40th
4-1-76 41st
4-1-76 42nd
4-1-76 43rd
4-1-76 44th
4-1-76 45th
4-1-76 46th
4-1-76 47th
4-1-76 48th
4-1-76 49th
4-1-76 50th
4-1-76 51st
4-1-76 52nd
4-1-76 53rd
4-1-76 54th
4-1-76 55th
4-1-76 56th
4-1-76 57th
4-1-76 58th
4-1-76 59th
4-1-76 60th
4-1-76 61st
4-1-76 62nd
4-1-76 63rd
4-1-76 64th
4-1-76 65th
4-1-76 66th
4-1-76 67th
4-1-76 68th
4-1-76 69th
4-1-76 70th
4-1-76 71st
4-1-76 72nd
4-1-76 73rd
4-1-76 74th
4-1-76 75th
4-1-76 76th
4-1-76 77th
4-1-76 78th
4-1-76 79th
4-1-76 80th
4-1-76 81st
4-1-76 82nd
4-1-76 83rd
4-1-76 84th
4-1-76 85th
4-1-76 86th
4-1-76 87th
4-1-76 88th
4-1-76 89th
4-1-76 90th
4-1-76 91st
4-1-76 92nd
4-1-76 93rd
4-1-76 94th
4-1-76 95th
4-1-76 96th
4-1-76 97th
4-1-76 98th
4-1-76 99th
4-1-76 100th

Permit No. 76/0191
Location 75 St. Ave. 5A
Owner Corp. 11/1/76
Date of permit 11/1/76
Approved



APPLICATION FOR PERMIT
DEPARTMENT OF BUILDING INSPECTIONS SERVICES
ELECTRICAL INSTALLATIONS

Date June 2, 1976, 19
Receipt and Permit number A 1886

To the CHIEF ELECTRICAL INSPECTOR, Portland, Maine:

The undersigned hereby applies for a permit to make electrical installations in accordance with the laws of Maine, the Portland Electrical Ordinance, the National Electrical Code and the following specifications:

LOCATION OF WORK: 75 St. John St.

OWNER'S NAME: Colonial Supply

ADDRESS: _____

OUTLETS: (number of)

Lights 12

Receptacles 12

Switches _____

Plugmold _____ (number of feet)

TOTAL 24

FEES

3.00

FIXTURES: (number of)

Incandescent _____

Fluorescent _____ (Do not include strip fluorescent)

TOTAL _____

Strip Fluorescent, in feet _____

SERVICES:

Permanent, total amperes 400

Temporary _____

6.00

METERS: (number of) 1

50

MOTORS: (number of)

Fractional _____

1 HP or over _____

RESIDENTIAL HEATING:

Oil or Gas (number of units) _____

Electric (number of rooms) _____

COMMERCIAL OR INDUSTRIAL HEATING:

Oil or Gas (by a main boiler) _____

Oil or Gas (by separate unit) _____

Electric (total number of kw) _____

APPLIANCES: (number of)

Ranges _____

Cook Tops _____

Wall Ovens _____

Dryers _____

Fans _____

Water Heaters _____

Disposals _____

Dishwashers _____

Compactors _____

Others (denote) _____

TOTAL _____

MISCELLANEOUS: (number of)

Branch Panels _____

Transformers _____

Air Conditioners _____

Signs _____

Fire/Burglar Alarms _____

Circus, Fairs, etc. _____

Alterations to wires _____

Repairs after fire _____

Heavy Duty, 220v outlets _____

Emergency Lights, battery _____

Emergency Generators _____

INSTALLATION FEE DUE: _____

FOR ADDITIONAL WORK NOT ON ORIGINAL PERMIT _____

DOUBLE FEE DUE: _____

FOR REMOVAL OF A "STOP ORDER" (304-16.b) _____

FOR PERFORMING WORK WITHOUT A PERMIT (304-9) _____

TOTAL AMOUNT DUE: _____

9.50

INSPECTION:

Will be ready on _____, 19____, or Will Call XX

CONTRACTOR'S NAME: Walsh Elec.

ADDRESS: 119 Four Winds Rd.

TEL: _____

MASTER LICENSE NO.: 1740

LIMITED LICENSE NO.: _____

SIGNATURE OF CONTRACTOR: _____

OFFICE COPY

77-85 St. John Street
cor. 50-64 Valiev St.

April 29, 1976

St. John St. Corporation
75 St. John Street
Portland, ME 04102

cc: Malia Construction Co.
63 Simmons Road
So. Portland, ME 04106

Following is the decision of the Board of Appeals regarding your petition to construct a 70' x 20' addition, 14' high, on the right side of the existing building at the above named location. Please note that your appeal was granted with the condition that the curb cut be approved by the Traffic Engineer.

Your permit will be issued as soon as our Plan Examiner approves the structural plans.

Very truly yours,

A. Allan Soule
Assistant Director

AAS/mt

77-85 St. John Street
cor. 50-64 Valley St.

April 7, 1976

St. John St. Corporation
75 St. John Street
Portland, ME 04102

cc: Malia Construction Co.
63 Simmons Road
So. Portland, ME 04106

Building permit to construct a 70' x 20' addition, 14' high, on the right side of the existing building at the above named location, is not issuable under the Zoning Ordinance because the distance between the proposed addition and rear lot lines will be about 5', rather than the 14' required by Section 602.12.C.4 of the Ordinance applying to the I-2 Industrial Zone in which this property is located.

We understand that you would like to exercise your appeal rights in this matter. Accordingly, you or your authorized representative should come to this office, Room 113, City Hall, to file the appeal on forms which are available here. A fee of \$5.00 for a Space and Bulk appeal shall be paid at this office at the time the appeal is filed. If fee has been paid and appeal filed prior to this letter, then consider this letter as a matter of formality. (Section 602.24.C.3.b.1)

Very truly yours,

Malcolm G. Ward
Plan Examiner

MGW/mt

TRANS. 21.5/11.15

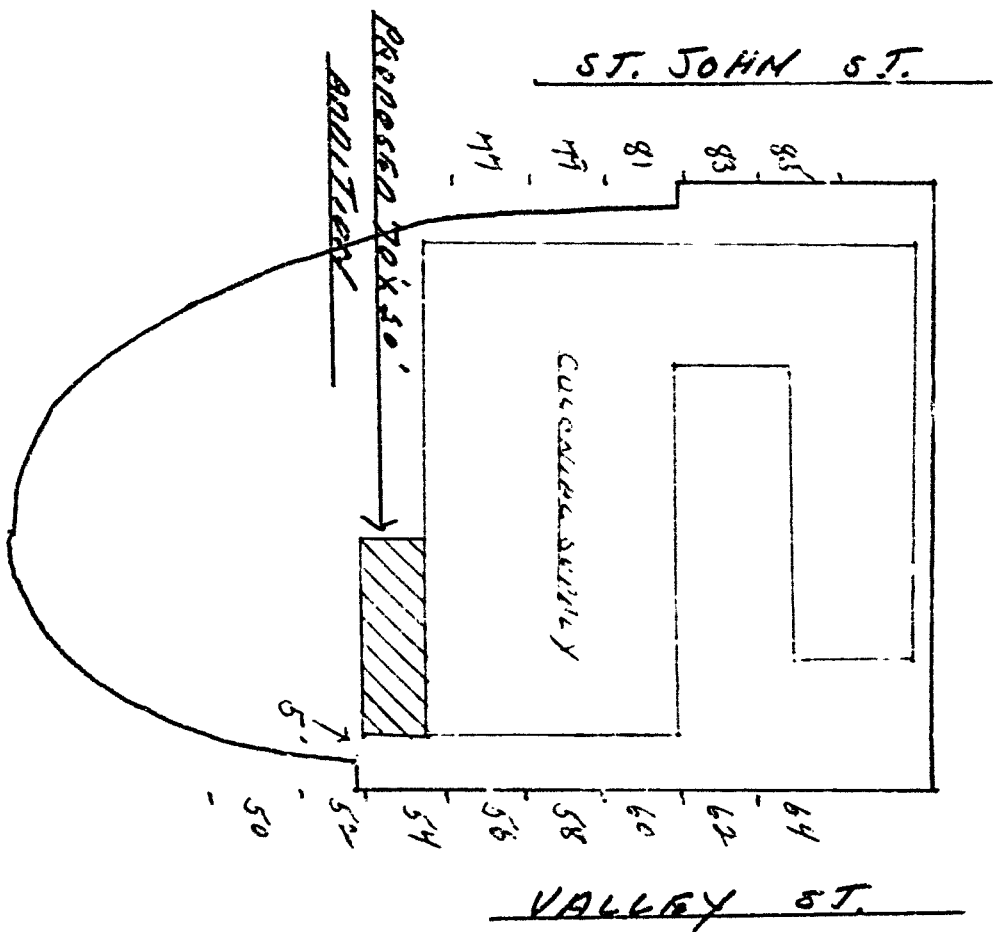

CITY OF PORTLAND, MAINE
SITE PLAN REVIEW
Processing Form

38

Applicant St. John Street Corporation Date November 5, 1975
Mailing Address 75 St. John Street Address of Proposed Site 75 St. John Street
Proposed Use of Site Plumbing supply addition Site Identifier(s) from Assessors Maps 70-B-2, 5, 6, 7
Acreage of Site 49,317 sq. ft. Ground Floor Coverage 6,040 sq. ft. Zoning of Proposed Site I-2
Site Location Review (DEP) Required: () Yes () No Proposed Number of Floors 1
Board of Appeals Action Required: (X) Yes () No Total Floor Area 22,000 sq. ft.
Planning Board Action Required: () Yes () No
Other Comments: _____
Date Dept. Review Due: November 10, 1975

BUILDING DEPARTMENT SITE PLAN REVIEW
(Does not include review of construction plans)

- ☒ Use does NOT comply with Zoning Ordinance
☒ Requires Board of Appeals Action
☐ Requires Planning Board/City Council Action

Explanation _____

- ☐ Use complies with Zoning Ordinance — Staff Review Below

Zoning:
SPACE & BULK,
as applicable

	DATE	ZONE LOCATION	INTERIOR OR CORNER LOT	40 FT SETBACK AREA (SEC 21)	USE	SEWAGE DISPOSAL	REAR YARDS	SIDE YARDS	FRONT YARD	PROJECTIONS	HEIGHT	LOT AREA	BUILDING AREA	AREA PER FAMILY	WIDTH OF LOT	LOT FRONTAGE	OFF-STREET PARKING	LOADING BAYS	
COMPLIES	✓	✓	✓	✓	✓	✓	✓	✓	✓	✓	✓						✓	✓	
COMPLIES CONDITIONALLY																			CONDITIONS SPECIFIED BELOW
DOES NOT COMPLY																			REASONS SPECIFIED BELOW

REASONS: TO CLOSE TO FRONT & SIDE LOT LINES

Michael B. Ward 11/5/75
SIGNATURE OF REVIEWING STAFF/DATE

BUILDING DEPARTMENT - ORIGINAL

CITY OF PORTLAND, MAINE
SITE PLAN REVIEW
 Processing Form

Applicant _____		Date _____
Mailing Address _____		Address of Proposed Site _____
Proposed Use of Site _____		Site Identifier(s) from Assessors Maps _____
Acreage of Site _____	Ground Floor Coverage _____	Zoning of Proposed Site _____
Site Location Review (DEP) Required: () Yes () No		Proposed Number of Floors _____
Board of Appeals Action Required: () Yes () No		Total Floor Area _____
Planning Board Action Required: () Yes () No		
Other Comments _____		
Date Dept. Review Due _____		

FIRE DEPARTMENT REVIEW

(Date Received) _____

	ACCESS TO SITE	ACCESS TO STRUCTURES	SUFFICIENT VEHICLE TURNING ROOM	SAFETY HAZARDS	HYDRANTS	SIAMESE CONNECTIONS	SUFFICIENCY OF WATER SUPPLY	OTHER	
APPROVED	✓	✓	✓	✓	✓	✓	✓		
APPROVED CONDITIONALLY									CONDITIONS SPECIFIED BELOW
DISAPPROVED									REASONS SPECIFIED BELOW

REASONS: _____

(Attach Separate Sheet if Necessary)

Capt. H. Miller

 SIGNATURE OF REVIEWING STAFF/DATE

FIRE DEPARTMENT COPY

CITY OF PORTLAND, MAINE
SITE PLAN REVIEW
Processing Form

Applicant _____	Date _____
Mailing Address _____	Address of Proposed Site _____
Proposed Use of Site _____	Site Identifier(s) from Assessors Maps _____
Acreage of Site / Ground Floor Coverage _____	Zoning of Proposed Site _____
Site Location Review (DEP) Required: () Yes () No	Proposed Number of Floors _____
Board of Appeals Action Required: () Yes () No	Total Floor Area _____
Planning Board Action Required: () Yes () No	
Other Comments: _____	
Date Dept. Review Due: _____	

PLANNING DEPARTMENT REVIEW

Nov 7/75
 (Date Received)

- ☐ Major Development — Requires Planning Board Approval: Review Initiated
- ☐ Minor Development — Staff Review Below

	LOADING AREA	PARKING	CIRCULATION PATTERN	ACCESS	PEDESTRIAN WALKWAYS	SCREENING	LANDSCAPING	SPACE & BULK OF STRUCTURES	LIGHTING	CONFLICT WITH CITY PROJECTS	FINANCIAL CAPACITY	CHANGE IN SITE PLAN
APPROVED												
APPROVED CONDITIONALLY												
DISAPPROVED												

CONDITIONS SPECIFIED BELOW

REASONS SPECIFIED BELOW

REASONS: _____

(Attach Separate Sheet if Necessary)

Brian M. [Signature] 11/7/75
 SIGNATURE OF REVIEWING STAFF/DATE

PLANNING DEPARTMENT COPY

CITY OF PORTLAND, MAINE

SITE PLAN REVIEW

Processing Form

Applicant _____	Date _____
Mailing Address _____	Address of Proposed Site _____
Proposed Use of Site _____	Site Identifier(s) from Assessors Maps _____
Acreage of Site / Ground Floor Coverage _____	Zoning of Proposed Site _____
Site Location Review (DEP) Required: () Yes () No	Proposed Number of Floors _____
Board of Appeals Action Required: () Yes () No	Total Floor Area _____
Planning Board Action Required: () Yes () No	
Other Comments: _____	
Date Dept. Review Due: _____	

PUBLIC WORKS DEPARTMENT REVIEW RECEIVED

(Date Received) 9/75

	TRAFFIC CIRCULATION	ACCESS	CURB CUTS	ROAD WIDTH	PARKING	SIGNALIZATION	TURNING MOVEMENTS	LIGHTING	CONFLICT WITH CITY CONSTRUCTION PROJECT	DRAINAGE	SOIL TYPES	SEWERS	CURBING	SIDEWALKS	OTHER	
APPROVED																
APPROVED CONDITIONALLY																CONDITIONS SPECIFIED BELOW
DISAPPROVED																REASONS SPECIFIED BELOW

REASONS: Sewers (Conditional Approval): No new sewer connection is shown on the site plan. If it is the intent of the applicant to install an additional sewer connection rather than connect to the plumbing of the existing structures, he must submit a revised site plan showing the size and location of said new connection.

Sidewalks and Curbing (Conditional Approval): Applicant must construct or petition for the construction of curbing (and sidewalks) along the frontage of the property or applicant may petition City Council for a waiver of this requirement. (Ref. Chapter 705 of Municipal Code Sidewalks and Maintenance, Sections 705.1 and 705.4, copy attached).

(Attach Separate Sheet if Necessary)

John R. Kennedy 11/12/75
SIGNATURE OF REVIEWING STAFF/DATE
PUBLIC WORKS DEPARTMENT COPY

77-85 St. John Street
cor. 50-64 Valley St.

December 1, 1975

St. John Street Corporation
75 St. John Street
Portland, ME 04102

Enclosed herewith is the decision of the Board of Appeals regarding your petition to construct a 40' x 160' one story masonry addition at the above named location. Please note that your appeal was granted.

Your permit will be issued as soon as our Plan Examiner approves the structural plans.

Very truly yours,

A. Allan Soule
Assistant Director

AAS/mj

PORTLAND COACH CO.

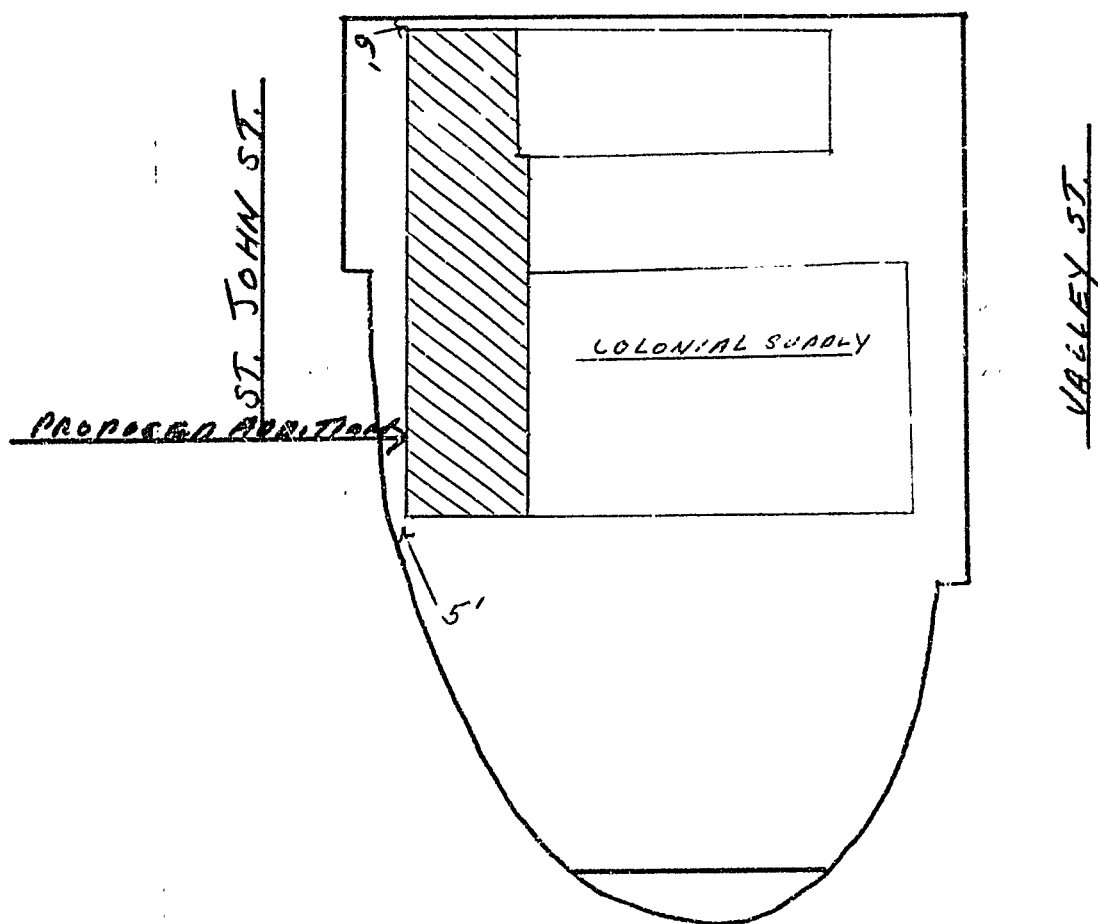

FOR INFORMATION IN CORRE SEE SHC RIGHT
OF WAY MAP "STATE HIGHWAY A" FILE NO 317
SH 3 OF 12.

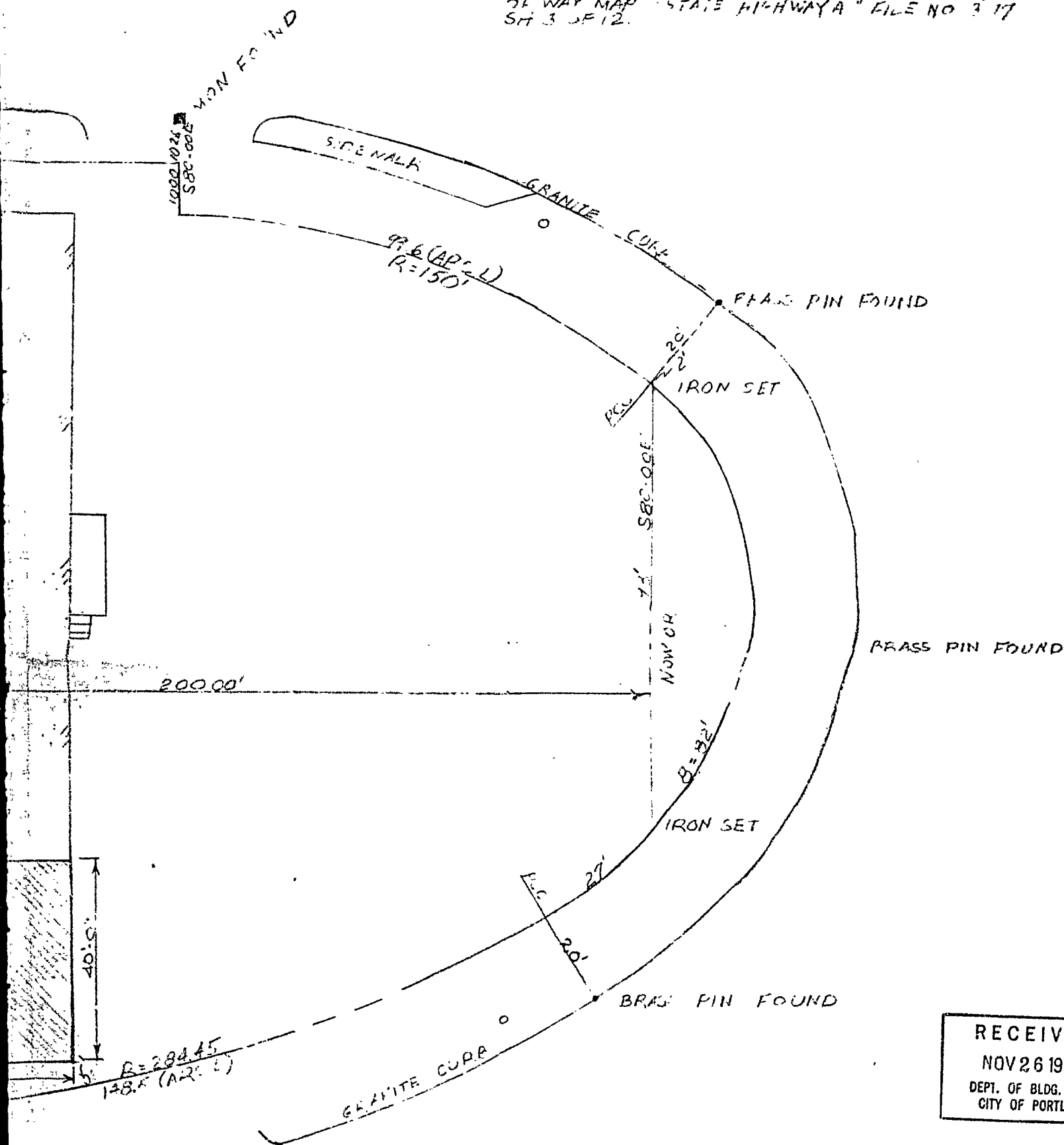

DEPT. OF BLDG. INSP.
CITY OF PORTLAND

IMPERIAL HOME BUILDERS
773-7271 P.O. BOX
883-5171 SCARBORO

P.O. BOX 487;
SCARBOROUGH, ME

FOR THE : COLONIAL SUPPLY CO. INC.

SECRET
TRACED BY T. ASINNOTT

DATE: 11-26-73

SCALE: 1" = 20'

DRAWING NO.

NY.

SHEET NO.

73-4-12-P

PSMAS

VALLEY ST

MAGNETIC
NORTH
1967

580.00 E

WIRE FENCE

200.00

6'

34.0'

IRON FOUND

0.46

510.00 W

80'

IRON SET

510.00 W
106.88

80.00'

EXISTING
BUILDING
1 STORY MASONRY
& STEEL FRAME

EXISTING
BUILDING
1 STORY MASONRY

PROPOSED ADDITION

160'-0"

4.94

510.00 W
3.72

IRON SET

MON FOUND

MON FOUND

20.07

ST. JOHNS ST



APPLICATION FOR PERMIT

B.O.C.A. USE GROUP

B.O.C.A. TYPE OF CONSTRUCTION

ZONING LOCATION I-2 PORTLAND, MAINE, Nov 26, 1973

To the DIRECTOR OF BUILDING & INSPECTION SERVICES, PORTLAND, MAINE

The undersigned hereby applies for a permit to erect, alter, repair, demolish, move or install the following building, structure, equipment or change use in accordance with the Laws of the State of Maine, the Portland B O C A Building Code and Zoning Ordinance of the City of Portland with plans and specifications, if any, submitted herewith and the following specifications:

LOCATION 75 St John St Fire District #1 ☐ #2 ☐
1. Owner's name and address St John St Corp, same Telephone 774-6191
2. Lessee's name and address Telephone
3. Contractor's name and address to be let Telephone
4. Architect Specifications Plans Yes No. of sheets 1
Proposed use of building addition to existing building No. families
Last use none No. families
Material conc/block No. stories two Heat Style of roof Roofing
Other buildings on same lot
Estimated contractual cost \$ 38,000.00 Fee \$ 114.00 *not paid*

FIELD INSPECTOR—Mr. Cartwright

GENERAL DESCRIPTION

This application is for: @ 775-5451 To construct a concrete block two story addition
Dwelling Ext. 234 to existing building per plan. This application is
Garage preliminary to get settled the question of zoning
Masonry Bldg. appeal. In the event the appeal is sustained the ap-
Metal Bldg. plicant will furnish complete information, estimated
Alterations cost and pay legal fee. Stamp of Special Conditions
Demolitions (29' IN HEIGHT)
Change of Use Appeal sustained 12-13-73
Other

NOTE TO APPLICANT: Separate permits are required by the installers and subcontractors of heating, plumbing, electrical and mechanicals.

PERMIT IS TO BE ISSUED TO 1 ☒ 2 ☐ 3 ☐ 4 ☐

Other:

DETAILS OF NEW WORK

Is any plumbing involved in this work? Is any electrical work involved in this work?
Is connection to be made to public sewer? If not, what is proposed for sewage?
Has septic tank notice been sent? Form notice sent?
Height average grade to top of plate Height average grade to highest point of roof
Size, front depth No. stories solid or filled land? earth or rock?
Material of foundation Thickness, top bottom cellar
Kind of roof Rise per foot Roof covering
No. of chimneys Material of chimneys of lining Kind of heat fuel
Framing Lumber—Kind Dressed or full size? Corner posts Sills
Size Girder Columns under girders Size Max. on centers
Studs (outside walls and carrying partitions) 2x4-16" O. C. Bridging in every floor and flat roof span over 8 feet.
Joists and rafters: 1st floor 2nd 3rd roof
On centers: 1st floor 2nd 3rd roof
Maximum span: 1st floor 2nd 3rd roof
If one story building with masonry walls, thickness of walls? height?

IF A GARAGE

No. cars now accommodated on same lot, to be accommodated ... number commercial cars to be accommodated ...
Will automobile repairing be done other than minor repairs to cars habitually stored in the proposed building?

APPROVALS BY:

DATE

MISCELLANEOUS

BUILDING INSPECTION—PLAN EXAMINER Will work require disturbing of any tree on a public street? no
ZONING:
BUILDING CODE: Will there be in charge of the above work a person competent
Fire Dept.: to see that the State and City requirements pertaining thereto
Health Dept.: are observed? yes
Others:

Signature of Applicant Raymond Adams Phone # same as owner
Type Name of above RAYMOND ADAMS 1 ☐ 2 ☐ 3 ☐ 4 ☐

Other
and Address

FIELD INSPECTOR'S COPY

\$ 3.00 fee paid

CITY OF PORTLAND, MAINE
IN THE BOARD OF APPEALS

MISCELLANEOUS APPEAL

St. John Street Corp., owner of property at 77-85 St. John Street, cor. 50-64 Valley Street under the provisions of Section 24 of the Zoning Ordinance of the City of Portland, hereby respectfully petitions the Board of Appeals to permit the construction of a 40' x 160' two story masonry addition at the above named location. This permit is not issuable under the Zoning Ordinance for the following reasons. The property is located in an I-2 Industrial Zone where under the provisions of Section 602.12.C the requirement is that the distance between the proposed addition and the front lot line and side lot line shall not be less than 25' instead of the approximately 5' as shown.

LEGAL BASIS OF APPEAL: Such permit may be granted only if the Board of Appeals find that enforcement of the terms of the Ordinance would result in undue hardship and desirable relief may be granted without substantially departing from the intent and purpose of the Ordinance.

* Raymond Adams
APPELLANT

DECISION

After public hearing held December 13, 1973, the Board of Appeals finds that enforcement of the terms of the Ordinance would result in undue hardship and desirable relief may be granted without substantially departing from the intent and purpose of the Ordinance.

It is, therefore, determined that such permit may be issued.

BOARD OF APPEALS

W. Carl Estlin
Josephine O'Neil
Thomas J. Murphy

City of Portland, Maine

IN BOARD OF MUNICIPAL OFFICERS

Ordered,

That a building permit authorizing erection of a detached sign 16 feet wide and 10 feet high with an overall height of 28 feet above the ground on land owned by Colonial Supply Corporation at 75-81 St. John Street be and hereby is approved as per Section 301.3.1-d of the Building Code subject to full compliance with all applicable requirements thereof

/s/ Clifton M. Pike

Ralph Amergian

Charles W. Allen

Daniel B. Felix

Donald R. Slipr

IN BOARD OF MUNICIPAL OFFICERS
February 12, 1968
Signed.

A True Copy.
Attest:

Arthur H. Duffett
City Clerk

CS 222

1968
CITY OF PORTLAND
OF BLDG. INSP.

PORTLAND, MAINE

Heights
 P_1 17' 0" $2 \times 12 \times 15 \times \frac{1}{2} = 800$
 P_2 17' 0" $3 \times 5 \times 50 = 1650$
 P_3 17' 0" $4 \times 12 \times 12 \times \frac{1}{2} = 2100$
 P_4 17' 0" $10 \times 16 \times 0 \times \frac{1}{2} = 3200$
 P_5 17' 0" $5 \times 4 \times 60 \times \frac{1}{2} = 1200$

2 1/2" x 1/4" RAILS

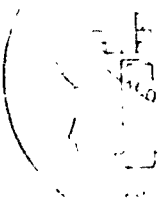

TYPICAL
PANEL



PANEL CROSS SECTION
20 GA. GALVANEAL

12' 0" WF 50#
 73.6' (12' 1")
 24' 0"

These plans (/ sheets) and the specifications 411
 accompanying the same, covering construction work on
 SIGN FOR COLONIAL SUPER CORP St Johns St. Port
 have been designed and drawn up by the undersigned
 according to the latest rules of engineering practice,
 and to comply with the allowable working stresses,
 floor loads, etc. required by the Building Code of
 the City of Portland.

(Signature) *Philip P. Snow*
 File 428

By: This statement is to be signed by the individual
 responsible for the design, and he should indicate
 in the blank provided the particular work to which
 the statement applies.

5'-0"
 FOR
 COLONIAL SUPER CORP.
 15 ORCHARD ST
 PORTLAND - MAINE
 CONYNE SIGN CO.

PHILIP P. Snow File 428
 Feb 21, 1968

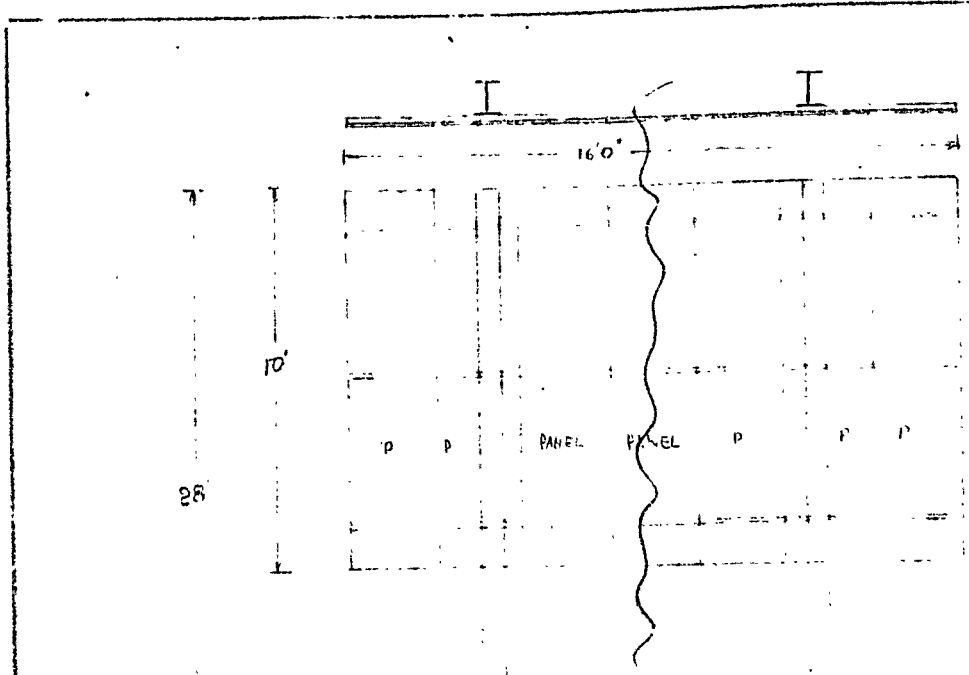

- F₁ Regn. 10x16x10^{1/2}
 F₂ Rail 33'x50
 F₃ Panels 4'x5'x7'x150
 F₄ Hand 10x16x20^{1/2}
 F₅ Box 5'x4'x600^{1/2}

2 1/2" RAILS

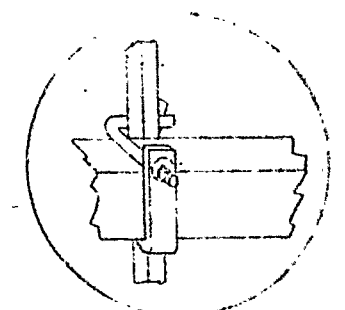

TYPICAL FASTENING

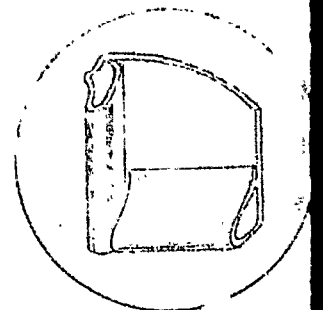

PANEL CROSS SECTION
20 GA. GALVANEAL

R₁ & R₂ WF 50#
 $S = \frac{M}{F}$
 BM @ base
 $\frac{73.6'k(12'')}{24 k/in} = 36.8 in^3$
 $S \text{ RWF } 50 = 14.7 in^3$

SCALE 1/4" = 1'

4'

7'0"

5'0"

COLONIAL
 75-81
 PORTLAND
 COYNE

PHILIP P.

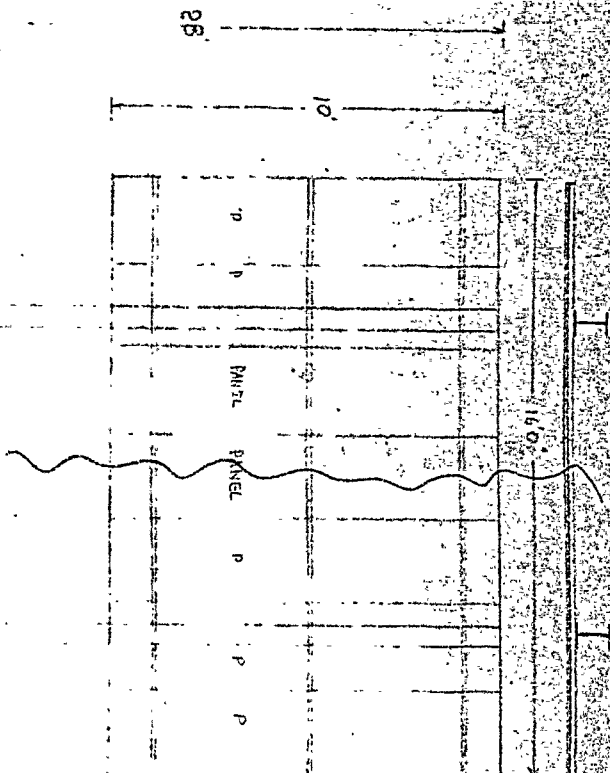

2 1/2" x 4" NAILS

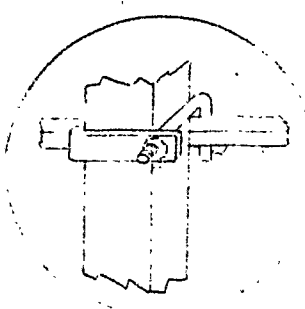

TYPICAL
FASTENING

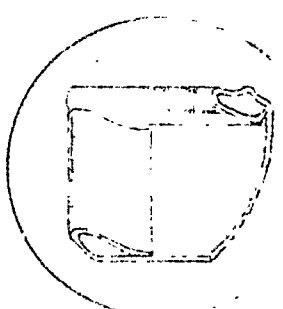

PANEL CROSS SECTION
20 GA. GALVANIZED

10' x 16' x 10' 1/4" = 8000
 16' x 50' = 8000
 4' x 5' x 7' x 150' = 21000
 23' x 4' x 50' = 4600
 15' x 4' x 5' x 100' = 3000
 12000

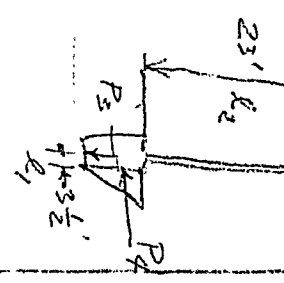

DRIVING SOFT
 5' x 1/4"
 B.M. @ Base
 $73.6' \times (12 \frac{1}{4}) = 26.5' \times 3$
 $24 \times 3 = 72$
 $5' \times 12' = 60' = 19.7' \times 3$

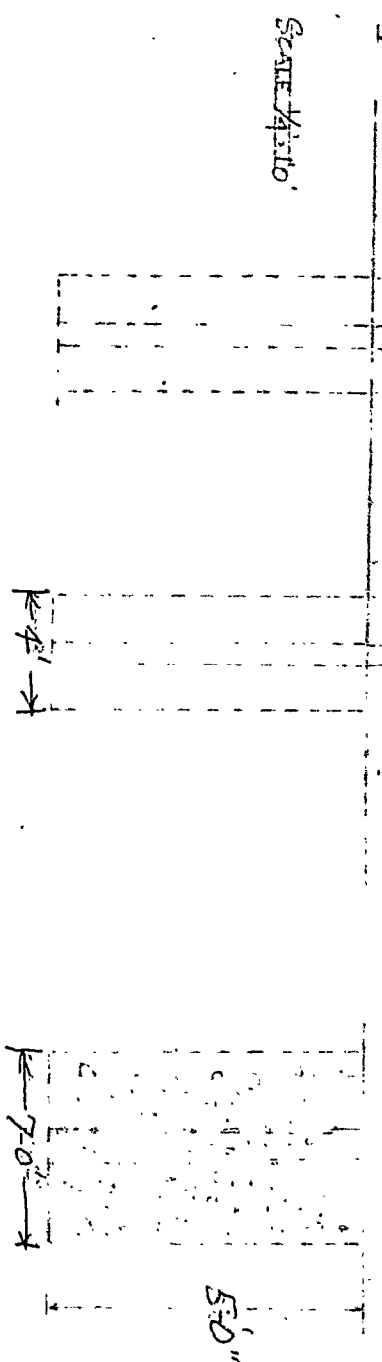

SIGN FOR
 COLONIAL SUPPLY CORP.
 75 B1 ST JOHN ST
 PORTLAND, MAINE
 COYNE SIGN CO.

PHILIP R. SNOW FILE 428
 17621, 1968

These plans (/ sheets) and the specifications of accompanying the same, covering construction work on SIGN FOR Colonial Supply Corp St John's St. For have been designed and drawn up by the undersigned according to the latest rules of engineering practice and to comply with the allowable working stresses, floor loads, etc. required by the Building Code of the City of Portland.

File 428 (Signature) Philip R. Snow

By: This statement is to be signed by the individual responsible for the design, and he should indicate the blank provided the particular work to which the statement applies.

VALLEY ST. E.

LOCATION
OF SIGN

1 STORY
BUILDING

JOHN ST.

PROPOSED SIGN FOR
COLONIAL SUPPLY CO.
75 81 ST. JOHN ST.
PORTLAND, MAINE

Sign Co. - PORTLAND, MAINE

VALLEY ST.

LOCATION
OF SIGN

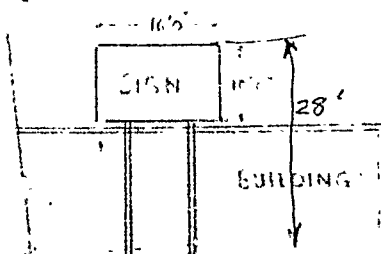

1 STORY
BUILDING

SCALE 1"=20'0"

ST. JOHN ST.



APPLICATION FOR PERMIT

Class of Building or Type of Structure Sign
Portland, Maine, October 30 1967

125
21 1967

To the INSPECTOR OF BUILDINGS, PORTLAND, MAINE

The undersigned hereby applies for a permit to erect alter repair demolish install the following building structure equipment in accordance with the Laws of the State of Maine, the Building Code and Zoning Ordinance of the City of Portland, plans and specifications, if any, submitted herewith and the following specifications:

Location 75-31 St. John St. Within Fire Limits? _____ Dist. No. _____
Owner's name and address Colonial Supply Corp. 75 St. John St. Telephone _____
Lessee's name and address owner of sign. " " " " Telephone _____
Contractor's name and address Coyne Sign Company 196 St. John St. Telephone 772-4144
Architect _____ Specifications _____ Plans yes No. of sheets 1
Proposed use of building _____ No. families _____
Last use _____ No. families _____
Material _____ No. stories _____ Heat _____ Style of roof _____ Roofing _____
Other buildings on same lot _____
Estimated cost \$ _____ Fee \$ 2.00

General Description of New Work

To erect (1)-singlefaced detached pole sign 16' x 10' as per plan.
(steady lighting)

Approved by Municipal Officers 2/12/68

It is understood that this permit does not include installation of heating apparatus which is to be taken out separately by and in the name of the heating contractor. **PERMIT TO BE ISSUED TO** contractor

Details of New Work

Is any plumbing involved in this work? _____ Is any electrical work involved in this work? _____
Is connection to be made to public sewer? _____ If not, what is proposed for sewage? _____
Has septic tank notice been sent? _____ Form notice sent? _____
Height average grade to top of plate _____ Height average grade to highest point of roof _____
Size, front _____ depth _____ No. stories _____ solid or filled land? _____ earth or rock? _____
Material of foundation _____ Thickness, top _____ bottom _____ cellar _____
Kind of roof _____ Rise per foot _____ Roof covering _____
No. of chimneys _____ Material of chimneys _____ of lining _____ Kind of heat _____ fuel _____
Framing Lumber—Kind _____; Dressed or full size? _____ Corner posts _____ Sills _____
Size Girder _____ Columns under girders _____ Size _____ Max. on centers _____
Studs (outside wall and carrying partitions) 2x4-16" O. C. Bridging in every floor and flat roof span over 8 feet.
Joists and rafters: 1st floor _____, 2nd _____, 3rd _____, roof _____
On centers: 1st floor _____, 2nd _____, 3rd _____, roof _____
Maximum span: 1st floor _____, 2nd _____, 3rd _____, roof _____
If one story building with masonry walls, thickness of walls? _____ height? _____

If a Garage

No. cars now accommodated on same lot _____, to be accommodated _____ number commercial cars to be accommodated _____
Will automobile repairing be done other than minor repairs to cars habitually stored in the proposed building? _____

APPROVED:

J. L. Ho

Miscellaneous

Will work require disturbing of any tree on a public street? _____ no
Will there be in charge of the above work a person competent to see that the State and City requirements pertaining thereto are observed? _____ yes

Coyne Sign Company

CS 301

INSPECTION COPY

Signature of owner _____ by _____

NOTES

10/20/68: Call on Carrier
 about the road cut of
 design. info on base of road
 pole & for road design
 truck. Call.

3-4-68 steel cols.
 up - sloppier footings
 spread over ground.

X

Permit No. 67/125
 Location 75-81 A. 9. 8. 1. A.
 Owner Calumet Supply Corp.
 Date of permit 2/21/68
 Notif. closing-in
 Inspn. closing-in
 Final Notif.
 Final Inspn.
 Cert. of Occupancy issued
 Staking Out Notice
 Form Check Notice

CITY OF PORTLAND, MAINE

Application for Permit to Install Wires

Permit No. 56286
Issued 10/24/67

Portland, Maine Oct 24, 1967

To the City Electrician, Portland, Maine:

The undersigned hereby applies for a permit to install wires for the purpose of conducting electric current, in accordance with the laws of Maine, the Electrical Ordinance of the City of Portland, and the following specifications:

(This form must be completely filled out — Minimum Fee, \$1.00)

Owner's Name and Address *Edward J. Murphy* Tel.
Contractor's Name and Address *132 199 1st Avenue* Tel.
Location *16 St. John St.* Use of Building *Supply House*
Number of Families _____ Apartments _____ Stores _____ Number of Stories _____
Description of Wiring: New Work _____ Additions _____ Alterations _____

Pipe _____ Cable _____ Metal Molding _____ BX Cable _____ Plug Molding (No. of feet) _____
No. Light Outlets _____ Plugs _____ Light Circuits _____ Plug Circuits _____
FIXTURES: No. _____ Light Switches _____ Fluor. or Strip Lighting (No. feet) _____
SERVICE: Pipe _____ Cable _____ Underground _____ No. of Wires _____ Size _____
METERS: Relocated _____ Added _____ Total No. Meters _____
MOTORS: Number _____ Phase _____ H. P. _____ Amps _____ Volts _____ Starter _____
HEATING UNITS: Domestic (Oil) _____ No. Motors _____ Phase _____ H.P. _____
Commercial (Oil) _____ No. Motors _____ Phase _____ H.P. _____
Electric Heat: No. of Rooms _____
APPLIANCES: No. Ranges _____ Watts _____ Brand Feeds (Size and No.) _____
Elec. Heaters _____ Watts _____
Miscellaneous _____ Watts _____ Extra Cabinets or Panels _____
Transformers _____ Air Conditioners (No. Units) _____ Signs (No. Units) _____
Will commence 19 _____ Ready to cover in 19 _____ Inspection 19 _____
Amount of Fee \$ *2.00*

Signed *Ed Murphy*

DO NOT WRITE BELOW THIS LINE

SERVICE		METER		GROUND	
VISITS: 1	2	3	4	5	6
7	8	9	10	11	12

REMARKS:

INSPECTED BY *FW* (OVER)

LOCATION *ST. John ST. 75*
 INSPECTION DATE *1/25/68*
 WORK COMPLETED *1/25/68*
 TOTAL NO. INSPECTIONS *1*
 REMARKS:

FEES FOR WIRING PERMITS EFFECTIVE JULY 31, 1963

WIRING		
1 to 30 Outlets	(including switches)	\$ 2.00
31 to 60 Outlets	(including switches)	3.00
Over 60 Outlets, each Outlet	(including switches)	.05
(Each twelve feet or fraction thereof of fluorescent lighting or any type of plug molding will be classed as one outlet).		
SERVICES		
Single Phase		2.00
Three Phase		4.00
MOTORS		
Not exceeding 50 H.P.		3.00
Over 50 H.P.		4.00
HEATING UNITS		
Domestic (Oil)		2.00
Commercial (Oil)		4.00
Electric Heat (Each Room)		.75
APPLIANCES		
Ranges, Cooking Tops, Ovens, Water Heaters, Disposals, Dishwashers, etc. — Each Unit		1.50
TEMPORARY WORK (limited to 6 months from date of permit)		
Service, Single Phase		1.00
Service, Three Phase		2.00
Wiring, 1-50 Outlets		1.00
Wiring, each additional outlet over 50		.02
Circuses, Carnivals, Fairs, etc		10.00



FILL IN AND SIGN WITH INK

APPLICATION FOR PERMIT FOR
HEATING, COOKING OR POWER EQUIPMENT

Portland, Maine,

October 24, 1967

PERMIT ISSUED
01126

PORTLAND

To the INSPECTOR OF BUILDINGS, PORTLAND, ME.

The undersigned hereby applies for a permit to install the following heating, cooking or power equipment in accordance with the Laws of Maine, the Building Code of the City of Portland, and the following specifications:

Location 75 St. John St. Use of Building Plumbing Supplies No. Stories 1 ~~NEW~~ Building Existing "
Name and address of owner of appliance Colonial Supply Co. 203 Fore St.
Installer's name and address Bregly Oil Service, 84 Congress St. Telephone

General Description of Work

To install (2) oil-fired suspended forced hot air heating systems (new installations)

IF HEATER, OR POWER BOILER

Location of appliance suspended from ceiling Any burnable material in floor surface or beneath? none
If so, how protected? Kind of fuel? oil
Minimum distance to burnable material, from top of appliance or casing top of furnace 25"
From top of smoke pipe 25" existing From front of appliance over 4' From sides or back of appliance over 3'
Size of chimney flue 10" existing Other connections to same flue none
If gas fired, how vented? Rated maximum demand per hour
Will sufficient fresh air be supplied to the appliance to insure proper and safe combustion? yes

IF OIL BURNER

Name and type of burner A B C-gunttype Labelled by underwriters' laboratories? yes
Will operator be always in attendance? Does oil supply line feed from top or bottom of tank? bottom
Type of floor beneath burner concrete Size of vent pipe 1 1/2"
Location of oil storage outside underground Number and capacity of tanks 1000 existing
Low water shut off Make No.
Will all tanks be more than five feet from any flame? yes How many tanks enclosed?
Total capacity of any existing storage tanks for furnace burners

IF COOKING APPLIANCE

Location of appliance Any burnable material in floor surface or beneath?
If so, how protected? Height of Legs, if any
Skirting at bottom of appliance? Distance to combustible material from top of appliance?
From front of appliance From sides and back From top of smokepipe
Size of chimney flue Other connections to same flue
Is hood to be provided? If so, how vented? Forced or gravity?
If gas fired, how vented? Rated maximum demand per hour

MISCELLANEOUS EQUIPMENT OR SPECIAL INFORMATION

Amount of fee enclosed? 3.00 (\$2.00 for one heater, etc., \$1.00 additional for each additional heater, etc., in same building at same time.)

APPROVED:

C.K. 10-24-67

Will there be in charge of the above work a person competent to see that the State and City requirements pertaining thereto are observed? yes

By Bregly Oil Service

CS 300

Signature of Installer

by:

C.K. Bregly

INSPECTION COPY

M

[illegible][illegible]

A hand-drawn graph on lined paper. The graph features two curves that intersect at a single point. The curve on the left is concave up, starting from the bottom left and moving towards the top right. The curve on the right is concave down, starting from the top left and moving towards the bottom right. The two curves cross each other in the middle of the page. The background consists of horizontal lines typical of notebook paper.

CITY OF PORTLAND, MAINE

Application for Permit to Install Wires

Permit No. 57162

Issued

Portland, Maine 24.29, 1907

To the City Electrician, Portland, Maine:

The undersigned hereby applies for a permit to install wires for the purpose of conducting electric current, in accordance with the laws of Maine, the Electrical Ordinance of the City of Portland, and the following specifications:

(This form must be completely filled out — Minimum Fee, \$1.00)

Owner's Name and Address Colcord Supply Tel. —

Contractor's Name and Address Anthony M. M. M. Tel. —

Location 75 St. John St. Use of Building

Number of Families Apartments Stores Number of Stories

Description of Wiring: New Work ☒ Additions Alterations

Pipe Cable Metal Molding BX Cable Plug Molding (No. of feet)

No. Light Outlets Plugs Light Circuits Plug Circuits

FIXTURES: No. Light Switches Fluor. or Strip Lighting (No. feet) 300 ft.

SERVICE: Pipe Cable Underground No. of Wires Size

METERS: Relocated Added Total No. Meters

MOTORS: Number Phase H. P. Amps Volts Starter

HEATING UNITS: Domestic (Oil) No. Motors Phase H.P.

Commercial (Oil) No. Motors Phase H.P.

Electric Heat (No. of Rooms)

APPLIANCES: No. Ranges Watts Brand Feeds (Size and No.)

Elec. Heaters Watts

Miscellaneous Watts Extra Cabinets or Panels

Transformers Transformers (No. Units) 1 Signs (No. Units)

Will commence 4.9 1907 Ready to cover in 9/20 1907 Inspection W. M. M. —

Amount of Fee \$ 2.00

Signed Anthony M. M. M.

DO NOT WRITE BELOW THIS LINE

SERVICE	METER			GROUND	
VISITS: 1	2	3	4	5	6
7	8	9		11	12

REMARKS:

INSPECTED BY W. M. M. (OVER)

LOCATION *ST. John St 75*
 INSPECTION DATE *9/27/67*
 WORK COMPLETED *9/27/67*
 TOTAL NO. INSPECTIONS *1*
 REMARKS:

FEEES FOR W. RING PERMITS EFFECTIVE JULY 31, 1963

WIRING

1 to 30 Outlets	(including switches)	\$ 2.00
31 to 60 Outlets	(including switches)	3.00
Over 60 Outlets, each Outlet	(including switches)	.05

(Each twelve feet or fraction thereof of fluorescent lighting or any type of plug molding will be classed as one outlet).

SERVICES

Single Phase	2.00
Three Phase	4.00

MOTORS

Not exceeding 50 H.P.	3.00
Over 50 H.P.	4.00

HEATING UNITS

Domestic (Oil)	2.00
Commercial (Oil)	4.00
Electric Heat (Each Room)	.75

APPLIANCES

Ranges, Cooking Tops, Ovens, Water Heaters, Disposals, Dishwashers, etc. — Each Unit

1.50

TEMPORARY WORK (limited to 6 months from date of permit)

Service, Single Phase	1.00
Service, Three Phase	2.00
Wiring, 1-50 Outlets	1.00
Wiring, each additional outlet over 50	.02
Circuses, Carnivals, Fairs, etc.	10.00

MISCELLANEOUS

Distribution Cabinet, Panel, etc.

1.00

CITY OF PORTLAND, MAINE
Application for Permit to Install Wires

Permit No. 55948
Issued
Portland, Maine July 11, 1907

To the City Electrician, Portland, Maine:

The undersigned hereby applies for a permit to install wires for the purpose of conducting electric current, in accordance with the laws of Maine, the Electrical Ordinance of the City of Portland, and the following specifications:

(This form must be completely filled out — Minimum Fee, \$1.00)

Owner's Name and Address Colonel Supply Co. Tel. —
Contractor's Name and Address Anthony Mancini Tel. —
Location Valley St. Use of Building —
Number of Families Apartments Stores Number of Stories
Description of Wiring: New Work Additions Alterations

Pipe Cable Metal Molding BX Cable Plug Molding (No. of feet)
No. Light Outlets 20 Plugs 25 Light Circuits Plug Circuits
FIXTURES: No. 20 Light Switches 10 Fluor. or Strip Lighting (No. feet) 25'
SERVICE: Pipe Cable Underground No. of Wires Size
METERS: Relocated Added Total No. Meters
MOTORS: Number Phase H. P. Amps Volts Starter
HEATING UNITS: Domestic (Oil) No. Motors Phase H.P.
Commercial (Oil) No. Motors Phase H.P.
Electric Heat (No. of Rooms)
APPLIANCES: No. Ranges Watts Brand Feeds (Size and No.)
Elec. Heaters Watts
Miscellaneous Watts Ext. Cabinets or Panels 1
Transformers Air Conditioners (No. Units) Signs (No. Units)
Will commence 7/17 1907 Ready to cover in will call Inspection 19
Amount of Fee \$ 6.15 ✓

Signed Anthony Mancini

DO NOT WRITE BELOW THIS LINE

SERVICE	METER	GROUND
VISITS: 1 2 3 4 5 6		
7 8 9 10 11 12		

REMARKS:

INSPECTED BY J. W. Hester (OVER)

LOCATION *St. John ST 75*
 INSPECTION DATE *7/18/67*
 WORK COMPLETED *7/18/67*
 TOTAL NO. INSPECTIONS *1*
 REMARKS:

FEEES FOR WIRING PERMITS EFFECTIVE JULY 31, 1963

WIRING

1 to 30 Outlets	(including switches)	\$ 2.00
31 to 60 Outlets	(including switches)	3.00
Over 60 Outlets, each Outlet	(including switches)	.05
(Each twelve feet or fraction thereof of fluorescent lighting or any type of plug molding will be classed as one outlet.)		

SERVICES

Single Phase	2.00
Three Phase	4.00

MOTORS

Not exceeding 50 H.P.	3.00
Over 50 H.P.	4.00

HEATING UNITS

Domestic (Oil)	2.00
Commercial (Oil)	4.00
Electric Heat (Each Room)	.75

APPLIANCES

Ranges, Cooking Tops, Ovens, Water Heaters, Disposals, Dishwashers, etc. -- Each Unit

1.50

TEMPORARY WORK (Limited to 6 months from date of permit)

Service, Single Phase	1.00
Service, Three Phase	2.00
Wiring, 1-50 Outlets	1.00
Wiring, each additional outlet over 50	.02
Circuits, Carnivals, Fairs, etc.	10.00

MISCELLANEOUS

Distribution Cabinet or Panel, per unit