

REVISIONS

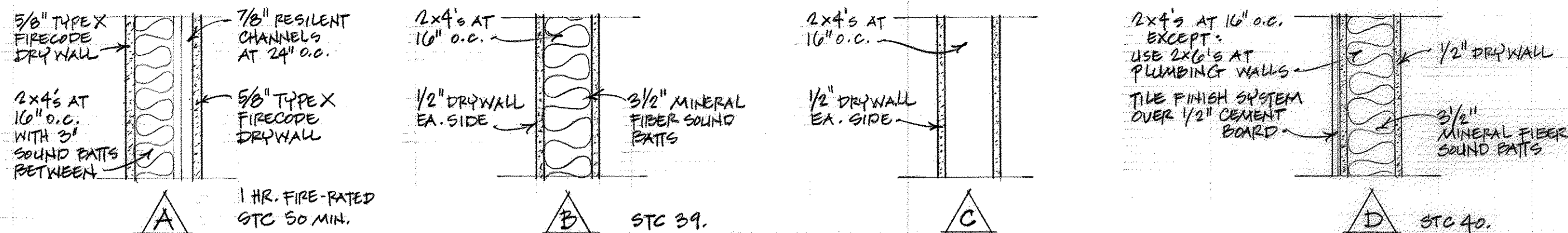

WALL TYPES.

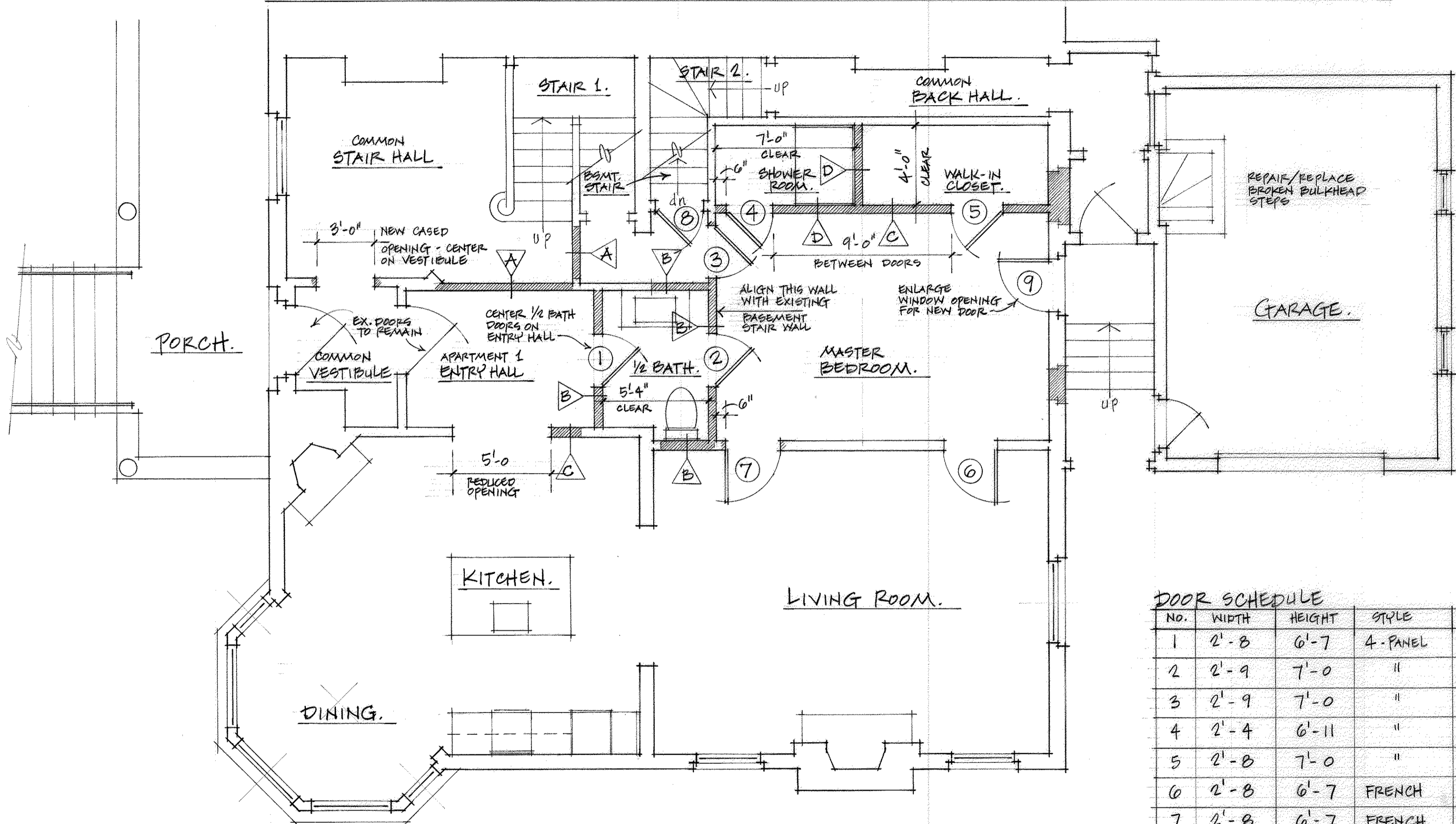

DOOR SCHEDULE

NO.	WIDTH	HEIGHT	STYLE	NOTES
1	2'-8	6'-7	4-PANEL	
2	2'-9	7'-0	"	
3	2'-9	7'-0	"	
4	2'-4	6'-11	"	
5	2'-8	7'-0	"	
6	2'-8	6'-7	FRENCH	TRANSOM ABOVE
7	2'-8	6'-7	FRENCH	TRANSOM ABOVE
8	VIF	VIF	FLUSH	FIRE DOOR
9	VIF	VIF	FLUSH	EXTERIOR FIRE DR

DOOR NOTES:

- DOORS 1-7 ARE SALVAGED. SEE DEMO PLAN.
- ALL SIZES APPROXIMATE - VERIFY ACTUAL DOOR SIZE.
- SALVAGE ALL HINGES, KNOBS + PLATES FOR RE-USE.
- TRANSOMS: BROSCO 2'-0 W. x 2'-0 H. 6-LIGHT SASH.
- CONTRACTOR TO VERIFY SPACE AVAILABLE FOR DOORS 8+9.

190 PINE STREET - FIRST FLOOR RENOVATIONS TO APARTMENT 1 - FLOOR PLAN

CARRIAGE HOUSE STUDIO ARCHITECTS · PORTLAND · MAINE

1/4" = 1'-0"

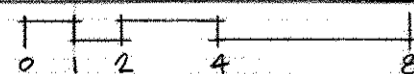

EXISTING CONSTRUCTION - NOTES ON FIRE RATING REQUIREMENTS -

- WHEREVER POSSIBLE, MAINTAIN EXISTING PLASTER WALLS + CEILINGS FOR FIRE SEPARATION BETWEEN APT. 1, COMMON AREAS AND APT. 2.
- WHERE WALLS OR CEILINGS REQUIRE REPLACEMENT, INSTALL SOUND BATT, RESILIENT CHANNELS + TYPE X FIRECODE DRYWALL, 5/8" THICK, IN PLACE OF PLASTER FINISH.



Carrriage House Studio architects

144 Vaughan Street · Portland · Maine · 207-318-0731
www.carrriagehousestudio.com

FLOOR PLAN
WALL TYPES
DOOR SCHEDULE
FIRE RATING NOTES

PERMIT SET

A-2

14 SEPT 2015