

**SLOPE COIL**

NOTE:  
1. CONDENSATE PAN DRAIN CAPS NOT SHOWN FOR CLARITY.

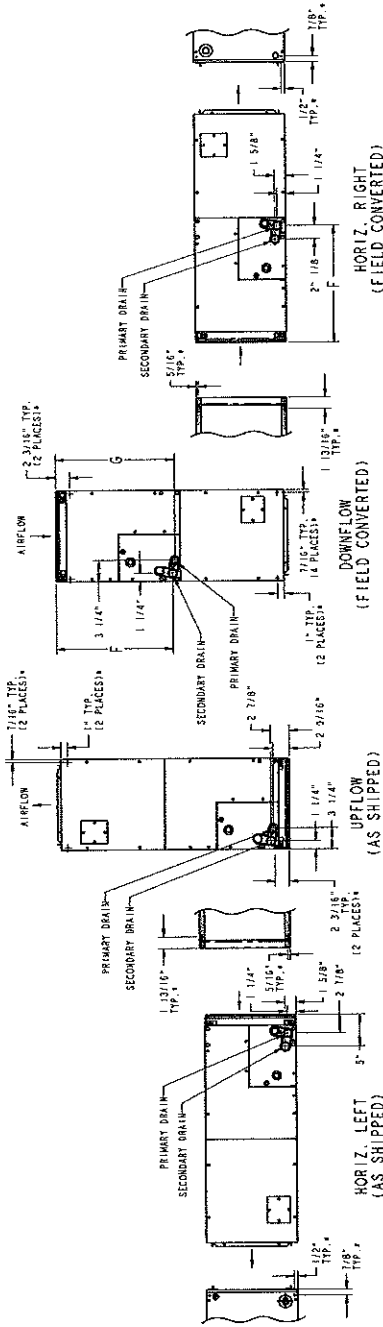

\* HORIZONTAL MOUNT LOCATIONS - SUPPLE PROVIDED IN TOP PANEL AND BACK OF CABINET IN CABINET BOTTOM HOLES PROVIDED 138" DIA. HORIZONTAL HANGING HARDWARE TO BE FIELD SUPPLIED.

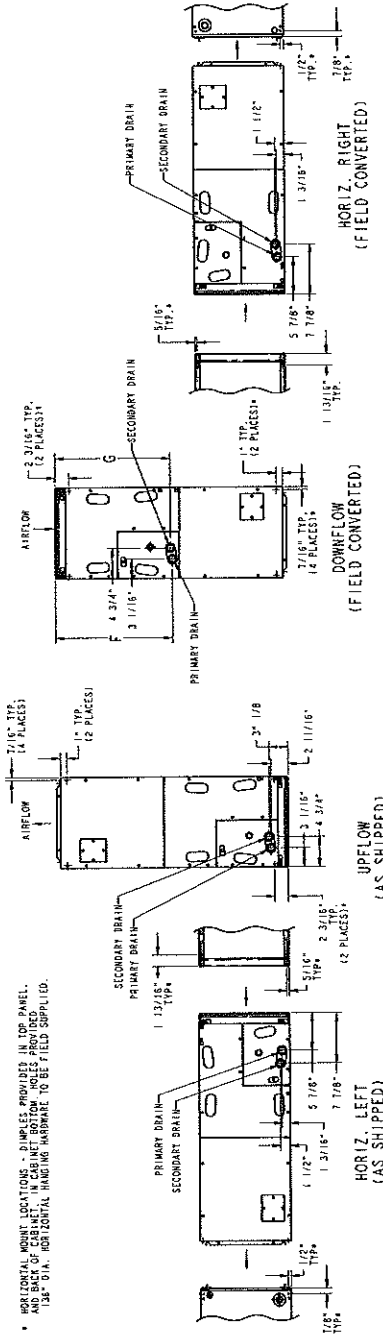

**A-COIL**

**DIMENSIONS**

UNIT	SIZE	F	G	mm	in	Slope	COIL CONFIGURATION	"A"	SHIPPING WEIGHT
FE4A	002	18-9/16	18-1/4	472	18-1/4	—	DOWNFLOW	Yes	135 / 61
FE4A	003	26-15/16	27-1/2	684	27-1/2	Yes	DOWNFLOW	—	150 / 68
FE4A	003*	26-15/16	27-1/2	684	27-1/2	Yes	DOWNFLOW	—	150 / 68
FE4A	005	27-1/4	26-15/16	692	26-15/16	—	DOWNFLOW	Yes	172 / 78
FE4A	005*	27-1/4	26-15/16	692	26-15/16	—	DOWNFLOW	Yes	172 / 78
FE4A	006*	32-15/16	32-5/8	837	32-5/8	—	DOWNFLOW	Yes	207 / 94
FE5A	004*	32-15/16	32-5/8	837	32-5/8	—	DOWNFLOW	Yes	200 / 91

\* Modular Cabinet