

## BILL OF MATERIALS

ITEM	QTY.	DESCRIPTION	DRAWING NO.	WT. #
1	1	BAR 1" DIA x 12"LG.		2.75
2	1	END CAP	CAPLUG # A570A15A	
		TOTAL WEIGHT*		2.75

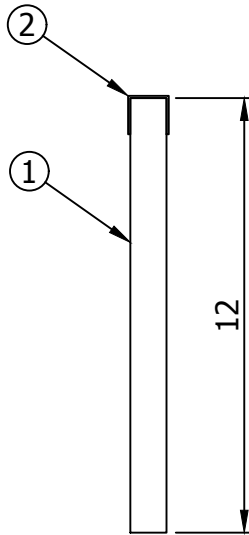

REV.	DATE	BY	DESCRIPTION
<b>REVISION INFORMATION</b>			
FOR:		DESCRIPTION:	
		12" RETAINING POLE FOR CANTILEVER RACK	

STANDARD TOLERANCES	
FEET	+/- 1/8"
INCHES	+/- 1/32
DECIMALS	+/- .001
ANGLES	+/- 1.0°

The information contained in this drawing is considered proprietary by Elite Storage Solutions, Inc. Permission of this drawing is not a license to duplicate this information in any other party without prior written permission of Elite Storage Solutions, Inc. The inclusion of non-proprietary information (ie: hardware parameters or other locations) shall not be considered an claim for duplicating this information. The sole purpose of this drawing is informational for the customer.



1118 W. SPRING STREET      MONROE, GA 30655

SCALE: 3" = 1'-0"
DRAWN BY: MD
DATE: 7/1/13
CHK BY: JLP

FILE NAME: X-S-POLE-12	<b>X-S-POLE-12</b>	REV. #
DRAWING NO.		