

BILL OF MATERIALS

ITEM	QTY.	DESCRIPTION	DRAWING NO	WT. #
1	1	1" SCH. 40 PIPE x 3 7/8" LG.		0.54
2	1	C.R.S. 1/4" x 3" x 2 3/4" LG.		0.59
TOTAL WEIGHT PER ASSEMBLY:				1.13

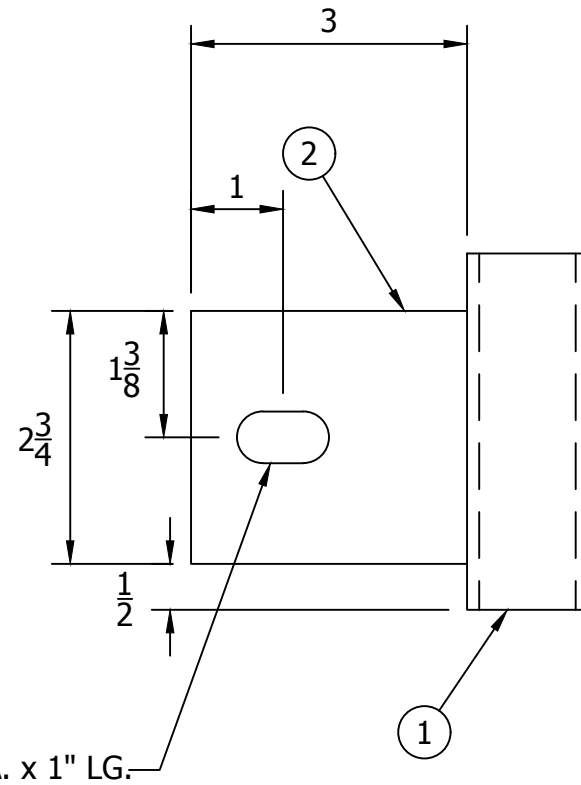
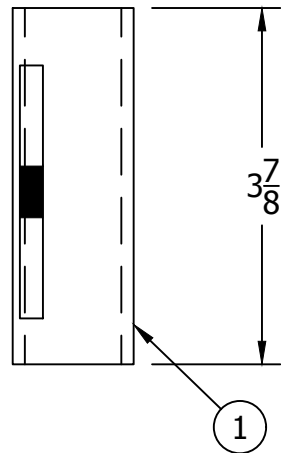
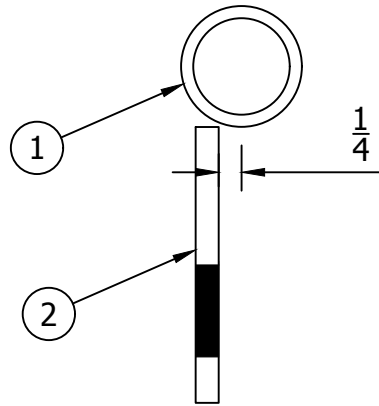

SLOT 9/16 DIA. x 1" LG.

REV.	DATE	BY	DESCRIPTION
10/18/2016	1:46:01 PM		REVISION INFORMATION

The information contained in this drawing is considered proprietary to Elite Storage Solutions, LLC. Permission of the drawing is not a license to distribute this information to any other party without prior written permission of Elite Storage Solutions, LLC. The inclusion of non-proprietary information (ie. Building parameters or other locations) shall not be considered as cause for disavowing this statement. The sole purpose of this drawing is informational for the customer.

STANDARD TOLERANCES		
FEET	+/-	1/8"
INCHES	+/-	1/16"
DECIMALS	+/-	.001
ANGLES	+/-	1.0°

FOR:		DESCRIPTION: POLE SOCKET FOR 4" & 5" ARM	
SCALE: HALF		FILE NAME: X-S-PIPE SOCKET FOR 4-5 INCH ARM.dwg	
DRAWN BY: JDC		DRAWING NO.	
DATE: 11/13/2009		X-S-PIPE SOCKET	
CHK BY:		REV. #	



1118 W. SPRING STREET MONROE, GA 30655