

### EXISTING CONDITIONS

PROJECT  
NORTH

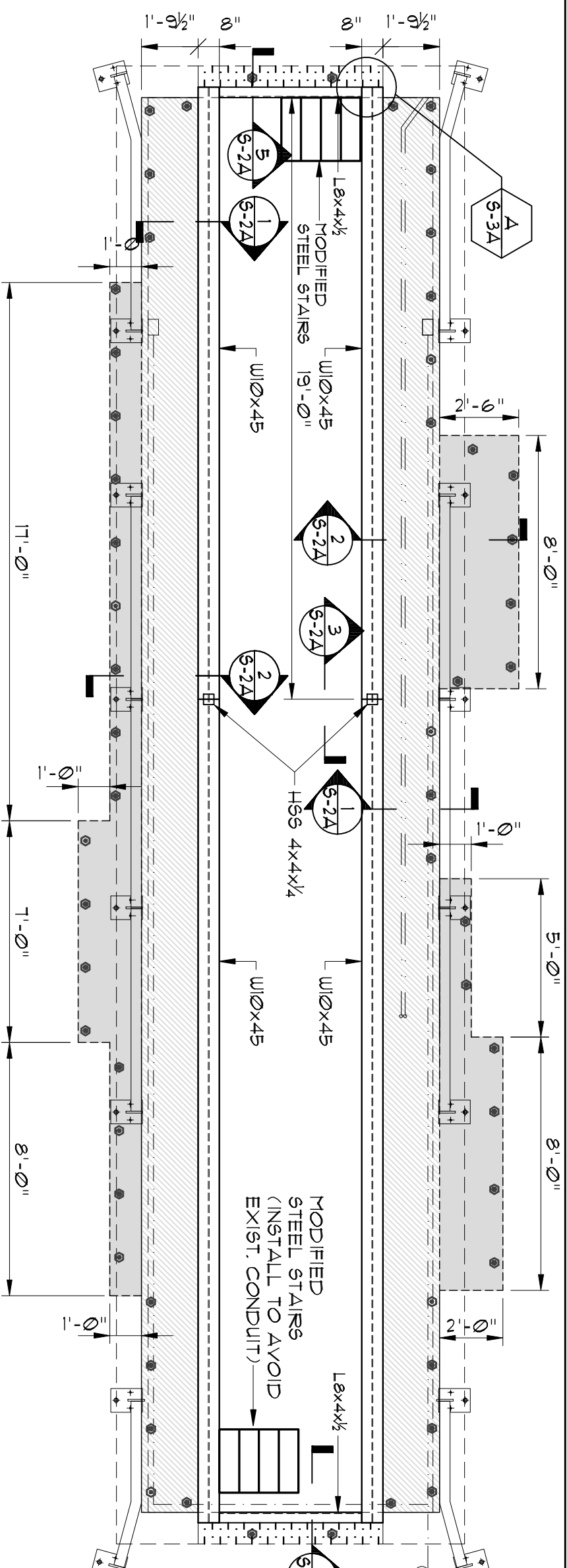

### NEW STEEL & SLAB REPAIR PLAN

REVISED FOR BUILDING PERMIT JUNE 20, 2013

GREATER PORTLAND TRANSIT DISTRICT  
INSPECTION PIT SLAB REPAIR PROJECT  
PORTLAND, MAINE

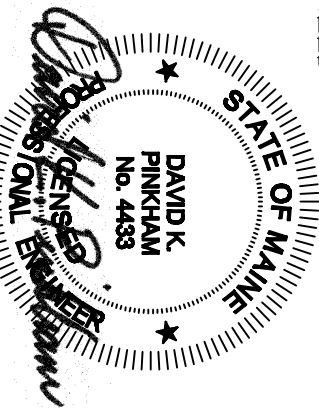

06-03-13

SCALE: 1/4"=1'-0"  
DATE: JUNE 3, 2013  
DESIGNED BY: DKP  
PROJECT: 12330-P  
SHEET 1 OF 4

