

**Granite Street Residence**

ADDITIONS & ALTERATIONS

Portland, Maine

Client:  
Carrie Lonsdale & Sean Ireland  
61 Granite Street  
Portland, Maine 04102

Architect:

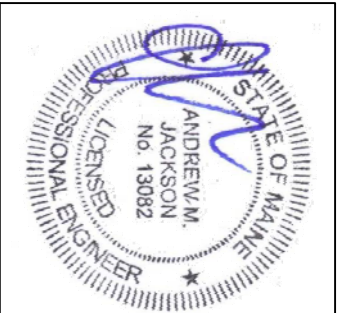

Issue Date	Revisions
January 3, 2013	For Permit

Drawing Title  
PROPOSED FOUNDATION PLAN

Drawn	Date
Checked	01.03.14
Scale	AS NOTED

Drawing No.  
**A.1.1**

Document

10. SONOTUBE MINIMUM DIAMETER  
6" MINIMUM PAD UNDER EACH TUBE  
SHOULD HAVE AN AREA OF 14 SQ FT

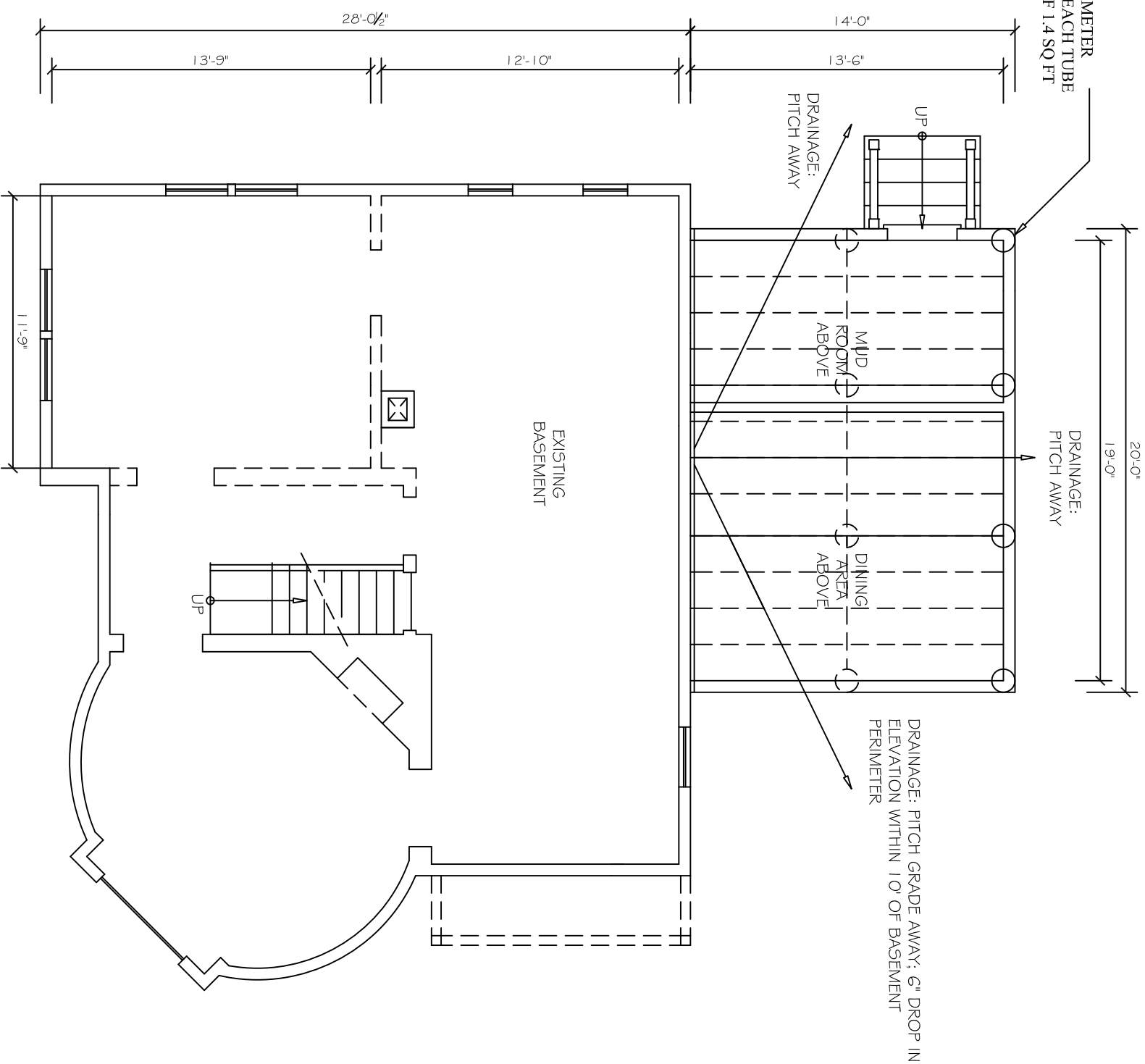

1 PROPOSED FOUNDATION PLAN  
1/8" = 1'-0"