

Granite Street Residence

ADDITIONS & ALTERATIONS

Portland, Maine

Client:
Carrie Lonsdale & Sean Ireland
61 Granite Street
Portland, Maine 04102

Architect:

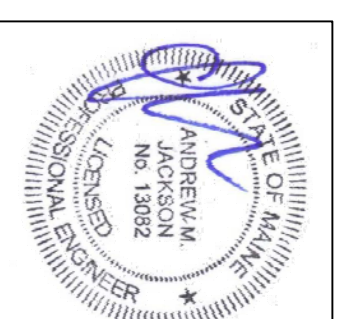

Issue Date	Revisions
January 3, 2013	For Permit

Drawing Title
EXISTING FOUNDATION &
BASEMENT PLAN

Drawn	Date
Checked	01.03.14
Scale	AS NOTED
Drawing No.	

A-0.1

Document

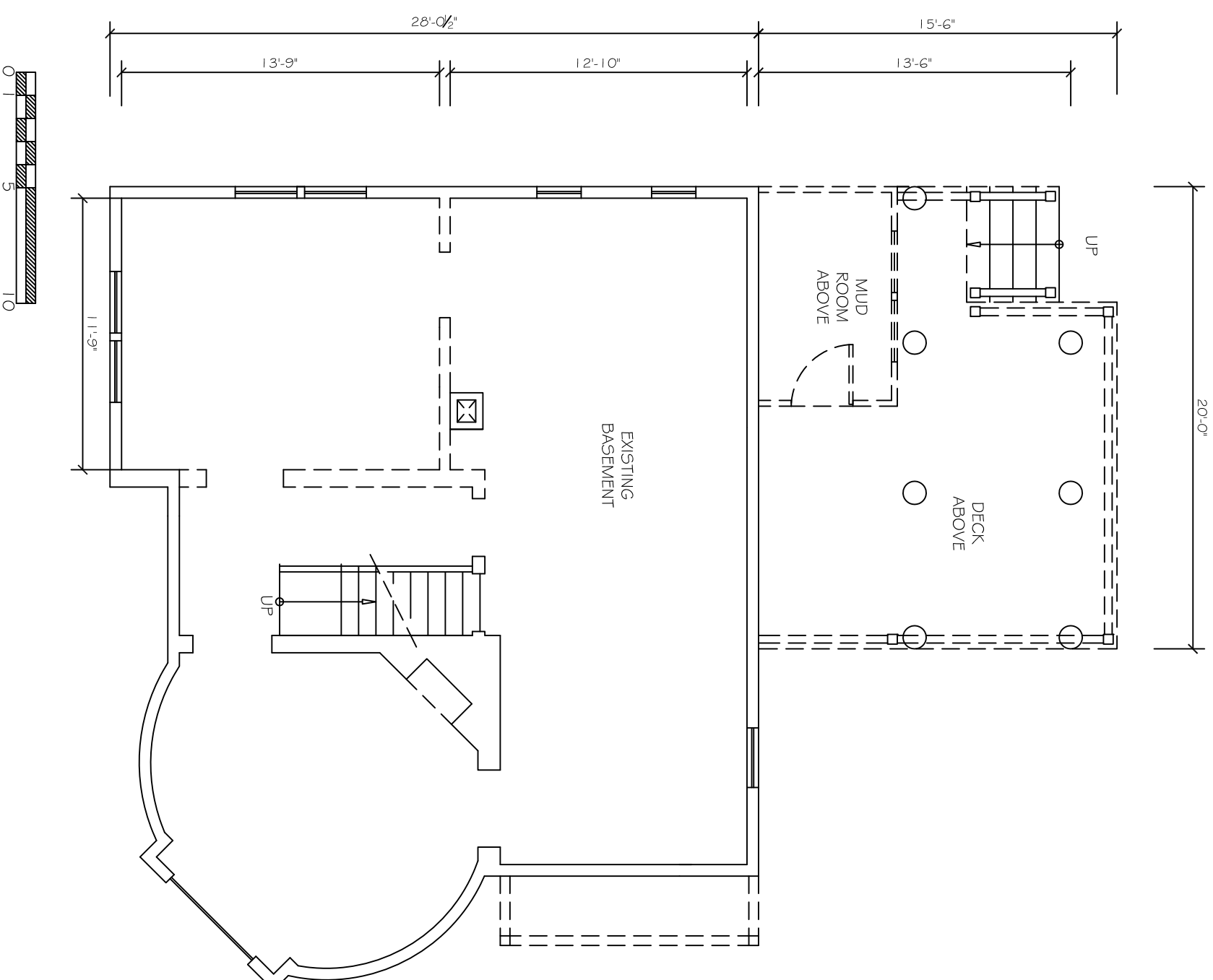

1 EXISTING BASEMENT AND FOUNDATION PLAN
1/8" = 1'-0"