

2 | THIRD FLOOR - ELECTRICAL PLAN
 1/8" = 1'-0" 0 2' 4' 8'

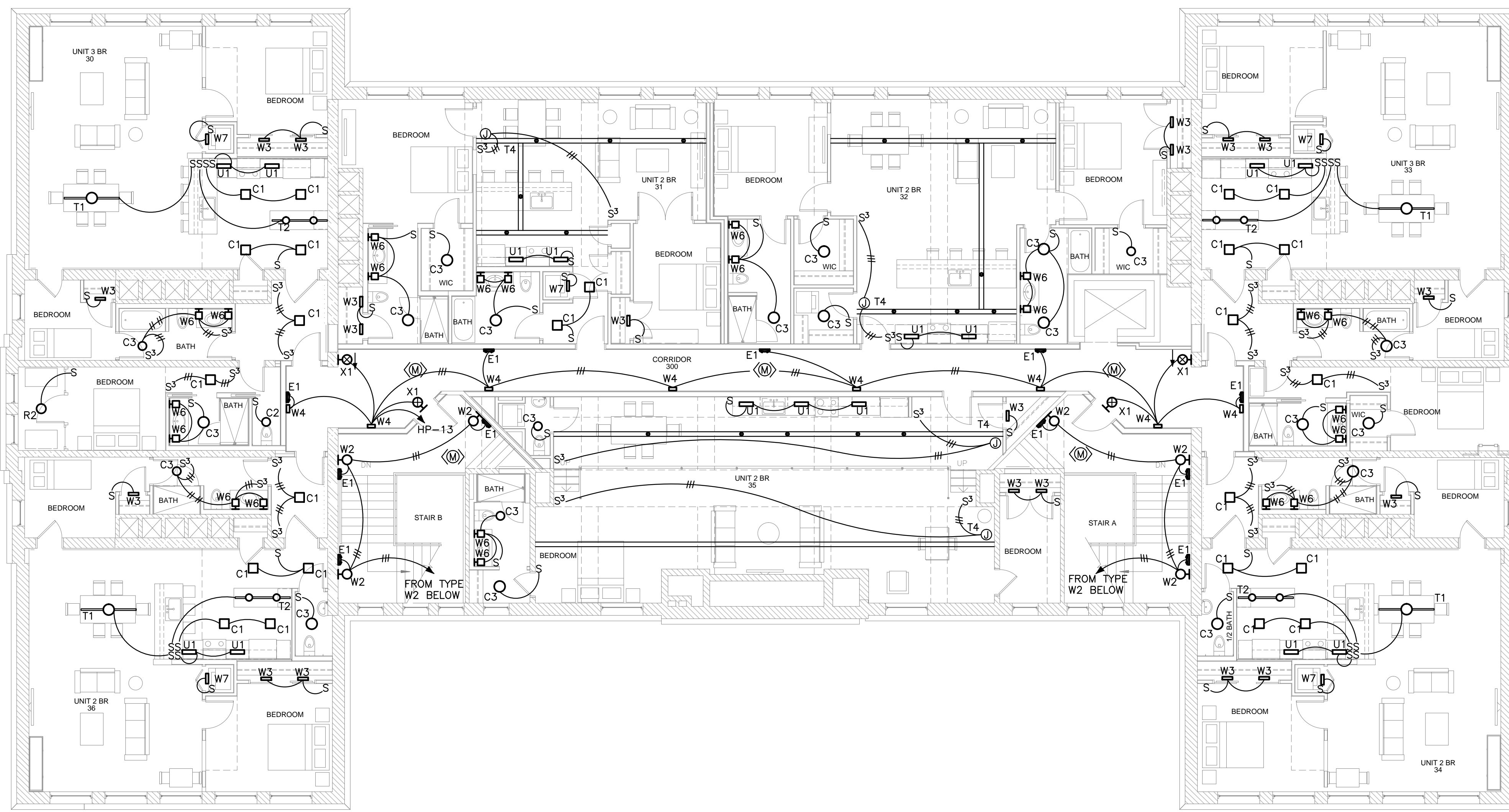

1 | THIRD FLOOR - LIGHTING PLAN
 1/8" = 1'-0" 0 2' 4' 8'

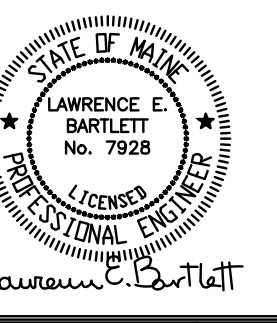

Prepared For:
Developers Collaborative

Consultant:
Bartlett Design
 LIGHTING & ELECTRICAL ENGINEERING
 48 Union Wharf Portland, Maine 04101
 TEL: (207) 443-3447 FAX: (207) 443-6800

Architect:
ARCHETYPE architects
 48 Union Wharf Portland, Maine 04101
 (207) 772-6022 ARCHETYPE@ARCHETYPEPA.COM

Project:
NATHAN CLIFFORD SCHOOL REDEVELOPMENT
 80 Falmouth Street Portland, Maine

Revisions:

Date: 15 JAN 2013
 Scale: 1/8" = 1'-0"
THIRD FLOOR LIGHTING & ELECTRICAL PLANS

E1.04