

2 | FIRST FLOOR - ELECTRICAL PLAN
1/8" = 1'-0"
0 20' 40' 80' 160'

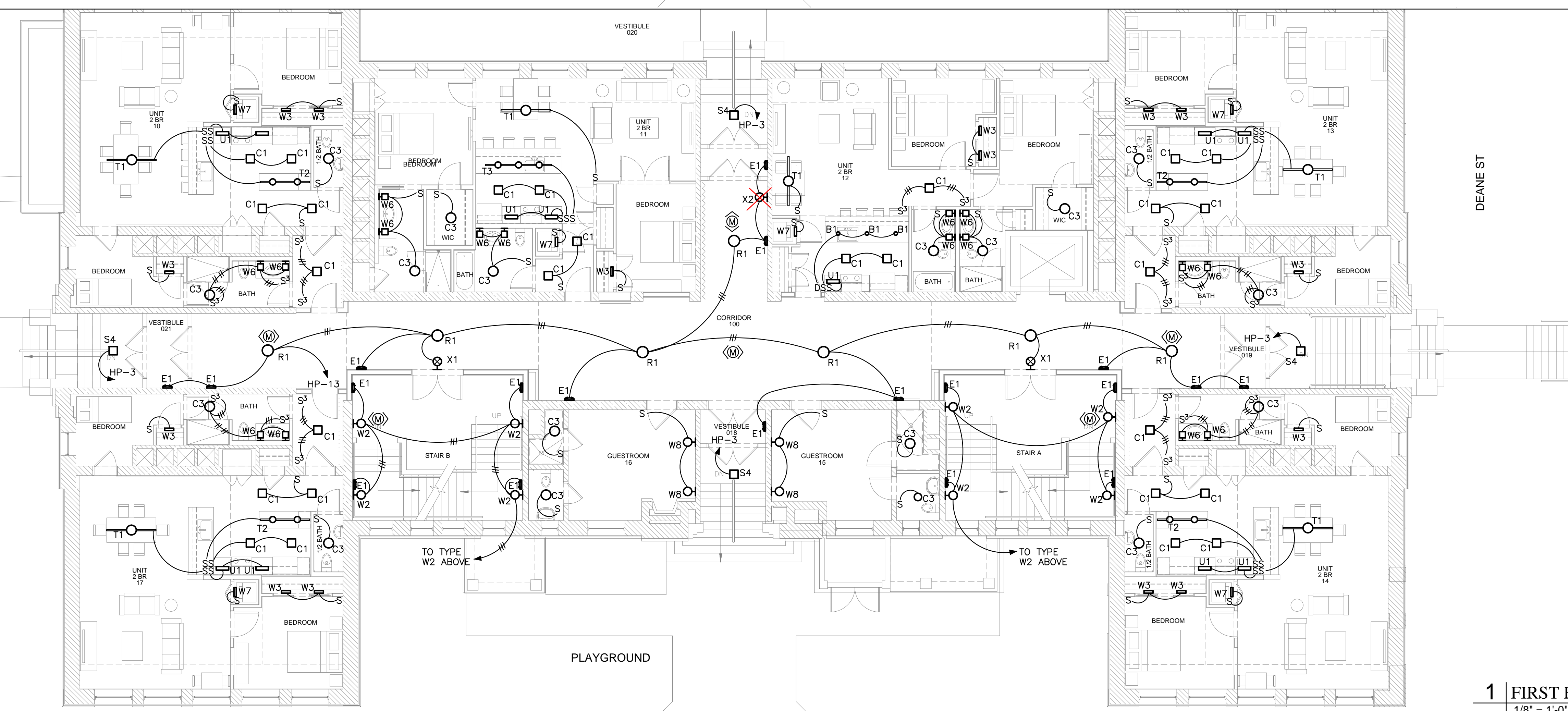

1 | FIRST FLOOR - LIGHTING PLAN
1/8" = 1'-0"
0 20' 40' 80' 160'



Prepared For:
Developers Collaborative

Consultant:
Bartlett Design
LIGHTING & ELECTRICAL ENGINEERING
1000 Commercial Street, Portland, ME 04101
TEL: (207) 442-3447 FAX: (207) 442-6900

Architect:
ARCHETYPE architects
48 Union Wharf Portland, Maine 04101
(207) 772-6022 ARCHETYPE@ARCHETYPEPA.COM

Project:
NATHAN CLIFFORD SCHOOL REDEVELOPMENT
80 Falmouth Street Portland, Maine

Revisions:

Date: 15 JAN 2013
Scale: 1/8" = 1'-0"
FIRST FLOOR LIGHTING & ELECTRICAL PLANS

E1.02