

GENERAL NOTES

1. PROVIDE NEW INSECT SCREENS AT WINDOW OPENINGS AT ALL NEW AND EXG ALUM. WINDOWS TO MATCH EXISTING.

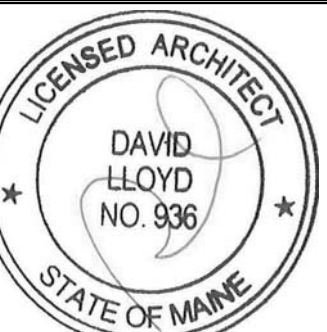

Prepared For:
Developers Collaborative
17 Chestnut Street
Portland, ME 04101

Consultant:
ARCHETYPE architects
48 Union Wharf Portland, Maine 04101
(207) 772-9022 ARCHETYPE@ARCHETYPEA.COM

Project:
NATHAN CLIFFORD SCHOOL REDEVELOPMENT
180 Falmouth Street Portland, Maine

Revisions:

Date: 15 JAN 2014
Scale: 3" = 1'-0"
WINDOW DETAILS

A8.03

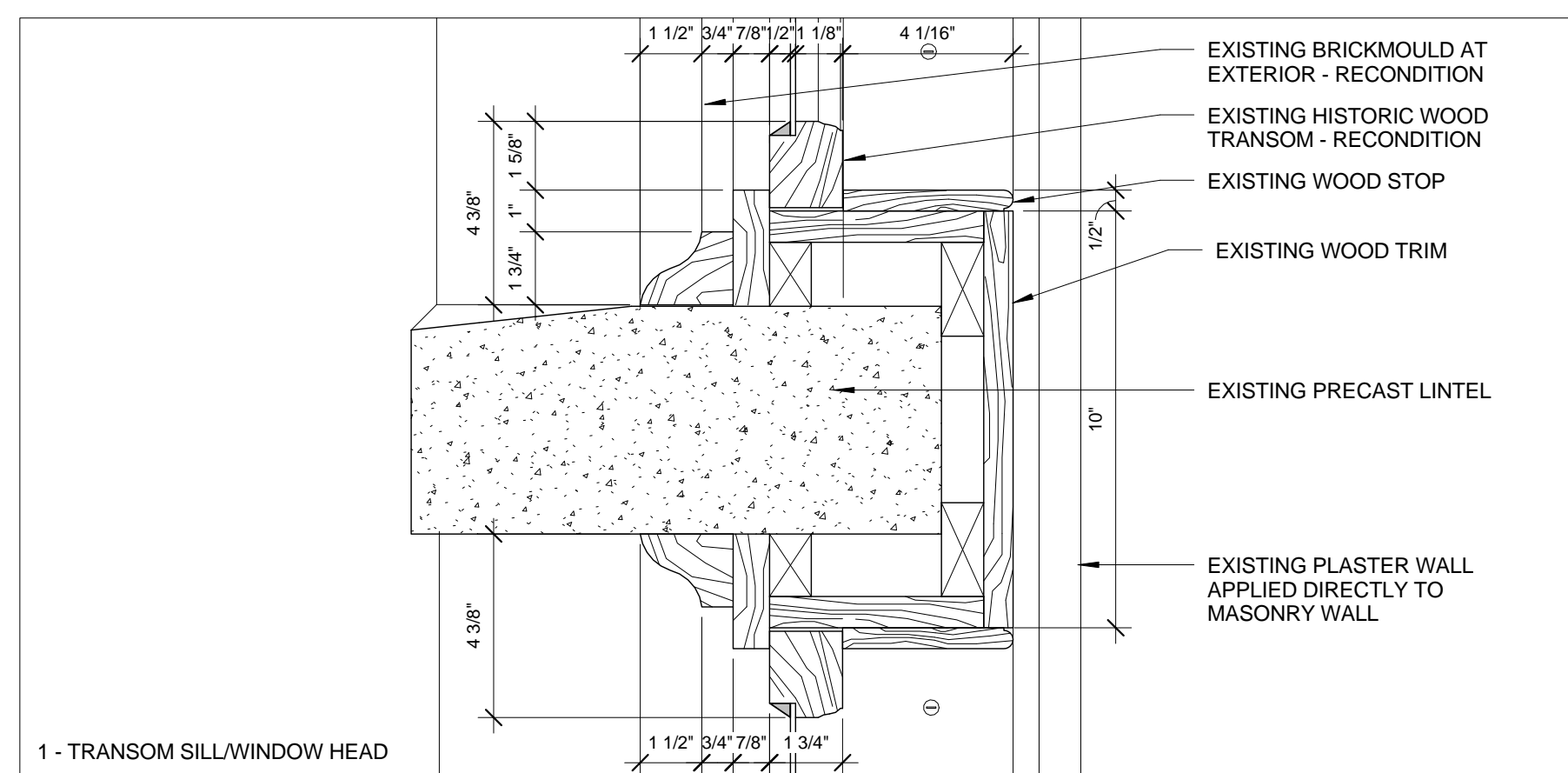
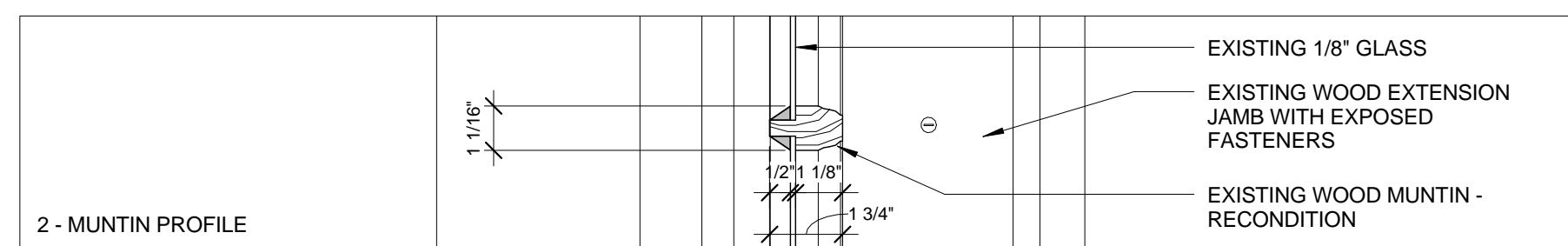
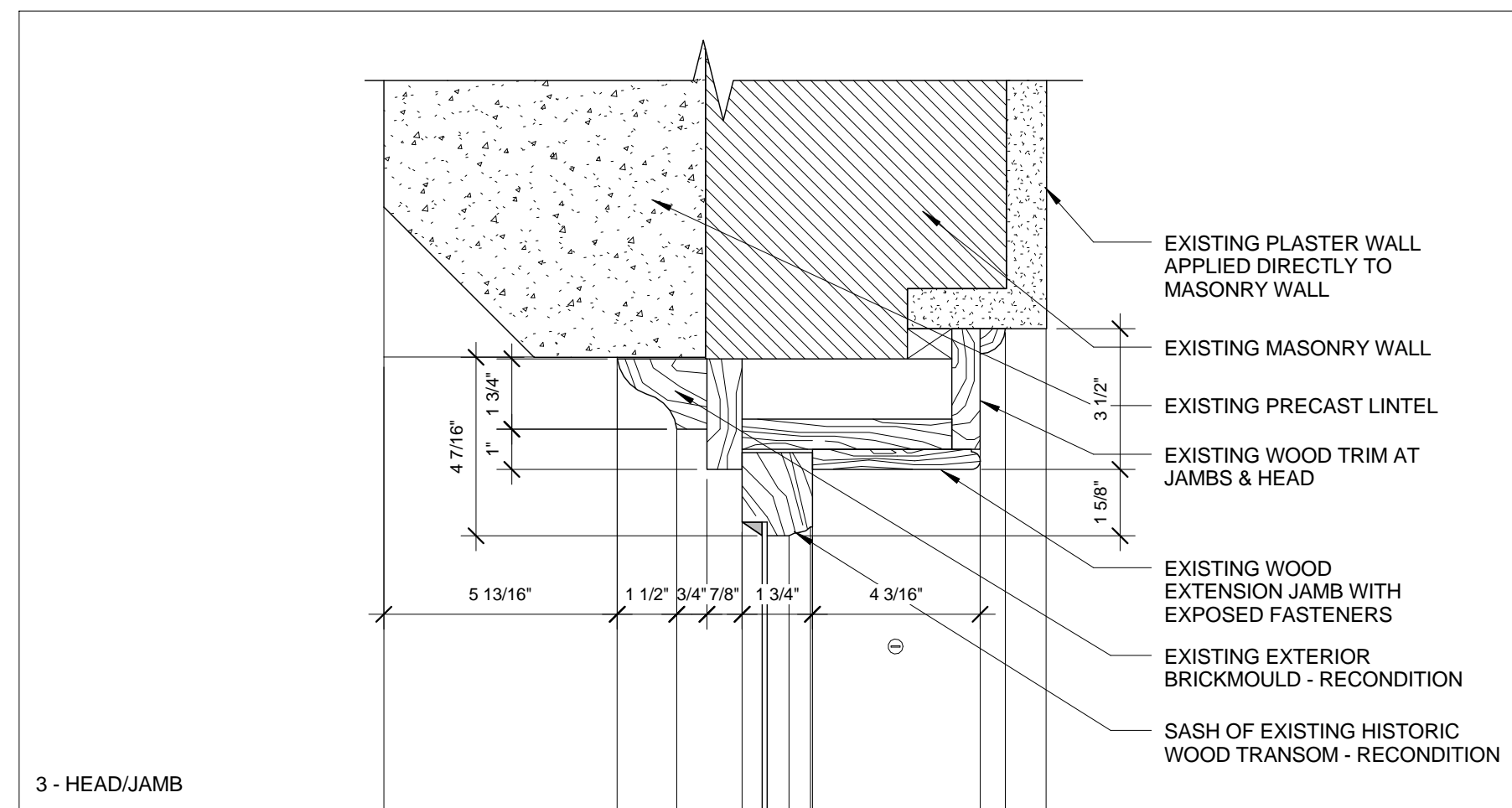
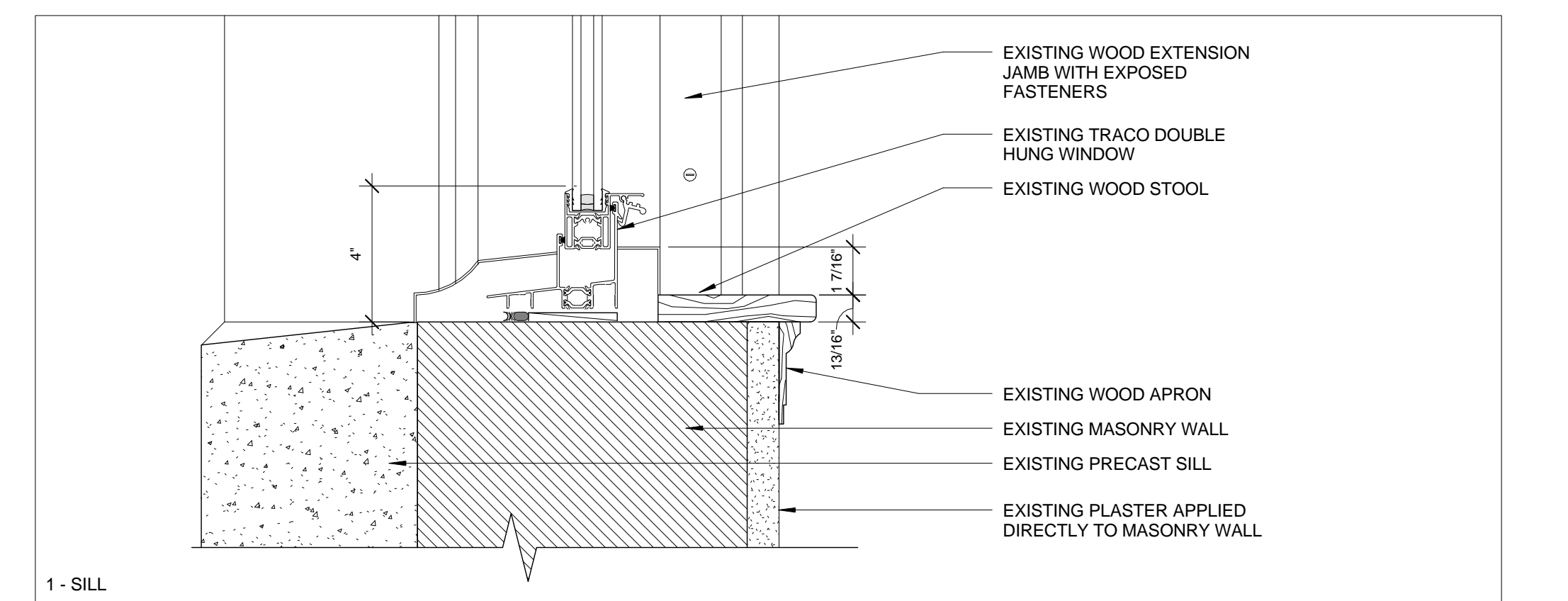
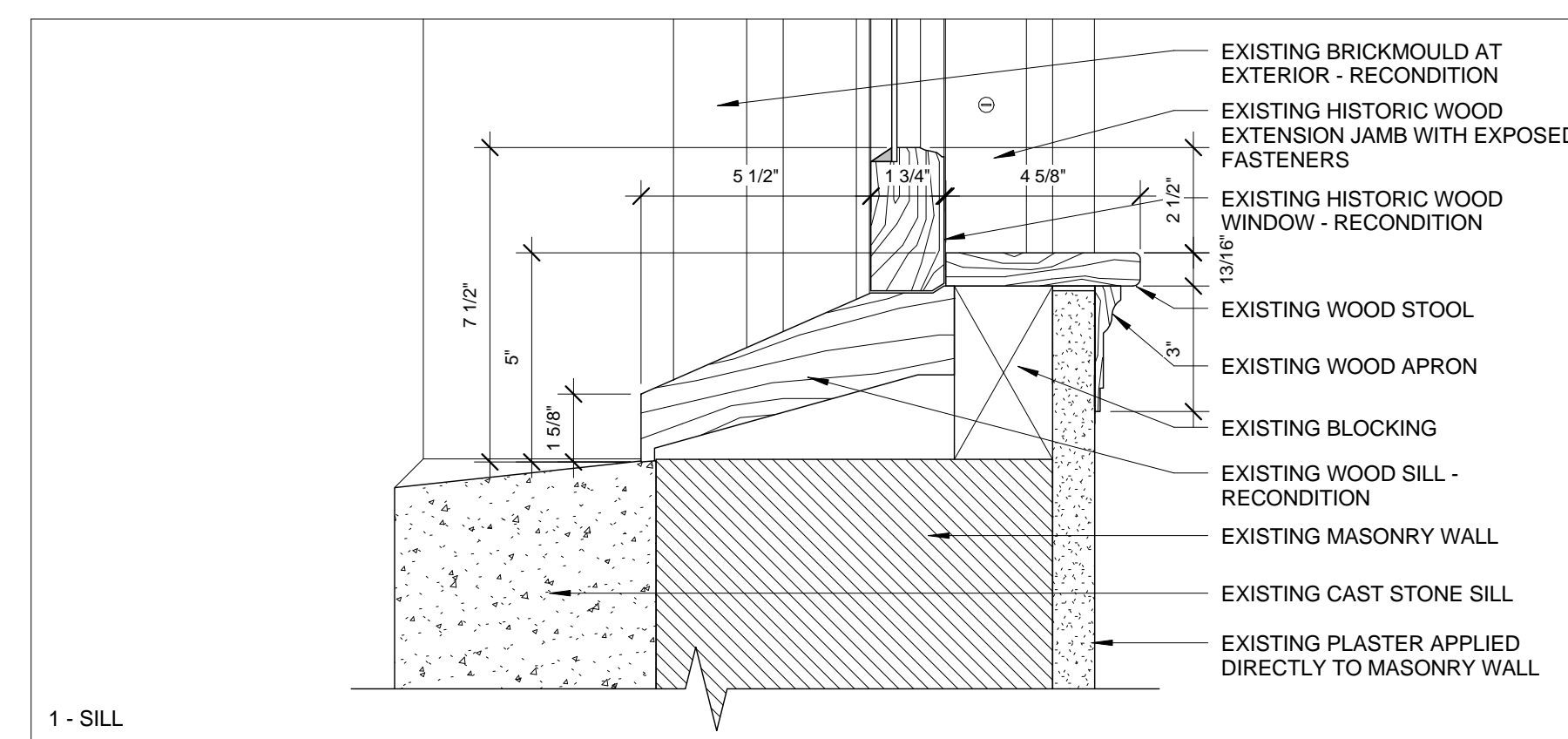
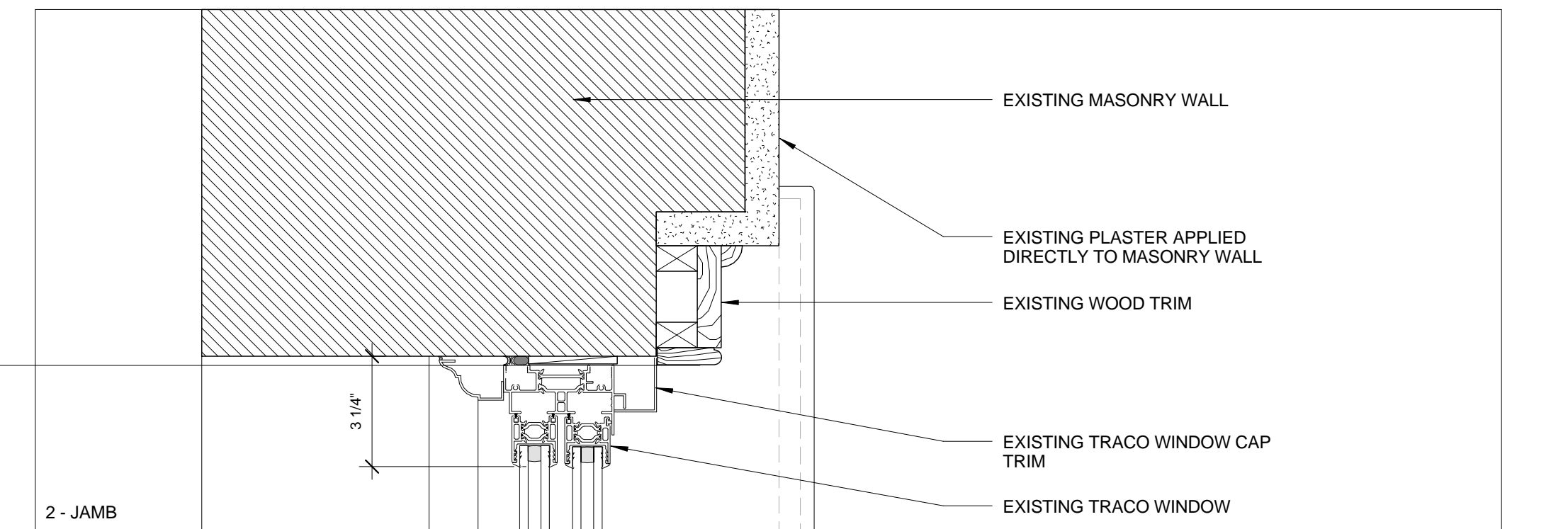
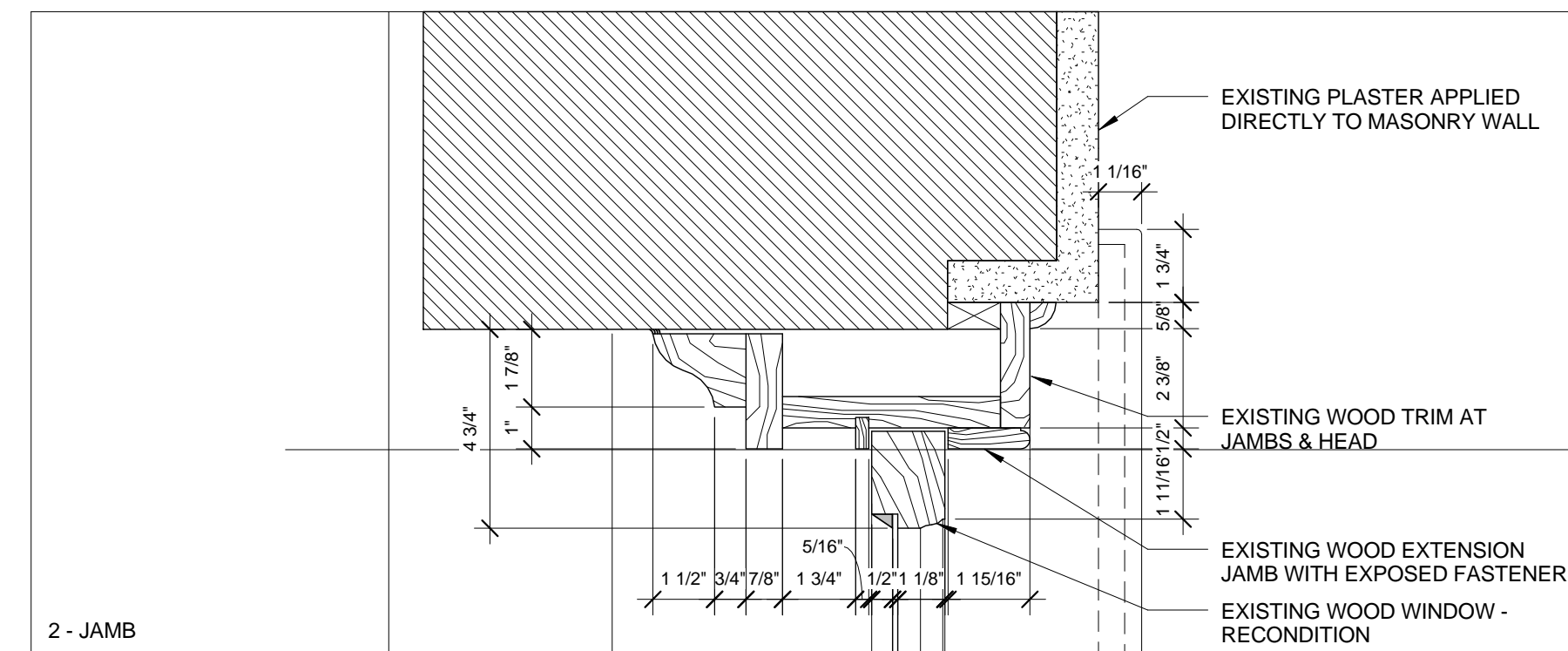
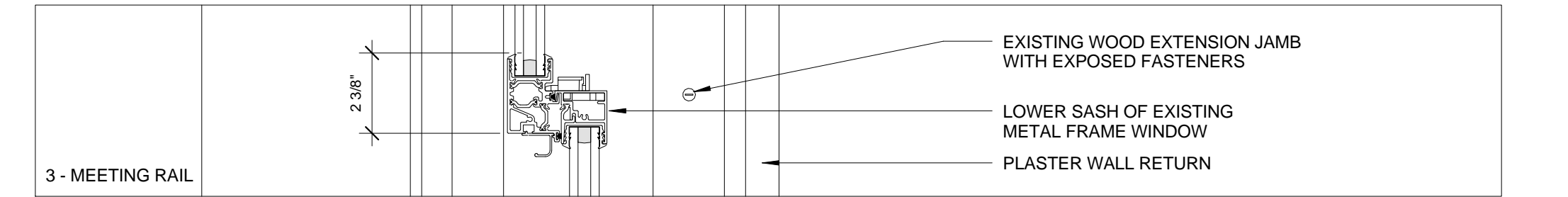
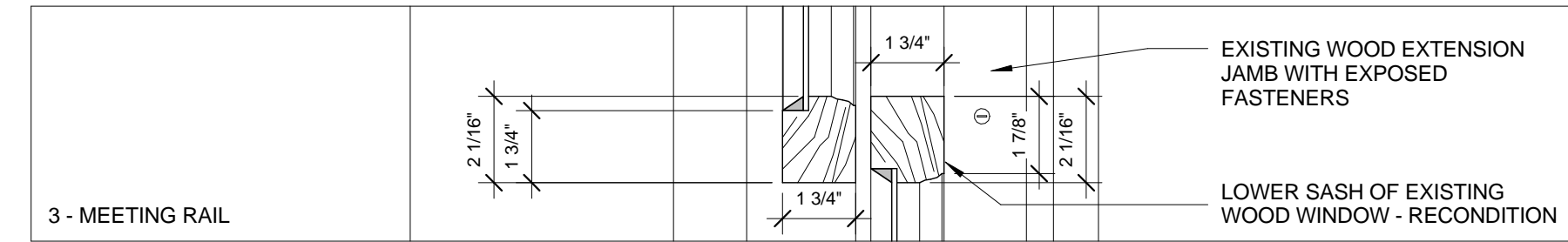
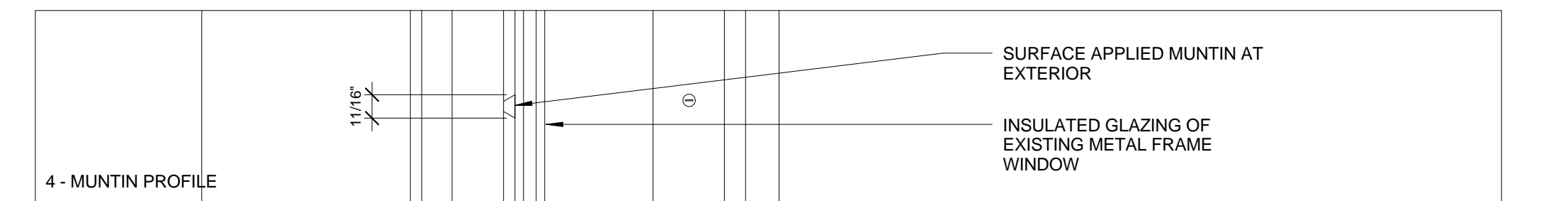
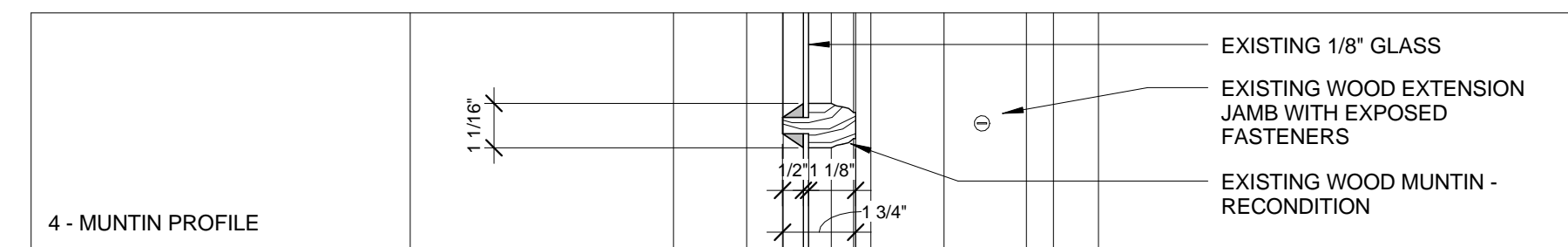
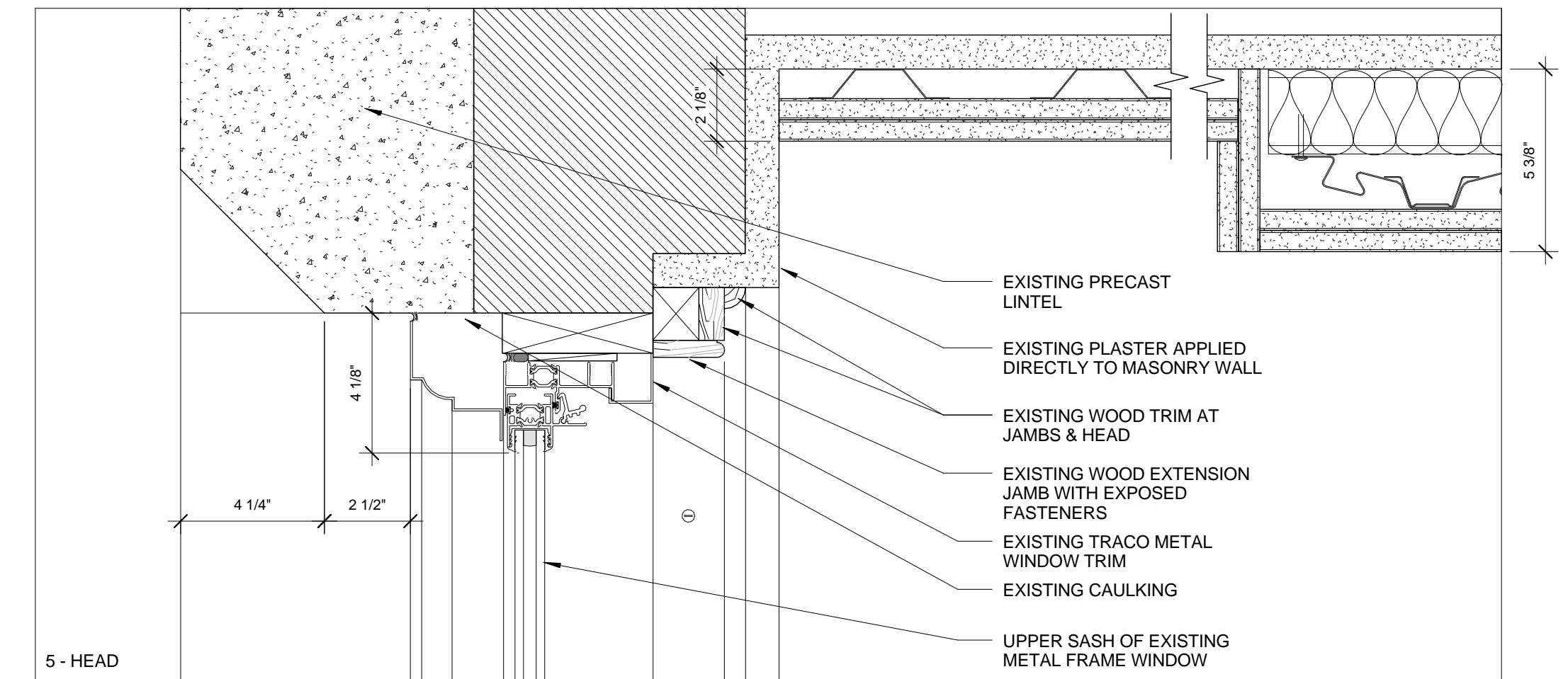
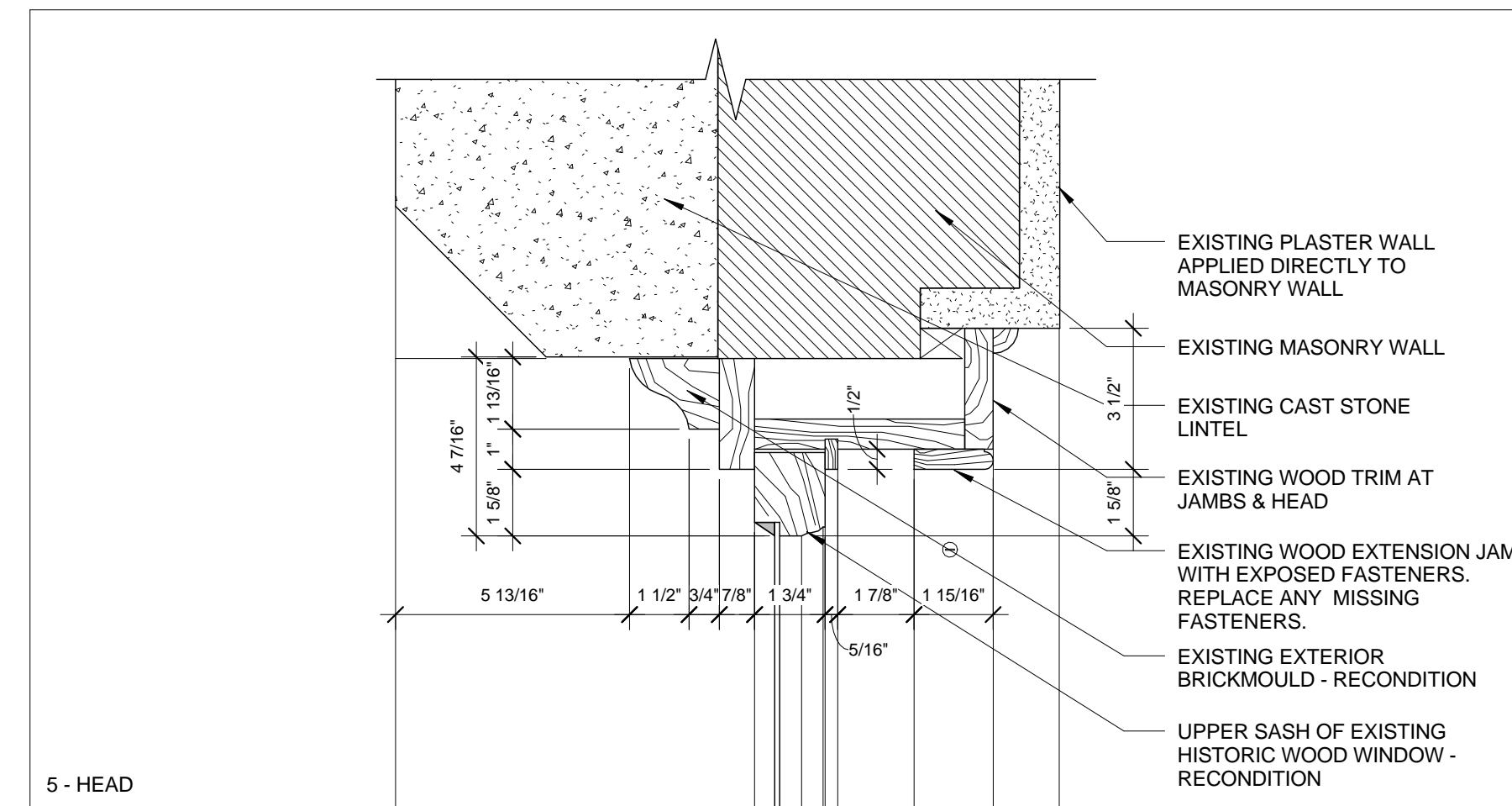

3 | EXISTING TRANSOM WINDOW SECTION - RECONDITIONED

2 | EXISTING WOOD WINDOW SECTION - RECONDITIONED

1 | EXISTING THIRD FLOOR ALUMINUM WINDOW SECTION

3" = 1'-0" 0 112 3 6 120

3" = 1'-0" 0 112 3 6 120

3" = 1'-0" 0 112 3 6 120