

2 | THIRD FLOOR PLASTER CONDITIONS PLAN
 1/8" = 1'-0"

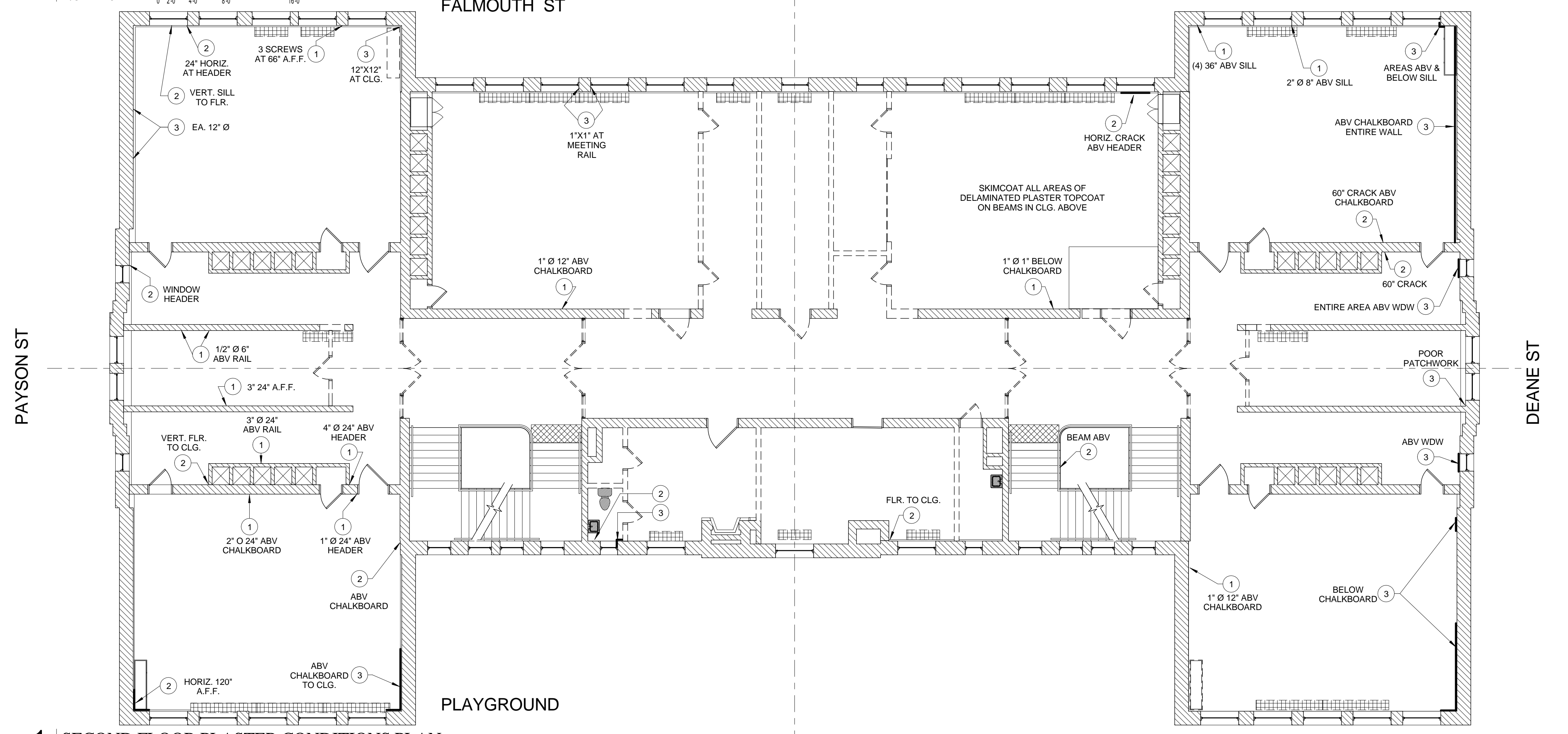

1 | SECOND FLOOR PLASTER CONDITIONS PLAN
 1/8" = 1'-0"

PLASTER REPAIR NOTES:
 PLASTER PLANS ARE PROVIDED TO ESTABLISH THE AREAS OF REPAIR.
 ALL PLASTER (HORIZ. OR VERTICAL) LEFT EXPOSED TO FINISHED SPACES AT THE COMPLETION OF WORK IS TO BE TREATED AS NECESSARY TO RECEIVE NEW FINISHES. SEE FINISH SCHEDULE FOR PROJECT FINISHES.
 REMOVE ALL CLASSROOM FF&E AND REPAIR PLASTER TO RECEIVE NEW FINISHES.
 SEE DEMO PLANS FOR EXTENT OF COATHOOKS AND CHALKBOARDS TO BE REMOVED.
 REPAIR PLASTER AT ALL BLEMMISHES DOCUMENTED IN PLASTER PLANS.

EXISTING PLASTER BLEMMISH LEGEND	
①	HOLE IN PLASTER - SEE PLAN FOR DIAMETER
②	CRACK IN PLASTER - SEE PLAN FOR LENGTH
③	DAMAGED PLASTER - SEE PLAN FOR SIZE