

- W11** NON-RATED NON-BEARING
STC SOUND - NA
- CONT. METAL FLOOR AND CEILING RUNNER - CHANNEL SHAPED, ATTACHED TO FLOOR AND CEILING WITH STEEL FASTENERS SPACED 24 IN. O.C. RUNNERS FABRICATED FROM MIN NO. 25MSG GALV. STEEL, 1 1/4 IN. DEEP AND 6 IN. WIDE.
 - STEEL STUDS - CHANNEL SHAPED, SUPPLIED WITH CUTOUTS, FRICTION FITTED INTO FLOOR AND CEILING RUNNER AND SPACED A MAX 24 IN. O.C. STUDS CUT 1/2" LESS THAN ASSEMBLY HEIGHT. STUDS FABRICATED FROM MIN. 25 MSG GALV. STEEL, MIN 3 5/8 IN. WIDE BY 1 5/8 IN. DEEP WITH 3/8 IN. FOLDED BACK RETURN FLANGE LEGS.
 - GYPSUM BOARD - 5/8 IN. THICK, 4 FT WIDE ATTACHED TO METAL STUDS WITH TYPE S STEEL SCREWS SPACED 8 IN. O.C. ALONG EDGES OF BOARD AND 12 IN. O.C. IN THE FIELD OF THE BOARD. JNTS. ORIENTED VERTICALLY AND STAGGERED ON OPPOSITE SIDES OF ASSEMBLY 48 IN. O.C.
 - SEALANT - SEALANT, FULL PERIMETER.
 - BLOCKING - (NOT SHOWN) WOOD BLOCKING AS NEEDED
 - TAPE AND COMPOUND - (NOT SHOWN) VINYL, DRY OR PREMIXED JOINT COMPOUND, APPLIED IN TWO COATS TO JOISTS AND SCREW HEADS, PAPER TAPE, 2 IN. WIDE, EMBEDDED IN FIRST LAYER OF COMPOUND OVER ALL JOISTS.
 - CEILING - AS NOTED
 - SCHEDULED BASE - AS NOTED
 - UNDERSIDE OF STRUCTURE
 - TOP OF STRUCTURE

NOTE: USE MOISTURE RESISTANT GYPSUM IN WET AREAS

12 | WALL TYPE 12 - FURRED OUT WET WALL
1 1/2" = 1'-0" 0 3 6 12 24

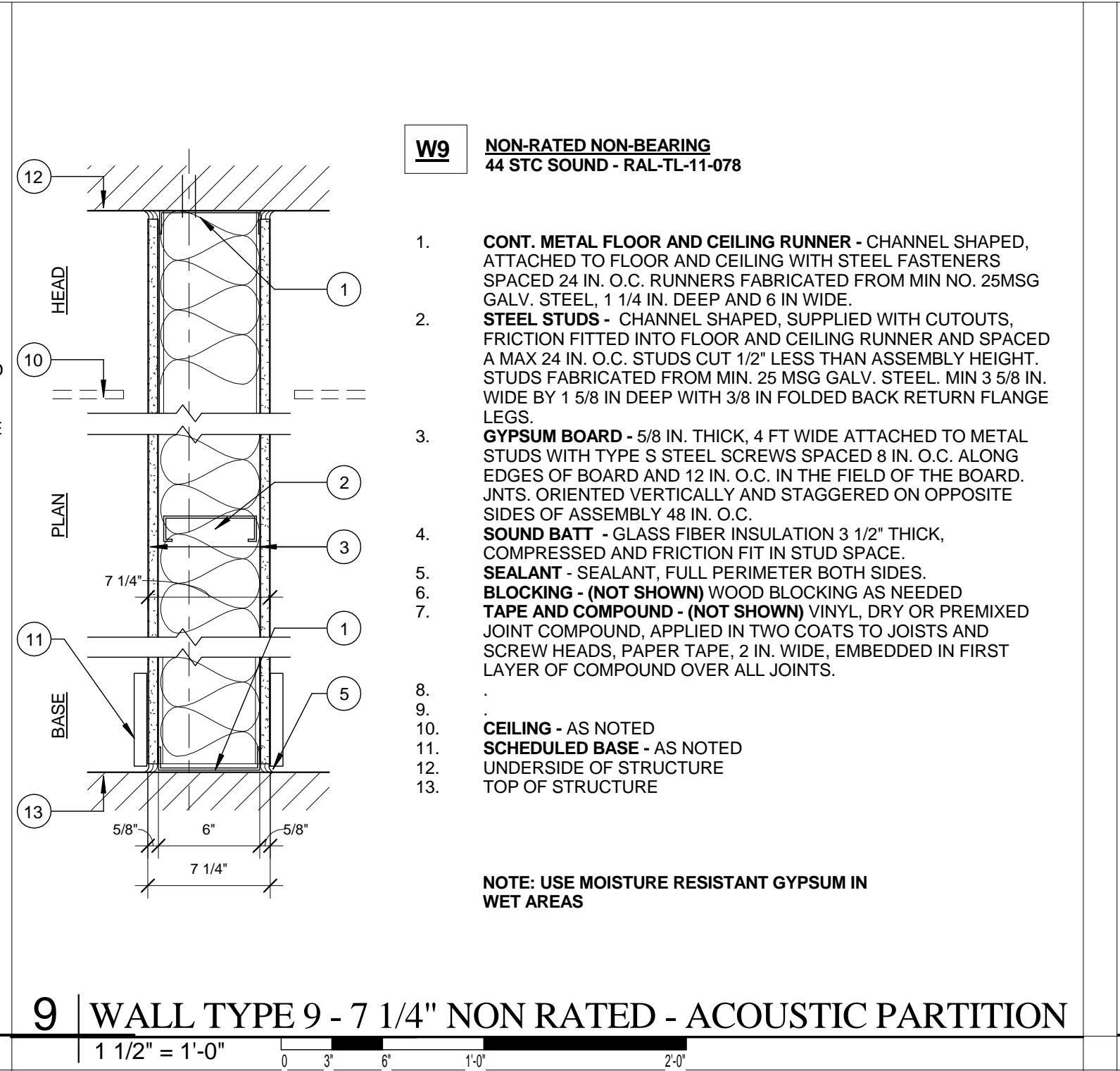

- W9** NON-RATED NON-BEARING
44 STC SOUND - RAL-TL-11-078
- CONT. METAL FLOOR AND CEILING RUNNER - CHANNEL SHAPED, ATTACHED TO FLOOR AND CEILING WITH STEEL FASTENERS SPACED 24 IN. O.C. RUNNERS FABRICATED FROM MIN NO. 25MSG GALV. STEEL, 1 1/4 IN. DEEP AND 6 IN. WIDE.
 - STEEL STUDS - CHANNEL SHAPED, SUPPLIED WITH CUTOUTS, FRICTION FITTED INTO FLOOR AND CEILING RUNNER AND SPACED A MAX 24 IN. O.C. STUDS CUT 1/2" LESS THAN ASSEMBLY HEIGHT. STUDS FABRICATED FROM MIN. 25 MSG GALV. STEEL, MIN 3 5/8 IN. WIDE BY 1 5/8 IN. DEEP WITH 3/8 IN. FOLDED BACK RETURN FLANGE LEGS.
 - GYPSUM BOARD - 5/8 IN. THICK, 4 FT WIDE ATTACHED TO METAL STUDS WITH TYPE S STEEL SCREWS SPACED 8 IN. O.C. ALONG EDGES OF BOARD AND 12 IN. O.C. IN THE FIELD OF THE BOARD. JNTS. ORIENTED VERTICALLY AND STAGGERED ON OPPOSITE SIDES OF ASSEMBLY 48 IN. O.C.
 - SOUND BATT - GLASS FIBER INSULATION 3 1/2" THICK, COMPRESSED AND FRICTION FIT IN STUD SPACE.
 - SEALANT - SEALANT, FULL PERIMETER BOTH SIDES.
 - BLOCKING - (NOT SHOWN) WOOD BLOCKING AS NEEDED
 - TAPE AND COMPOUND - (NOT SHOWN) VINYL, DRY OR PREMIXED JOINT COMPOUND, APPLIED IN TWO COATS TO JOISTS AND SCREW HEADS, PAPER TAPE, 2 IN. WIDE, EMBEDDED IN FIRST LAYER OF COMPOUND OVER ALL JOISTS.
 - CEILING - AS NOTED
 - SCHEDULED BASE - AS NOTED
 - UNDERSIDE OF STRUCTURE
 - TOP OF STRUCTURE

NOTE: USE MOISTURE RESISTANT GYPSUM IN WET AREAS

9 | WALL TYPE 9 - 7 1/4" NON RATED - ACOUSTIC PARTITION
1 1/2" = 1'-0" 0 3 6 12 24

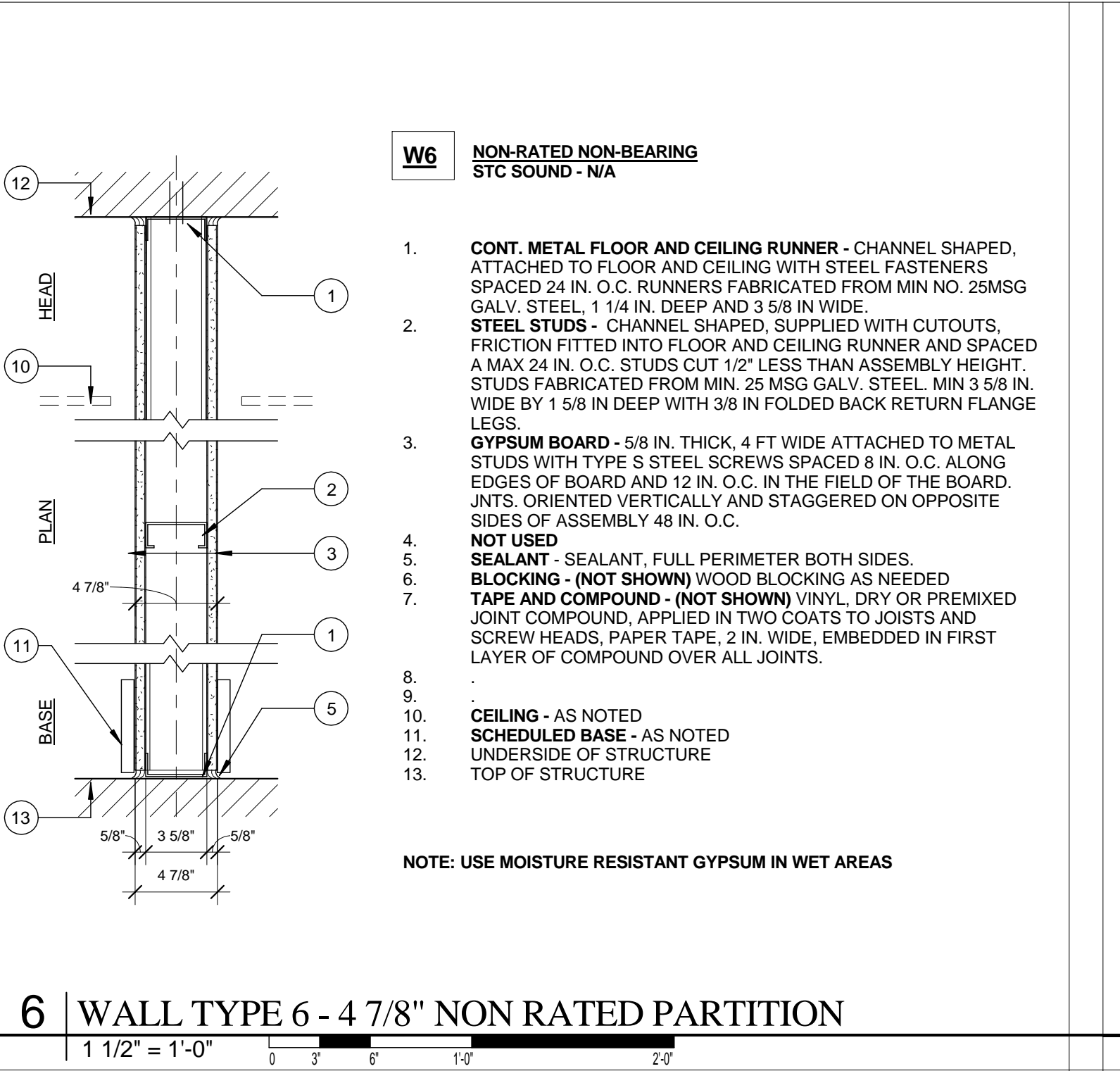

- W6** NON-RATED NON-BEARING
STC SOUND - NA
- CONT. METAL FLOOR AND CEILING RUNNER - CHANNEL SHAPED, ATTACHED TO FLOOR AND CEILING WITH STEEL FASTENERS SPACED 24 IN. O.C. RUNNERS FABRICATED FROM MIN NO. 25MSG GALV. STEEL, 1 1/4 IN. DEEP AND 3 5/8 IN. WIDE.
 - STEEL STUDS - CHANNEL SHAPED, SUPPLIED WITH CUTOUTS, FRICTION FITTED INTO FLOOR AND CEILING RUNNER AND SPACED A MAX 24 IN. O.C. STUDS CUT 1/2" LESS THAN ASSEMBLY HEIGHT. STUDS FABRICATED FROM MIN. 25 MSG GALV. STEEL, MIN 3 5/8 IN. WIDE BY 1 5/8 IN. DEEP WITH 3/8 IN. FOLDED BACK RETURN FLANGE LEGS.
 - GYPSUM BOARD - 5/8 IN. THICK, 4 FT WIDE ATTACHED TO METAL STUDS WITH TYPE S STEEL SCREWS SPACED 8 IN. O.C. ALONG EDGES OF BOARD AND 12 IN. O.C. IN THE FIELD OF THE BOARD. JNTS. ORIENTED VERTICALLY AND STAGGERED ON OPPOSITE SIDES OF ASSEMBLY 48 IN. O.C.
 - SEALANT - SEALANT, FULL PERIMETER BOTH SIDES.
 - BLOCKING - (NOT SHOWN) WOOD BLOCKING AS NEEDED
 - TAPE AND COMPOUND - (NOT SHOWN) VINYL, DRY OR PREMIXED JOINT COMPOUND, APPLIED IN TWO COATS TO JOISTS AND SCREW HEADS, PAPER TAPE, 2 IN. WIDE, EMBEDDED IN FIRST LAYER OF COMPOUND OVER ALL JOISTS.
 - CEILING - AS NOTED
 - SCHEDULED BASE - AS NOTED
 - UNDERSIDE OF STRUCTURE
 - TOP OF STRUCTURE

NOTE: USE MOISTURE RESISTANT GYPSUM IN WET AREAS

6 | WALL TYPE 6 - 4 7/8" NON RATED PARTITION
1 1/2" = 1'-0" 0 3 6 12 24

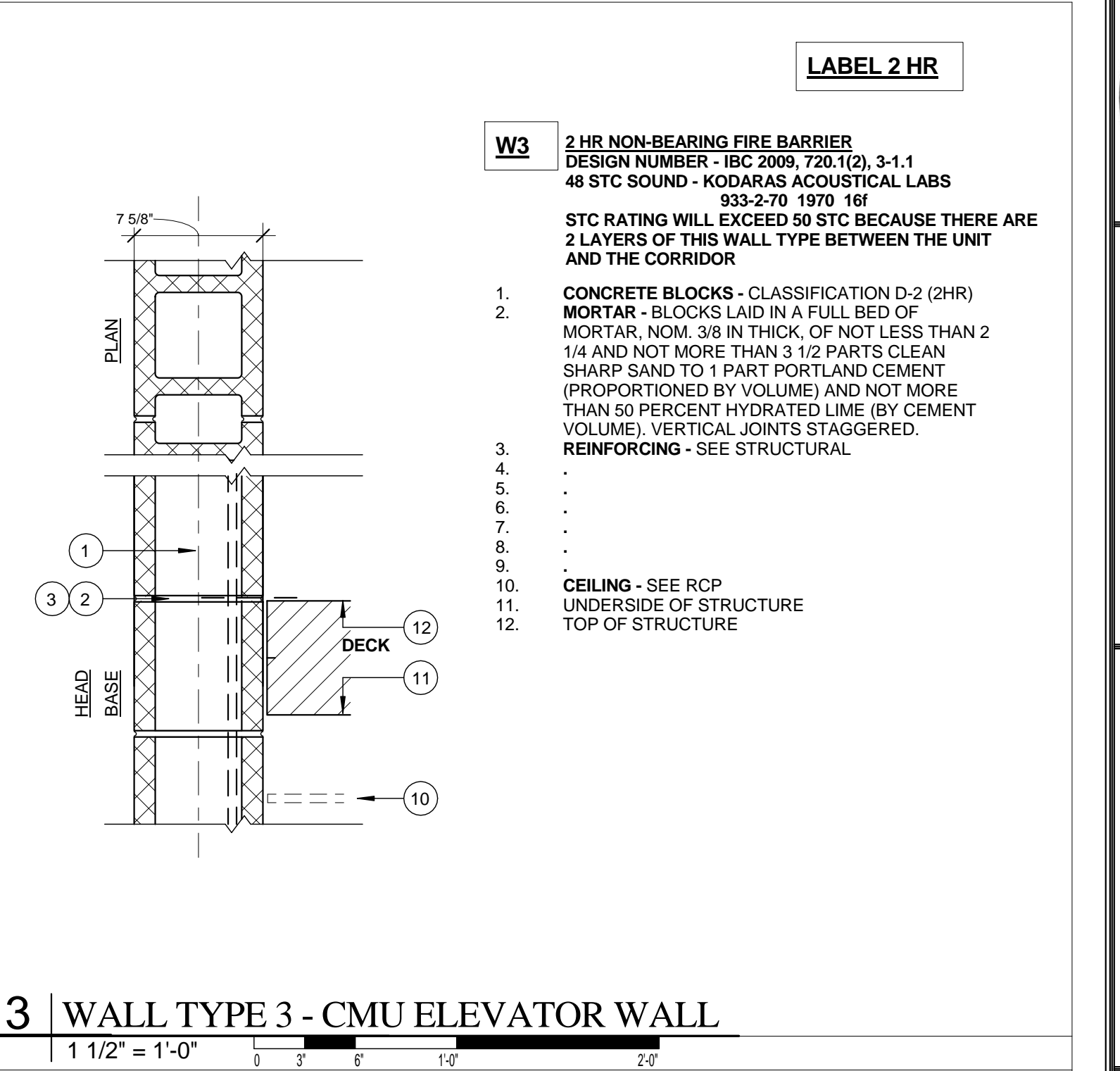

- W3** 2 HR NON-BEARING FIRE BARRIER
DESIGN NUMBER - IBC 2009, 720.1(2), 3-1.1
48 STC SOUND - KODARAS ACOUSTICAL LABS
933-270-1970 448
- STC RATING WILL EXCEED 50 STC BECAUSE THERE ARE 2 LAYERS OF THIS WALL TYPE BETWEEN THE UNIT AND THE CORRIDOR
- CONCRETE BLOCKS - CLASSIFICATION D-2 (2HR)
 - MORTAR - BLOCKS LAID IN A FULL BED OF MORTAR, NOM. 3/8 IN. THICK, OF NOT LESS THAN 2 1/4" AND NOT MORE THAN 3 1/2" PARTS CLEAR, SHARP SAND TO 1 PART PORTLAND CEMENT (PROPORTIONED BY VOLUME) AND NOT MORE THAN 50 PERCENT HYDRATED LIME (BY CEMENT VOLUME). VERTICAL JOINTS STAGGERED.
 - REINFORCING - SEE STRUCTURAL
 - CEILING - SEE RCP
 - UNDERSIDE OF STRUCTURE
 - TOP OF STRUCTURE

3 | WALL TYPE 3 - CMU ELEVATOR WALL
1 1/2" = 1'-0" 0 3 6 12 24

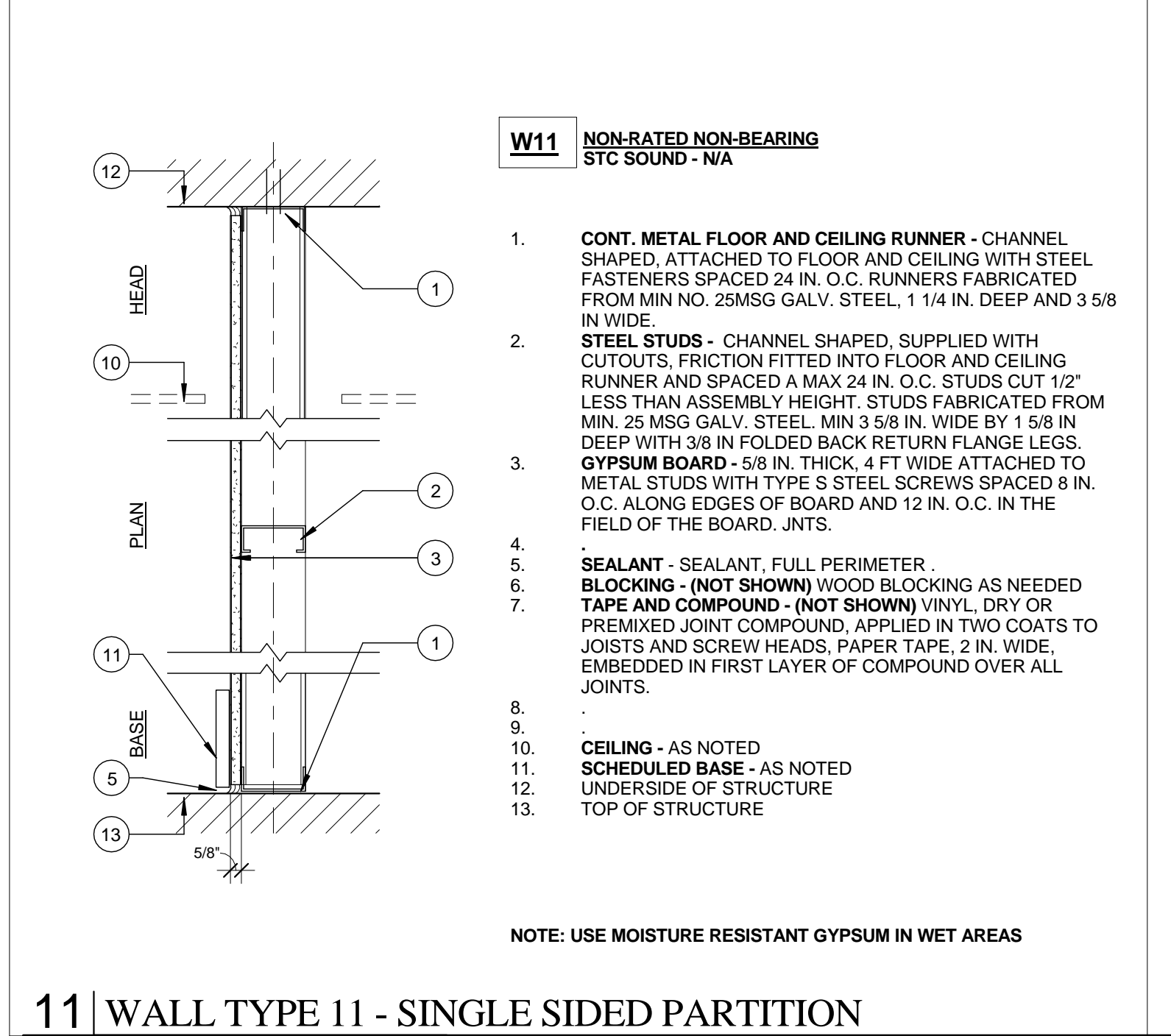

- W11** NON-RATED NON-BEARING
STC SOUND - NA
- CONT. METAL FLOOR AND CEILING RUNNER - CHANNEL SHAPED, ATTACHED TO FLOOR AND CEILING WITH STEEL FASTENERS SPACED 24 IN. O.C. RUNNERS FABRICATED FROM MIN NO. 25MSG GALV. STEEL, 1 1/4 IN. DEEP AND 3 5/8 IN. WIDE.
 - STEEL STUDS - CHANNEL SHAPED, SUPPLIED WITH CUTOUTS, FRICTION FITTED INTO FLOOR AND CEILING RUNNER AND SPACED A MAX 24 IN. O.C. STUDS CUT 1/2" LESS THAN ASSEMBLY HEIGHT. STUDS FABRICATED FROM MIN. 25 MSG GALV. STEEL, MIN 3 5/8 IN. WIDE BY 1 5/8 IN. DEEP WITH 3/8 IN. FOLDED BACK RETURN FLANGE LEGS.
 - GYPSUM BOARD - 5/8 IN. THICK, 4 FT WIDE ATTACHED TO METAL STUDS WITH TYPE S STEEL SCREWS SPACED 8 IN. O.C. ALONG EDGES OF BOARD AND 12 IN. O.C. IN THE FIELD OF THE BOARD. JNTS.
 - SEALANT - SEALANT, FULL PERIMETER.
 - BLOCKING - (NOT SHOWN) WOOD BLOCKING AS NEEDED
 - TAPE AND COMPOUND - (NOT SHOWN) VINYL, DRY OR PREMIXED JOINT COMPOUND, APPLIED IN TWO COATS TO JOISTS AND SCREW HEADS, PAPER TAPE, 2 IN. WIDE, EMBEDDED IN FIRST LAYER OF COMPOUND OVER ALL JOISTS.
 - CEILING - AS NOTED
 - SCHEDULED BASE - AS NOTED
 - UNDERSIDE OF STRUCTURE
 - TOP OF STRUCTURE

NOTE: USE MOISTURE RESISTANT GYPSUM IN WET AREAS

11 | WALL TYPE 11 - SINGLE SIDED PARTITION
1 1/2" = 1'-0" 0 3 6 12 24

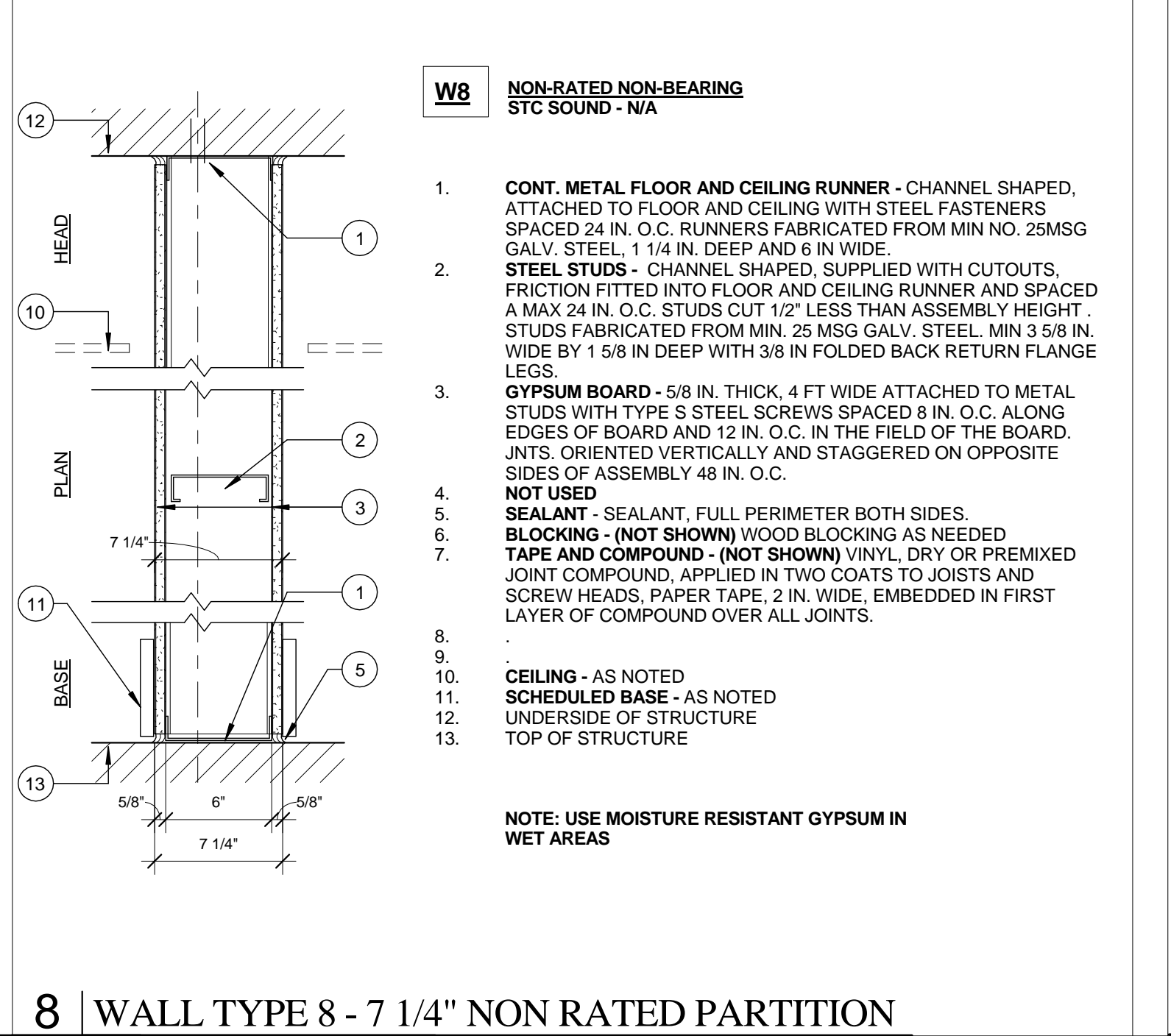

- W8** NON-RATED NON-BEARING
STC SOUND - NA
- CONT. METAL FLOOR AND CEILING RUNNER - CHANNEL SHAPED, ATTACHED TO FLOOR AND CEILING WITH STEEL FASTENERS SPACED 24 IN. O.C. RUNNERS FABRICATED FROM MIN NO. 25MSG GALV. STEEL, 1 1/4 IN. DEEP AND 6 IN. WIDE.
 - STEEL STUDS - CHANNEL SHAPED, SUPPLIED WITH CUTOUTS, FRICTION FITTED INTO FLOOR AND CEILING RUNNER AND SPACED A MAX 24 IN. O.C. STUDS CUT 1/2" LESS THAN ASSEMBLY HEIGHT. STUDS FABRICATED FROM MIN. 25 MSG GALV. STEEL, MIN 3 5/8 IN. WIDE BY 1 5/8 IN. DEEP WITH 3/8 IN. FOLDED BACK RETURN FLANGE LEGS.
 - GYPSUM BOARD - 5/8 IN. THICK, 4 FT WIDE ATTACHED TO METAL STUDS WITH TYPE S STEEL SCREWS SPACED 8 IN. O.C. ALONG EDGES OF BOARD AND 12 IN. O.C. IN THE FIELD OF THE BOARD. JNTS. ORIENTED VERTICALLY AND STAGGERED ON OPPOSITE SIDES OF ASSEMBLY 48 IN. O.C.
 - NOT USED
 - SEALANT - SEALANT, FULL PERIMETER BOTH SIDES.
 - BLOCKING - (NOT SHOWN) WOOD BLOCKING AS NEEDED
 - TAPE AND COMPOUND - (NOT SHOWN) VINYL, DRY OR PREMIXED JOINT COMPOUND, APPLIED IN TWO COATS TO JOISTS AND SCREW HEADS, PAPER TAPE, 2 IN. WIDE, EMBEDDED IN FIRST LAYER OF COMPOUND OVER ALL JOISTS.
 - CEILING - AS NOTED
 - SCHEDULED BASE - AS NOTED
 - UNDERSIDE OF STRUCTURE
 - TOP OF STRUCTURE

NOTE: USE MOISTURE RESISTANT GYPSUM IN WET AREAS

8 | WALL TYPE 8 - 7 1/4" NON RATED PARTITION
1 1/2" = 1'-0" 0 3 6 12 24

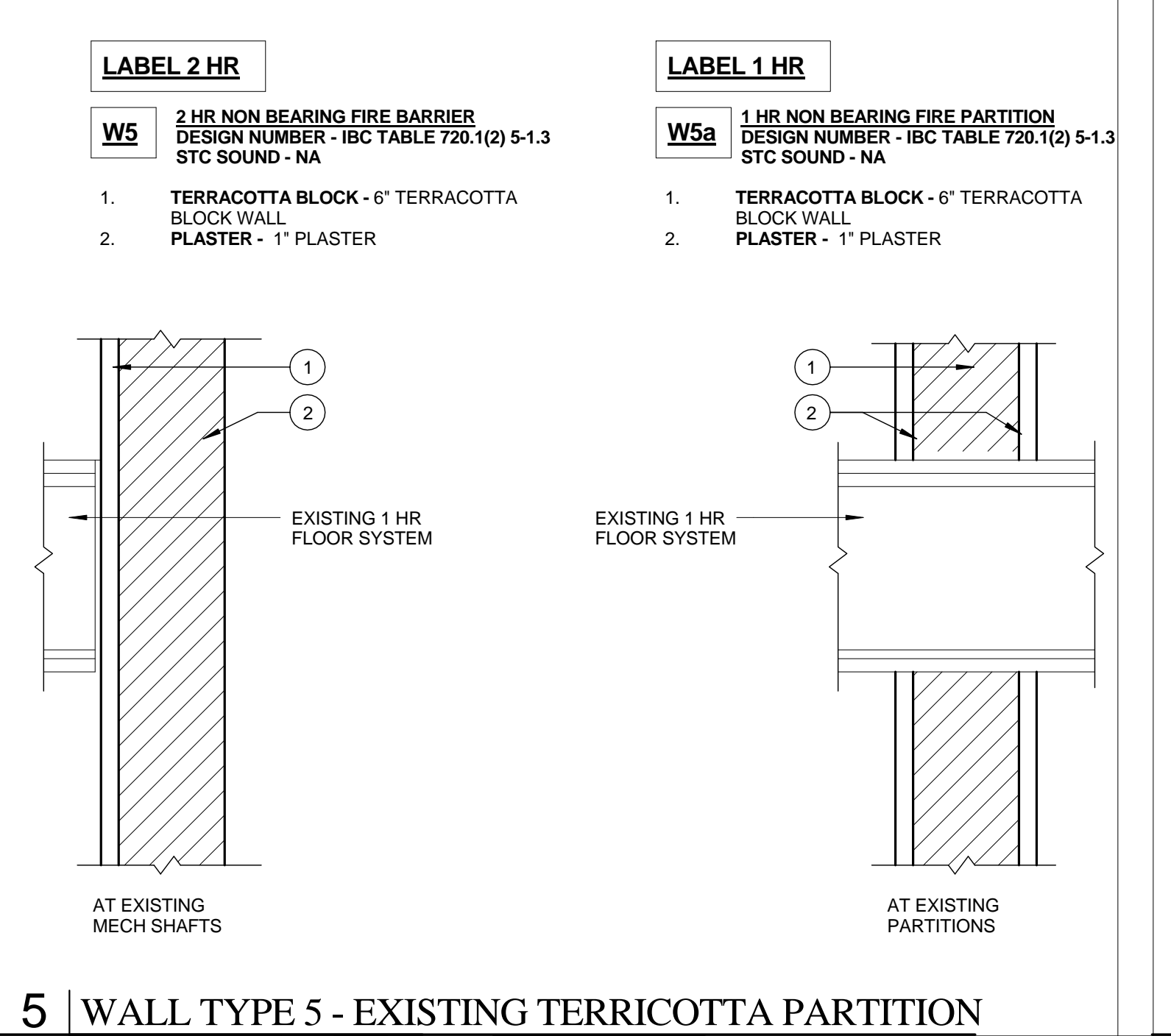

- W5** 2 HR NON BEARING FIRE BARRIER
DESIGN NUMBER - IBC TABLE 720.1(2) 5-1.3
STC SOUND - NA
- TERRACOTTA BLOCK - 6" TERRACOTTA BLOCK WALL
 - PLASTER - 1" PLASTER

AT EXISTING MECH SHAFTS

5 | WALL TYPE 5 - EXISTING TERRACOTTA PARTITION
1 1/2" = 1'-0" 0 3 6 12 24

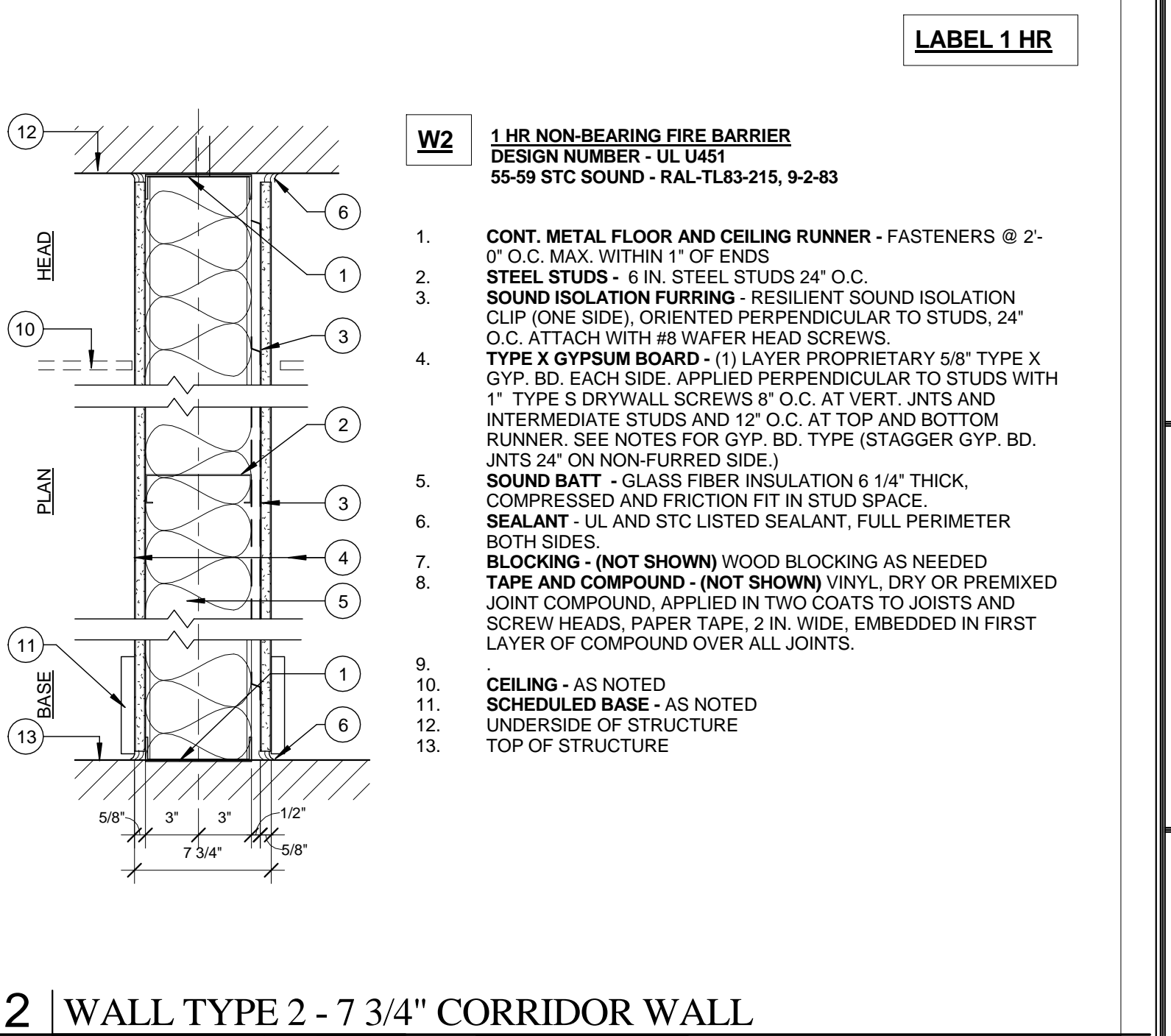

- W2** 1 HR NON-BEARING FIRE BARRIER
DESIGN NUMBER - UL U451
55-59 STC SOUND - RAL-TL83-215, 9-2-83
- CONT. METAL FLOOR AND CEILING RUNNER - FASTENERS @ 2'-0" O.C. MAX. WITHIN 1' OF ENDS
 - STEEL STUDS - 6 IN. STEEL STUDS 24" O.C.
 - SOUND ISOLATION FURRING - RESILIENT SOUND ISOLATION CLIP (ONE SIDE), ORIENTED PERPENDICULAR TO STUDS, 24" O.C. ATTACH WITH #6 WAFFER HEAD SCREWS.
 - TYPE X GYPSUM BOARD - (1) LAYER PROPRIETARY 5/8" TYPE X GYP. BD. EACH SIDE. APPLIED PERPENDICULAR TO STUDS WITH 1" TYPE S DRYWALL SCREWS 8" O.C. AT VERT. JNTS AND INTERMEDIATE STUDS AND 12" O.C. AT TOP AND BOTTOM RUNNER. SEE NOTES FOR GYP. BD. TYPE (STAGGER GYP. BD. JNTS 24" ON NON-FURRED SIDE)
 - SOUND BATT - GLASS FIBER INSULATION 6 1/4" THICK, COMPRESSED AND FRICTION FIT IN STUD SPACE.
 - SEALANT - UL AND STC LISTED SEALANT, FULL PERIMETER BOTH SIDES.
 - BLOCKING - (NOT SHOWN) WOOD BLOCKING AS NEEDED
 - TAPE AND COMPOUND - (NOT SHOWN) VINYL, DRY OR PREMIXED JOINT COMPOUND, APPLIED IN TWO COATS TO JOISTS AND SCREW HEADS, PAPER TAPE, 2 IN. WIDE, EMBEDDED IN FIRST LAYER OF COMPOUND OVER ALL JOISTS.
 - CEILING - AS NOTED
 - SCHEDULED BASE - AS NOTED
 - UNDERSIDE OF STRUCTURE
 - TOP OF STRUCTURE

2 | WALL TYPE 2 - 7 3/4" CORRIDOR WALL
1 1/2" = 1'-0" 0 3 6 12 24

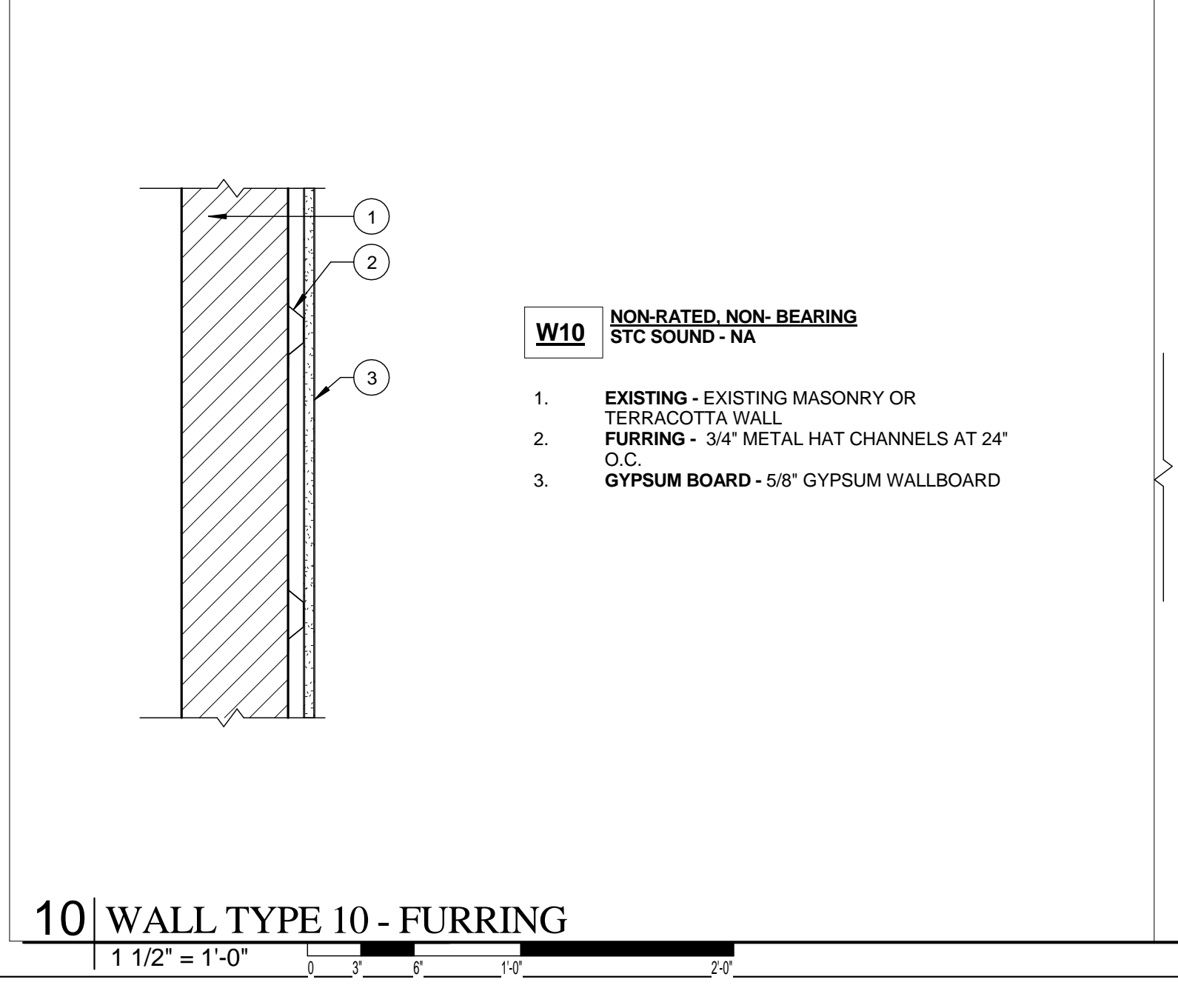

- W10** NON-RATED NON-BEARING
STC SOUND - NA
- EXISTING - EXISTING MASONRY OR TERRACOTTA WALL
 - FURRING - 3/4" METAL HAT CHANNELS AT 24" O.C.
 - GYPSUM BOARD - 5/8" GYPSUM WALLBOARD

NOTE: USE MOISTURE RESISTANT GYPSUM IN WET AREAS

10 | WALL TYPE 10 - FURRING
1 1/2" = 1'-0" 0 3 6 12 24

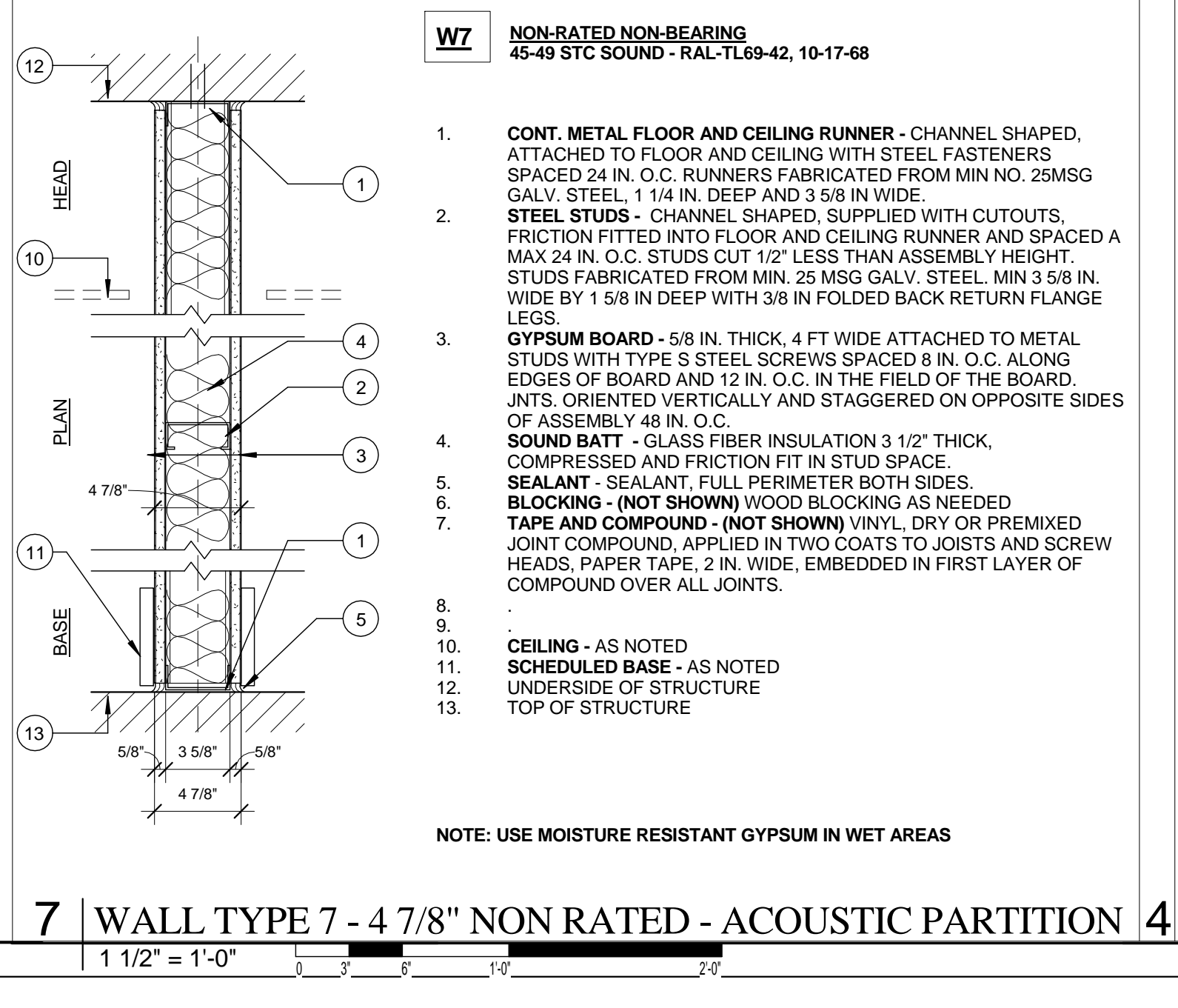

- W7** NON-RATED NON-BEARING
45-49 STC SOUND - RAL-TL69-42, 10-17-68
- CONT. METAL FLOOR AND CEILING RUNNER - CHANNEL SHAPED, ATTACHED TO FLOOR AND CEILING WITH STEEL FASTENERS SPACED 24 IN. O.C. RUNNERS FABRICATED FROM MIN NO. 25MSG GALV. STEEL, 1 1/4 IN. DEEP AND 3 5/8 IN. WIDE.
 - STEEL STUDS - CHANNEL SHAPED, SUPPLIED WITH CUTOUTS, FRICTION FITTED INTO FLOOR AND CEILING RUNNER AND SPACED A MAX 24 IN. O.C. STUDS CUT 1/2" LESS THAN ASSEMBLY HEIGHT. STUDS FABRICATED FROM MIN. 25 MSG GALV. STEEL, MIN 3 5/8 IN. WIDE BY 1 5/8 IN. DEEP WITH 3/8 IN. FOLDED BACK RETURN FLANGE LEGS.
 - GYPSUM BOARD - 5/8 IN. THICK, 4 FT WIDE ATTACHED TO METAL STUDS WITH TYPE S STEEL SCREWS SPACED 8 IN. O.C. ALONG EDGES OF BOARD AND 12 IN. O.C. IN THE FIELD OF THE BOARD. JNTS. ORIENTED VERTICALLY AND STAGGERED ON OPPOSITE SIDES OF ASSEMBLY 48 IN. O.C.
 - SOUND BATT - GLASS FIBER INSULATION 3 1/2" THICK, COMPRESSED AND FRICTION FIT IN STUD SPACE.
 - SEALANT - SEALANT, FULL PERIMETER BOTH SIDES.
 - BLOCKING - (NOT SHOWN) WOOD BLOCKING AS NEEDED
 - TAPE AND COMPOUND - (NOT SHOWN) VINYL, DRY OR PREMIXED JOINT COMPOUND, APPLIED IN TWO COATS TO JOISTS AND SCREW HEADS, PAPER TAPE, 2 IN. WIDE, EMBEDDED IN FIRST LAYER OF COMPOUND OVER ALL JOISTS.
 - CEILING - AS NOTED
 - SCHEDULED BASE - AS NOTED
 - UNDERSIDE OF STRUCTURE
 - TOP OF STRUCTURE

NOTE: USE MOISTURE RESISTANT GYPSUM IN WET AREAS

7 | WALL TYPE 7 - 4 7/8" NON RATED - ACOUSTIC PARTITION
1 1/2" = 1'-0" 0 3 6 12 24

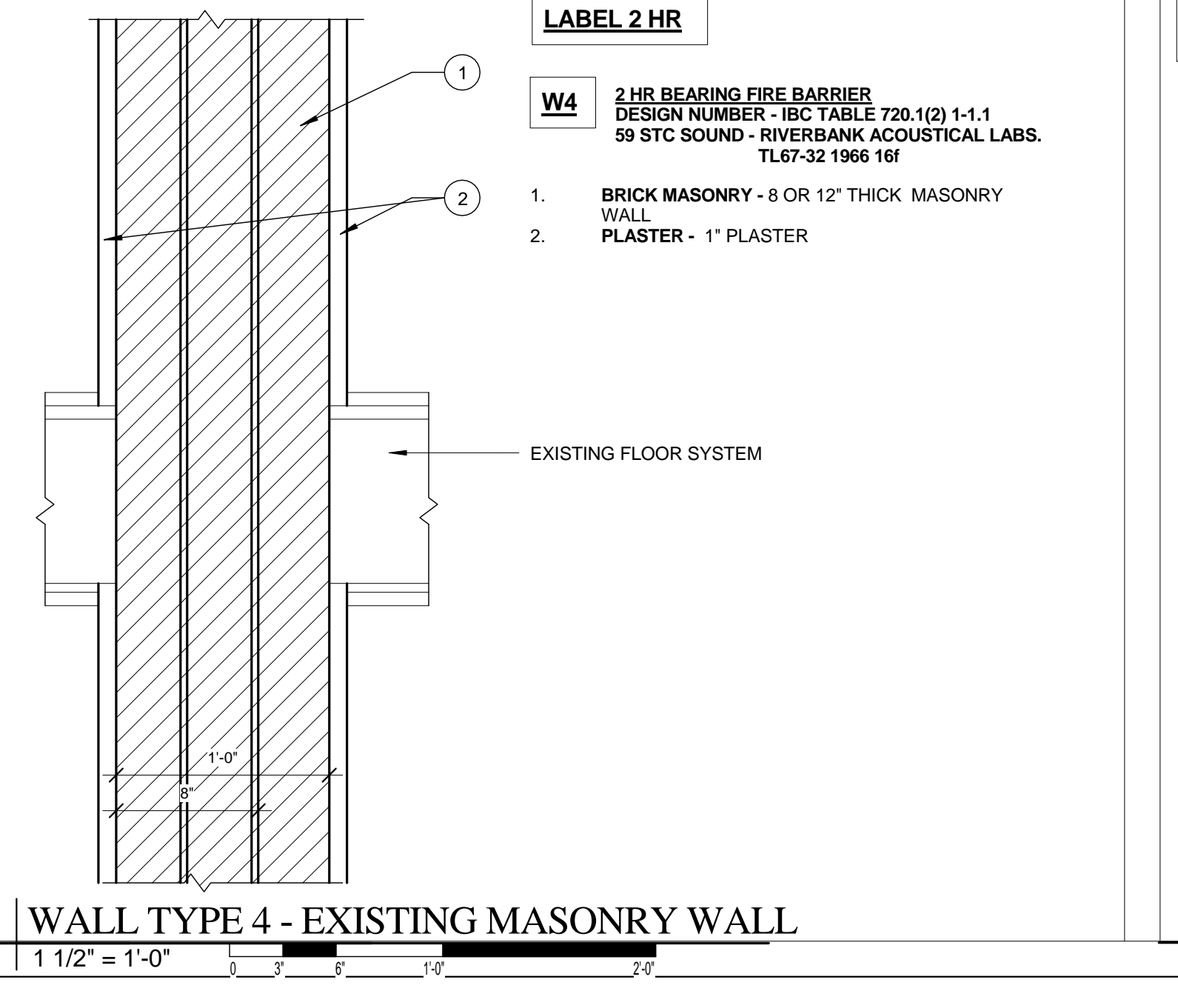

- W4** 2 HR BEARING FIRE BARRIER
DESIGN NUMBER - IBC TABLE 720.1(2) 1-1.1
59 STC SOUND - RIVERBANK ACOUSTICAL LABS.
TL67-32 1966 16f
- BRICK MASONRY - 8 OR 12" THICK MASONRY WALL
 - PLASTER - 1" PLASTER

4 | WALL TYPE 4 - EXISTING MASONRY WALL
1 1/2" = 1'-0" 0 3 6 12 24

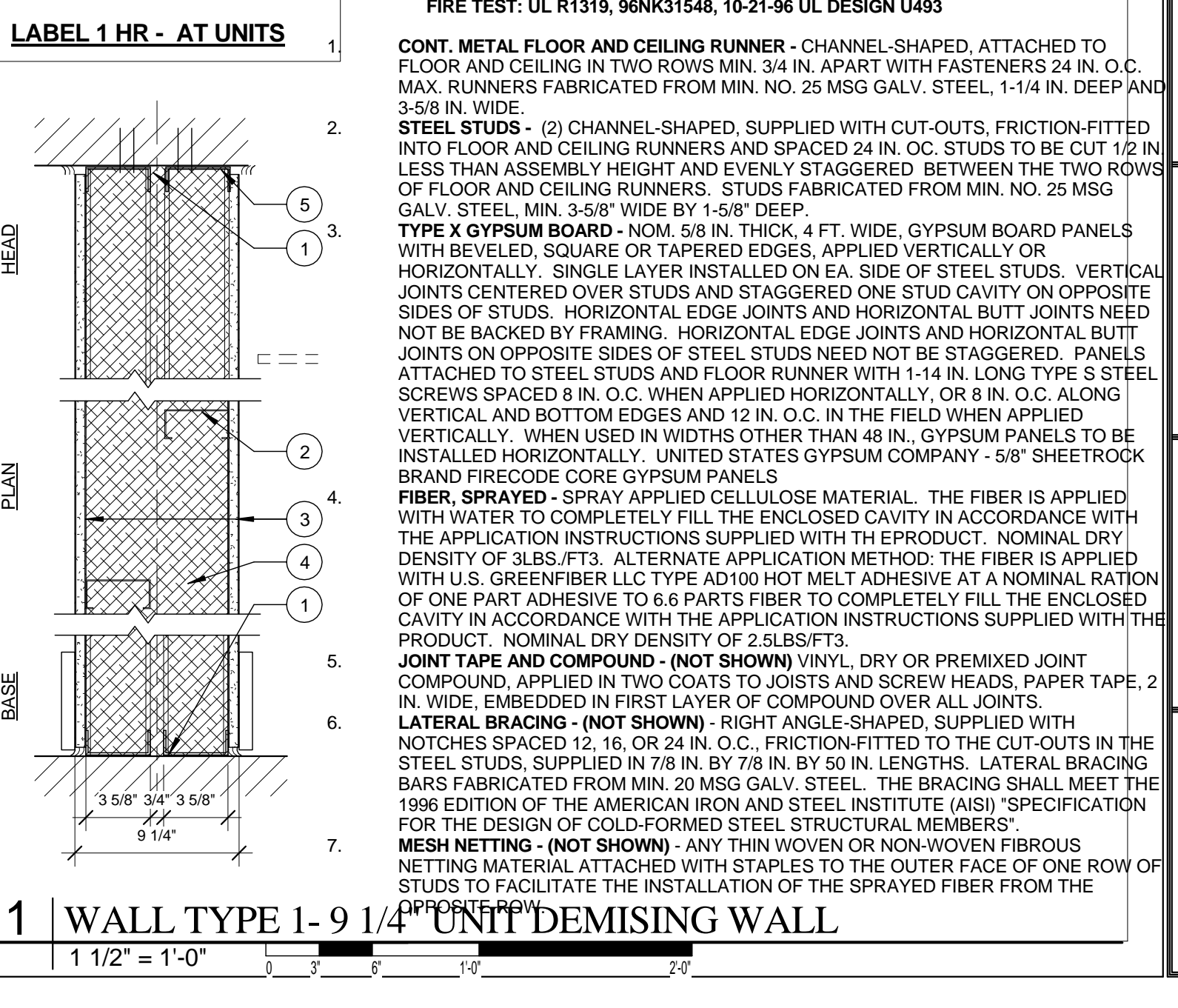

- W1** 1 HR NON-BEARING FIRE BARRIER
DESIGN NUMBER - UL U493 (GA FILE WP5006 PROPRIETARY 1 HOUR FIRE)
60-64 STC SOUND - IBC TABLE 720.1(2) 5-1.3
FIRE TEST: UL R1319, 96NK1548, 10-21-96 UL DESIGN U493
- LABEL 2 HR - AT STAIRS AND SHAFTS ENCLOSURE**
- LABEL 1 HR - AT UNITS**
- CONT. METAL FLOOR AND CEILING RUNNER - CHANNEL SHAPED, ATTACHED TO FLOOR AND CEILING WITH STEEL FASTENERS SPACED 24 IN. O.C. MAX. RUNNERS FABRICATED FROM MIN. NO. 25 MSG GALV. STEEL, 1-1/4 IN. DEEP AND 3-5/8 IN. WIDE.
 - STEEL STUDS - (2) CHANNEL SHAPED, SUPPLIED WITH CUT-OUTS, FRICTION-FITTED INTO FLOOR AND CEILING RUNNERS AND SPACED 24 IN. O.C. STUDS TO BE CUT 1/2 IN. LESS THAN ASSEMBLY HEIGHT AND EVENLY STAGGERED BETWEEN THE TWO ROWS OF FLOOR AND CEILING RUNNERS. STUDS FABRICATED FROM MIN. NO. 25 MSG GALV. STEEL, MIN. 3-5/8" WIDE BY 1-5/8" DEEP.
 - TYPE X GYPSUM BOARD - NOM. 5/8 IN. THICK, 4 FT. WIDE, GYPSUM BOARD PANELS WITH BEVELED, SQUARE OR TAPERED EDGES, APPLIED VERTICALLY OR HORIZONTALLY. SINGLE LAYER INSTALLED ON EA. SIDE OF STEEL STUDS. VERTICAL JOINTS CENTERED OVER STUDS AND STAGGERED ONE STUD CAVITY ON OPPOSITE SIDES OF STUDS. HORIZONTAL EDGE JOINTS AND HORIZONTAL BUTT JOINTS NEED NOT BE BACKED BY FRAMING. HORIZONTAL EDGE JOINTS AND HORIZONTAL BUTT JOINTS ON OPPOSITE SIDES OF STEEL STUDS NEED NOT BE STAGGERED. PANELS ATTACHED TO STEEL STUDS AND FLOOR RUNNER WITH 1-1/4 IN. LONG TYPE S STEEL SCREWS SPACED 8 IN. O.C. WHEN APPLIED HORIZONTALLY, OR 8 IN. O.C. ALONG VERTICAL AND BOTTOM EDGES AND 12 IN. O.C. IN THE FIELD WHEN APPLIED VERTICALLY. WHEN USED IN WIDTHS OTHER THAN 48 IN., GYPSUM PANELS TO BE INSTALLED HORIZONTALLY. UNITED STATES GYPSUM COMPANY - 5/8" SHEETROCK BRAND FIRECODE CORE GYPSUM PANELS
 - FIBER, SPRAYED - SPRAY APPLIED CELLULOSE FIBER. THE FIBER IS APPLIED WITH WATER TO COMPLETELY FILL THE ENCLOSED CAVITY IN ACCORDANCE WITH THE APPLICATION INSTRUCTIONS SUPPLIED WITH THE PRODUCT. NOMINAL DRY DENSITY OF 3LBS./FT3. ALTERNATE APPLICATION METHOD: THE FIBER IS APPLIED WITH U.S. GREENFIBER LLC TYPE AD100 HOT MELT ADHESIVE AT A NOMINAL RATION OF ONE PART ADHESIVE TO 6.6 PARTS FIBER TO COMPLETELY FILL THE ENCLOSED CAVITY IN ACCORDANCE WITH THE APPLICATION INSTRUCTIONS SUPPLIED WITH THE PRODUCT. NOMINAL DRY DENSITY OF 2.5LBS./FT3.
 - JOINT TAPE AND COMPOUND - (NOT SHOWN) VINYL, DRY OR PREMIXED JOINT COMPOUND, APPLIED IN TWO COATS TO JOISTS AND SCREW HEADS, PAPER TAPE, 2 IN. WIDE, EMBEDDED IN FIRST LAYER OF COMPOUND OVER ALL JOISTS.
 - LATERAL BRACING - (NOT SHOWN) - RIGHT ANGLE SHAPED, SUPPLIED WITH NOTCHES SPACED 12, 16, OR 24 IN. O.C. FRICTION-FITTED TO THE CUT-OUTS IN THE STEEL STUDS, SUPPLIED IN 7/8 IN. BY 7/8 IN. BY 50 IN. LENGTHS. LATERAL BRACING BARS FABRICATED FROM MIN. 20 MSG GALV. STEEL. THE BRACING SHALL MEET THE 1996 EDITION OF THE AMERICAN IRON AND STEEL INSTITUTE (AISI) "SPECIFICATION FOR THE DESIGN OF COLD-FORMED STEEL STRUCTURAL MEMBERS".
 - MESH NETTING - (NOT SHOWN) - ANY THIN WOVEN OR NON-WOVEN FIBROUS NETTING MATERIAL, ATTACHED WITH STAPLES TO THE OUTER FACE OF ONE ROW OF STUDS TO FACILITATE THE INSTALLATION OF THE SPRAYED FIBER FROM THE OPPOSITE ROW.

1 | WALL TYPE 1 - 9 1/4" UNIT DEMISING WALL
1 1/2" = 1'-0" 0 3 6 12 24

Prepared For: **Developers Collaborative**
17 Chestnut Street
Portland, ME 04101

Consultant: **ARCHETYPE architects**
48 Union Wharf Portland, Maine 04101
(207) 772-0022 ARCHETYPE@ARCHETYPEA.COM

Project: **NATHAN CLIFFORD SCHOOL REDEVELOPMENT**
180 Falmouth Street Portland, Maine

Revisions: Scale: 1 1/2" = 1'-0" WALL TYPES

Date: 15 JAN 2014

A4.01

DAVID LLOYD NO. 936
LICENSED ARCHITECT
STATE OF MAINE