

DEANE STREET

FALMOUTH STREET

PAYSON STREET

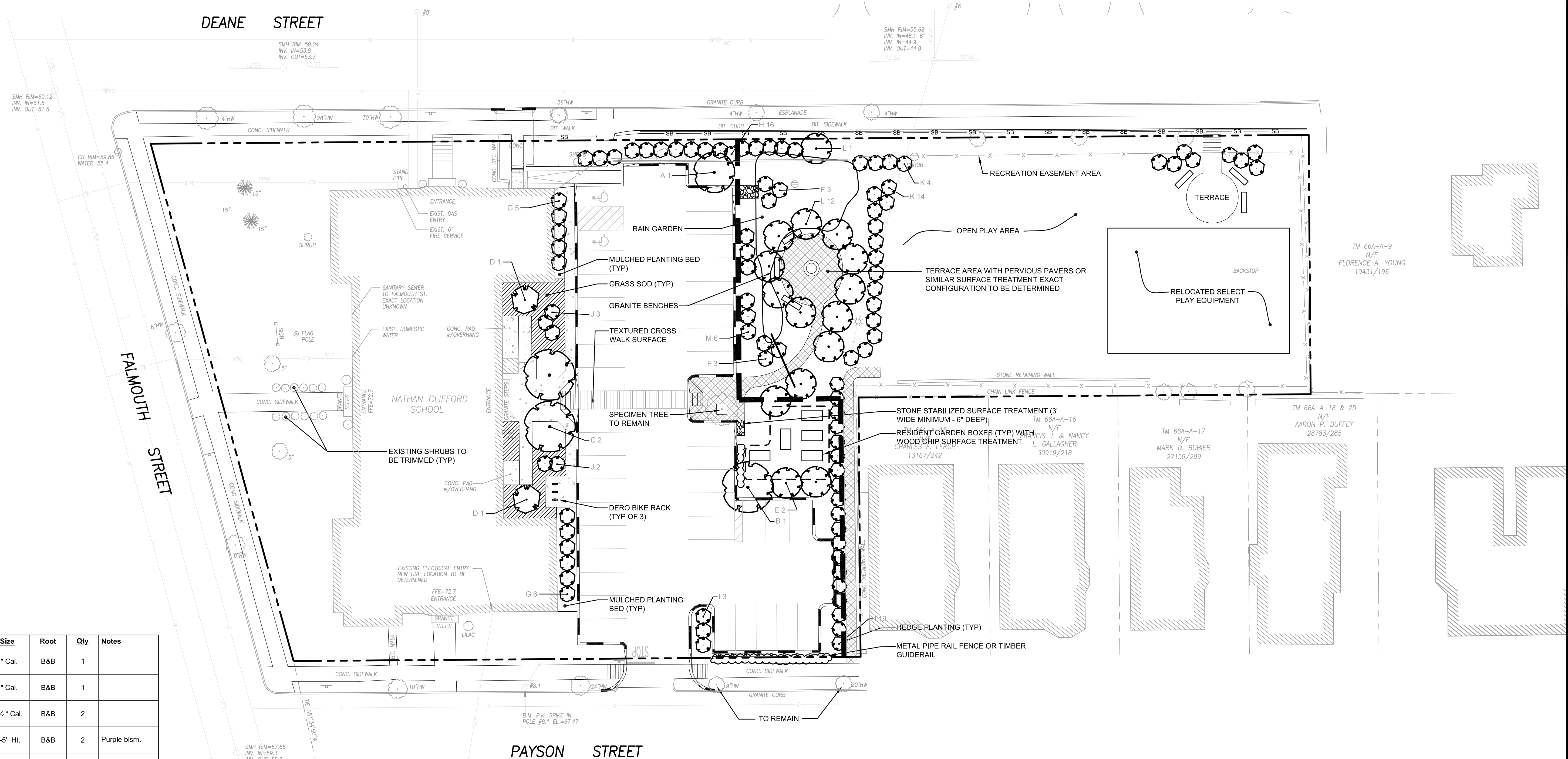

Key	Common & Botanical Name	Size	Root	Qty	Notes
A.	Sugar Maple A. Saccharum	3" Cal.	B&B	1	
B.	Hornbeam Carpinus Caroliniana	2" Cal.	B&B	1	
C.	Cockspur Thornless Hawthorne C. Crusgalli 'inermis'	2 1/2" Cal.	B&B	2	
D.	Common Lilac S. Vulgaris	4'-5' Ht.	B&B	2	Purple blsm.
E.	Cornelian Cherry Cornus Mas	5'-6' Ht.	B&B	2	
F.	Shasta Viburnum V. Plicatum Var. Tomentosum 'Shasta'	4'-5' Ht.	B&B	6	
G.	Northern Bayberry M. Pensilvanica	30" Ht.	#2	11	3 Canes
H.	Highbush Blueberry V. Corymbosum	3'-4' Ht.	Cont.	16	3 Canes
I.	Shoshoni Viburnum V. Plicatum 'Shoshoni'	#5	Cont.	22	
J.	Annabelle Hydrangea H. Aborescens 'Annabelle'	#3	Cont.	5	2-3 Trunk
K.	Miss Kim Lilac S. Patula 'Miss Kim'	4'-5' Ht.	B&B	18	
L.	Flowering Crab Malus 'Donald Wyman'	2 1/2" Cal.	B&B	13	
M.	Compact Red Twig Dogwood C. Sericea 'Isanti'	#2	Cont.	6	
PB.	Planting Beds for Assorted Perennials @ 15" deep - prepared planing soil				
aa	Daylily Var. Hemerocallis 'mixture'				

CURRENT LANDSCAPED AREA : 43%

PROPOSED LANDSCAPED AREA: 46%

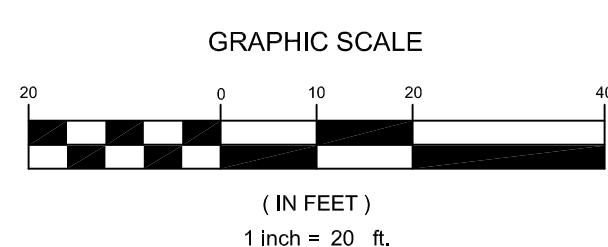

**FST**  
ENGINEERS  
**FAY, SPOFFORD & THORNDIKE, INC.**  
ENGINEERS · PLANNERS · SCIENTISTS  
5 BURLINGTON WOODS, BURLINGTON, MA 01803

Prepared For: <b>DEVELOPERS COLLABORATIVE PREDEVELOPMENT L.L.C.</b> 17 CHESTNUT STREET PORTLAND, ME 04101	Project: <b>NATHAN CLIFFORD SCHOOL REDEVELOPMENT</b> FALMOUTH STREET PORTLAND, MAINE	Revisions: 12.20.13 - RELEASED FOR BIDS 11.19.13 - FINAL PLAN SUBMISSION 11.12.13 - FINAL PLAN SUBMISSION 11.05.13 - FINAL PLAN SUBMISSION 10.16.13 - REV. PLAN SUBMISSION 10.01.13 - PRELIMINARY PLAN SUBMISSION TO CITY	
		Architect: <b>ARCHETYPE Architects</b> 48 Union Wharf Portland, Maine 04101 (207) 772-6022 Fax (207) 772-4056	Date: OCT. 2012
<b>LANDSCAPE PLAN</b>			