

City of Portland, Maine - Building or Use Permit Application
 389 Congress Street, 04101 Tel: (207) 874-8703, Fax: (207) 874-8716

Permit No: 04-0166	Issue Date: APR 01 2004	CEL: 066 F001001
-----------------------	----------------------------	---------------------

Location of Construction: 315 Park Ave	Owner Name: 315 Park Avenue Properties Llc	Owner Address: 30 Milk St 2nd Floor	Phone: CITY OF PORTLAND
Business Name: n/a	Contractor Name: Dan Libby	Contractor Address: 271 Milt Brown Rd. Standish	Phone: 2076424768
Lessee/Buyer's Name n/a	Phone: n/a	Permit Type:	Zone: B2

Past Use: Commercial	Proposed Use: Commercial / Install natural gas direct vent in attic.	Permit Fee: \$183.00	Cost of Work: \$0.00	CEO District: 3
Proposed Project Description: Install natural gas direct vent in attic		FIRE DEPT: <input checked="" type="checkbox"/> Approved <input type="checkbox"/> Denied	INSPECTION: Use Group: B Type: S	
		Signature: <i>[Signature]</i>	Signature: <i>[Signature]</i> 5/30/04	
PEDESTRIAN ACTIVITIES DISTRICT (P.A.D.)				
Action: <input type="checkbox"/> Approved <input type="checkbox"/> Approved w/Conditions <input type="checkbox"/> Denied				
Signature: _____ Date: _____				

Permit Taken By: gg	Date Applied For: 02/24/2004	Zoning Approval		
1. This permit application does not preclude the Applicant(s) from meeting applicable State and Federal Rules. 2. Building permits do not include plumbing, septic or electrical work. 3. Building permits are void if work is not started within six (6) months of the date of issuance. False information may invalidate a building permit and stop all work..		Special Zone or Reviews <input type="checkbox"/> Shoreland <input type="checkbox"/> Wetland <input type="checkbox"/> Flood Zone <input type="checkbox"/> Subdivision <input type="checkbox"/> Site Plan Maj <input type="checkbox"/> Minor <input type="checkbox"/> MM <input type="checkbox"/> Date: <i>3/5/04</i>	Zoning Appeal <input type="checkbox"/> Variance <input type="checkbox"/> Miscellaneous <input type="checkbox"/> Conditional Use <input type="checkbox"/> Interpretation <input type="checkbox"/> Approved <input type="checkbox"/> Denied Date: _____	Historic Preservation <input checked="" type="checkbox"/> Not in District or Landmark <input type="checkbox"/> Does Not Require Review <input type="checkbox"/> Requires Review <input type="checkbox"/> Approved <input type="checkbox"/> Approved w/Conditions <input type="checkbox"/> Denied Date: <i>[Signature]</i>

CERTIFICATION

I hereby certify that I am the owner of record of the named property, or that the proposed work is authorized by the owner of record and that I have been authorized by the owner to make this application as his authorized agent and I agree to conform to all applicable laws of this jurisdiction. In addition, if a permit for work described in the application is issued, I certify that the code official's authorized representative shall have the authority to enter all areas covered by such permit at any reasonable hour to enforce the provision of the code(s) applicable to such permit.

SIGNATURE OF APPLICANT ADDRESS DATE PHONE

RESPONSIBLE PERSON IN CHARGE OF WORK, TITLE DATE PHONE



FILL IN AND SIGN WITH INK

APPLICATION FOR PERMIT HEATING OR POWER EQUIPMENT

PERMIT ISSUED
APR 01 2004
CITY OF PORTLAND

066 F 001

To the INSPECTOR OF BUILDINGS, PORTLAND, ME.

The undersigned hereby applies for a permit to install the following heating, cooking or power equipment in accordance with the Laws of Maine, the Building Code of the City of Portland, and the following specifications:

Location / CBL 315 Park Ave Use of Building Office Date 2-23-04
Name and address of owner of appliance _____

Installer's name and address Dan Libby - Refrigeration - Heating - A.C.
571 Mill Brown Rd Standish, Me. 04084 Telephone 207-642-4768

Location of appliance:

- Basement
- Attic
- Floor
- Roof

Type of Fuel:

- Gas
- Oil
- Solid

Appliance Name: BAKI-LUNG

U.L. Approved Yes No

Will appliance be installed in accordance with the manufacture's installation instructions? Yes No

IF NO Explain: _____

The Type of License of Installer:

- Master Plumber # _____
- Solid Fuel # _____
- Oil # MS20005654
- Gas # PNT56
- Other _____

Type of Chimney:

- Masonry Lined
Factory built _____
- Metal
Factory Built U.L. Listing # _____
- Direct Vent
Type _____ UL# _____

Type of Fuel Tank

- Oil
- Gas natural

Size of Tank _____

Number of Tanks _____

Distance from Tank to Center of Flame _____ feet.

Cost of Work: \$ 18,000.00

Permit Fee: \$ _____ 183.00

Approved

Approved with Conditions

Fire: Urry
Ele.: _____
Bldg.: [Signature]

See attached letter DEPARTMENT OF BUILDING INSPECTION
CITY OF PORTLAND, ME
Inspector's Signature _____ Date 2/23/04 Approved _____

Signature of Installer [Signature]

RECEIVED
FEB 24 2004

City of Portland, Maine - Building or Use Permit

389 Congress Street, 04101 Tel: (207) 874-8703, Fax: (207) 874-8716

Permit No: 04-0166	Date Applied For: 02/24/2004	CBL: 066 F001001
------------------------------	--	----------------------------

Location of Construction: 315 Park Ave	Owner Name: 315 Park Avenue Properties Llc	Owner Address: 30 Milk St 2nd Floor	Phone:
Business Name: n/a	Contractor Name: Dan Libby	Contractor Address: 271 Milt Brown Rd. Standish	Phone (207) 642-4768
Lessee/Buyer's Name n/a	Phone: n/a	Permit Type: HVAC	

Proposed Use: Commercial / Install natural gas direct vent in attic.	Proposed Project Description: Install natural gas direct vent in attic
--	--

Dept: Zoning	Status: Approved	Reviewer: Marge Schmuckal	Approval Date: 03/05/2004
Note:			Ok to Issue: <input checked="" type="checkbox"/>

Dept: Building	Status: Approved with Conditions	Reviewer: Mike Nugent	Approval Date: 03/30/2004
Note:			Ok to Issue: <input checked="" type="checkbox"/>
1) Fire dampers must be installed in HVAC vents that penetrate Fire Separation Assemblies, Advised Contractor Must comply with State Gas Regs.			

Dept: Fire	Status: Approved with Conditions	Reviewer: Lt. MacDougal	Approval Date: 03/08/2004
Note:			Ok to Issue: <input checked="" type="checkbox"/>
1) the furnace shall be installed in an one hour rated enclosure or a smoke protected enclosure with a sprinkler system			

Comments:			
3/29/2004-gg: recieved structurals as requested. /gg			
3/9/2004-mjn: Need: Structurals, how is it being attached Fire Damper schedule (plan shows a duct penetration in the egress stairway..)			

04 0166
315 Paul Ave
066 Fou

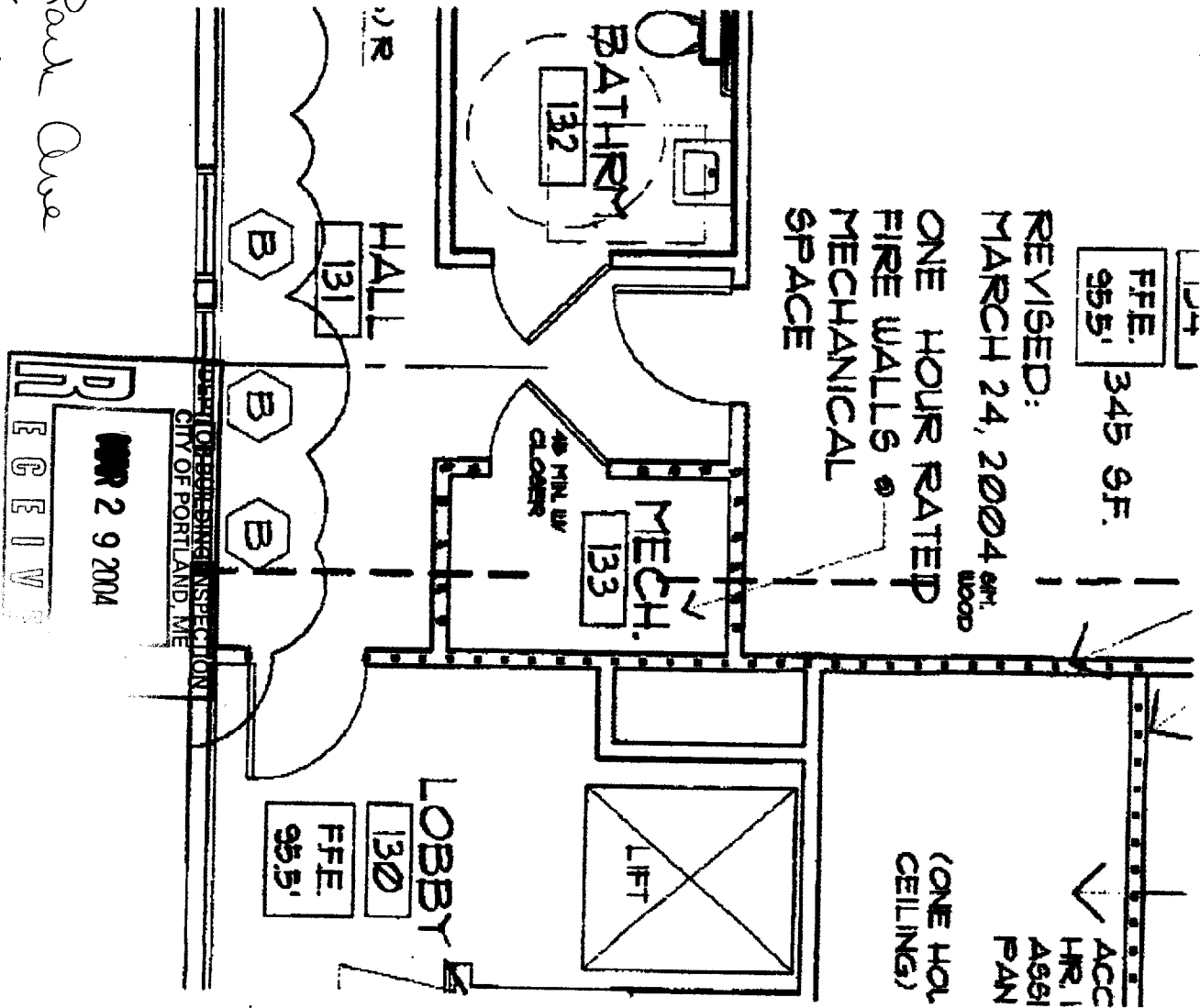

315
PAUL AVE.
FIRE
RATED WALL
1/2" - 1/8"

Mar 24 04 02:50p

315 Park Ave

REVISED:
MARCH 24, 2004

ONE HOUR RATED
FIRE WALL
② SECOND FLOOR
MECHANICAL
SPACE
(EXTEND WALL TO
UNDERSIDE OF CONC.
PLANK ROOF ABOVE
AND EXTEND GUB UP
W/IN EACH "1" "
SECTION,
SEE ONE HOUR WALL
TYPE DETAIL)

FIRE CAULK AND
SEAL
ALL PIPE
PENETRATIONS W/ "UL"
ASSEMBLY SLEEVE
(TYP)

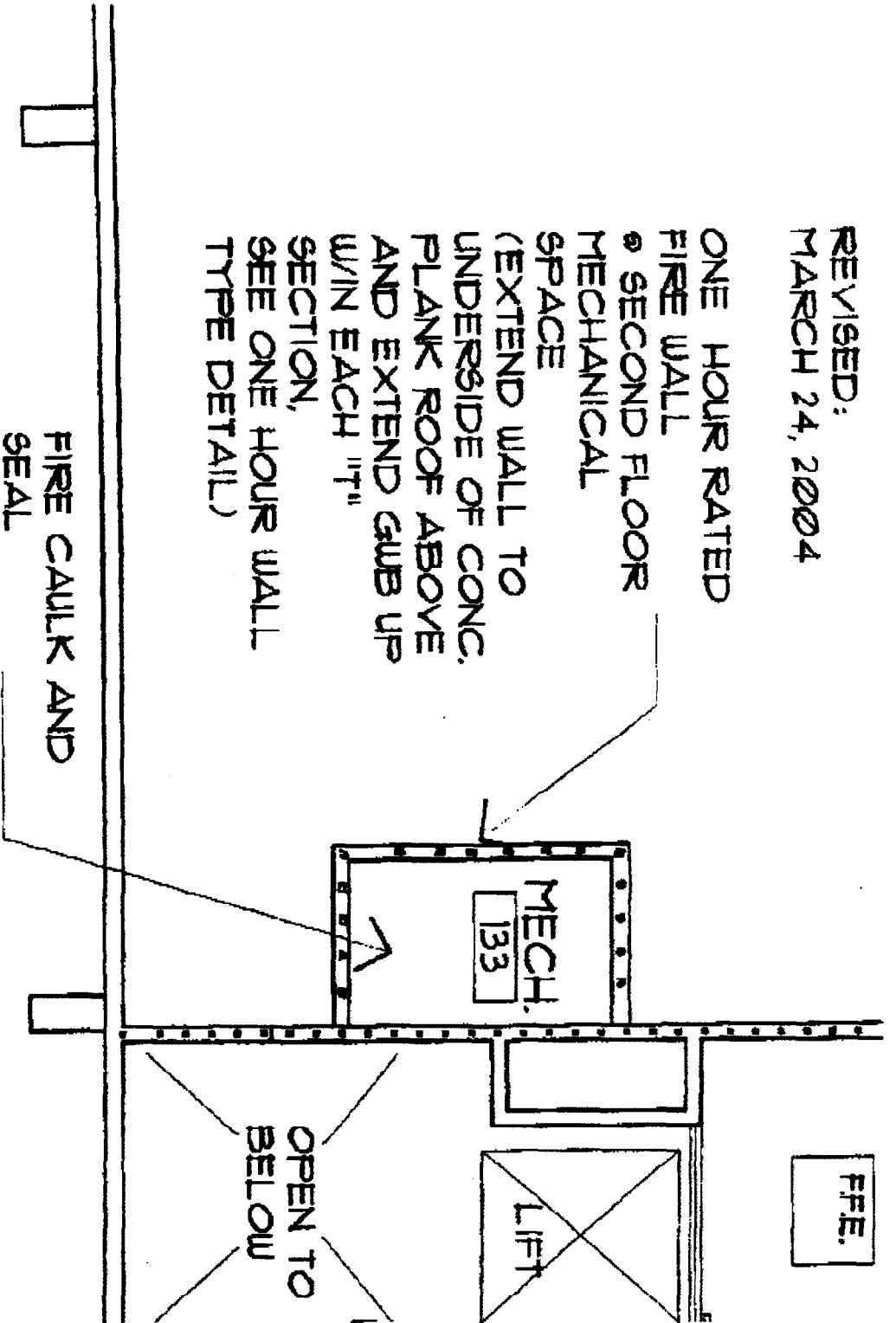

315 Park Ave.

Specs from para
14" x 1" x 1"

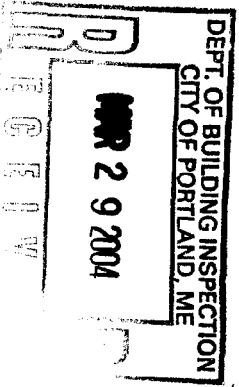

I am installing a wall mounted
natural gas boiler with an air handler
and duct work for the remodel at
315 park Ave.

I will get outside air from the
roof pulled in to the air handler's return
The condensing unit will be on the
roof.

The roof is flat and rubber over
pre-stress concrete

Don Libby