

INTERIOR OFFICE FIT-UP 106 GILMAN STREET PORTLAND, MAINE

INDEX OF DRAWINGS

- Title Sheet, Key Plans, Code Analysis
- 51 Structural Plans & Details
- A1 Floor Plans
- A2 Reflected Ceiling Plans
- A3 Schedules
- A4 Building Section, Exterior Elevations
- A5 Details

OWNER
Shalom House, Inc.
PO Box 560
Portland, Maine 04112

ARCHITECT
ArcheType, P.A.
48 Union Wharf
Portland, Maine 04101

TENANT
Maine Medical Center
Portland, Maine 04101

CONTRACTOR
Thaxter Company
Bell Street
Portland, Maine 04101

PROJECT DESCRIPTION
THE PROJECT CONSISTS OF THE FOLLOWING:
1. FIRST FLOOR: A 1245 SQUARE FOOT BUSINESS OFFICE FIT-UP OF AN EXISTING BUSINESS OCCUPANCY.
2. SECOND FLOOR: A 5,995 SQUARE FOOT BUSINESS OFFICE FIT-UP OF AN EXISTING STORAGE OCCUPANCY.
THE BUILDING IS FULLY SPRINKLED. NO SITE WORK OR BUILDING ADDITION IS PROPOSED.

CODE ANALYSIS - NFPA 2003

OCCUPANCY
CHAPTERS 36/39 - BUSINESS OCCUPANCIES

OCCUPANT LOAD
TABLE 13.12 - (1) OCCUPANT PER EACH 100².

ARRANGEMENT OF MEANS OF EGRESS
SECTION 302.5.2.1 - DEAD END CORRIDORS, SHALL NOT EXCEED 50' IN A SPRINKLED BUILDING.

SECTION 302.5.3.2 - COMMON PATH OF TRAVEL. 100' IN A SPRINKLED BUILDING.

SECTION 302.6.1 - TRAVEL DISTANCE TO EXITS. 300' IN A SPRINKLED BUILDING.

SECTION 302.8 - ILLUMINATION OF MEANS OF EGRESS. REQUIRED IN ACCORDANCE WITH SECTION 7.8.

SECTION 302.9 - EMERGENCY LIGHTING. REQUIRED IN ACCORDANCE WITH SECTION 7.9.

DETECTION ALARM & COMMUNICATIONS SYSTEMS
SECTION 303.4.1 - FIRE ALARM SYSTEM REQUIRED.

SECTION 303.4.2 INITIATION - BY SPRINKLER SYSTEM.

SECTION 303.4.3 NOTIFICATION - IN ACCORDANCE WITH SECTION 9.6.3.

EXTINGUISHMENT REQUIREMENTS
BUILDING IS FULLY SPRINKLED.

SECTION 303.5 - PORTABLE FIRE EXTINGUISHERS REQUIRED IN ACCORDANCE WITH 9.1.4.1.

CODE ANALYSIS - IBC 2003

USE GROUP
IBC 304.0 - BUSINESS USE GROUP B.

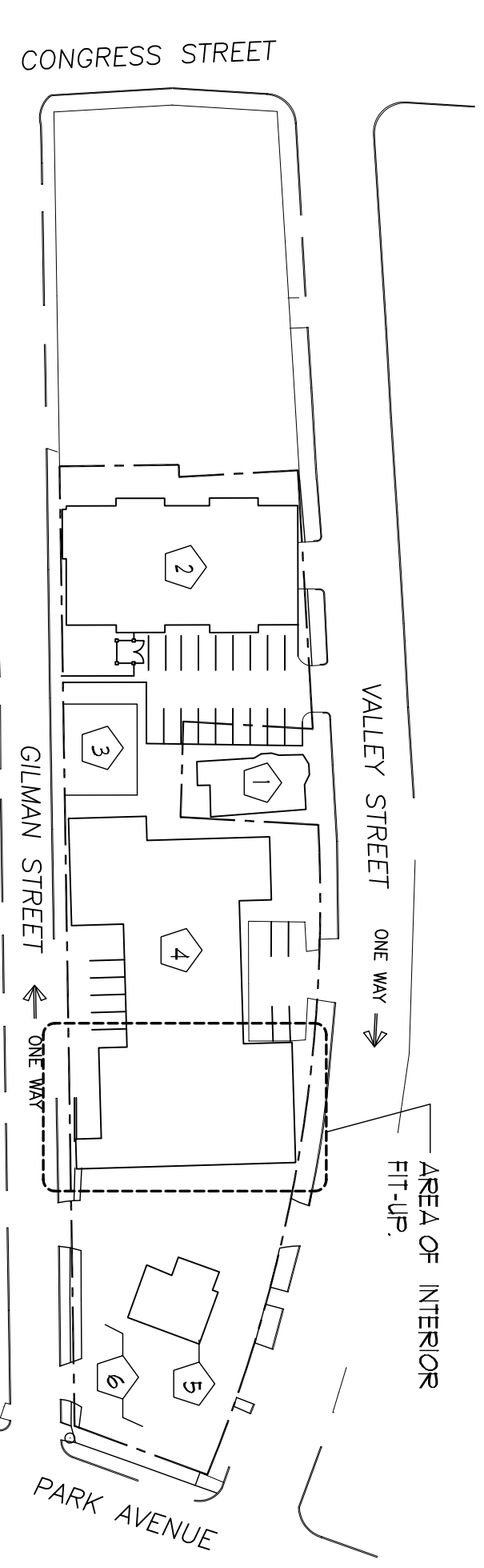

LOCATION PLAN

NO SCALE

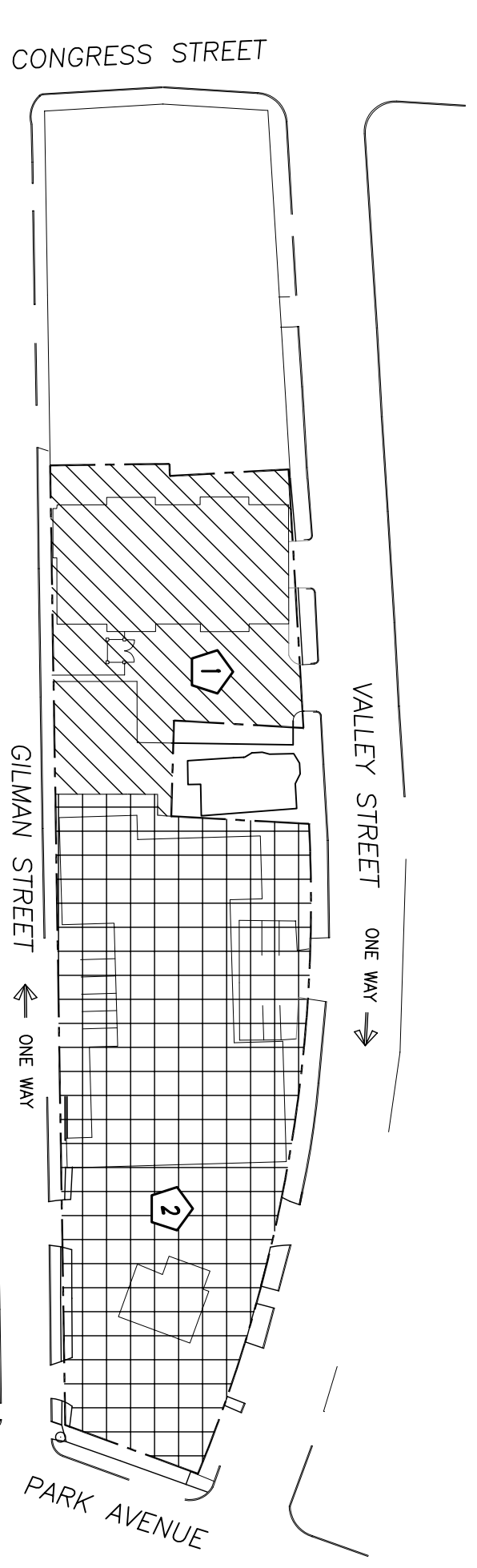

ZONING PLAN

NO SCALE

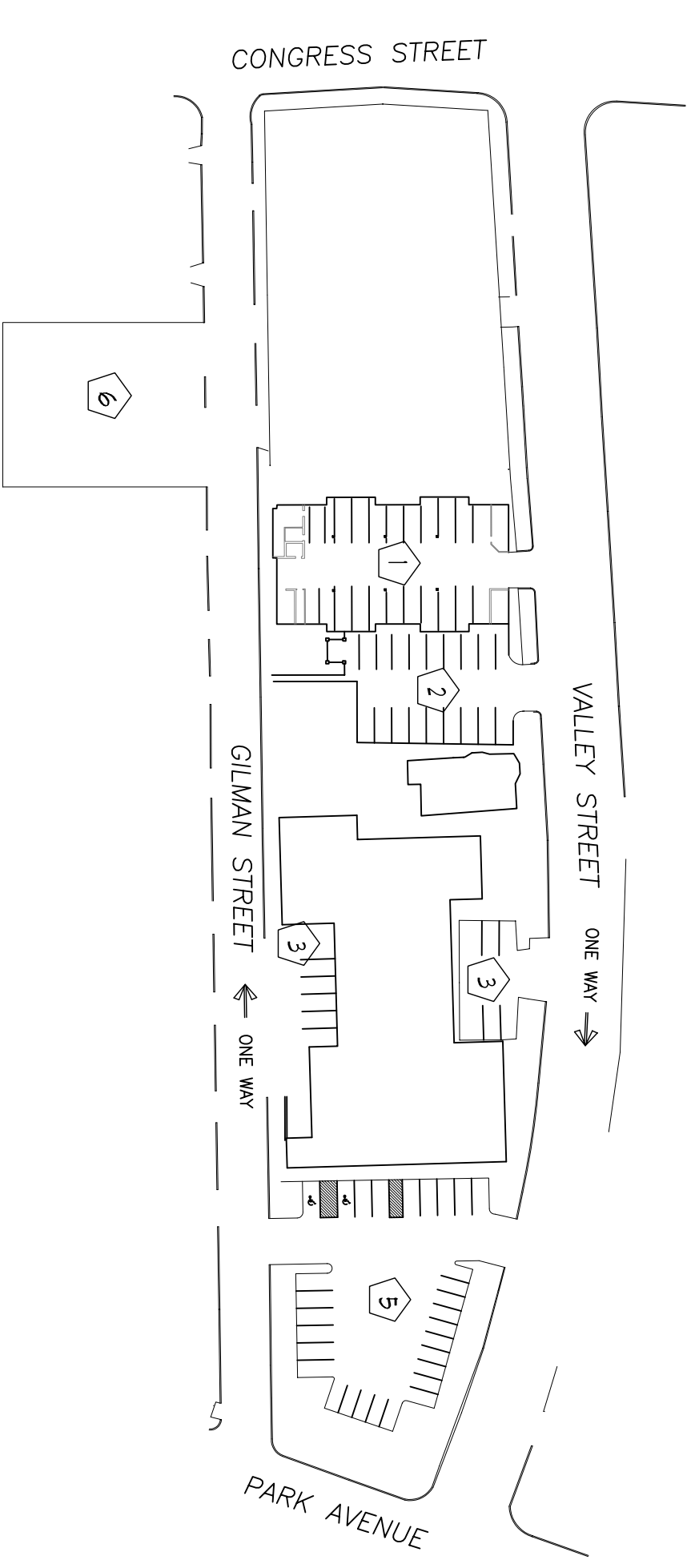

PARKING PLAN

NO SCALE