

PLOT DATE & TIME: 8/16/2007 1:29 PM
 FILE PATH & NAME: F:\DATA\PROJECTS\MCDONALDS\M-1000S\M-1032 PORTLAND, ME\ARCHITECTURAL-DRAWINGS\M-1032_LS-1_LIFE SAFETY PLAN

LIFE SAFETY FIRE DEPARTMENT REQUIREMENTS:

PROPOSED USE: USE GROUP A2 - ASSEMBLY
 PROPOSED SQUARE FOOTAGE: 5,448 GROSS S.F.
 PROPOSED FIRE PROTECTION SYSTEM: SEE FIRE PROTECTION DRAWING FPIQ, FIRE PROTECTION SPECIFICATIONS AND FIRE ALARM NARRATIVE.
 MAX TRAVEL DIST TO EXIT DISCHARGE: 130' FEET (SEE PLAN ROUTE - - - - -) NOTE: NO POINT EXCEEDS THE 250' MAX.
 MEANS OF EGRESS: NUMBER OF EXITS REQUIRED: 2
 NUMBER OF EXITS PROVIDED: 4

PLAN KEY

FIRE EXTINGUISHERS LOCATIONS: ●FE PROVIDE ADDITIONAL FIRE EXTINGUISHERS AS REQUIRED AND LOCATE PER FIRE DEPARTMENT DIRECTION.
 ANSUL SYSTEM LOCATIONS: ⊕
 EMERGENCY LIGHT LOCATIONS: (◁ EXTERIOR) (◇ INTERIOR)
 EXIT SIGN LOCATIONS: (◁ SHADED ARROW INDICATES DIRECTION OF TRAVEL)

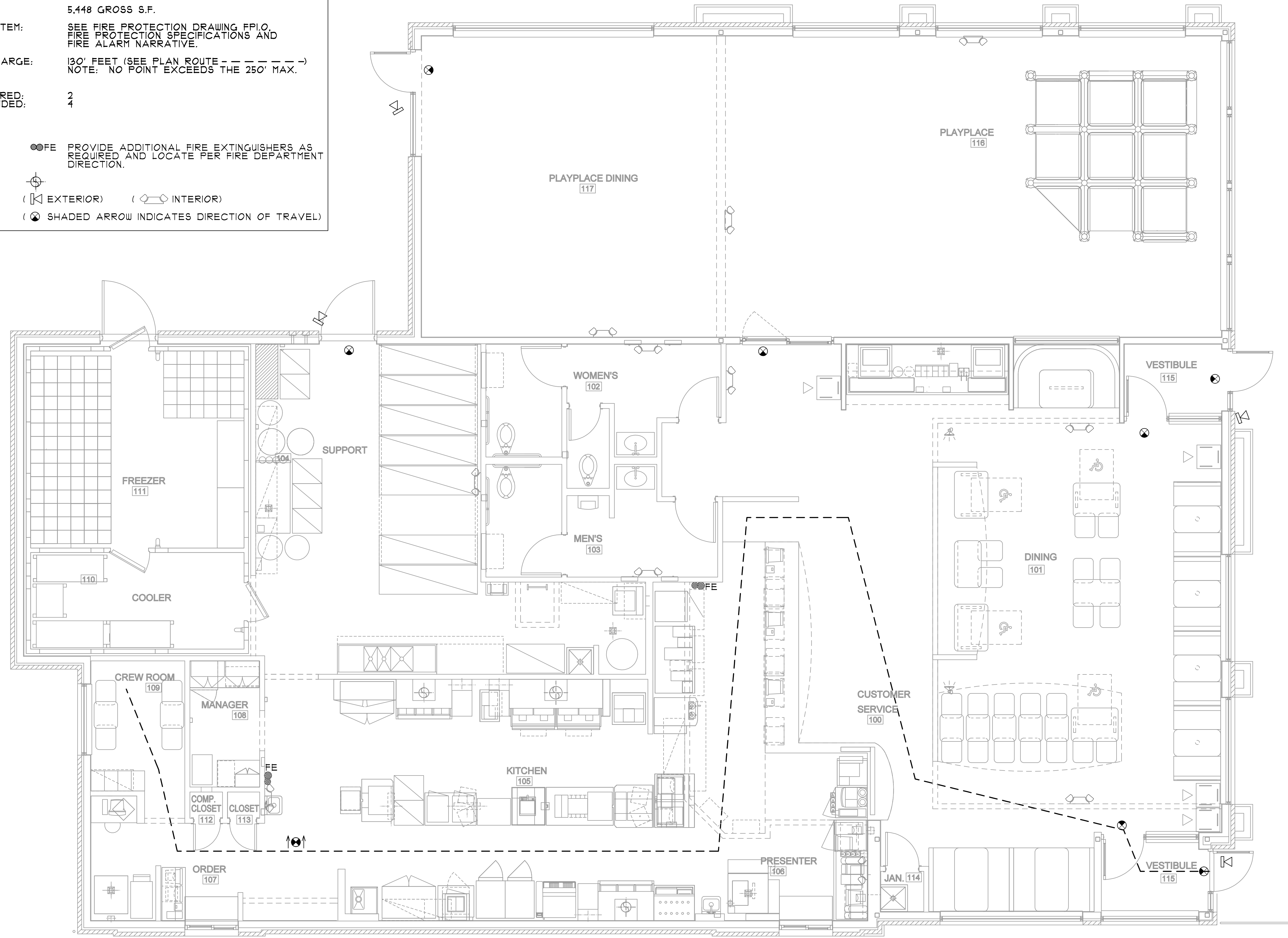

NO.	DATE	BY
1		
2		
3		
4		
5		
6		
7		



DATE ISSUED: 08/14/07
 DATE DRAWN: 04/17/07
 S.A. T.B.D. SCALE: AS NOTED
 JOB NUMBER: M-1032

CONSULTANT:

SHEET TITLE:
LIFE SAFETY PLAN

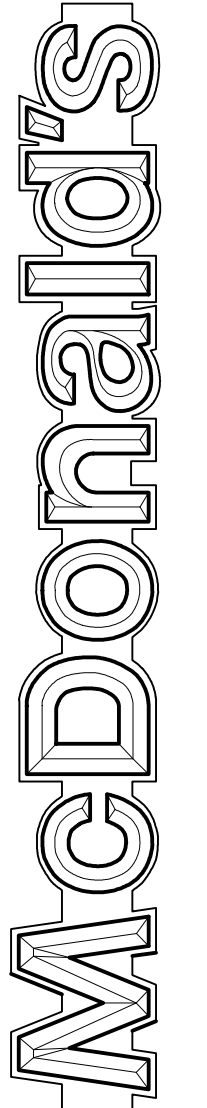

RESTAURANT LOCATION:
 332 St John Street
PORTLAND, ME

PREPARED FOR:
McDonald's USA, LLC
 McDONALD'S PLAZA
 OAK BROOK, ILLINOIS
 60521

SHEET NUMBER:
LS-1