



Reviewed for Code Compliance
Permitting and Inspections Department
Approved with Conditions

05/16/2018

Letter of Authorization

This letter authorizes a representative of New England Signs – 315 Derry Road – Hudson, NH 03051 to secure permits to perform sign installations, removals or any sign maintenance necessary at our property located at:

340 Park Avenue – Portland, ME 04102

Property Owner : LQ Portfolio East, LLC

Address: 909 Hidden Ridge, Ste 600, Irving, Tx 75038

Phone: 214 492 6758

Fax: 214 596 6119

[Signature]
Owner's Signature

Sworn to and subscribed before me this 22 day of Aug, 2017 by Ted Czyzewski who is personally known to me or provided as identification.

[Signature]
Signature of Notary Public

Ellison Riley
Printed Notary Name

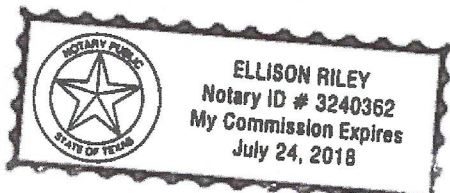



FEE \$30 + \$2/SF



Permitting and Inspections Department
Michael A. Russell, MS, Director

Signage /Awning Permit Application

Reviewed for Code Compliance
Permitting and Inspections Department
Approved with Conditions

05/16/2018

340 PARK AVENUE

Building Information:

Exterior Length of façade of tenant space (ft): _____ Height of exterior façade (ft): _____
 Lot frontage on street (ft): _____ This is a (select one): Single Tenant Lot Multi-Tenant Lot
 If multi-tenant, this is a (select one): Ground floor unit Upper story unit
 Current specific use: HOTEL If vacant, prior use: _____
 Proposed use: HOTEL

Information on EXISTING signs that will remain:

Type (i.e. awning, freestanding sign, attached building sign)	For awnings only:		Dimensions of awning or sign (include length, width, and height, as applicable)	Height of awning or sign above the ground to its highest point	For freestanding signs - setback of closest point of sign to the nearest property line(s)
	Is there any symbol/lettering on awning? (Y/N - if Y, list the dimensions of the messaging)	Is awning backlit? (Y/N)			
<u>WALL #3/4</u>			<u>281.75 SF</u>	<u>ETR</u>	<u>N/A</u>

Information on PROPOSED signs:

Type (i.e. awning, freestanding sign, attached building sign)	For awnings only:		Dimensions of awning or sign (include length, width, and height, as applicable)	Height of awning or sign above the ground to its highest point	For freestanding signs - setback of closest point of sign to the nearest property line(s)
	Is there any symbol/lettering on awning? (Y/N - if Y, list the dimensions of the messaging)	Is awning backlit? (Y/N)			
<u>#1 PYLON</u>			<u>4'-2" x 7'-2"</u>	<u>15'</u>	<u>ETR</u>
<u>#2 DIRECTIONAL</u>			<u>1'-6" x 3'-6"</u>	<u>ETR</u>	<u>ETR</u>

I hereby certify the following:

- I am the Owner of record of the named property, or the owner of record authorizes the proposed work and I have been authorized by the owner to make this application as his/her authorized agent.
- I assume responsibility for compliance with all applicable statutes, codes, ordinances, rules and regulations.
- I understand that this application will not be reviewed for code compliance, and I certify that the proposed sign will be installed in accordance with the IBC 2009.
- I understand that if a Code Official determines that the sign has been installed in violation of any statute, code, or ordinance, that I am responsible for remedying the violation.
- If a permit for work described in this application is issued, I certify that the Code Official's authorized representative shall have the authority to enter all areas covered by this permit at any reasonable hour to enforce the provisions of the codes applicable to this permit.

Signature of Applicant: Carolyn A. Parker Date: 4/20/18
 This is a legal document and your electronic signature is considered a legal signature per Maine state law.



Permitting and Inspections Department
Michael A. Russell, MS, Director



Signage /Awning Permit Application and Checklist

Reviewed for Code Compliance
Permitting and Inspections Department
Approved with Conditions

(For the purposes of this application, an awning shall be considered to be a lightweight metal frame structure over which a fabric covering is attached.) **05/16/2018**

Applications shall be submitted online via the Citizen Self Service portal. Refer to the attached documents for complete instructions. The following items shall be submitted (please check and submit all items):

- Signage/Awning Permit Application form
- Certificate of Liability listing the City as an additional insured if any portion of the sign abuts or encroaches on any public right of way, or can fall into any public right of way.
- A copy of the signed lease or letter of permission from the property owner indicating the specific permissions granted and the tenant/space building frontage.
- A plan showing the specific locations of all existing and proposed signs:
 - For freestanding signs: the plan shall depict lot lines, buildings, driveways, abutting streets or rights of way, lengths of street frontages, and setbacks from freestanding signs to the nearest lot line.
 - For all other signs and awnings: the plan shall depict buildings, driveways, abutting streets or rights of way, and building façade dimensions. Photos or other documentation similar to a drawn plan are acceptable, provided that all required information is included.
- A drawing or photo of the proposed sign showing content, all dimensions, materials, source of illumination, details of anchoring and installation (e.g., attachment specifications, footing details for freestanding signs, etc.).
- Certificate of flammability is required for awnings or banners. *N/A*
- A UL Classification Mark, found on the product, is required for illuminated signs at the time of final inspection.
- Photos of existing signage.

The Permitting and Inspections Department may request additional information prior to the issuance of a permit.



Reviewed for Code Compliance
Permitting and Inspections Department
Approved with Conditions

05/16/2018

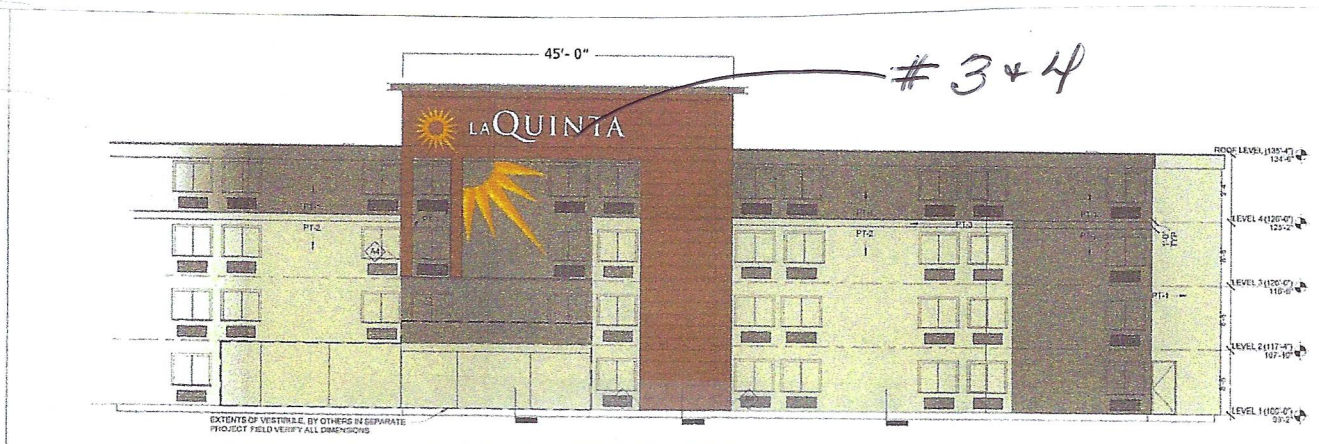
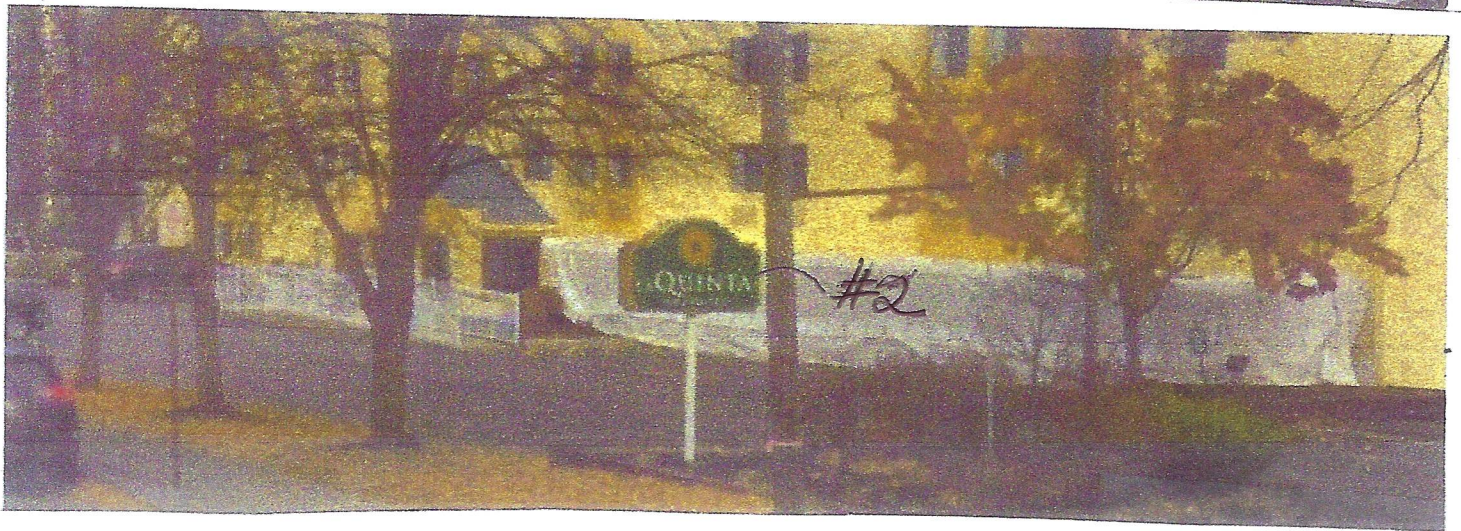

SIGN #1 - 8'-11 5/8" x 5'-7" = 50.7 SF (REPLACE)
SIGN #2 - 5'-7" x 3'-6" = 19.4 SF (REPLACE)
SIGN #3 + #4 = 135 SF (TO REMAIN)
148.75 SF (TO REMAIN)



340 park

066 DD010

Show search results for 340 park

Reviewed for Code Compliance
Permitting and Inspections Department
Approved with Conditions

05/16/2018

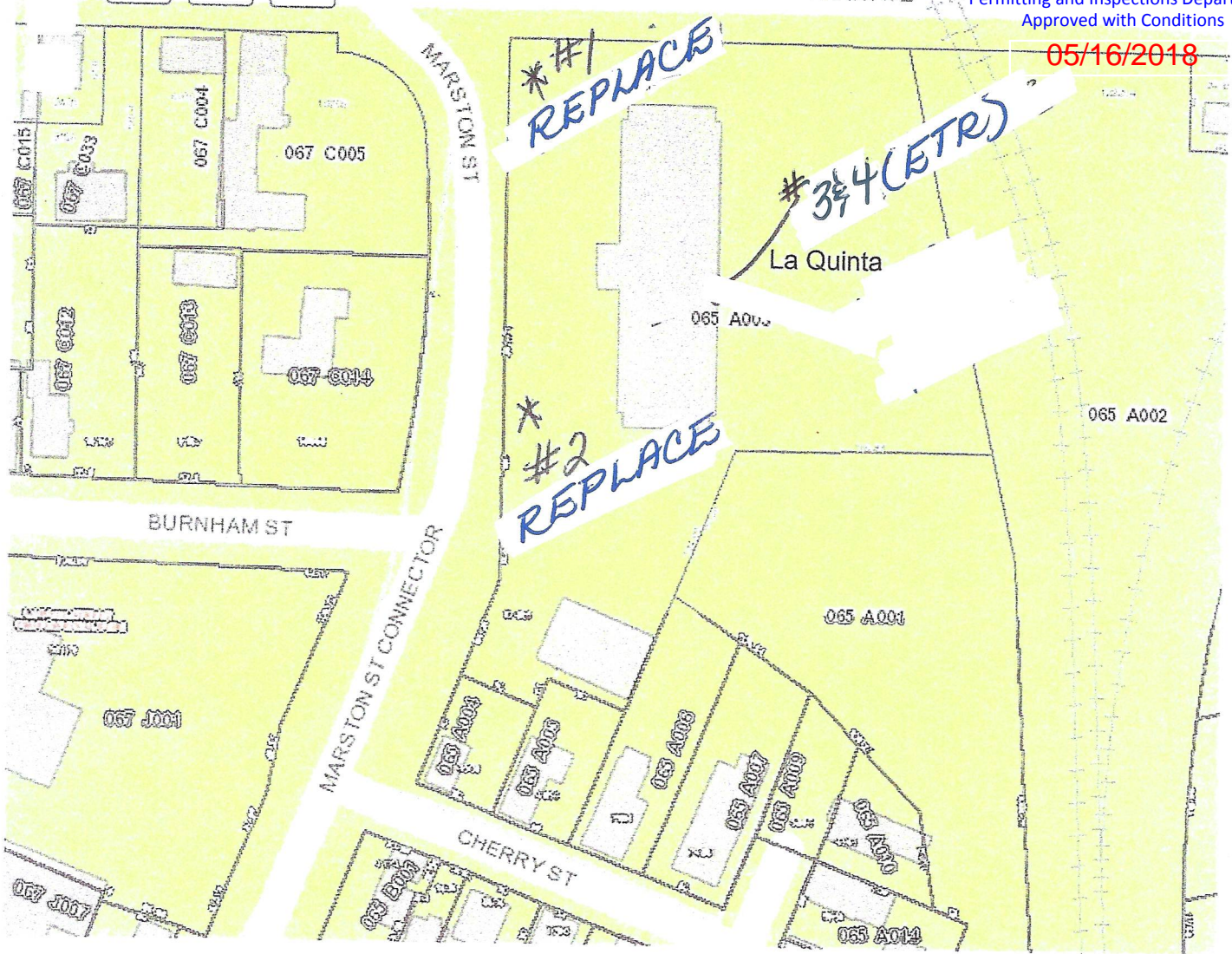

LaQuinta
340 Park Ave
Portland, ME

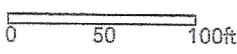

2,973,063.464 299 556.020 Feet

LA QUINTA

Portland, ME

NEW 4'-2" x 7'-2" (DS-S33R) DF-CP Illuminated Sign on Existing Pole

Existing S50 - 5'-7" x 8'-11"

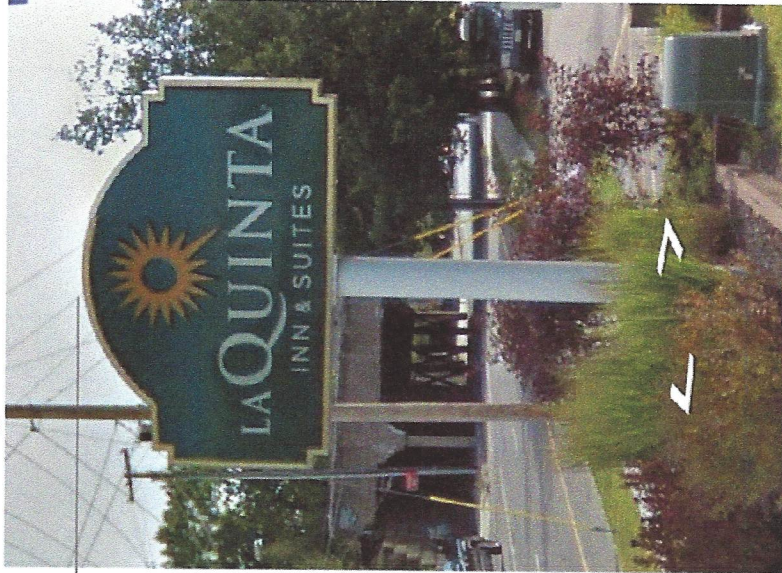

Proposed

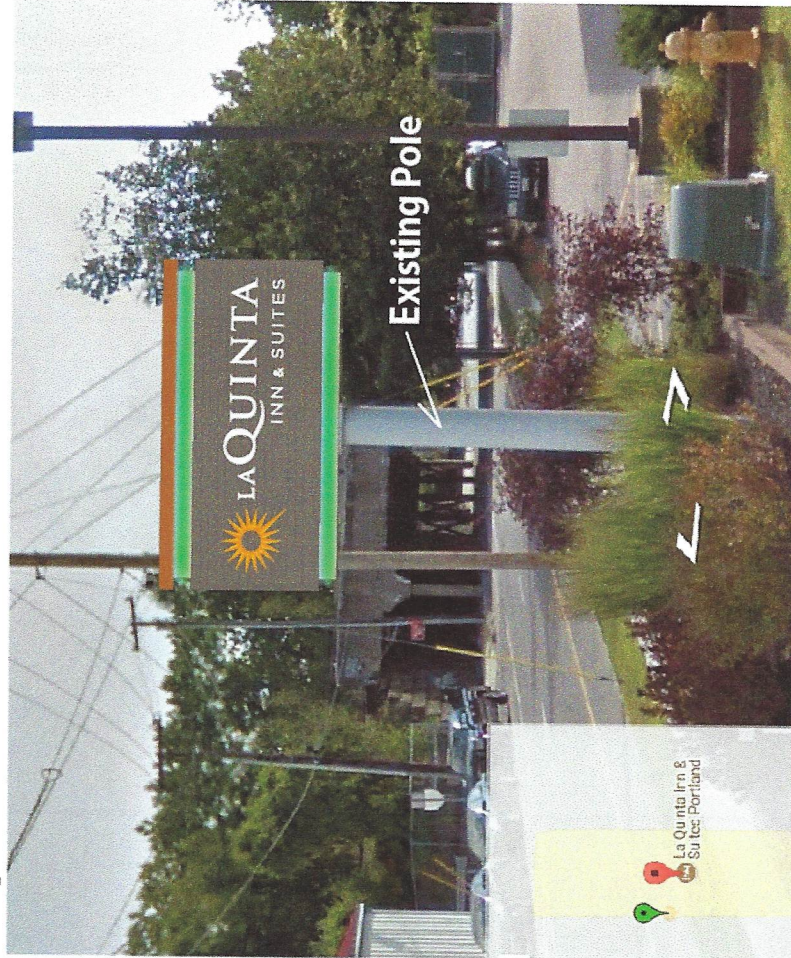

Simulated Night View

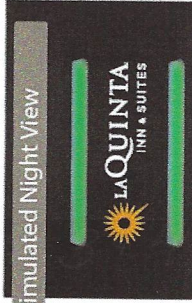

Material & construction to be determined.

- ILLUMINATION = Sunburst, LAQUINTA, INN & SUITES
- Green "Halo Effect"



Dualite Sales & Service, Inc.
WILLIAMSBURG, OHIO • CEDAR HILL, TEXAS

Sketch No. 18-2-2-F-LQ-B1

Dualite Sales & Service, Inc.
One Dualite Lane
Williamsburg, Ohio 45176

Scale:STE Date: 3-5-2018

Approval:

This design is exclusive property of Dualite Sales & Service, Inc. • 1 Dualite Lane - Williamsburg, OH 45176 • Copyright 2018 Dualite Sales & Service, Inc. All Rights Reserved. Reproduction of this proprietary work without the permission of Dualite Sales & Service, Inc. will subject the user to liability under the copyright statute of the State of Ohio.

Note: Dimensions are Approximate and Subject to Change Pending Review by Dualite Engineering.

Reviewed for Code Compliance
Permitting and Inspections Department
Approved with Conditions

05/16/2018



Existing S20 - 3'-6" x 5'-7"

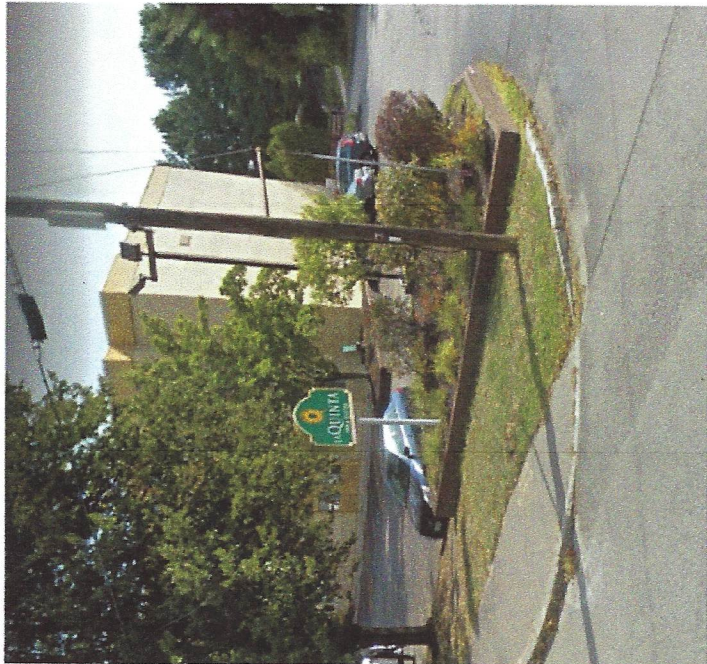

Proposed

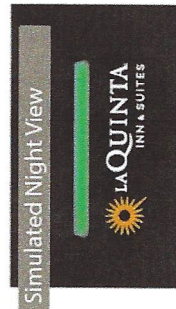
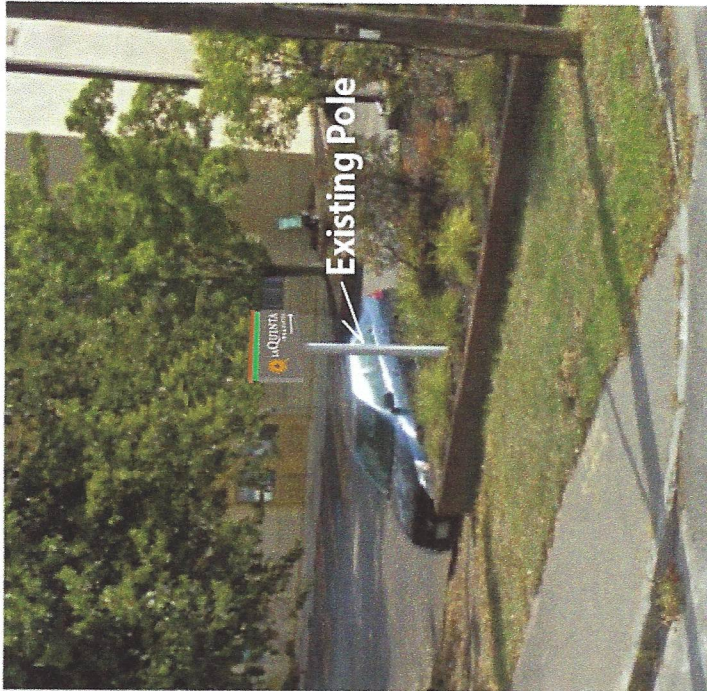

Material & construction to be determined.

- ILLUMINATION = Sunburst, LAQUINTA, INN & SUITES
- Green "Halo Effect"

Reviewed for Code Compliance
Permitting and Inspections Department
Approved with Conditions

05/16/2018

 Dualite Sales & Service, Inc. WILLIAMSBURG, OHIO - CEDAR HILL, TEXAS	Dualite Sales & Service, Inc. One Dualite Lane Williamsburg, Ohio 45176	Sketch No. 18-2-2-F-LQ-C1 Scale: STE	Date: 3-7-2018 Approval:
	This design is exclusive property of Dualite Sales & Service, Inc. • 1 Dualite Lane • Williamsburg, OH 45176 • Copyright 2018 Dualite Sales & Service, Inc. All Rights Reserved. Reproduction of this proprietary work without the permission of Dualite Sales & Service, Inc. will subject the user to liability under the copyright statutes of the United States.		
Note: Dimensions are Approximate and Subject to Change Pending Review by Dualite Engineering.			





Reviewed for Code Compliance
Permitting and Inspections Department
Approved with Conditions

05/16/2018

Letter of Authorization

This letter authorizes a representative of New England Signs – 315 Derry Road – Hudson, NH 03051 to secure permits to perform sign installations, removals or any sign maintenance necessary at our property located at:

340 Park Avenue – Portland, ME 04102

Property Owner : LQ Properties, LLC

Address: 909 Hidden Ridge, Irving, TX 75038

Phone: 214 492 6758 Fax: 214 596 6119

Owner's Signature

Sworn to and subscribed before me this 16 day of April, 2018 by Ted Czyzewski who is personally known to me or provided as identification.

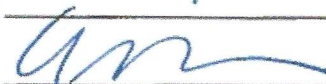
Signature of Notary Public

Ellison Riley
Printed Notary Name

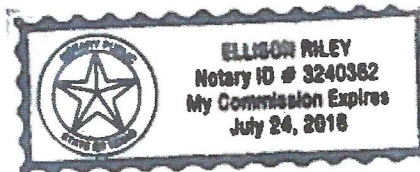



CERTIFICATE OF LIABILITY INSURANCE

DATE (MM/DD/YYYY)
05/15/2018

THIS CERTIFICATE IS ISSUED AS A MATTER OF INFORMATION ONLY AND CONFERS NO RIGHTS UPON THE CERTIFICATE HOLDER. THIS CERTIFICATE DOES NOT AFFIRMATIVELY OR NEGATIVELY AMEND, EXTEND OR ALTER THE COVERAGE AFFORDED BY THE POLICIES BELOW. THIS CERTIFICATE OF INSURANCE DOES NOT CONSTITUTE A CONTRACT BETWEEN THE ISSUING INSURER, AUTHORIZED REPRESENTATIVE OR PRODUCER, AND THE CERTIFICATE HOLDER.



IMPORTANT: If the certificate holder is an ADDITIONAL INSURED, the policy(ies) must have ADDITIONAL INSURED provisions endorsed. If SUBROGATION IS WAIVED, subject to the terms and conditions of the policy, certain policies may require an endorsement. A statement on this certification does not confer rights to the certificate holder in lieu of such endorsement(s).

Reviewed for Code Compliance
Permitting and Inspections Department

PRODUCER 603-890-6439 Santo Insurance and Financial 224 Main Street Suite 2A Salem, NH 03079 Michael Kimball	CONTACT NAME: Michael Kimball PHONE (A/C. No, Ext): 603-890-6439 E-MAIL ADDRESS: Approved with Conditions (A/C. No.) 603-890-6521 05/16/2018												
INSURER(S) AFFORDING COVERAGE													
INSURED New England Signs & Awings Rob Mcintyre (President) 315 Derry Road Unit 3 Hudson, NH 03051	<table border="1" style="width: 100%; border-collapse: collapse;"> <tr> <td style="width: 80%;">INSURER A : MMG Insurance</td> <td style="width: 20%;">NAIC # 15997</td> </tr> <tr> <td>INSURER B : AM Trust</td> <td></td> </tr> <tr> <td>INSURER C :</td> <td></td> </tr> <tr> <td>INSURER D :</td> <td></td> </tr> <tr> <td>INSURER E :</td> <td></td> </tr> <tr> <td>INSURER F :</td> <td></td> </tr> </table>	INSURER A : MMG Insurance	NAIC # 15997	INSURER B : AM Trust		INSURER C :		INSURER D :		INSURER E :		INSURER F :	
INSURER A : MMG Insurance	NAIC # 15997												
INSURER B : AM Trust													
INSURER C :													
INSURER D :													
INSURER E :													
INSURER F :													

COVERAGES CERTIFICATE NUMBER: REVISION NUMBER:

THIS IS TO CERTIFY THAT THE POLICIES OF INSURANCE LISTED BELOW HAVE BEEN ISSUED TO THE INSURED NAMED ABOVE FOR THE POLICY PERIOD INDICATED. NOTWITHSTANDING ANY REQUIREMENT, TERM OR CONDITION OF ANY CONTRACT OR OTHER DOCUMENT WITH RESPECT TO WHICH THIS CERTIFICATE MAY BE ISSUED OR MAY PERTAIN, THE INSURANCE AFFORDED BY THE POLICIES DESCRIBED HEREIN IS SUBJECT TO ALL THE TERMS, EXCLUSIONS AND CONDITIONS OF SUCH POLICIES. LIMITS SHOWN MAY HAVE BEEN REDUCED BY PAID CLAIMS.

INSR LTR	TYPE OF INSURANCE	ADDL INSD	SUBR WVD	POLICY NUMBER	POLICY EFF (MM/DD/YYYY)	POLICY EXP (MM/DD/YYYY)	LIMITS														
A	<input checked="" type="checkbox"/> COMMERCIAL GENERAL LIABILITY <input type="checkbox"/> CLAIMS-MADE <input checked="" type="checkbox"/> OCCUR GEN'L AGGREGATE LIMIT APPLIES PER: <input type="checkbox"/> POLICY <input checked="" type="checkbox"/> PRO-JECT <input type="checkbox"/> LOC OTHER:			SC12878577	11/29/2017	11/29/2018	<table border="1" style="width: 100%; border-collapse: collapse;"> <tr><td>EACH OCCURRENCE</td><td style="text-align: right;">\$ 1,000,000</td></tr> <tr><td>DAMAGE TO RENTED PREMISES (Ea occurrence)</td><td style="text-align: right;">\$ 100,000</td></tr> <tr><td>MED EXP (Any one person)</td><td style="text-align: right;">\$ 10,000</td></tr> <tr><td>PERSONAL & ADV INJURY</td><td style="text-align: right;">\$ 1,000,000</td></tr> <tr><td>GENERAL AGGREGATE</td><td style="text-align: right;">\$ 2,000,000</td></tr> <tr><td>PRODUCTS - COM/OP AGG</td><td style="text-align: right;">\$ 2,000,000</td></tr> <tr><td></td><td style="text-align: right;">\$</td></tr> </table>	EACH OCCURRENCE	\$ 1,000,000	DAMAGE TO RENTED PREMISES (Ea occurrence)	\$ 100,000	MED EXP (Any one person)	\$ 10,000	PERSONAL & ADV INJURY	\$ 1,000,000	GENERAL AGGREGATE	\$ 2,000,000	PRODUCTS - COM/OP AGG	\$ 2,000,000		\$
EACH OCCURRENCE	\$ 1,000,000																				
DAMAGE TO RENTED PREMISES (Ea occurrence)	\$ 100,000																				
MED EXP (Any one person)	\$ 10,000																				
PERSONAL & ADV INJURY	\$ 1,000,000																				
GENERAL AGGREGATE	\$ 2,000,000																				
PRODUCTS - COM/OP AGG	\$ 2,000,000																				
	\$																				
A	AUTOMOBILE LIABILITY <input type="checkbox"/> ANY AUTO OWNED AUTOS ONLY <input checked="" type="checkbox"/> SCHEDULED AUTOS <input checked="" type="checkbox"/> HIRED AUTOS ONLY <input checked="" type="checkbox"/> NON-OWNED AUTOS ONLY			KA12878577	11/29/2017	11/29/2018	<table border="1" style="width: 100%; border-collapse: collapse;"> <tr><td>COMBINED SINGLE LIMIT (Ea accident)</td><td style="text-align: right;">\$ 1,000,000</td></tr> <tr><td>BODILY INJURY (Per person)</td><td style="text-align: right;">\$</td></tr> <tr><td>BODILY INJURY (Per accident)</td><td style="text-align: right;">\$</td></tr> <tr><td>PROPERTY DAMAGE (Per accident)</td><td style="text-align: right;">\$</td></tr> <tr><td></td><td style="text-align: right;">\$</td></tr> </table>	COMBINED SINGLE LIMIT (Ea accident)	\$ 1,000,000	BODILY INJURY (Per person)	\$	BODILY INJURY (Per accident)	\$	PROPERTY DAMAGE (Per accident)	\$		\$				
COMBINED SINGLE LIMIT (Ea accident)	\$ 1,000,000																				
BODILY INJURY (Per person)	\$																				
BODILY INJURY (Per accident)	\$																				
PROPERTY DAMAGE (Per accident)	\$																				
	\$																				
A	<input type="checkbox"/> UMBRELLA LIAB <input checked="" type="checkbox"/> OCCUR <input type="checkbox"/> EXCESS LIAB <input type="checkbox"/> CLAIMS-MADE DED RETENTION \$			SC12878577	11/29/2017	11/29/2018	<table border="1" style="width: 100%; border-collapse: collapse;"> <tr><td>EACH OCCURRENCE</td><td style="text-align: right;">\$ 1,000,000</td></tr> <tr><td>AGGREGATE</td><td style="text-align: right;">\$ 1,000,000</td></tr> <tr><td></td><td style="text-align: right;">\$</td></tr> </table>	EACH OCCURRENCE	\$ 1,000,000	AGGREGATE	\$ 1,000,000		\$								
EACH OCCURRENCE	\$ 1,000,000																				
AGGREGATE	\$ 1,000,000																				
	\$																				
B	WORKERS COMPENSATION AND EMPLOYERS' LIABILITY ANY PROPRIETOR/PARTNER/EXECUTIVE OFFICER/MEMBER EXCLUDED? (Mandatory in NH) <input type="checkbox"/> Y <input type="checkbox"/> N <input type="checkbox"/> N/A If yes, describe under DESCRIPTION OF OPERATIONS below			SWC111173847 3A NH	11/28/2017	11/28/2018	<table border="1" style="width: 100%; border-collapse: collapse;"> <tr> <td><input checked="" type="checkbox"/> PER STATUTE</td> <td><input type="checkbox"/> OTHER</td> <td></td> </tr> <tr><td>E.L. EACH ACCIDENT</td><td></td><td style="text-align: right;">\$ 500,000</td></tr> <tr><td>E.L. DISEASE - EA EMPLOYEE</td><td></td><td style="text-align: right;">\$ 500,000</td></tr> <tr><td>E.L. DISEASE - POLICY LIMIT</td><td></td><td style="text-align: right;">\$ 500,000</td></tr> </table>	<input checked="" type="checkbox"/> PER STATUTE	<input type="checkbox"/> OTHER		E.L. EACH ACCIDENT		\$ 500,000	E.L. DISEASE - EA EMPLOYEE		\$ 500,000	E.L. DISEASE - POLICY LIMIT		\$ 500,000		
<input checked="" type="checkbox"/> PER STATUTE	<input type="checkbox"/> OTHER																				
E.L. EACH ACCIDENT		\$ 500,000																			
E.L. DISEASE - EA EMPLOYEE		\$ 500,000																			
E.L. DISEASE - POLICY LIMIT		\$ 500,000																			

DESCRIPTION OF OPERATIONS / LOCATIONS / VEHICLES (ACORD 101, Additional Remarks Schedule, may be attached if more space is required)

CERTIFICATE HOLDER City of Portland 389 Congress St Portland, ME 04101	CANCELLATION SHOULD ANY OF THE ABOVE DESCRIBED POLICIES BE CANCELLED BEFORE THE EXPIRATION DATE THEREOF, NOTICE WILL BE DELIVERED IN ACCORDANCE WITH THE POLICY PROVISIONS. AUTHORIZED REPRESENTATIVE
--	--



Ann Machado <amachado@portlandmaine.gov>



340 Park Ave - Permit SIGN2018-00017

Carolyn Parker <cappermits@carolynparkerconsulting.com>
To: "amachado@portlandmaine.gov" <amachado@portlandmaine.gov>

Reviewed for Code Compliance
Wed, May 16, 2018 at 9:27 AM
Approved with Conditions

05/16/2018

Ann,

See attached and below, Call if any further questions Carolyn

Carolyn A. Parker Consulting

3 Lorion Avenue

Worcester, MA 01606

774-239-2781

cappermits@carolynparkerconsulting.com

From: Rob McIntyre <rob@newenglandsignsandawnings.com>
Sent: Tuesday, May 15, 2018 2:47 PM
To: Carolyn Parker <cappermits@CarolynParkerConsulting.Com>
Subject: RE: 340 Park Ave - Permit SIGN2018-00017

Hi Carolyn,

Here is the COI. The materials will be alum, plastic and steel.

Sincerely,

Rob McIntyre



We service the following states:

New Hampshire, Massachusetts, Maine, Vermont and Connecticut.

5/16/2018

City of Portland Mail - 340 Park Ave - Permit SIGN2018-00017

315 Derry RD (unit 3)

Hudson, NH 03051

Tel: (603) 235-7205

Fax: (603) 883-1050

rob@newenglandsignsandawnings.com

www.NewEnglandSignsandAwnings.com



Reviewed for Code Compliance
Permitting and Inspections Department
Approved with Conditions

05/16/2018

CONFIDENTIALITY NOTICE: The information contained in this communication may be confidential, and is intended only for the use of the recipients named above. You are hereby notified that any dissemination, distribution, or copying of this communication, or any of its contents, to any other party, is strictly prohibited. If you have received this communication in error, please return it to the sender immediately and delete the original message and any copy of it from your computer system. If you have any questions concerning this message, please contact the sender.

From: Carolyn Parker [<mailto:capermits@CarolynParkerConsulting.Com>]

Sent: Tuesday, May 15, 2018 10:29 AM

To: Rob McIntyre

Subject: FW: 340 Park Ave - Permit SIGN2018-00017

Rob,

Drawings say materials are TBD – need this info please

From: Ann Machado <amachado@portlandmaine.gov>

Sent: Tuesday, May 15, 2018 10:12 AM

To: capconsulting@verizon.net

Subject: 340 Park Ave - Permit SIGN2018-00017

[Quoted text hidden]

Notice: Under Maine law, documents - including e-mails - in the possession of public officials or city employees about government business may be classified as public records. There are very few exceptions. As a result, please be advised that what is written in an e-mail could be released to the public and/or the media if requested.

 **717157737e.pdf**
54K