

C1 REGISTRATION DESK - SIDE ELEVATION 1
1 1/2" = 1'-0"

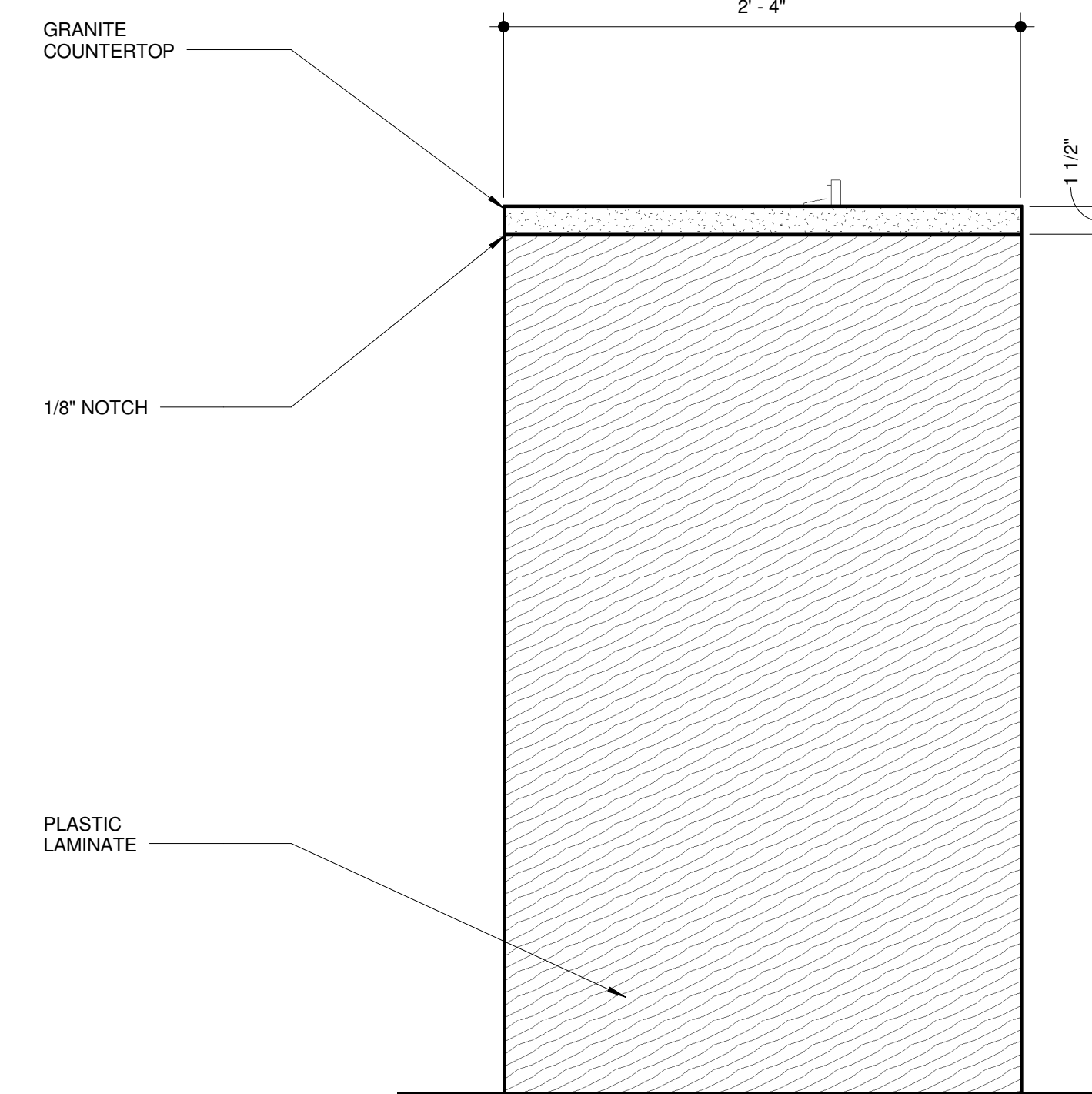

C4 REGISTRATION DESK - SIDE ELEVATION 2
1 1/2" = 1'-0"

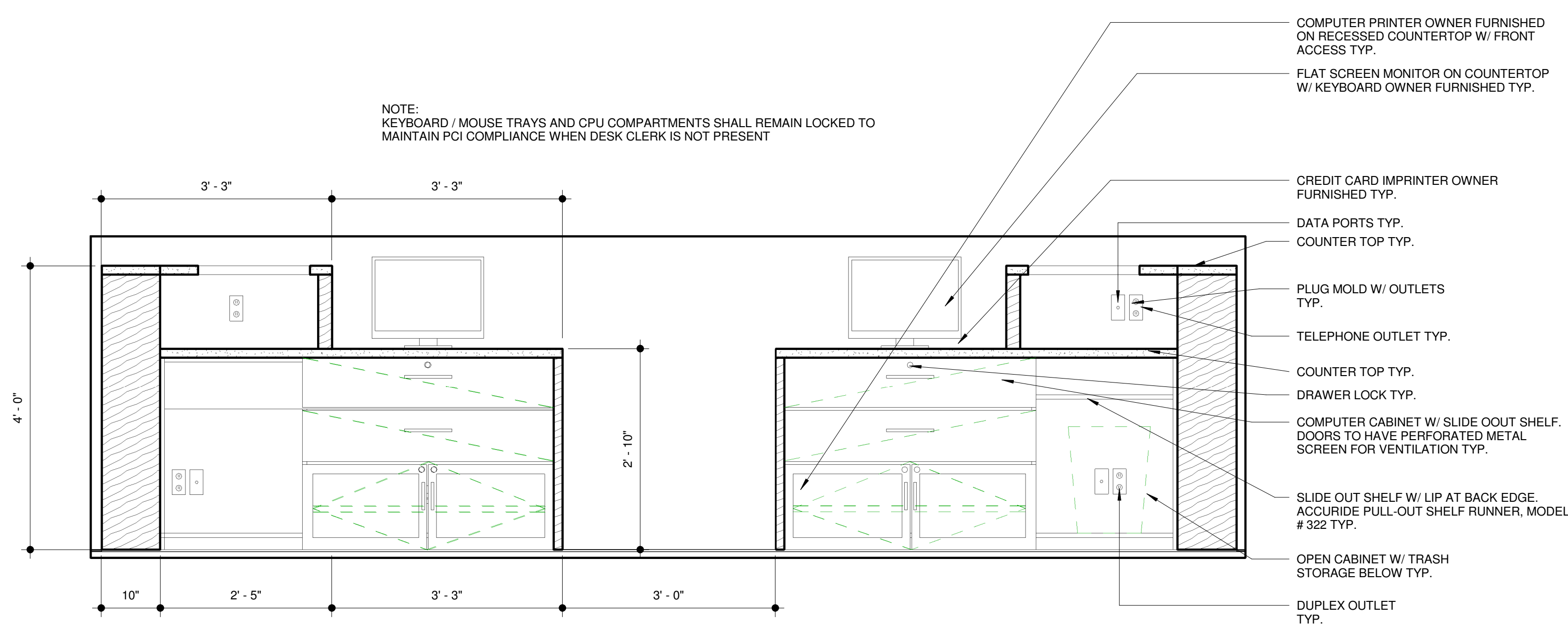

A3 REGISTRATION - REAR ELEVATION
3/4" = 1'-0"

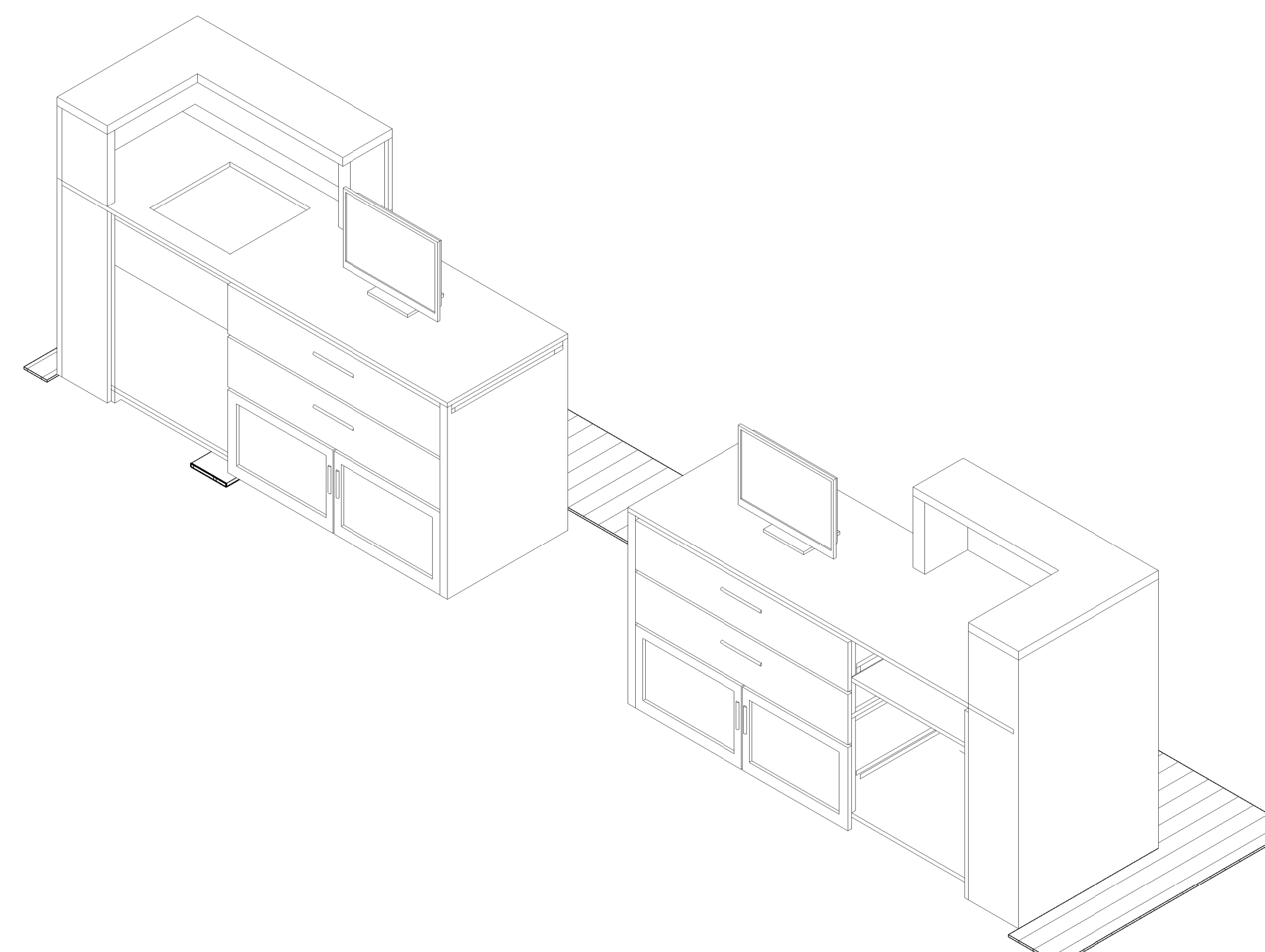

Project:
PORTLAND LaQUINTA INN & SUITES LQ #2049 RENOVATION
 340 Park Ave, Portland, ME 04102

Project Owner:
LQ MANAGEMENT, LLC
 909 HIDDEN RIDGE, SUITE 600 IRVING, TEXAS 75038

Architect:
BMA
 Professional Corporation
BMA Architectural Group
 Architects ■ Designers ■ Planners
 12 Middle Street
 Amherst, New Hampshire 03031
 TEL 603 673 1991 FAX 603 672 1385
 www.bmaworld.com

Seal:

 ROLF K. BIGGERS
 No. 2597
 STATE OF MAINE

BMA COPYRIGHT:
 These plans are copyrighted and are subject to copyright protection as an "architectural work" under Sec. 102 of the Copyright Act, 17 U.S.O. as amended December 1990 and known as Architectural Works Copyright Protection Act of 1990. The protection includes but is not limited to the overall form as well as the arrangement and composition of spaces and elements of the design. Under such protection, unauthorized use of these plans, work or home represented, can legally result in the cessation of construction or buildings being seized and/or monetary compensation to BMA, P.C.

REVISIONS

NO.	DESCRIPTION

Job Number: 3044
 Drawn By: C.J.T.
 Checked By: RKB
 Phase: LOBBY AND ADA DOCUMENTS

Drawing Title:
FRONT DESK DETAILS

SHEET NUMBER:
A-802
 DATE: 14 APRIL 2017