

BMA COPYRIGHT:
 These plans are copyrighted and are subject to copyright protection as an "architectural work" under Sec. 102 of the Copyright Act, 17 U.S.O. as amended December 1990 and known as Architectural Works Copyright Protection Act of 1990. The protection includes but is not limited to the overall form as well as the arrangement and composition of spaces and elements of the design. Under such protection, unauthorized use of these plans, work or home represented, can legally result in the cessation of construction or buildings being seized and/or monetary compensation to BMA, P.C.

REVISIONS

Job Number:	3044
Drawn By:	CJT
Checked By:	RKB
Phase:	LOBBY AND ADA DOCUMENTS

Drawing Title:
ENLARGED GUESTROOM PLANS AND ELEVATIONS - ACC D/D

SHEET NUMBER:
A-405
 DATE: 14 APRIL 2017

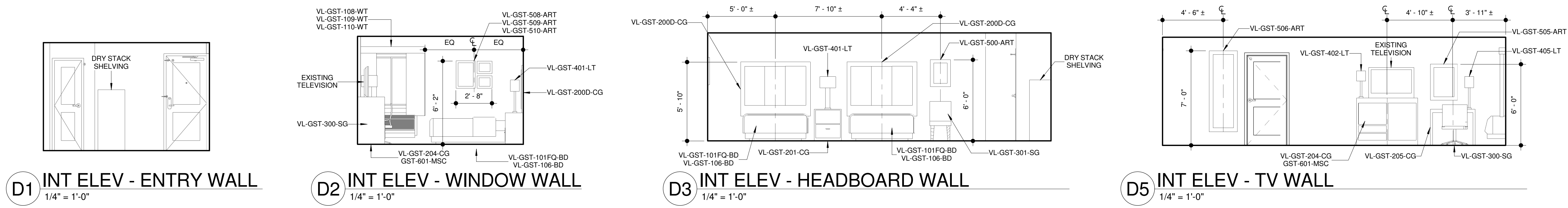

DEMOLITION KEYNOTES	
Key Value	Keynote Text
D01	REMOVE EXISTING VANITY AND PREPARE FOR NEW.
D02	REMOVE EXISTING VANITY MIRROR AND PREPARE FOR NEW LIGHTED MIRROR
D03	REMOVE EXISTING FLOORING, PAD (IF APPLICABLE), AND BASE AND PREPARE FOR NEW.
D04	REMOVE ANY EXISTING VWC AND PREPARE FOR NEW PAINTED TEXTURED FINISH TO MATCH EXISTING. VWC LOCATIONS MAY VARY BY GUESTROOM TYPE.
D05	EXISTING ARTWORK, MIRRORS, AND OTHER WALL-HUNG FF&E TO BE REMOVED. PATCH AND REPAIR WALLS AS REQUIRED.
D06	REMOVE EXISTING PARTITION. PATCH/REPAIR REMAINING PARTITION AS REQUIRED.
D08	REMOVE EXISTING DOOR, FRAME, AND ALL HARDWARE.
D10	REMOVE EXISTING PLUMBING FIXTURES AND PREPARE FOR NEW.
D15	REMOVE EXISTING FURNITURE.

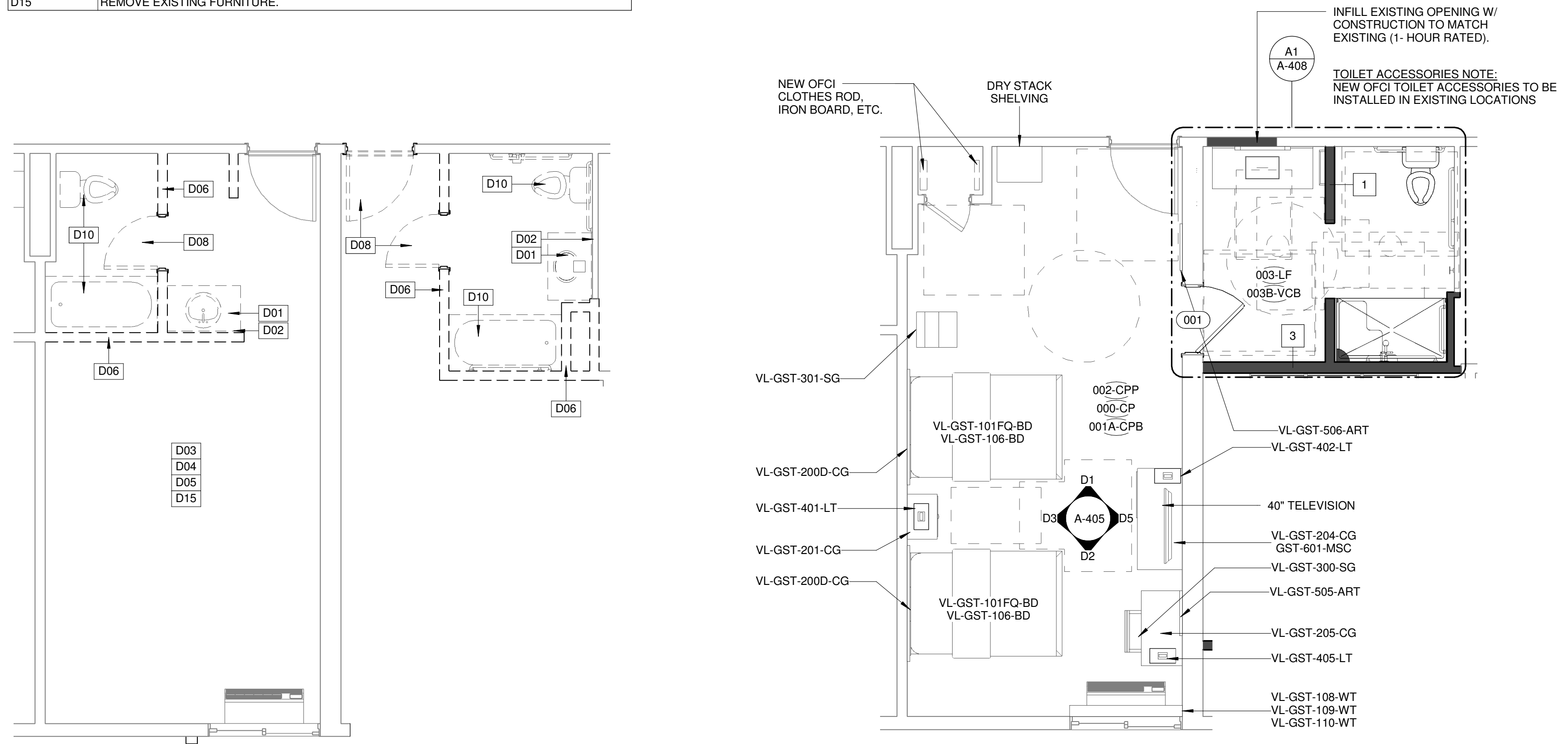

- GUESTROOM FINISHES**
- FLOORS: AS NOTED ON PLANS.
- FLOOR TRANSITIONS: VINYL TRANSITION: JOHNSONITE CE-XX-A, CHARCOAL
- WALLS: GUESTROOM FIELD COLOR - PT-10
 GUESTROOM ACCENT (HEADBOARD WALL) - PT-8
 BATHROOM - PT-10
 BATHROOM ACCENT: PT-5
- CEILINGS: PT-2
- GRILLS, DIFFUSERS: PAINT ADJACENT WALL/CEILING COLOR.
- VERTICAL FACE OF SOFFITS: CONTINUE ADJACENT WALL COLOR.
- CLOSET & ENTRY DOORS AND FRAMES: PT-2
- BATHROOM DOORS AND FRAMES: PT-2
- NOTE: PET GUESTROOMS ARE TO HAVE FLOOR FINISH 003-LF AND BASE 003B-VCB THROUGHOUT THE ENTIRE ROOM. COORDINATE PET GUESTROOM LOCATIONS WITH OWNER.

- CORRIDOR FINISHES**
- FLOOR: CARPET, COORDINATE W/ OWNER
- WALL BASE: CARPET, COORDINATE W/ OWNER
- WALL: WC-6 AND WC-7 - REFER TO CORRIDOR ELEVATION FOR LOCATIONS
- CORNER GUARDS: PROVIDE INPRO 8" X 1 1/2" CORNER GUARDS @ 90 DEGREE CORNERS OF DOOR INSETS.
 - AT WALLS W/ WC-6: CG-1 COLOR 0119 PEPPERDUST
 - AT WALLS W/ WC-7: CG-2 COLOR 0280 SHIPROCK
- FIRE EXTINGUISHER CABINETS: PT-5

FINISH TAG	COLOR/MODEL	SHEEN
PT-1	SW7016 MINDFUL GREY	EGGSHELL
PT-2	SW7008 ALABASTER	FLAT @ CEILINGS SEMI-GLOSS @ DOORS & FRAMES
PT-5	SW7018 DOWETAIL	SEMI-GLOSS
PT-8	SW2072 PURPLE LOTUS	EGGSHELL
PT-9	SW7019 GAUNTLET GREY	SEMI-GLOSS
PT-10	SW1032 CITY LOFT	SEMI-GLOSS @ BATHROOMS EGGSHELL @ OTHER AREAS

- WC-6 DL COUCH
 JG-18-LQ03 SONNET, NICKEL
- WC-7 DL COUCH
 JG-18-LQ04 BRIO, HUNAN 54" ROLL
- ACT-1 ARMSTRONG LUMAWASH - SQUARE TEGULAR
 REPLACE ALL EXISTING 2x2 TILES AT GUEST CORRIDORS

- DOOR HARDWARE NOTES:**
- ALL HARDWARE EXCEPT CARD KEYLOCK WILL BE REMOVED AND REPLACED WITH NEW BRUSHED NICKEL HARDWARE.
 - CFCI: HINGES, STOPS, LATCHES, DOOR VIEWERS, CLOSET DOOR HANDLES, BATHROOM DOOR HANDLES.

DRAPERY NOTE:
 PROVIDE MOTORIZED DRAPERY @ ACCESSIBLE ROOMS. CONTROLS TO BE MOUNTED IN AN ACCESSIBLE LOCATION. COORDINATE W/ ARCHITECT.

ROOM MATRIX				
	ACC KING	ACC KING SUITE	ACC DOUBLE/DOUBLE	TOTAL
FIRST FLOOR	1	-	1 (W/ROLL-IN)	2
SECOND FLOOR	1	1	-	2
THIRD FLOOR	1	-	-	1
FOURTH FLOOR	-	-	-	-
TOTAL	3	1	1	5

NOTE: ROOM MATRIX DOES NOT INCLUDE TYPICAL GUESTROOMS. FOR A TOTAL OF 95 GUESTROOMS. THESE ROOMS HAVE BEEN SUBMITTED AT AN EARLIER DATE UNDER A SEPARATE PERMIT APPLICATION.

D01 FIRST FLOOR DEMOLITION PLAN - Callout 1
 1/4" = 1'-0"

A3 ENLARGED GUESTROOM FF&E PLAN - ACC. DOUBLE/ DOUBLE
 1/4" = 1'-0"