

ROOM MATRIX									
	KING	KING 2	DOUBLE/DOUBLE	DOUBLE	DOUBLE 2	ACC KING	ACC KING SUITE	ACC. DBL DBL	TOTAL
FIRST FLOOR	4	-	9	1	-	1	-	1	16
SECOND FLOOR	10	1	14	1	-	1	1	-	28
THIRD FLOOR	10	-	15	1	1	1	-	-	28
FOURTH FLOOR	12	-	13	2	1	-	-	-	28
TOTAL	36	1	51	5	2	3	1	1	100

- 2010 ADA DESIGN STANDARDS

ROOM TYPE	QTY	PCT
KING	38 (1 ACC)	38%
DOUBLE/DOUBLE	52 (1 ACC)	52%
DOUBLE	9 (2 ACC)	9%
KING SUITE	1 (1 ACC)	1%
TOTAL	100 (5 ACC)	100.0%

**GUESTROOM DATA**

5 ACCESSIBLE GUESTROOMS (1 ROLL-IN SHOWER)

ADA REQUIRES 5 ACCESSIBLE GUESTROOMS BASED ON 100 TOTAL GUESTROOMS.

ADA REQUIRES 9 HRI GUESTROOMS, BASED ON 100 TOTAL GUESTROOMS - 1 INCLUDED IN ACC RMS, 8 ADDITIONAL HRI REQUIRED = 9 TOTAL HRI RMS.

TOTAL OF 9 GUESTROOMS WITH COMMUNICATION FEATURES (INCLUDING ACCESSIBLE GUESTROOM) ROOMS 119, 120, 121, 123, 125, 218, 220, 221, 223.

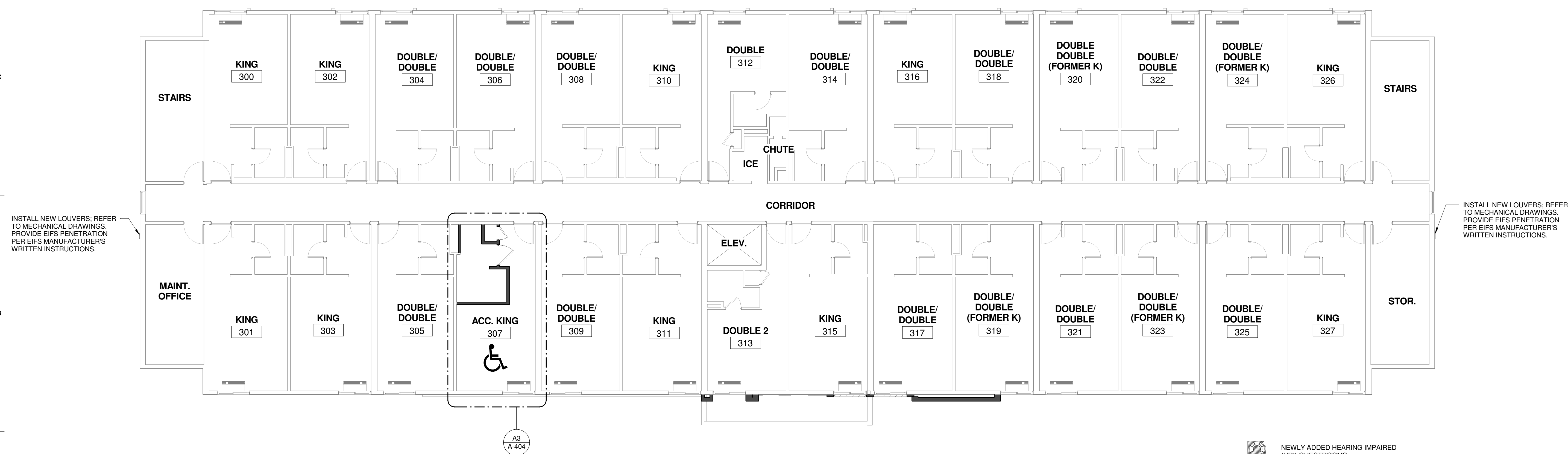

INSTALL NEW LOUVERS; REFER TO MECHANICAL DRAWINGS. PROVIDE EIFS PENETRATION PER EIFS MANUFACTURER'S WRITTEN INSTRUCTIONS.

INSTALL NEW LOUVERS; REFER TO MECHANICAL DRAWINGS. PROVIDE EIFS PENETRATION PER EIFS MANUFACTURER'S WRITTEN INSTRUCTIONS.

- NEWLY ADDED HEARING IMPAIRED (HRI) GUESTROOMS
- NEW ACCESSIBLE GUESTROOMS

Project:  
  
**PORTLAND LaQUINTA INN & SUITES LQ #2049 RENOVATION**  
 340 Park Ave, Portland, ME 04102

Project Owner:  
**LQ MANAGEMENT, LLC**  
 909 HIDDEN RIDGE, SUITE 600 IRVING, TEXAS 75038

Architect:  
  
 Professional Corporation  
**BMA Architectural Group**  
 Architects ■ Designers ■ Planners  
 12 Middle Street  
 Amherst, New Hampshire 03031  
 TEL 603 673 1991 FAX 603 672 1385  
 www.bmaworld.com

Seal:

**BMA COPYRIGHT:**  
 These plans are copyrighted and are subject to copyright protection as an "architectural work" under Sec. 102 of the Copyright Act, 17 U.S.O. as amended December 1990 and known as Architectural Works Copyright Protection Act of 1990. The protection includes but is not limited to the overall form as well as the arrangement and composition of spaces and elements of the design. Under such protection, unauthorized use of these plans, work or home represented, can legally result in the cessation of construction or buildings being seized and/or monetary compensation to BMA, P.C.

REVISIONS

NO.	DESCRIPTION

Job Number:	3044
Drawn By:	CJT
Checked By:	RKB
Phase:	LOBBY AND ADA DOCUMENTS

Drawing Title:  
**THIRD FLOOR PLAN**

SHEET NUMBER:  
**A-103**  
 DATE: 14 APRIL 2017