

LEGEND

- Iron marker - found
- Property line (abutter)
- Property line (locus)
- - - Right of way line
- · - · - Easement line
- Board fence
- × Metal fence
- · - · - Edge of pavement
- Sign
- ★ Lamp or light pole
- Utility pole
- Guy wire
- Gas valve
- Gas meter
- Water valve
- Water shutoff
- Fire hydrant
- Sewer manhole
- Electric manhole
- Water manhole
- Catch basin (round)
- Catch basin (square)
- Drain manhole
- Bollard
- Overhead utility line
- Sewer line
- Storm drain
- Underground water line
- Underground gas line
- Underground electric line
- Contours (1ft)
- Contours (5ft)
- Now or formerly of
- Deed reference (Book/Page)
- Tree line
- Deciduous tree
- Coniferous tree
- Existing building
- Concrete
- Test boring

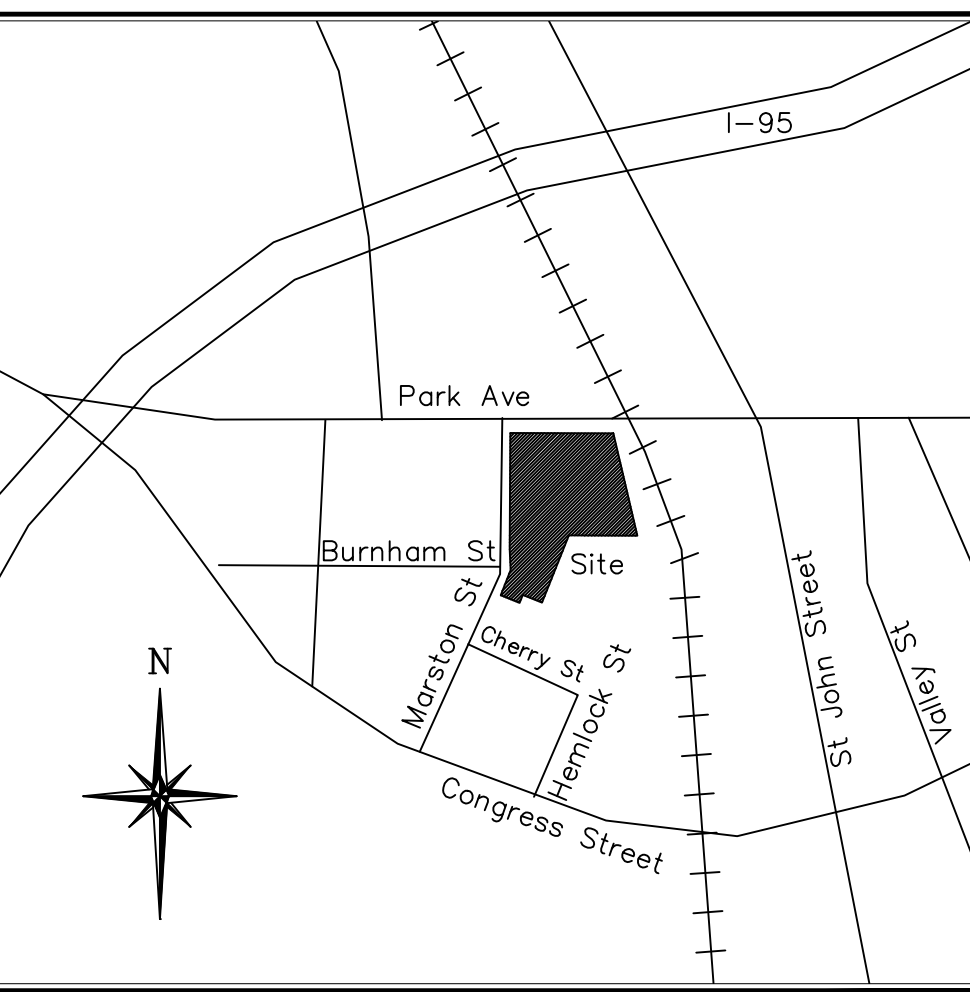

VICINITY MAP
No Scale

NOTES

- 1) This is not a boundary survey. The location of boundary lines rely entirely upon the information shown on plan reference #1 and no representations will be made or implied regarding the accuracy of the information shown.
- 2) Book and Page references are to the Cumberland County Registry of Deeds.
- 3) Bearings are referenced to City of Portland Datum taken from the Portland CSO project on Marston and Burnham Streets performed by Tiltcomb Associates in 2007 (project# 207094). Base Point: Traverse #24 (mag nail)(N: 299438.18 E: 2921952.13) Azimuth: Traverse #22 (mag nail)(N: 299446.74 E: 2921822.58)
- 4) Elevations are based on City of Portland datum by MDT disk labeled "TANK" on St. James Street; elevation: 34.32'.
- 5) Utility information on this plan is approximate, based on location of visible features and information contained on plans and drawings provided by others. DigSafe and/or the appropriate utilities should be contacted prior to any construction.
- 6) Property lies within Zone C based on FIRM Community #230051 Panel #013 B, dated July 17, 1986. It does not lie within a special flood hazard area.

PLAN REFERENCES

- 1) Plan of ALTA/ACSM Land Title Survey performed for Blackstone Portfolio by Book & Clark National Surveyors and Holden Engineering & Surveying, Inc., dated November 18, 2013 and revised through December 4, 2013.

EASEMENTS / ENCUMBRANCES

- 1) Subject to and benefiting from an easement for an underground cable granted by Susse Chalet Motor Lodge of Portland, Inc. to Central Maine Power Company by instrument dated February 6, 1985 and recorded in Book 6727, Page 305 as shown on plan reference #1. Location is approximate.

AREA

87,062 s.f., 2.0 acres (as shown on plan reference #1)

OWNERS OF RECORD

LQ Portfolio East LLC
Book 24827, Page 127

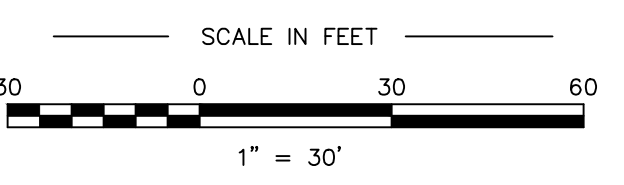

PLAN OF
Topographic Survey

340 Park Avenue Portland, Maine

MADE FOR
Acorn Engineering

158 Danforth Street Portland, Maine

JOB #216107	DATE: 11/15/2016	SCALE: 1" = 30'
BOOK #899	216107.dwg	
FILE #9863	 133 Gray Road, Falmouth, Maine 04105 (207)797-9199 www.tiltcombsurvey.com	

CERTIFICATION

This is not a boundary survey. The location of the boundary lines rely entirely upon the information shown on plan reference 1, no representations are made or implied regarding the accuracy of the information.

Rex J. Croteau, P.L.S. #2273

