

# MORTGAGE LOAN INSPECTION PLAN

249 SAINT JOHN STREET

No. 220-1

PBA P. 16 LOT 18  
CITY PARKIN ADJACENT STWAK  
PORTLAND, MAINE

TO THE LENDING INSTITUTION AND ITS TITLE INSURER  
I hereby certify that the location of the dwelling shown on this plan does conform with the local zoning laws in effect at the time of construction. The property does not fall within a special flood hazard zone.

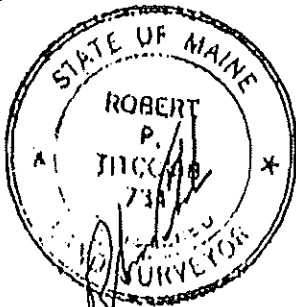

OWNER: JOSEPH P. & DAWN E DESIMONE

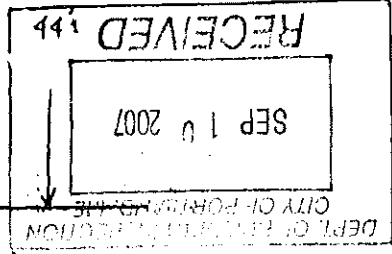
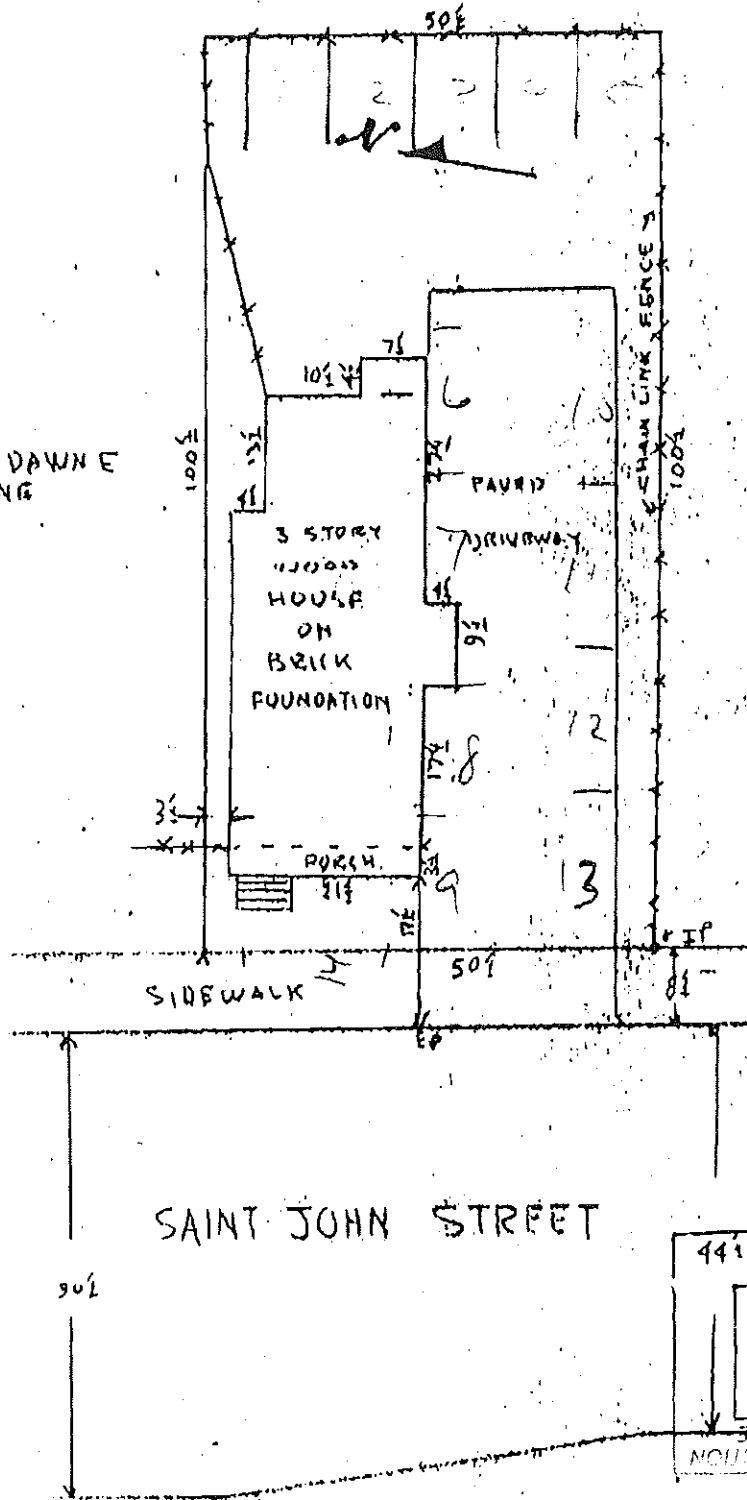

This plan was not made from an instrument survey.  
The certifications are for mortgage purposes only.  
This plan applies only to conditions existing as of the date shown hereon. This plan is not for recording.

Date 9-30-93 Scale 1"=20'

R.P. TITCOMB ASSOCIATES, INC. Falmouth, Maine

Drawn By