

DISPLAY THIS CARD ON PRINCIPAL FRONTAGE OF WORK

CITY OF PORTLAND

BUILDING INSPECTION

PERMIT

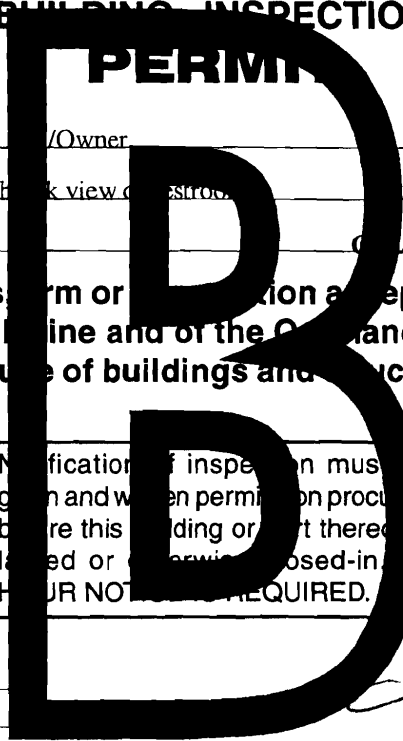

Please Read Application And Notes, If Any, Attached

PERMIT ISSUED
Permit Number: 070598
JUN 21 2007
CITY OF PORTLAND

This is to certify that HO DUC N & YEM T LEE /Owner
has permission to Build a non-bearing wall to block view of street
AT 249 ST JOHN ST 064 D006001

provided that the person or persons who apply for or accept this permit shall comply with all of the provisions of the Statutes of the State and of the Ordinances of the City of Portland regulating the construction, maintenance and use of buildings and structures, and of the application on file in this department.

Apply to Public Works for street line and grade if nature of work requires such information.

Notification of inspection must be given and when permission procured before this building or part thereof is leased or otherwise closed-in. 24 HOUR NOTICES ARE REQUIRED.

A certificate of occupancy must be procured by owner before this building or part thereof is occupied.

OTHER REQUIRED APPROVALS

Fire Dept. Jay Kelley P.F.D. 5/31/07
Health Dept. _____
Appeal Board _____
Other _____
Department Name

6/13/07
Director - Building & Inspection Services

PENALTY FOR REMOVING THIS CARD

City of Portland, Maine - Building or Use Permit Application

389 Congress Street, 04101 Tel: (207) 874-8703, Fax: (207) 874-8716

Permit No: 07-0598	Issue Date:	CBL: 064 D006001
-----------------------	-------------	---------------------

Location of Construction: 249 ST JOHN ST	Owner Name: HO DUC N & YEM T LEE JTS	Owner Address: 17 ALLEN RD	Phone:
Business Name:	Contractor Name: Owner	Contractor Address:	Phone
Lessee/Buyer's Name	Phone:	Permit Type: Alterations - Commercial	Zone: B-2

Past Use: Commercial - Viet BangKok - Restaurant	Proposed Use: Viet BangKok - Restaurant - Build a non-bearing wall to block view of restrooms	Permit Fee: \$30.00	Cost of Work: \$1,000.00	CEO District: 2
Proposed Project Description: Build a non-bearing wall to block view of restrooms		FIRE DEPT: <input checked="" type="checkbox"/> Approved <input type="checkbox"/> Denied <i>Jay Kelley P.F.D. 5/23/07</i>	INSPECTION: Use Group: <i>A/B</i> Type: <i>5B</i> <i>IBC 2003</i>	
		Signature: _____ Date: _____		
PEDESTRIAN ACTIVITIES DISTRICT (P.A.D.)				
Action: <input type="checkbox"/> Approved <input type="checkbox"/> Approved w/Conditions <input type="checkbox"/> Denied				
Signature: _____ Date: _____				

Permit Taken By: Idobson	Date Applied For: 05/23/2007	Zoning Approval		
-----------------------------	---------------------------------	------------------------	--	--

- This permit application does not preclude the Applicant(s) from meeting applicable State and Federal Rules.
- Building permits do not include plumbing, septic or electrical work.
- Building permits are void if work is not started within six (6) months of the date of issuance. False information may invalidate a building permit and stop all work..

Special Zone or Reviews	Zoning Appeal	Historic Preservation
<input type="checkbox"/> Shoreland	<input type="checkbox"/> Variance	<input checked="" type="checkbox"/> Not in District or Landmark
<input type="checkbox"/> Wetland	<input type="checkbox"/> Miscellaneous	<input type="checkbox"/> Does Not Require Review
<input type="checkbox"/> Flood Zone	<input type="checkbox"/> Conditional Use	<input type="checkbox"/> Requires Review
<input type="checkbox"/> Subdivision	<input type="checkbox"/> Interpretation	<input type="checkbox"/> Approved
<input type="checkbox"/> Site Plan	<input type="checkbox"/> Approved	<input type="checkbox"/> Approved w/Conditions
Maj <input type="checkbox"/> Minor <input type="checkbox"/> MM <input type="checkbox"/>	<input type="checkbox"/> Denied	<input type="checkbox"/> Denied
Date: <i>5/23/07</i>	Date: _____	Date: _____

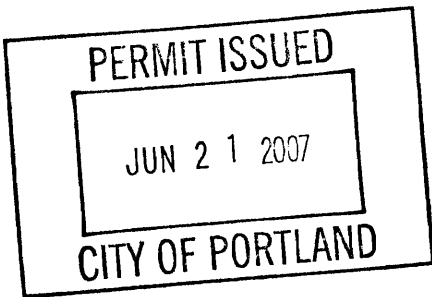

CERTIFICATION

I hereby certify that I am the owner of record of the named property, or that the proposed work is authorized by the owner of record and that I have been authorized by the owner to make this application as his authorized agent and I agree to conform to all applicable laws of this jurisdiction. In addition, if a permit for work described in the application is issued, I certify that the code official's authorized representative shall have the authority to enter all areas covered by such permit at any reasonable hour to enforce the provision of the code(s) applicable to such permit.

SIGNATURE OF APPLICANT	ADDRESS	DATE	PHONE
RESPONSIBLE PERSON IN CHARGE OF WORK, TITLE		DATE	PHONE

City of Portland, Maine - Building or Use Permit

389 Congress Street, 04101 Tel: (207) 874-8703, Fax: (207) 874-8716

Permit No: 07-0598	Date Applied For: 05/23/2007	CBL: 064 D006001
------------------------------	--	----------------------------

Location of Construction: 249 ST JOHN ST	Owner Name: HO DUC N & YEM T LEE JTS	Owner Address: 17 ALLEN RD	Phone:
Business Name:	Contractor Name: Owner	Contractor Address:	Phone:
Lessee/Buyer's Name	Phone:	Permit Type: Alterations - Commercial	

Proposed Use: Viet BangKok - Restaurant - Build a non-bearing wall to block view of restrooms	Proposed Project Description: Build a non-bearing wall to block view of restrooms
---	---

Dept: Zoning	Status: Approved	Reviewer: Marge Schmuckal	Approval Date: 05/23/2007
Note:			Ok to Issue: <input checked="" type="checkbox"/>
Dept: Building	Status: Approved	Reviewer: Tammy Munson	Approval Date: 06/13/2007
Note: work already done - after the fact permit			Ok to Issue: <input checked="" type="checkbox"/>
Dept: Fire	Status: Pending	Reviewer: Jay Kelley	Approval Date: 05/31/2007
Note:			Ok to Issue: <input checked="" type="checkbox"/>
1) Do not interfere with means of egress			



General Building Permit Application

If you or the property owner owes real estate or personal property taxes or user charges on any property within the City, payment arrangements must be made before permits of any kind are accepted.

Location/Address of Construction: <u>249 St John Street, Portland, Maine 04102</u>		
Total Square Footage of Proposed Structure		Square Footage of Lot
Tax Assessor's Chart, Block & Lot Chart# Block# Lot# <u>64</u> <u>D</u> <u>6</u>	Owner: <u>Duc N. Ho</u>	Telephone: <u>415-2626-</u>
Lessee/Buyer's Name (If Applicable)	Applicant name, address & telephone: <u>Duc N. Ho</u> <u>17 Allen Road</u> <u>South Portland ME</u> <u>04106</u>	Cost Of Work: \$ <u>4000</u> Fee: \$ <u>30</u> C of O Fee: \$ _____
Current legal use (i.e. single family) <u>Commercial Restaurant/Vietnam</u> <u>kok.</u> If vacant, what was the previous use? _____ Proposed Specific use: _____ Is property part of a subdivision? _____ If yes, please name _____ Project description: <u>Add wall to block view of Restrooms.</u>		
Contractor's name, address & telephone:		
Who should we contact when the permit is ready: <u>Wayne Steinhope</u> Mailing address: _____ Phone: <u>671-1195</u>		

Please submit all of the information outlined in the Commercial Application Checklist. Failure to do so will result in the automatic denial of your permit.

In order to be sure the City fully understands the full scope of the project, the Planning and Development Department may request additional information prior to the issuance of a permit. For further information visit us on-line at www.portlandmaine.gov, stop by the Building Inspections office, room 315 City Hall or call 874-8703.

I hereby certify that I am the Owner of record of the named property, or that the owner of record authorizes the proposed work and that I have been authorized by the owner to make this application as his/her authorized agent. I agree to conform to all applicable laws of this jurisdiction. In addition, if a permit for work described in this application is issued, I certify that the Code Official's authorized representative shall have the authority to enter all areas covered by this permit at any reasonable hour to enforce the provisions of the codes applicable to this permit.

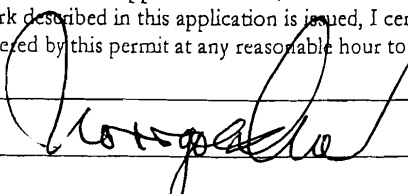
Signature of applicant: 	Date: <u>5/22/07</u>
---	----------------------

This is not a permit; you may not commence ANY work until the permit is issued.

CEILING

WALL

ATTACHED TO CEILING

Hallway
to
Bathrooms

WALL

2x4" ↑
FLOOR

2"x4" FRAME ↓

1" SHEET ROCK
ATTACHED TO 2"x4"
PAINTED

FRAME IS ATTACHED TO
CEILING AND FLOOR BY
2" SCREWS

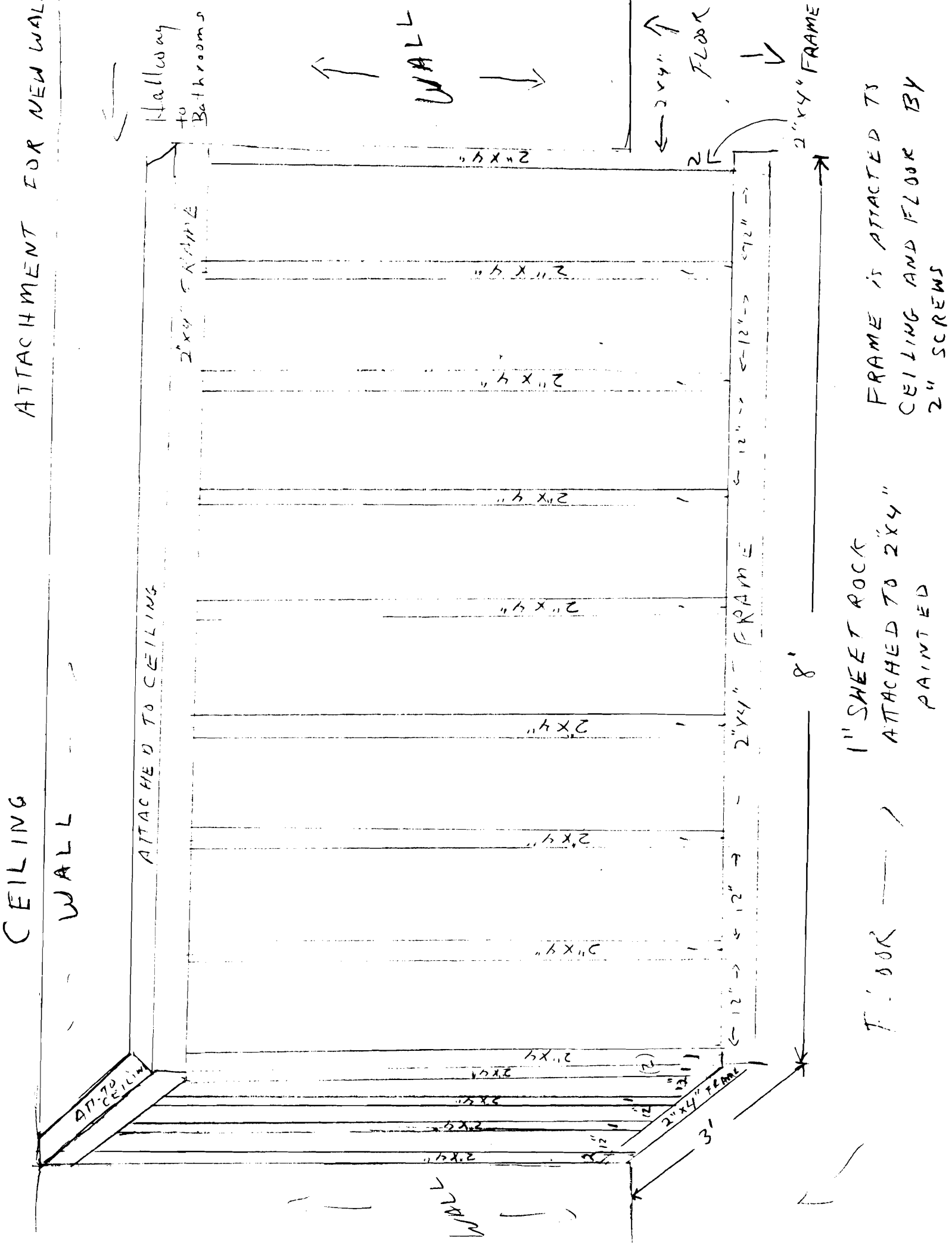

ATTACHMENT FOR NEW WALL

2"x4" FRAME

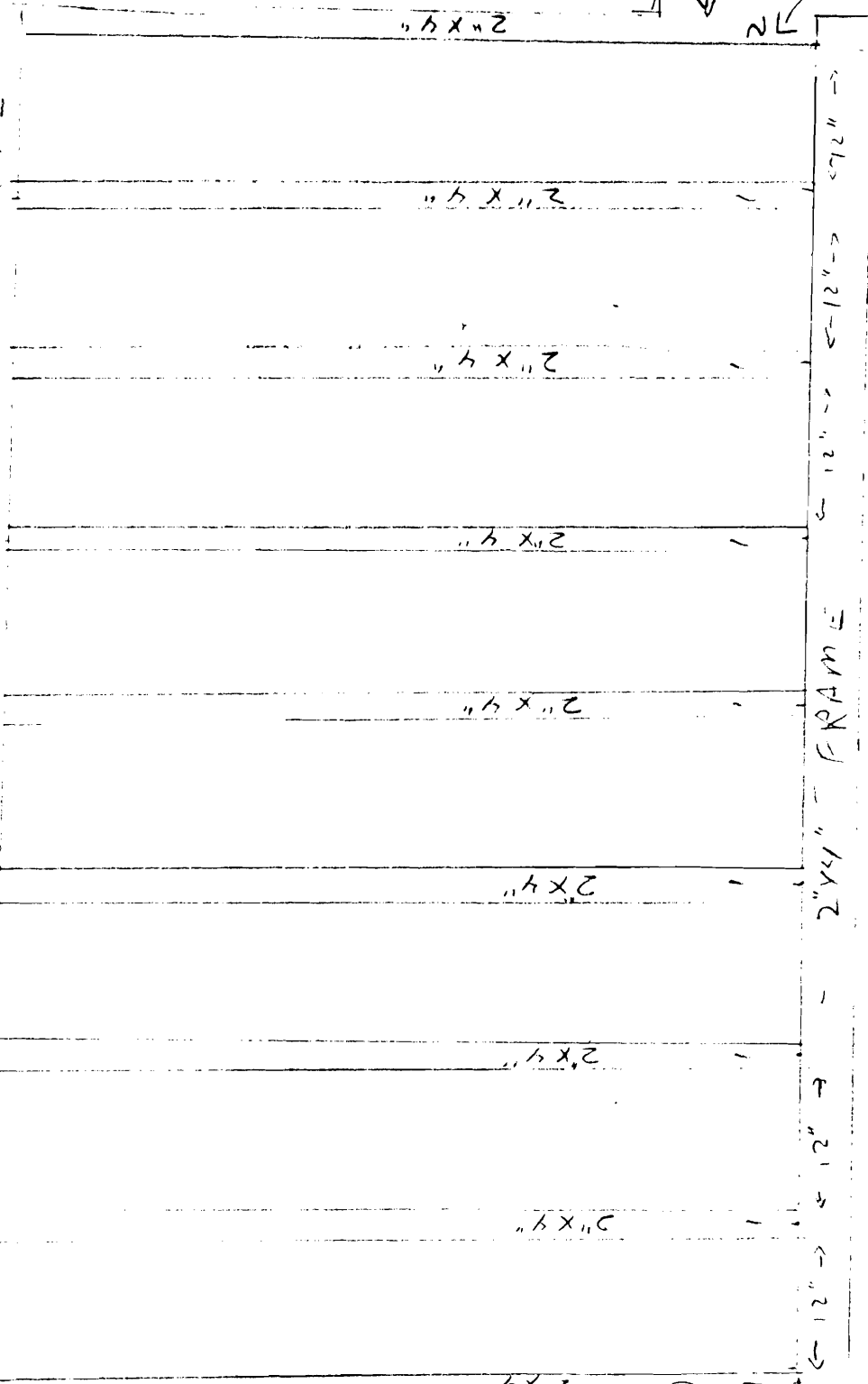

2"x4" FRAME

8'

FLOOR

2"x4" FLOOR

3'

WALL

249 ST JOHN ST - PORTLAND, ME

- CHAIRS ● — 40
- TABLES □ — 10

1/4" = 1' FLOOR PLAN - CUSTOMER ACCESS AREA
 APPROX. 650 SF.

