

# DISPLAY THIS CARD ON PRINCIPAL FRONTAGE OF WORK CITY OF PORTLAND

## BUILDING INSPECTION

Please Read Application And Notes, If Any, Attached

# PERMIT

Permit Number: 081163

This is to certify that UNION STATION LMT PARTNERSHIP

has permission to "Happy Nails" New signage - Nail Salon (using old sign and sign boxes from "Shokudo Teriyaki") - 50

AT 966 CONGRESS ST 064 A001001

provided that the person or persons performing or supervising the work accepting this permit shall comply with all of the provisions of the Statutes of the State and of the Ordinances of the City of Portland regulating the construction, maintenance and use of buildings and structures, and of the application on file in this department.

Apply to Public Works for street line and grade if nature of work requires such information.

Notification of inspection must be given and when permission procured before this building or part thereof is altered or closed-in. 4 HOUR NOTICE IS REQUIRED.

A certificate of occupancy must be procured by owner before this building or part thereof is occupied.

OTHER REQUIRED APPROVALS

Fire Dept. \_\_\_\_\_

Health Dept. \_\_\_\_\_

Appeal Board \_\_\_\_\_

Other \_\_\_\_\_

Department Name: CITY OF PORTLAND

PERMIT ISSUED  
SEP 17 2006

9/17/06 Chh S Q  
Director - Building & Inspection Services

**PENALTY FOR REMOVING THIS CARD**

**City of Portland, Maine - Building or Use Permit Application**

389 Congress Street, 04101 Tel: (207) 874-8703, Fax: (207) 874-8716

Permit No: 08-1163	Issue Date: 9/17/08	CBL: 064 A001001
-----------------------	------------------------	---------------------

Location of Construction: 966 CONGRESS ST	Owner Name: UNION STATION LMT PARTNE	Owner Address: 12 BROOK ST	Phone:
Business Name: Happy Nails	Contractor Name:	Contractor Address:	Phone
Lessee/Buyer's Name Thanh Nguyen	Phone: 207-239-0547	Permit Type: Signs - Permanent	Zone: B-2

Past Use: Nail Salon - See Permit# 081129	Proposed Use: Nail Salon - "Happy Nails" New signage for Nail Salon (using the old sign band & sign boxes from "Shokudo Teriyaki")	Permit Fee: \$190.00	Cost of Work: \$190.00	CEO District: 2
Proposed Project Description: "Happy Nails" New signage for Nail Salon (using the old sign band & sign boxes from "Shokudo Teriyaki") - 50sf sign (3 sections) facing St John & 4' x 6' sign facing parking lot.		FIRE DEPT: <input type="checkbox"/> Approved <input type="checkbox"/> Denied	INSPECTION: Use Group: B Sign Type: SB IBL-2003	
		Signature: 9/17/08 CM		Signature: 9/17/08 CM
PEDESTRIAN ACTIVITIES DISTRICT (P.A.D.)				
Action: <input type="checkbox"/> Approved <input type="checkbox"/> Approved w/Conditions <input type="checkbox"/> Denied				
Signature: _____ Date: _____				

Permit Taken By: Idobson	Date Applied For: 09/15/2008	<b>Zoning Approval</b>		
-----------------------------	---------------------------------	------------------------	--	--

<ol style="list-style-type: none"> <li>This permit application does not preclude the Applicant(s) from meeting applicable State and Federal Rules.</li> <li>Building permits do not include plumbing, septic or electrical work.</li> <li>Building permits are void if work is not started within six (6) months of the date of issuance. False information may invalidate a building permit and stop all work..</li> </ol>	<b>Special Zone or Reviews</b> <input type="checkbox"/> Shoreland <input type="checkbox"/> Wetland <input type="checkbox"/> Flood Zone <input type="checkbox"/> Subdivision <input type="checkbox"/> Site Plan Maj <input type="checkbox"/> Minor <input type="checkbox"/> MM <input type="checkbox"/> Date: 9/15/08 ABM	<b>Zoning Appeal</b> <input type="checkbox"/> Variance <input type="checkbox"/> Miscellaneous <input type="checkbox"/> Conditional Use <input type="checkbox"/> Interpretation <input type="checkbox"/> Approved <input type="checkbox"/> Denied Date:	<b>Historic Preservation</b> <input checked="" type="checkbox"/> Not in District or Landmark <input type="checkbox"/> Does Not Require Review <input type="checkbox"/> Requires Review <input type="checkbox"/> Approved <input type="checkbox"/> Approved w/Conditions <input type="checkbox"/> Denied Date: ABM
---	---	---	--

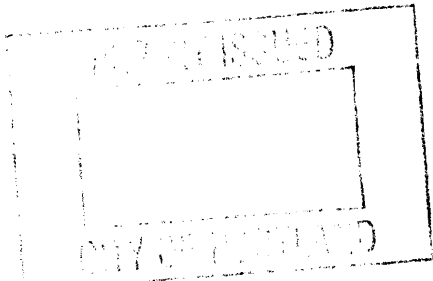

**CERTIFICATION**

I hereby certify that I am the owner of record of the named property, or that the proposed work is authorized by the owner of record and that I have been authorized by the owner to make this application as his authorized agent and I agree to conform to all applicable laws of this jurisdiction. In addition, if a permit for work described in the application is issued, I certify that the code official's authorized representative shall have the authority to enter all areas covered by such permit at any reasonable hour to enforce the provision of the code(s) applicable to such permit.

SIGNATURE OF APPLICANT	ADDRESS	DATE	PHONE
RESPONSIBLE PERSON IN CHARGE OF WORK, TITLE		DATE	PHONE

# Signage/Awning Permit Application

If you or the property owner owes real estate or personal property taxes or user charges on any property within the City, payment arrangements must be made before permits of any kind are accepted.

Location/Address of Construction: <u>966 St. John (at 294 St. John) Union Station Plaza Shopping Center</u>		
Tax Assessor's Chart, Block & Lot Chart# <u>064</u> Block# <u>A</u> Lot# <u>001</u>	Owner: <u>Union Station Lmt Pt. 12 Brook Wellisley MA 02482</u>	Telephone: <u>1781-431-7060</u>
Lessee/Buyer's Name (If Applicable): <u>TiENG C. Nguyen</u>	Contractor name, address & telephone: <u>TiENG C. NGUYEN 4 Atlantic Ave Boothbay Harbor ME 04538</u>	Total s.f. of signage x \$2.00 Per s.f. plus \$30.00/\$65.00 For H.D. signage= Total <u>8058 FF.</u> Fee: \$ _____ Awning Fee= cost of work _____ Total Fee: \$ _____ <u>19000</u>
Who should we contact when the permit is ready: <u>Thanh Nguyen</u> phone: <u>(207) 239-0547</u>		
* Tenant/allocated building space frontage (feet): Length: <u>29'</u> Height: <u>8' 10" + 6' 5"</u> Lot Frontage (feet) <u>29'</u> Single Tenant or Multi Tenant Lot <u>Single tenant</u> <u>- charge of use 05-1,129</u>		
Current Specific use: <u>Nail Salon</u> If vacant, what was prior use: <u>Japanese Restaurant</u> Proposed Use: <u>Nail Salon</u>		
Information on proposed sign(s): Freestanding (e.g., pole) sign? Yes <input type="checkbox"/> No <input checked="" type="checkbox"/> SEP 15 2008 * Bldg. wall sign? (attached to bldg) Yes <input checked="" type="checkbox"/> No <input type="checkbox"/> Dimensions proposed: _____ Height from grade: _____ ① <u>13' 4", 21' 3", 8"</u> ② <u>11', 10' 1"</u> ③ <u>9' 6", 10 1/2", 4' 1"</u>		
Proposed awning? Yes <input checked="" type="checkbox"/> No <input type="checkbox"/> Is awning backlit? Yes <input checked="" type="checkbox"/> No <input type="checkbox"/> Height of awning: _____ Length of awning: _____ Depth: _____ Is there any communication, message, trademark or symbol on it? Yes <input checked="" type="checkbox"/> No <input type="checkbox"/> If yes, total s.f. of panels w/communications, message, trademark or symbol: _____ s.f. <u>9 Letters</u> <u>10 number (phone number)</u>		
* Information on existing and previously permitted sign(s): Freestanding (e.g., pole) sign? Yes <input type="checkbox"/> No <input checked="" type="checkbox"/> Dimensions: _____ ① <u>13' 4", 21' 3", 8"</u> * Bldg. wall sign? (attached to bldg) Yes <input checked="" type="checkbox"/> No <input type="checkbox"/> Dimensions: _____ ② <u>11', 10' 1"</u> Awning? Yes <input type="checkbox"/> No <input checked="" type="checkbox"/> Sq. ft. area of awning w/communication: _____ ③ <u>9' 6", 10 1/2", 4' 1"</u> <del>There are 3 awning, please look at the sign!</del>		
A site sketch and building sketch showing exactly where existing and new signage is located must be provided. Sketches and/or pictures of proposed signage and existing building are also required.		

**Please submit all of the information outlined in the Sign/Awning Application Checklist. Failure to do so may result in the automatic denial of your permit.**

In order to be sure the City fully understands the full scope of the project, the Planning and Development Department may request additional information prior to the issuance of a permit. For further information visit us on-line at [www.portlandmaine.gov](http://www.portlandmaine.gov), stop by the Building Inspections office, room 315 City Hall or call 874-8703.

I hereby certify that I am the Owner of record of the named property, or that the owner of record authorizes the proposed work and that I have been authorized by the owner to make this application as his/her authorized agent. I agree to conform to all applicable laws of this jurisdiction. In addition, if a permit for work described in this application is issued, I certify that the Code Official's authorized representative shall have the authority to enter all areas covered by this permit at any reasonable hour to enforce the provisions of the codes applicable to this permit.

Signature of applicant: [Signature] Date: Sep 15, 2008

This is not a permit; you may not commence ANY work until the permit is issued.

**City of Portland, Maine - Building or Use Permit**

389 Congress Street, 04101 Tel: (207) 874-8703, Fax: (207) 874-8716

<b>Permit No:</b> 08-1163	<b>Date Applied For:</b> 09/15/2008	<b>CBL:</b> 064 A001001
------------------------------	--	----------------------------

<b>Location of Construction:</b> 966 CONGRESS ST	<b>Owner Name:</b> UNION STATION LMT PARTNE	<b>Owner Address:</b> 12 BROOK ST	<b>Phone:</b>
<b>Business Name:</b> Happy Nails	<b>Contractor Name:</b>	<b>Contractor Address:</b>	<b>Phone:</b>
<b>Lessee/Buyer's Name:</b> Thanh Nguyen	<b>Phone:</b> 207-239-0547	<b>Permit Type:</b> Signs - Permanent	

<b>Proposed Use:</b> Nail Salon - "Happy Nails" New signage for Nail Salon (using the old sign band & sign boxes from "Shokudo Teriyaki")	<b>Proposed Project Description:</b> "Happy Nails" New signage for Nail Salon (using the old sign band & sign boxes from "Shokudo Teriyaki") - 50sf sign (3 sections) facing St John & 4' x 6' sign facing parking lot.
--	--

<b>Dept:</b> Zoning	<b>Status:</b> Approved	<b>Reviewer:</b> Ann Machado	<b>Approval Date:</b> 09/15/2008
<b>Note:</b> Replacing signage from "Shokudo Teriyaki" using the same sign band and sign boxes (Permit #06-1816)			<b>Ok to Issue:</b> <input checked="" type="checkbox"/>
<b>Dept:</b> Building	<b>Status:</b> Approved with Conditions	<b>Reviewer:</b> Chris Hanson	<b>Approval Date:</b> 09/17/2008
<b>Note:</b>			<b>Ok to Issue:</b> <input checked="" type="checkbox"/>
1) Signage Installation to comply with Chapter 31 of the IBC 2003 building code.			

**BUILDING PERMIT INSPECTION PROCEDURES**

**Please call 874-8703 or 874-8693 (ONLY )**

**to schedule your inspections as agreed upon**

**Permits expire in 6 months, if the project is not started or ceases for 6 months.**

The Owner or their designee is required to notify the inspections office for the following inspections and provide adequate notice. Notice must be called in 48-72 hours in advance in order to schedule an inspection:

**By initializing at each inspection time, you are agreeing that you understand the inspection procedure and additional fees from a "Stop Work Order" and "Stop Work Order Release" will be incurred if the procedure is not followed as stated below.**

**A Pre-construction Meeting will take place upon receipt of your building permit.**

  X   **Final inspection required at completion of work.**

Certificate of Occupancy is not required for certain projects. Your inspector can advise you if your project requires a Certificate of Occupancy. All projects DO require a final inspection.

**If any of the inspections do not occur, the project cannot go on to the next phase, REGARDLESS OF THE NOTICE OR CIRCUMSTANCES.**

**CERIFICATE OF OCCUPANICES MUST BE ISSUED AND PAID FOR, BEFORE THE SPACE MAY BE OCCUPIED.**

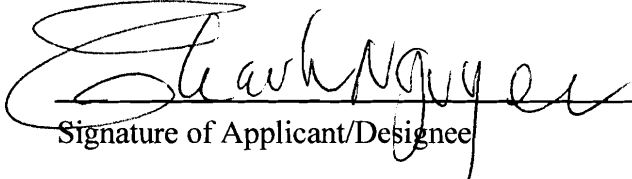
  
\_\_\_\_\_  
Signature of Applicant/Designee

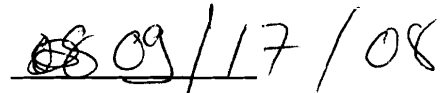
  
\_\_\_\_\_  
Date

\_\_\_\_\_  
Signature of Inspections Official

\_\_\_\_\_  
Date

St. John St

\* Considered one sign for zoning

Parking Lot

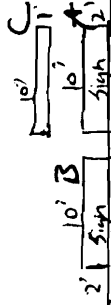

24' 39' (off plan)

Staircase  
Circulation

Nail Salon (off plan)

Subway  
Restaurant

above Entrance

not permitted. performed under section 14-368.5(5)

(Congress St

Parking Lot

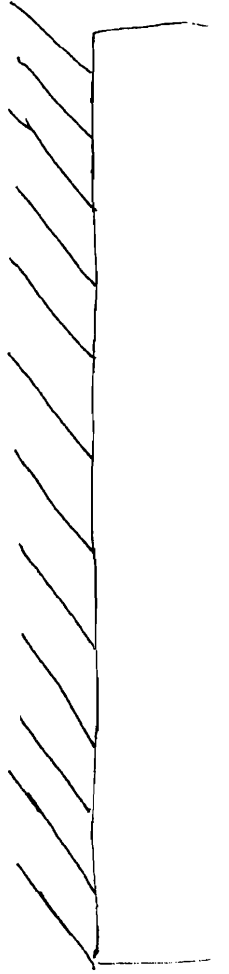

Front

Subway →

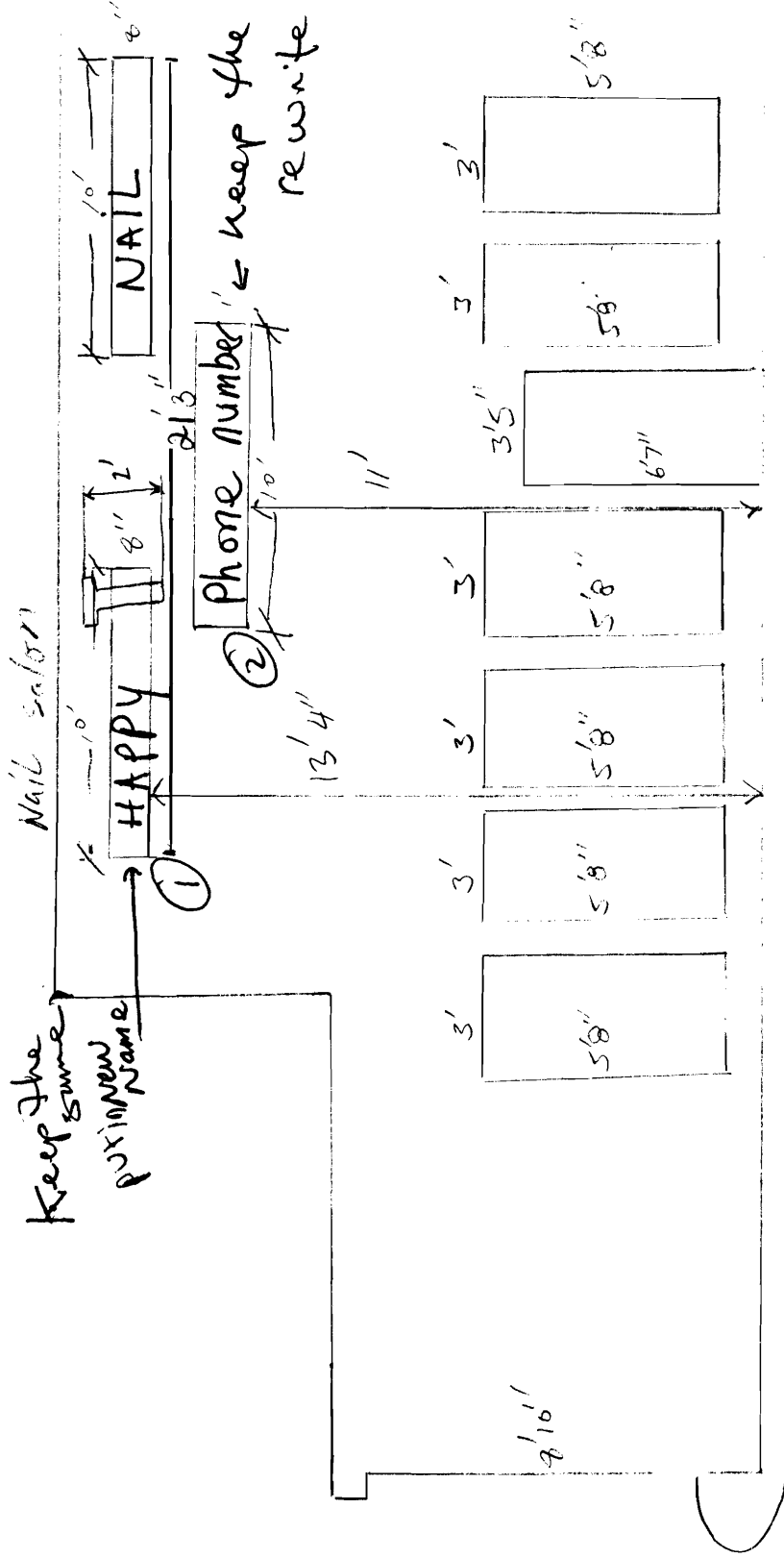

Keep the same prox name

①  
②  
Phone Number ← keep the same box  
rewrite phone number

13' drive thru

55055  
grass  
trees

wood

REAR

Nail Salon

Subway

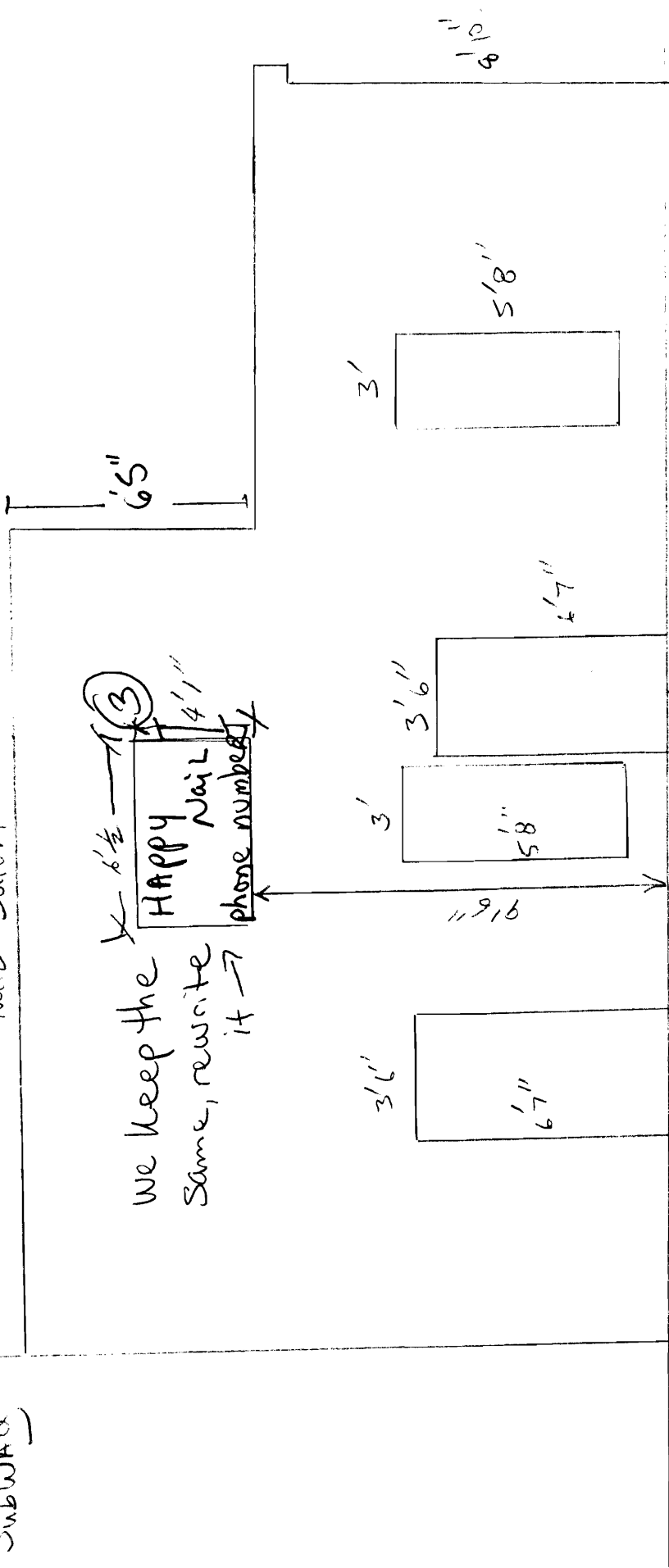

③  
 HAPPY Nail 4'1"  
 phone number

We keep the  
 same, rewrite  
 it ->

WALKWAY

Door

Door

Parking lots

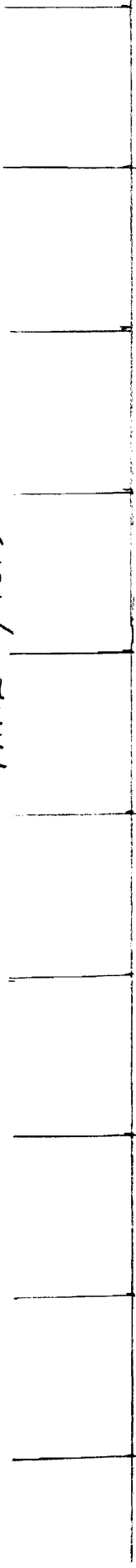



FRONT

Replace  
phone number

replace  
Nail

Replace  
HAPPY



Re place  
Happy Nail  
and phone number



Rear