

PORC CITY

DESIGN

43 DEERING STREE
 PORTLAND, ME 04110
 PHONE: 207.761.9501
 FAX: 207.761.9591
 design@portcitydesign.me

© COPYRIGHT
 Reuse or reproduction of the contents o
 this document is not permitted without
 written permission of PORC CITY DESIGN

FOR CONSTRUCTION

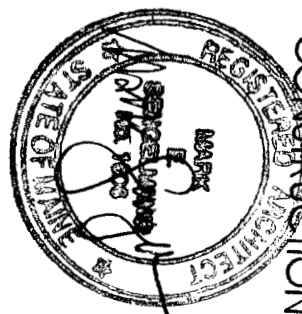

hall
 +014

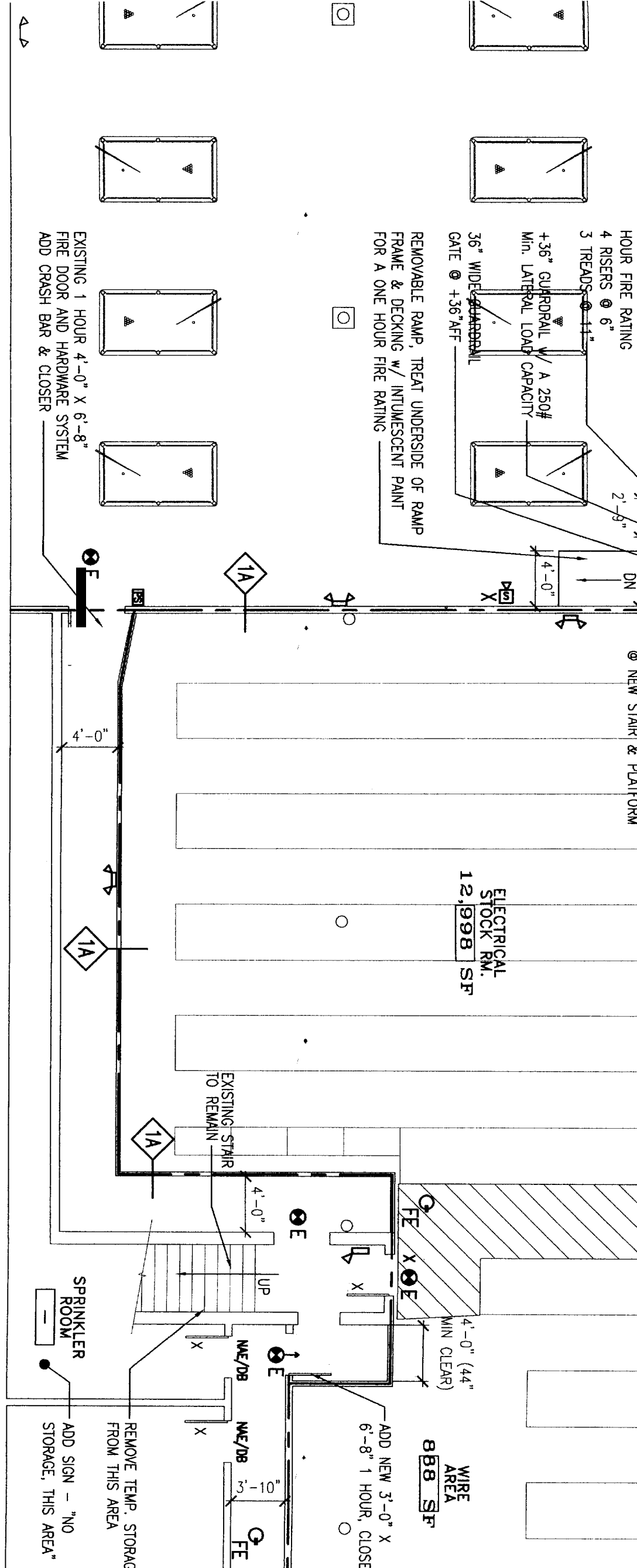

MENT PLAN
 : 1/8" = 1'-0"

01/12/06

Renovation
The Station
 274 St. Joh
 Portland, Ore

JOB: 05210

ISSUE DATE	
PRELIM.	12/26/05
SFMO Notes:	01/10/06
CD's	-
REV. 1	-
REV. 2	-
PRINT	01/12/06

BASEMENT
 FLOOR
 PLAN

A-0

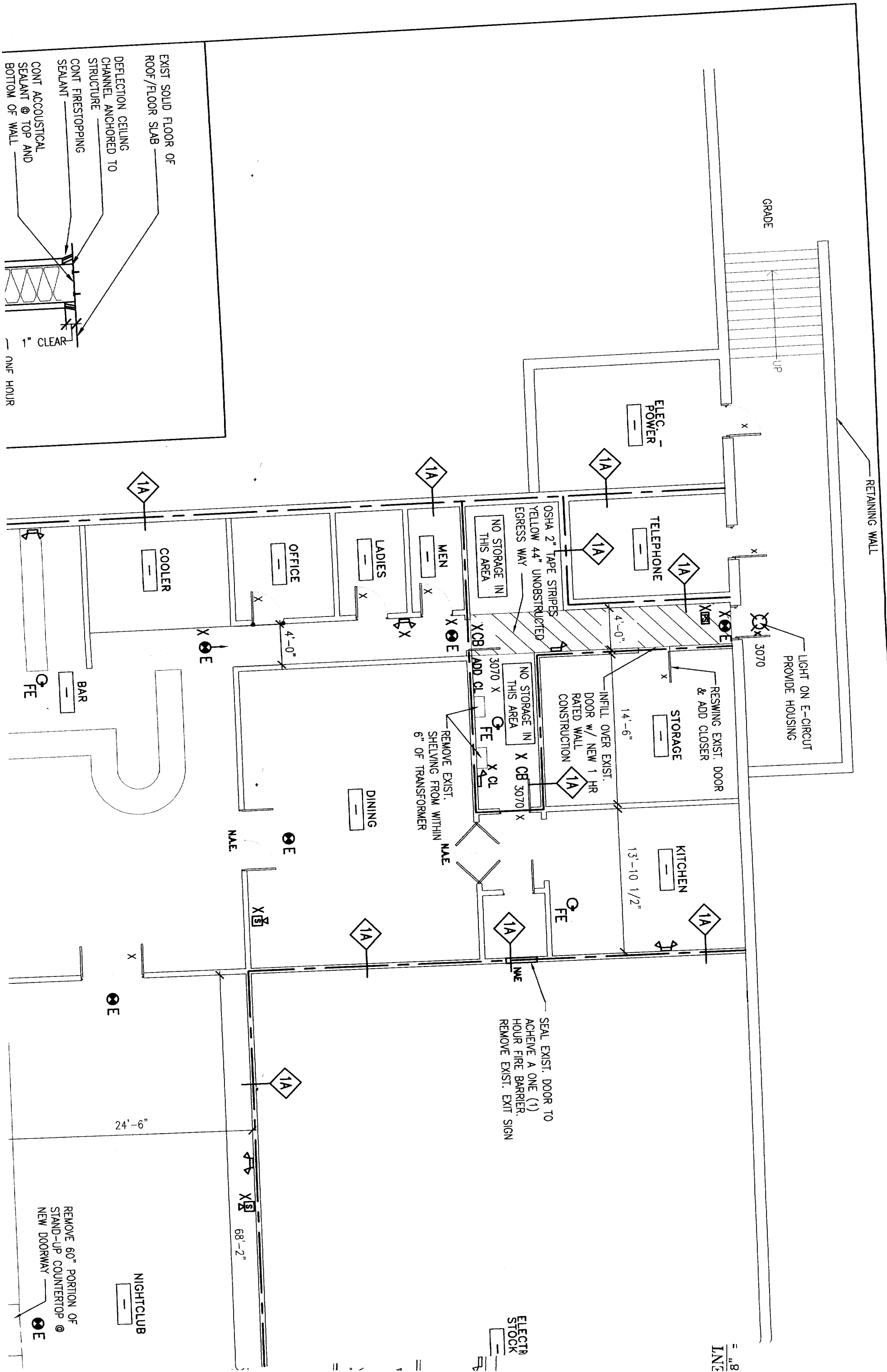

GRADE

UP

RETAINING WALL

LIGHT ON E-CIRCUIT
PROVIDE HOUSING

3070

ELEC. POWER

TELEPHONE

OSHA 2" TAPE STRIPES
YELLOW 44" UNOBSTRUCTED
EGRESS WAY
NO STORAGE IN
THIS AREA

RESWING EXIST. DOOR
& ADD CLOSER

STORAGE

INFILL OVER EXIST.
DOOR w/ NEW 1 HR
RATED WALL
CONSTRUCTION

NO STORAGE IN
THIS AREA

REMOVE EXIST.
SHELVING FROM WITHIN
6" OF TRANSFORMER

KITCHEN

DINING

OFFICE

LADIES

MEN

COOLER

BAR

NIGHTCLUB

REMOVE 60" PORTION OF
STAND-UP COUNTERTOP @
NEW DOORWAY

EXIST SOLID FLOOR OF
ROOF/FLOOR SLAB
DEFLECTION CEILING
CHANNEL ANCHORED TO
STRUCTURE
CONT FIRESTOPPING
SEALANT
CONT ACCOUSTICAL
SEALANT @ TOP AND
BOTTOM OF WALL
1" CLEAR
1NF HOUR

1/8" = 1' NE

ELECTR STOCK

68'-2"

24'-6"

NAE

NAE

SEAL EXIST. DOOR TO
ACHIEVE A ONE (1)
HOUR FIRE BARRIER.
REMOVE EXIST. EXIT SIGN

E

E

FE

FE

FE

E

FE

1A

1A

1A

1A

1A

1A

1A

1A

1A

1A

1A

E

E

UNO: _____













3 5/8" METAL STUD-FULL HGT
ONE HOUR RATED

1A

6" METAL STUD-FULL HGT
ONE HOUR RATED

1B

FIRE PROTECTION LEGEND

-  FE FIRE EXTINGUISHER
-  E EXIT LIGHT
-  STROBE ONLY WITH CANDELLA RATING AS NOTED
-  HORN STROBE WITH CANDELLA RATING AS NOTED
-  DUAL EMERGENCY LIGHT
-  SINGLE EMERGENCY LIGHT
-  S SMOKE DETECTOR (CEILING)
-  H HEAT DETECTOR (CEILING)
-  FIRE ALARM MASTER CONTROL PANEL
-  PULL STATION
-  O+ EXTERIOR EGRESS LIGHT
-  NAE 'NOT AN EXIT' SIGN W/ RAISED BRAILLE
-  VAP VAN ACCESSIBLE

NOTE:
STROBE DEVICE TO HAVE COMMUNICATION RATING MEETING NFPA 72 TABLE 6-4.4.1.1(o), MOUNT AT +80" A.F.F. INCLUDE W/ VOICE EVACUATION SYSTEM.

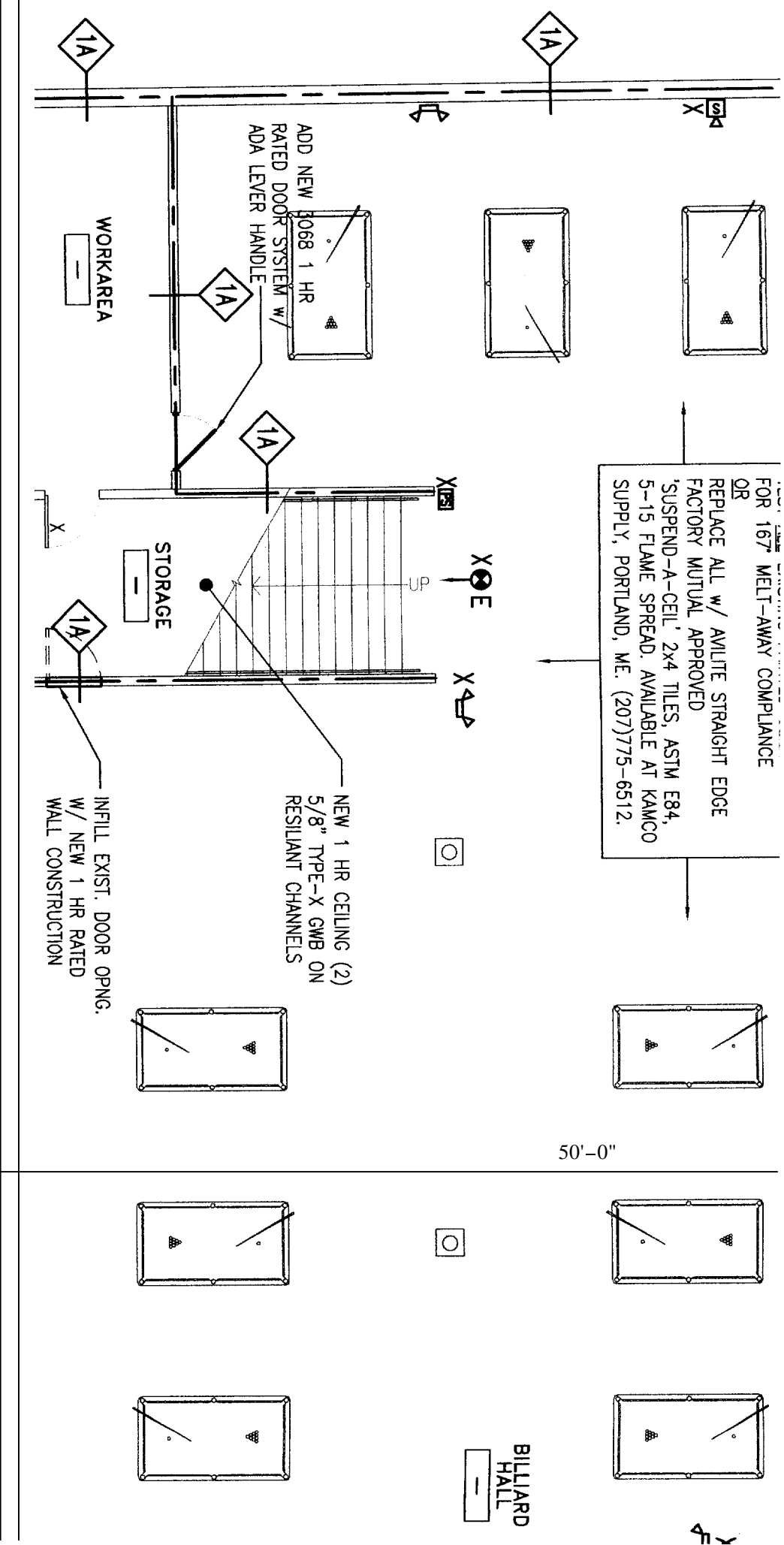

FOR 167' MELL-AWAY COMPLIANCE
OR
REPLACE ALL W/ ANLITE STRAIGHT EDGE
FACTORY MUTUAL APPROVED
'SUSPEND-A-CELL' 2x4 TILES, ASTM E84,
5-15 FLAME SPREAD. AVAILABLE AT KAMCO
SUPPLY, PORTLAND, ME. (207)775-6512.

NEW 1 HR CEILING (2)
5/8" TYPE-X GWB ON
RESILIENT CHANNELS

INFILL EXIST. DOOR OPNG.
W/ NEW 1 HR RATED
WALL CONSTRUCTION

50'-0"

BILLIARD HALL