

| | | | | | | | |
|---|--|--|--|---|--|---|--|
| Location of Construction: 146 Neal Street | | Owner: Carl Lakari | | Phone: 646-8615 | | Permit No: | |
| Owner Address: RR 1, Box 879, Wells, ME 04090 | | Leasee/Buyer's Name: Project for Supported Living | | Phone: 879-0847 | | BusinessName: | |
| Contractor Name: Stephanie Fairchild ✓ | | Address: | | Phone: | | Permit Issued: | |
| Past Use: Apartment house | | Proposed Use: apartment house with 6 x 8 shed | | COST OF WORK: \$175.00 | | PERMIT FEE: \$25.00 | |
| | | | | FIRE DEPT. <input type="checkbox"/> Approved <input type="checkbox"/> Denied | | INSPECTION: Use Group: Type: | |
| Proposed Project Description: erect a 6 x 8 shed | | | | Signature: | | Signature: | |
| | | | | PEDESTRIAN ACTIVITIES DISTRICT (P.U.D.) | | Zoning Approval: | |
| | | | | Action: <input type="checkbox"/> Approved <input type="checkbox"/> Approved with Conditions <input type="checkbox"/> Denied | | Special Zone or Reviews: <input type="checkbox"/> Shoreland <input type="checkbox"/> Wetland <input type="checkbox"/> Flood Zone <input type="checkbox"/> Subdivision <input type="checkbox"/> Site Plan maj <input type="checkbox"/> minor <input type="checkbox"/> mm <input type="checkbox"/> | |
| Permit Taken By: Victoria A. Dover | | Date Applied For: December 5, 1995 | | | | Zoning Appeal: <input type="checkbox"/> Variance <input type="checkbox"/> Miscellaneous <input type="checkbox"/> Conditional Use <input type="checkbox"/> Interpretation <input type="checkbox"/> Approved <input type="checkbox"/> Denied | |

Zone: R-6 CBL: 63-I-7

1. This permit application doesn't preclude the Applicant(s) from meeting applicable State and Federal rules.
2. Building permits do not include plumbing, septic or electrical work.
3. Building permits are void if work is not started within six (6) months of the date of issuance. False information may invalidate a building permit and stop all work..

*Never Issued - Put to file
9-9-96*

CERTIFICATION

I hereby certify that I am the owner of record of the named property, or that the proposed work is authorized by the owner of record and that I have been authorized by the owner to make this application as his authorized agent and I agree to conform to all applicable laws of this jurisdiction. In addition, if a permit for work described in the application issued, I certify that the code official's authorized representative shall have the authority to enter all areas covered by such permit at any reasonable hour to enforce the provisions of the code(s) applicable to such permit

| | | | | | | | |
|--|--|---------------------------------------|--|------------------|--|--------------------|--|
| SIGNATURE OF APPLICANT: Stephanie Fairchild Carl Lakari | | ADDRESS: 146 Neal St, Portland, ME | | DATE: 12/5/95 | | PHONE: 879-0847 | |
| RESPONSIBLE PERSON IN CHARGE OF WORK, TITLE | | | | | | PHONE: | |

Historic Preservation
 Not in District or Landmark
 Does Not Require Review
 Requires Review

Action:
 Approved
 Approved with Conditions
 Denied

Date: _____

CEO DISTRICT #3.
A Simpson

Never Issued

1" = 20'

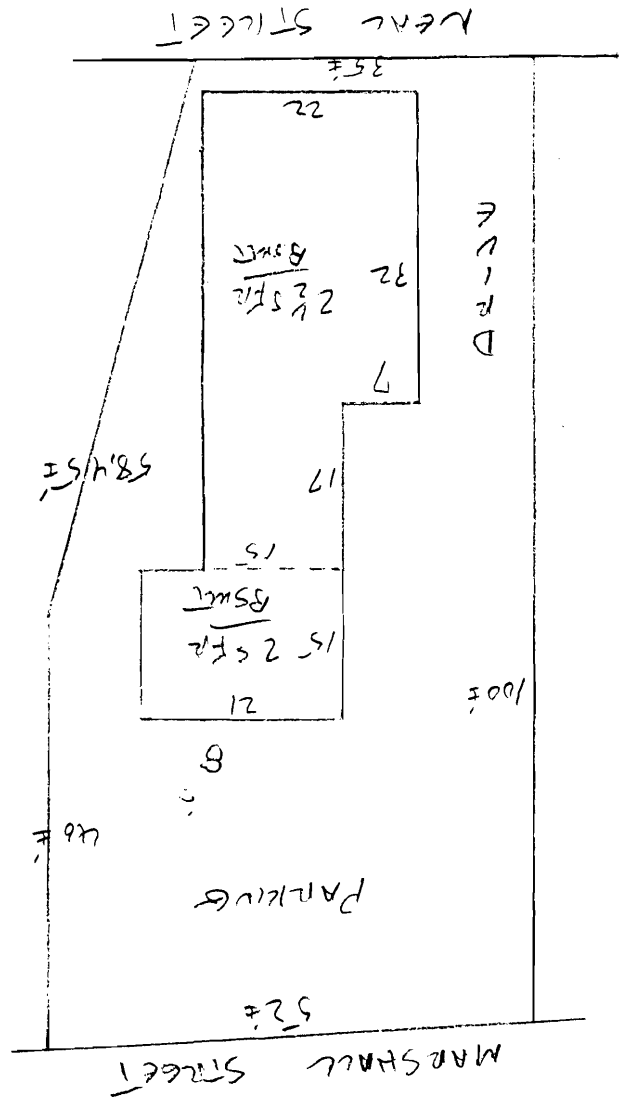

146 NE 0110 ST.

PLOT PLAN

STANIE FRANCHISE
Project for supported living
74 Elm St
PTA, ME 0410

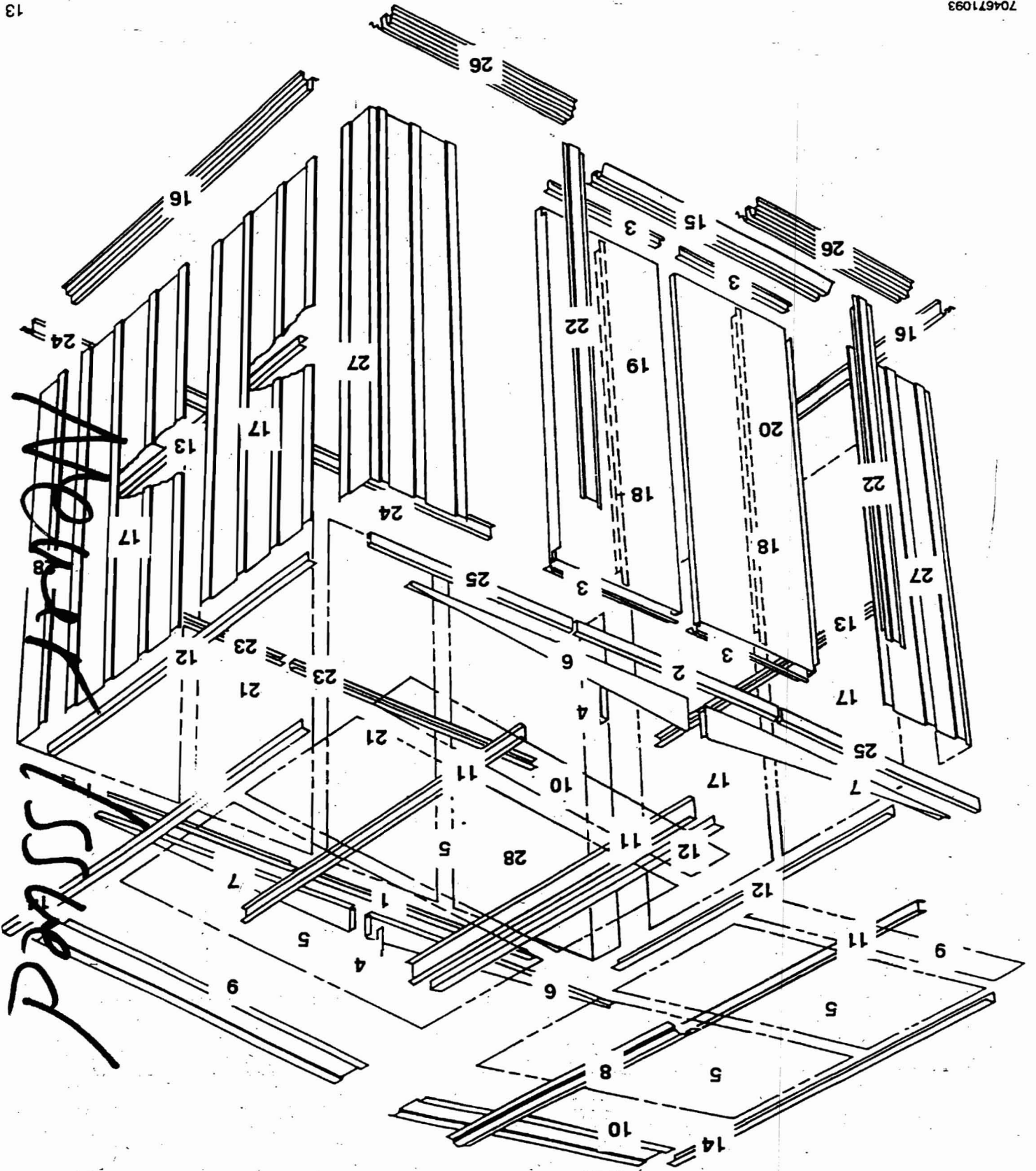

Not Issued

Assembly by Key No.

146 Neal St

Owner's Manual & Assembly Instructions

Model No. EN86 HM86 MN86
 NW86 SA86 VN86
 697.68537

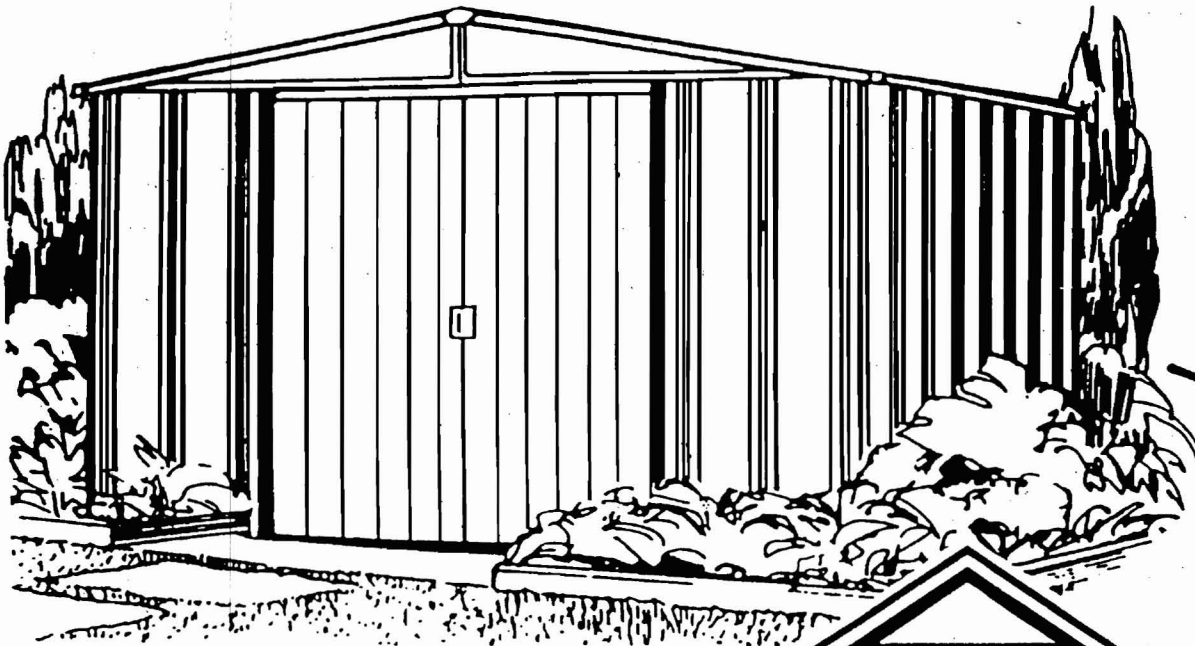

Never Issued

704670794

BUILDING DIMENSIONS *Size rounded off to the nearest foot



CAUTION: SOME PARTS HAVE SHARP EDGES. CARE MUST BE TAKEN WHEN HANDLING THE VARIOUS PIECES TO AVOID A MISHAP. FOR SAFETY SAKE; PLEASE READ SAFETY INFORMATION PROVIDED IN THIS MANUAL BEFORE BEGINNING CONSTRUCTION. WEAR GLOVES WHEN HANDLING METAL PARTS.

| * Approx. Size | Foundation Size | Storage Area Sq. Ft. Cu. Ft. | | Exterior Dimensions (Roof Edge to Roof Edge) | | | Interior Dimensions (Wall to Wall) | | |
|----------------|-------------------|---------------------------------|-----|---|---------|---------|---------------------------------------|-------|---------|
| | | | | Width | Depth | Height | Width | Depth | Height |
| 8' x 6' | 97 1/2" x 68 3/4" | 43 | 230 | 99 3/4" | 71 1/4" | 67 7/8" | 94 3/4" | 66" | 66 5/8" |