

SITE



DEPT. OF BUILDING INSPECTION
CITY OF PORTLAND, ME
NOV - 9 2005
RECEIVED
187 Via Weston

FOR MORTGAGE LENDER USE ONLY

GENERAL NOTES: (1) DISTANCES SHOWN ARE TAKEN FROM PROVIDED TITLE REFERENCES SHOWN BELOW. (2) THE PURPOSE OF THIS INSPECTION IS TO RENDER AN OPINION AS FOLLOWS: A) DWELLING AND ACCESSORY STRUCTURE'S COMPLIANCE WITH RESPECT TO MUNICIPAL SETBACKS, AND B) FLOOD ZONE DETERMINATION BY SHADY SIDE SETBACKS ON BASIS REFERENCED FROM MAP. (3) THIS INSPECTION EXCEPTS OUT ALL TECHNICAL STANDARDS CURRENTLY SET FORTH BY STATE OF MAINE BOARD OF LICENSED PROFESSIONAL LAND SURVEYORS. (4) THIS INSPECTION IS TO BE USED ONLY BY THE BELOW LISTED LENDER, TITLE ATTORNEY & TITLE INSURER AND IS NOT TO BE USED BY ANOTHER PARTY FOR BOUNDARY LINE LOCATIONS OR LAND TITLE OPINIONS. (5) A BOUNDARY SURVEY SHOULD BE PERFORMED TO RENDER A PROFESSIONAL OPINION PERTAINING TO BOUNDARY LINE LOCATIONS, EASEMENTS, RIGHTS OF WAY, ENCUMBRANCES, AND/OR ENCROACHMENTS.

THIS SKETCH IS NOT TO BE USED FOR CONSTRUCTION PURPOSES

ADDRESS: 187 VAUGHAN STREET INSPECTION DATE: APRIL 14, 2005
PORTLAND MAINE SCALE: 1" = 20'

187 VAUGHAN ST.

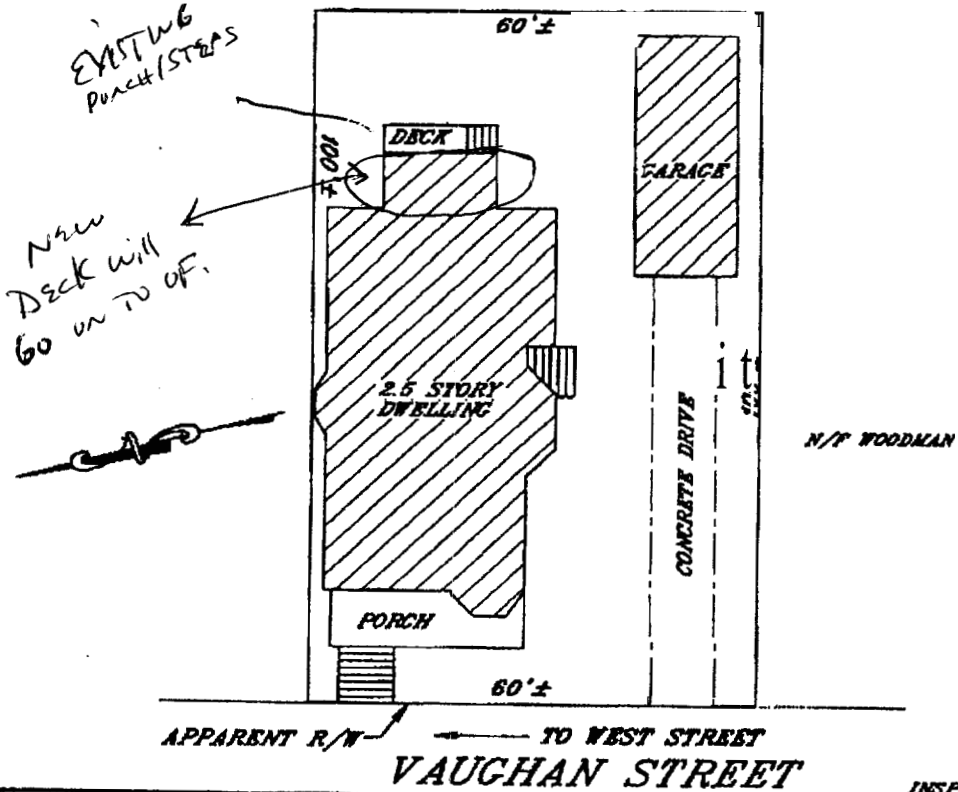

DEPT. OF BUILDING INSPECTION
 CITY OF PORTLAND, ME
 NOV - 0 2005
 RECEIVED

SEE PROVIDED TITLE REFERENCES FOR APPLICABLE APPURTENANCES, IF ANY. INSP. BY SBH

APPLICANT: _____ REQ. PARTY: NORMAN, HANSON & DETROY
 OWNER: TRUSTEE OF THE ESTATE OF ELIZABETH G. MURPHY & ESTATE OF THOMAS J. MURPHY ATTORNEY: _____
 LENDER: _____ FILE No. 20512559 FIELD BOOK: _____

TITLE REFERENCES:
 DEED BOOK 22064 PAGE: 50
 PLAN BOOK: _____ PAGE: _____ LOT: _____
 COUNTY: CUMBERLAND

MUNICIPAL REFERENCE:
 MAP: 63 BLOCK: G LOT: 7

THE DWELLING DOES NOT FALL WITHIN A SPECIAL FLOOD HAZARD ZONE PER FEMA COMMUNITY MAP No. 230051 PANEL: 0052E ZONE: C DATE: DECEMBER 9, 1998
 THE DWELLING WAS ~~IN~~ IN COMPLIANCE WITH MUNICIPAL SETBACK REQUIREMENTS AT THE TIME OF CONSTRUCTION.

COMMENTS:

YOUR FILE #:
NADEAU & LODGE, INC.
 PROFESSIONAL LAND SURVEYORS
 510 BURNETT AVENUE PORTLAND, ME 04108 (207) 878-7878
 324 CLARET WOODS ROAD LYRAN, ME 04963 (207) 483-2359

[Signature]
 4-15-5

THIS INSPECTION IS VALID ONLY WITH AN EMBOSSED SEAL AND IS NULL & VOID 90 DAYS AFTER INSPECTION DATE.
 - NOT FOR RECORDING

THIS IS NOT A BOUNDARY SURVEY.

187 Vaughan

187 VAUGHAN ST. - NEAR OF BUILDING - TOP
NEW DECK TO BE BUILT ON OF
EXISTING 2 STORY STRUCTURE
BRICK

NO STAIRS



DEPT. OF BUILDING INSPECTION
CITY OF PORTLAND, ME
NOV - 9 - 2005
RECEIVED

187 Vaughan