

UNITED STATES OF AMERICA  
 ADMINISTRATOR OF GENERAL SERVICES  
 DB 3121 PG 663  
 PB 82 PG 35  
 TM 42 BL C TL 1

N/F  
 HOBSON'S PIER, INC.  
 DB 10799 PG 135  
 PB 193 PG 164  
 TM 42 BL D TL 2

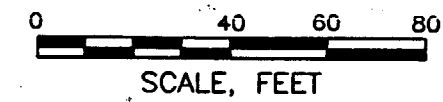

DRAWING ENTITLED "ALTA/ACSM LAND TITLE SURVEY TAX  
 CITY OF PORTLAND CUMBERLAND COUNTY STATE  
 CONSULTANTS, INC. OF WESTBROOK, MAINE, DATED

SURVEYED BY SURVEY & GEODETIC CONSULTANTS, INC.

EXAMINED BY R. W. GILLESPIE & ASSOCIATES, INC. BY

AS SHOWN ON A DRAWING ENTITLED "NAVAL RESERVE  
 " PREPARED BY WILLIAM T. MATHIS & ASSOCIATES  
 FLORIDA, REVISION 1 DATED 09 SEPTEMBER 1972 ISSUED  
 CONSTRUCTION OF GREAT NECK, NEW YORK.

TESTS AND PROBES WERE MONITORED BY R. W. GILLESPIE

FIGURE 2  
 EXPLORATION LOCATION PLAN  
 GULF OF MAINE RESEARCH INSTITUTE  
 PORTLAND, MAINE

JUNE 2003

PROJECT NO. 235-741



**R.W. Gillespie & Associates, Inc.**  
 CONSULTING GEOTECHNICAL & ENVIRONMENTAL SPECIALISTS

86 Industrial Park Rd., Suite 4 Saco, Maine 04072 (207) 286-8008  
 Fax: (207) 286-2882 E-mail: rwg-a@cybertours.com

IRON PIPE	SS	SANITARY SEWER MANHOLE	SS	UNDERGROUND SANITARY SEWER LINE	R/W	RIGHT-OF-WAY
REBAR	ST	STORM DRAIN INLET - ROUND	ST	UNDERGROUND STORM DRAIN LINE	B/C	BACK OF CURB
UTILITY POLE w/GUY WIRE	W	STORM DRAIN INLET - SQUARE	W	UNDERGROUND WATER LINE	FFE	FINISHED FLOOR ELEVATION
BORING LOCATION w/GND ELEV	EL	FIRE HYDRANT	EL	UNDERGROUND ELECTRIC LINE	RCP	REINFORCED CONCRETE PIPE
DOUBLE POST SIGN	TEL	WATER VALVE	TEL	UNDERGROUND TELEPHONE LINE	PVC	POLYETHYLENE CHLORIDE PIPE
SHRUB	CIV	BACK FLOW PREVENTER	CIV	UNDERGROUND CABLE TELEVISION LINE	TM	TAX MAP
TREE STUMP	GAS	ELECTRIC MANHOLE	GAS	UNDERGROUND NATURAL GAS LINE	BL	BLOCK
LIGHT POLE	UHW	TELEPHONE MANHOLE	UHW	OVERHEAD WIRES	TL	TAX LOT
ELECTRIC TRANSFORMER	IP	TELEPHONE PEDESTAL	IP	6' HIGH CHAIN LINK FENCE	DB	DEED BOOK
FLAG POLE	CP	CABLE PEDESTAL	CP	"W-BEAM" GUARD RAIL	PB	PLAN BOOK
RIP RAP	Gv	GAS VALVE	Gv	APPROXIMATE WATER LINE	PG	PAGE

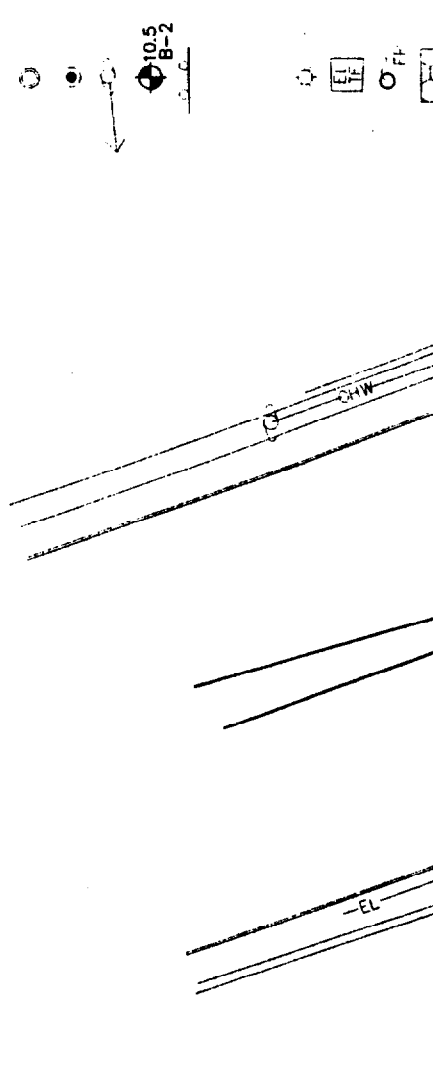

N/F  
 THE STATE OF MAINE  
 DB 4759 PG 119  
 PG 192 PG 32  
 TM 41 BL A TL 14 & 20

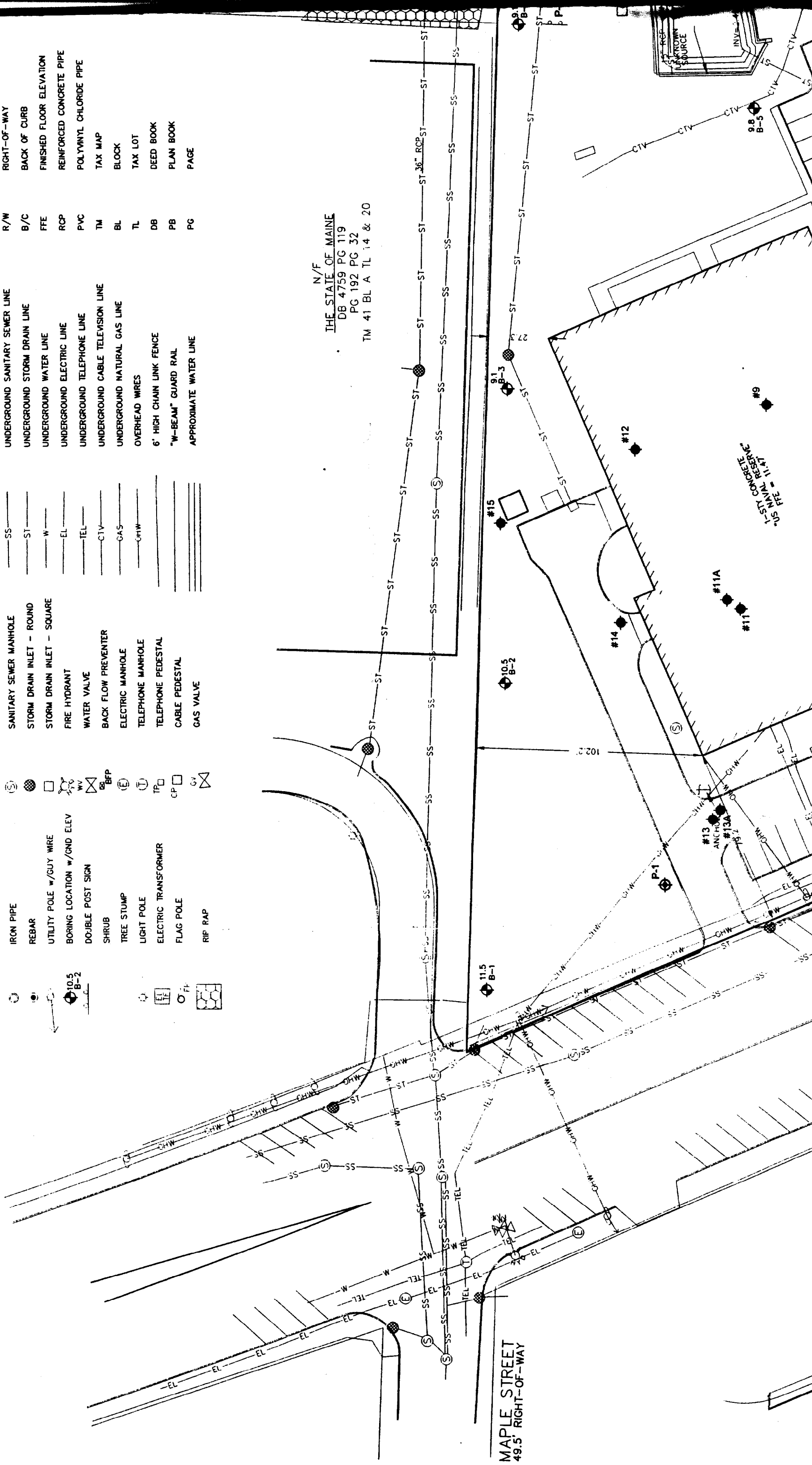

A.K.A. U.S. ROUTE 1A  
 COMMERCIAL STREET  
 VARIABLE WIDTH RIGHT-OF-WAY  
 (PER GENERAL NOTE 12)

N/F  
 CENTRAL MAINE POWER  
 DB 9157 PG 289  
 PB 193 PG 164  
 TM 42 BL D TL 1

1-STY WOOD  
 "DIVE SHOP"

**LEGEND:**

- B-11** ◆ DESIGNATION AND APPROXIMATE LOCATION OF TEST BORING DRILLED FOR THE PROPOSED GULF OF MAINE RESEARCH FACILITY GEOTECHNICAL INVESTIGATION BY GREAT WORKS PUMP & TEST BORING, INC. OF ROLLINSFORD, NEW HAMPSHIRE DURING THE PERIOD 05 TO 11 DECEMBER 2001.
- P-2** ◆ DESIGNATION AND APPROXIMATE LOCATION OF PROBE DRILLED FOR THE PROPOSED GULF OF MAINE RESEARCH FACILITY GEOTECHNICAL INVESTIGATION BY GREAT WORKS PUMP & TEST BORING, INC. OF ROLLINSFORD, NEW HAMPSHIRE DURING THE PERIOD 05 TO 11 DECEMBER 2001.
- #15** ◆ DESIGNATION AND APPROXIMATE LOCATION OF TEST BORING DRILLED FOR THE NAVAL RESERVE CENTER BY NORTHEAST SOILS SERVICES SOILS EXPLORATION OF BREWER, MAINE ON 30 DECEMBER 1969.

**NOTE:**

1. FIGURE DEVELOPED FROM PRELIMINARY MAP 42 BLOCK C LOT 1 COMMERCIAL OF MAINE" PREPARED BY SURVEY 10 DECEMBER 2001.
2. LOCATIONS OF 2001 TEST BORINGS OF WESTBROOK, MAINE.
3. LOCATIONS OF 2001 PROBES USING HAND-TAPING AND PACING METHOD.
4. LOCATIONS OF 1969 TEST BORINGS AT NAVAL RESERVE CENTER SOUTH PORTLAND, MAINE, AS-BUILT BY ARNOLD M. DIAMOND CONSULTING ENGINEERS OF JACKSONVILLE, FLORIDA.
5. DRILLING ACTIVITIES FOR 2001 BY GREAT WORKS PUMP & TEST BORING, INC. & ASSOCIATES, INC.