

# EXISTING CONDITION/SITE ANALYSIS

## WILLISTON WEST CHURCH

### PORTLAND, MAINE

CYNTHIA ORCUTT  
LANDSCAPE ARCHITECT ME #055

8/10/15

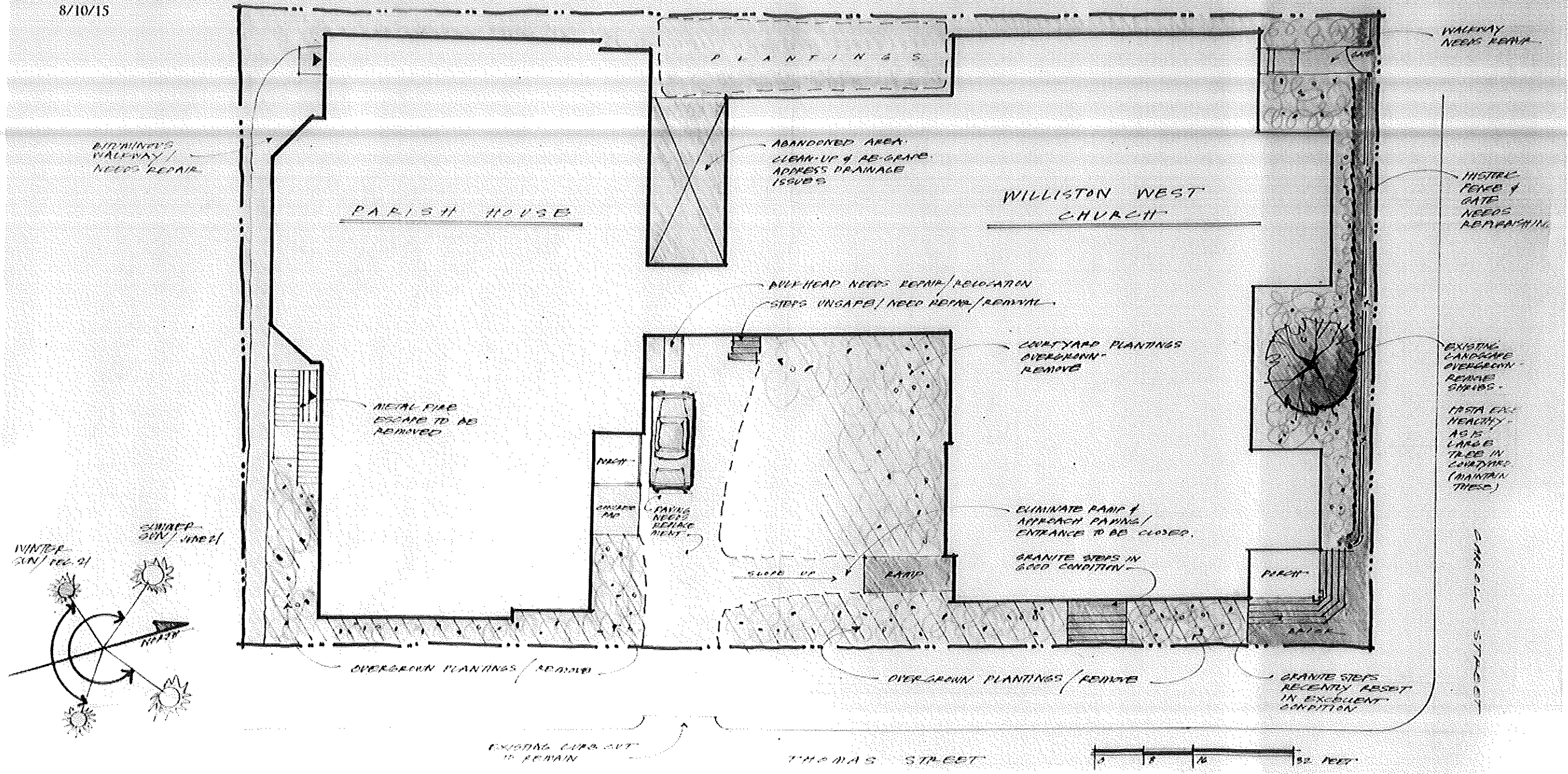

Williston West  
32 Thomas Street LLC

Existing Conditions  
Analysis  
1100