

MAX TRAVEL DISTANCE (UNIT #1) 66'-9"

10 Ground Floor Life Safety Plan

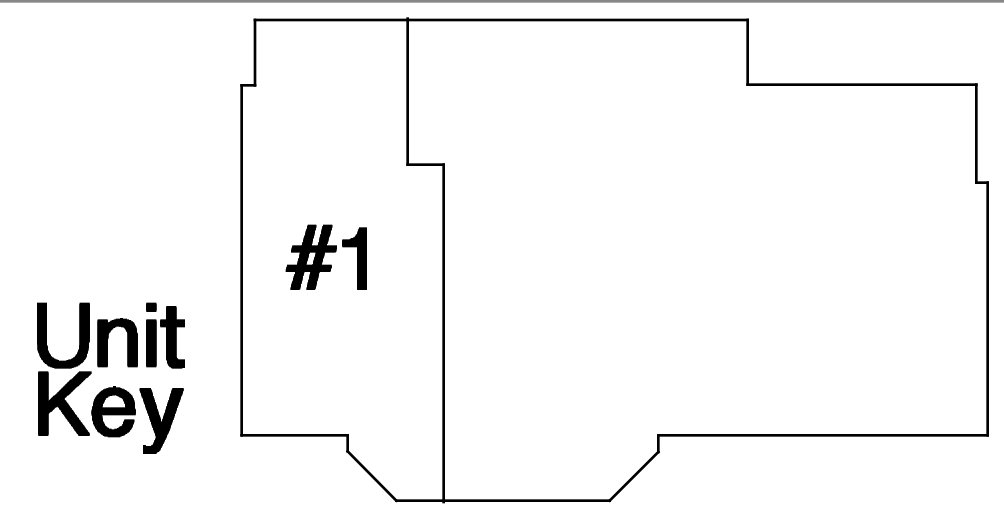

project name
32 Thomas Street Apartments

project location
32 Thomas Street
Portland Maine 04101

Revisions	date
Added EXIT Access path for Unit #1	041216

date February 22, 2016
scale 1/4" = 1'-0"
project # 2011-018
drawing title **Parish House Ground Floor Life Safety Plan**
drawing number **LS101**