

10 Second Floor Life Safety Plan

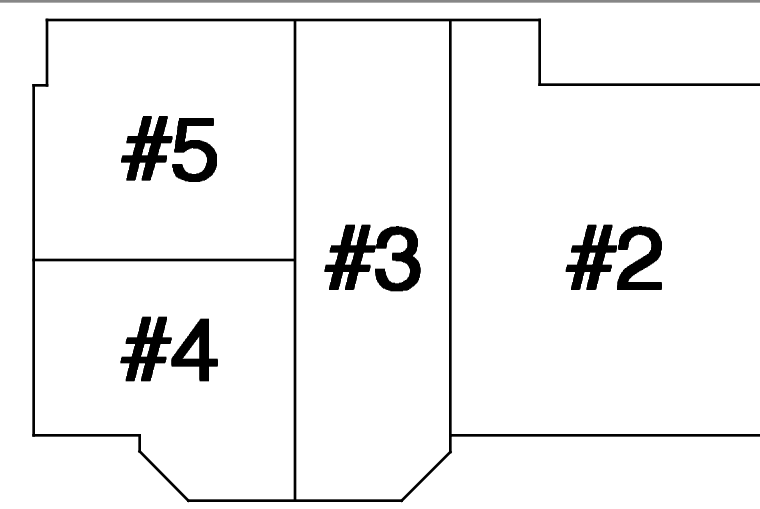

41 edgewood ave
 portland, maine 04103
 telephone 207 450 0750
 e-mail matthewwinch@earthlink.net

Unit Key



project name
32 Thomas Street Apartments
 project location
 32 Thomas Street
 Portland Maine 04101

Revisions	date

date February 22, 2016
 scale 1/4" = 1'-0"
 project # 2011-018
 drawing title **Parish House Second Floor Life Safety Plan**
 drawing number **LS102**