

604

Rating 2 HR
UL 465
STC 55
Jamb TBD

5/8" GWB - Type X
3 5/8" Mtl Stds @ 16" OC
SAB
5/8" GWB - Type X (Type X MR in Bath)

SEE DETAIL CL1, CL3 or CL4 FOR WALL CONST ABOVE CLG

603

Rating 2 HR
UL 465
STC 55
Jamb TBD

1/2" GWB - Type X
3 5/8" Mtl Stds @ 16" OC
SAB
1/2" RC-1 Res Chnl
(2) 1/2" GWB - Type X (Type X MR in Bath)

SEE DETAIL CL1, CL3 or CL4 FOR WALL CONST ABOVE CLG

602

Rating 2 HR
UL 465
STC 63
Jamb TBD

1/2" GWB - Type X
SAB
2 1/2" Mtl Stds @ 16" OC
1/2" GWB - Type X
3 5/8" Mtl Stds @ 16" OC
SAB
1/2" RC-1 Res Chnl
(2) 1/2" GWB - Type X (Type X MR in Bath)

SEE DETAIL CL1, CL3 or CL4 FOR WALL CONST ABOVE CLG

601

Rating 3HR
UL 419
STC 65
Jamb TBD

3 Layers 1/2" GWB - Type X (Type X MR in Bath)
6" Mtl Stds @ 16" OC
SAB
1/2" RC-1 Res Chnl
3 Layers 1/2" GWB - Type X

SEE DETAIL CL1, CL3 or CL4 FOR WALL CONST ABOVE CLG

103

Rating NA
UL N/A
STC 45
Jamb

Porcelain tile
1/2" Cement board
2 x 4 Studs @ 16" OC
SAB
1/2" Cement board
Porcelain tile

102

Rating NA
UL N/A
STC 45
Jamb

5/8" GWB - Type X
2 x 4 Studs @ 16" OC
SAB
1/2" Cement board
Porcelain tile

101

Rating NA
UL 305
STC 45
Jamb

5/8" GWB - Type X
2 x 4 Studs @ 16" OC
SAB
5/8" GWB - Type X

1. Partition type designations refer to the following wall construction systems:
100 Series - 2x4 Wood stud construction
600 Series - Metal stud construction
2. All GWB to be cut to fit around penetrations, pipes, ducts, conduit, cables, etc.
All penetrations shall be sealed with acoustic sealant, unless noted otherwise.
3. All partitions extending to underside of ceiling above shall fully follow the contour of struct.
4. All sound insulated partitions shall extend to the underside of structure above, UNO
5. All sound insulated partitions shall be sealed with acoustic sealant under the shoe, head, and jamb, and at all GWB joints.
6. Refer to Room Finish Schedule for wall finish and base information.

623

Partition type designation
NR (not rated), 1HR, 2HR, 3HR as applicable
Rating
UL
STC
Jamb

Partition type designation
UL design number. See Fire Rating notes this sheet.
STC design value for partition as applicable
Jamb detail reference for this partition type

Partition Notes / Legend

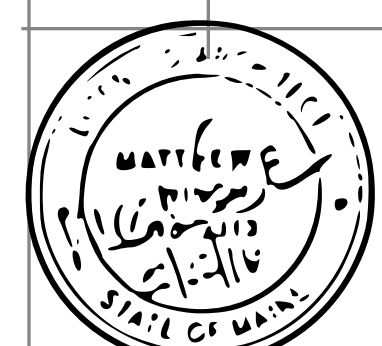
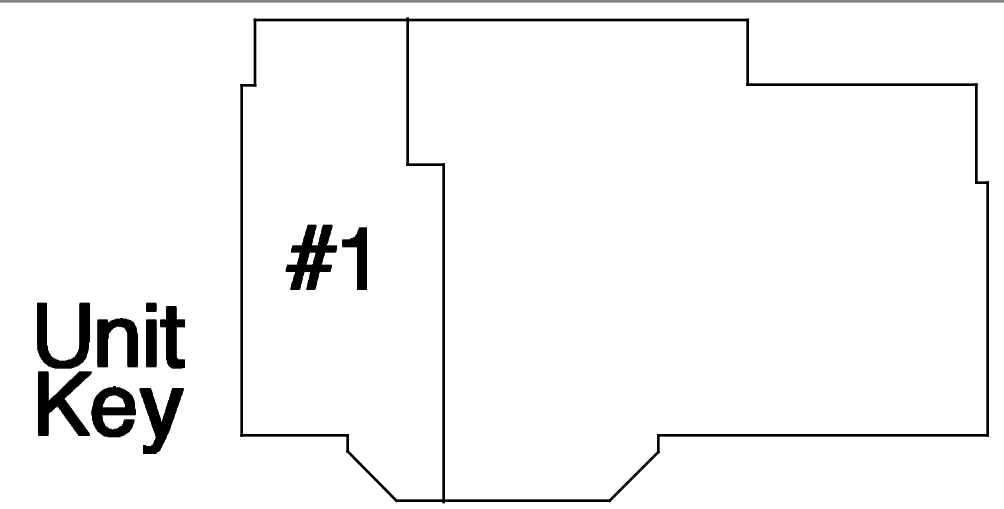

Revisions	date