

City of Portland, Maine – Building or Use Permit Application 389 Congress Street, 04101, Tel: (207) 874-8703, FAX: 874-8716

Location of Construction: 22 Carroll St., Apt. 10		Owner: *** Dino & Barbara Giamatti		Phone: *** 799-0107		Permit No: 001035	
Owner Address: 22 Carroll St., Apt. 10 Portland, ME 04102		Lessee/Buyer's Name:		Phone:		BusinessName:	
Contractor Name: D.J.S. Construction		Address: Scarborough, ME 04074		Phone:		Permit Issued: SEP 15 2000	
Past Use: Multi		Proposed Use: Same		COST OF WORK: \$ 65,000.00		PERMIT FEE: \$ 414.00	
				FIRE DEPT. <input type="checkbox"/> Approved <input type="checkbox"/> Denied		INSPECTION: Use Group: A-2 Type: 53 BOC 499	
				Signature:		Signature: <i>Hepper</i>	
Proposed Project Description: New kitchen & bath				PEDESTRIAN ACTIVITIES DISTRICT (P.A.D.)		Zoning: CBL: 062-E-001	
				Action: <input type="checkbox"/> Approved <input type="checkbox"/> Approved with Conditions <input type="checkbox"/> Denied		Zoning Approval:	
Permit Taken By: Gayle		Date Applied For: September 14, 2000 GG				Special Zone or Reviews: <input type="checkbox"/> Shoreland <input type="checkbox"/> Wetland <input type="checkbox"/> Flood Zone <input type="checkbox"/> Subdivision <input type="checkbox"/> Site Plan maj <input type="checkbox"/> minor <input type="checkbox"/> mm <input type="checkbox"/>	

1. This permit application does not preclude the Applicant(s) from meeting applicable State and Federal rules.
2. Building permits do not include plumbing, septic or electrical work.
3. Building permits are void if work is not started within six (6) months of the date of issuance. False information may invalidate a building permit and stop all work..

PERMIT ISSUED WITH REQUIREMENTS

CERTIFICATION

I hereby certify that I am the owner of record of the named property, or that the proposed work is authorized by the owner of record and that I have been authorized by the owner to make this application as his authorized agent and I agree to conform to all applicable laws of this jurisdiction. In addition, if a permit for work described in the application is issued, I certify that the code official's authorized representative shall have the authority to enter all areas covered by such permit at any reasonable hour to enforce the provisions of the code(s) applicable to such permit

September 14, 2000

SIGNATURE OF APPLICANT ADDRESS: DATE: PHONE:

RESPONSIBLE PERSON IN CHARGE OF WORK, TITLE PHONE:

White-Permit Desk Green-Assessor's Canary-D.P.W. Pink-Public File Ivory Card-Inspector

Zoning Appeal

Variance
 Miscellaneous
 Conditional Use
 Interpretation
 Approved
 Denied

Historic Preservation

Not in District or Landmark
 Does Not Require Review
 Requires Review

Action:

Approved
 Approved with Conditions
 Denied

Date: _____

PERMIT ISSUED WITH REQUIREMENTS

CEO DISTRICT

BUILDING PERMIT REPORT

DATE: 14 Sept. 2000 ADDRESS: 22 Carroll St. Apt. 10 CBL: 062-E-001

REASON FOR PERMIT: New Kitchen & bath

BUILDING OWNER: Giannatti's

PERMIT APPLICANT: CONTRACTOR D.J.S. Construction

USE GROUP: R-2 CONSTRUCTION TYPE: 53 CONSTRUCTION COST: \$65,000.00 PERMIT FEES: \$440.00

The City's Adopted Building Code (The BOCA National Building Code/1999 with City Amendments)
The City's Adopted Mechanical Code (The BOCA National Mechanical Code/1993)

CONDITION(S) OF APPROVAL

This permit is being issued with the understanding that the following conditions shall be met: 1, 11, 13, 14, 15, 17
19, 22, 29, 30, 34

1. This permit does not excuse the applicant from meeting applicable State and Federal rules and laws.
2. Before concrete for foundation is placed, approvals from the Development Review Coordinator and Inspection Services must be obtained. (A 24 hour notice is required prior to inspection) "ALL LOT LINES SHALL BE CLEARLY MARKED BEFORE CALLING."
3. Foundation drain shall be placed around the perimeter of a foundation that consists of gravel or crushed stone containing not more than 10 percent material that passes through a No. 4 sieve. The drain shall extend a minimum of 12 inches beyond the outside edge of the footing. The thickness shall be such that the bottom of the drain is not higher than the bottom of the base under the floor, and that the top of the drain is not less than 6 inches above the top of the footing. The top of the drain shall be covered with an approved filter membrane material. Where a drain tile or perforated pipe is used, the invert of the pipe or tile shall not be higher than the floor elevation. The top of joints or top of perforations shall be protected with an approved filter membrane material. The pipe or tile shall be placed on not less than 2" of gravel or crushed stone, and shall be covered with not less than 6" of the same material. Section 1813.5.2
4. Foundations anchors shall be a minimum of 1/2" in diameter, 7" into the foundation wall, minimum of 12" from corners of foundation and a maximum 6' O.C. between bolts. Section 2305.17
5. Waterproofing and dampproofing shall be done in accordance with Section 1813.0 of the building code.
6. Precaution must be taken to protect concrete from freezing. Section 1908.0
7. It is strongly recommended that a registered land surveyor check all foundation forms before concrete is placed. This is done to verify that the proper setbacks are maintained.
8. Private garages located beneath habitable rooms in occupancies in Use Group R-1, R-2, R-3 or I-1 shall be separated from adjacent interior spaces by fire partitions and floor/ceiling assembly which are constructed with not less than 1-hour fire resisting rating. Private garages attached side-by-side to rooms in the above occupancies shall be completely separated from the interior spaces and the attic area by means of 1/2 inch gypsum board or the equivalent applied to the garage side. (Chapter 4, Section 407.0 of the BOCA/1999)
9. All chimneys and vents shall be installed and maintained as per Chapter 12 of the City's Mechanical Code. (The BOCA National Mechanical Code/1993). Chapter 12 & NFPA 211
10. Sound transmission control in residential building shall be done in accordance with Chapter 12, Section 1214.0 of the City's Building Code.
11. Guardrails & Handrails: A guardrail system is a system of building components located near the open sides of elevated walking surfaces for the purpose of minimizing the possibility of an accidental fall from the walking surface to the lower level. Minimum height all Use Groups 42". In occupancies in Use Group A, B,H-4, I-1, I-2, M, R, public garages and open parking structures, open guards shall have balusters or be of solid material such that a sphere with a diameter of 4" cannot pass through any opening. Guards shall not have an ornamental pattern that would provide a ladder effect. Handrails shall be a minimum of 34" but not more than 38". Exception: Handrails that form part of a guard shall have a height not less than 36 inches (914 mm) and not more than 42 inches (1067 mm). Handrail grip size shall have a circular cross section with an outside diameter of at least 1 1/4" and not greater than 2". (Sections 1021 & 1022.0). Handrails shall be on both sides of stairway. (Section 1014.7)
12. Headroom in habitable space is a minimum of 7'6". (Section 1204.0)
13. Stair construction in Use Group R-3 & R-4 is a minimum of 10" tread and 7 1/2" maximum rise. All other Use Group minimum 11" tread, 7" maximum rise. (Section 1014.0)
14. The minimum headroom in all parts of a stairway shall not be less than 80 inches. (6'8") 1014.4
15. Every sleeping room below the fourth story in buildings of Use Groups R and I-1 shall have at least one operable window or exterior door approved for emergency egress or rescue. The units must be operable from the inside without the use of special knowledge or separate tools. Where windows are provided as means of egress or rescue they shall have a sill height not more than 44 inches (1118mm) above the floor. All egress or rescue windows from sleeping rooms shall have a minimum net clear opening height dimension of 24 inches (610mm). The minimum net clear opening width dimension shall be 20 inches (508mm), and a minimum net clear opening of 5.7 sq. ft. (Section 1010.4)
16. Each apartment shall have access to two (2) separate, remote and approved means of egress. A single exit is acceptable when it exits directly from the apartment to the building exterior with no communications to other apartment units. (Section 1010.1)
17. All vertical openings shall be enclosed with construction having a fire rating of at least one (1) hour, including fire doors with self closure's. (Over 3 stories in height requirements for fire rating is two (2) hours. (Section 710.0)
18. The boiler shall be protected by enclosing with (1) hour fire rated construction including fire doors and ceiling, or by providing automatic extinguishment. (Table 302.1.1)

19. All single and multiple station smoke detectors shall be of an approved type and shall be installed in accordance with the provisions of the City Building Code Chapter 9, Section 920.3.2 (BOCA National Building Code/1999), and NFPA 101 Chapter 18 & 19. (Smoke detectors shall be installed and maintained at the following locations):
- In the immediate vicinity of bedrooms
 - In all bedrooms
 - In each story within a dwelling unit, including basements
20. A portable fire extinguisher shall be located as per NFPA #10. They shall bear the label of an approved agency and be of an approved type. (Section 921.0)
21. The Fire Alarm System shall be installed and maintained to NFPA #72 Standard.
22. The Sprinkler System shall be installed and maintained to NFPA #13 Standard.
23. All exit signs, lights and means of egress lighting shall be done in accordance with Chapter 10 Section & Subsections 1023.0 & 1024.0 of the City's Building Code. (The BOCA National Building Code/1999)
24. Section 25 - 135 of the Municipal Code for the City of Portland states, "No person or utility shall be granted a permit to excavate or open any street or sidewalk from the time of November 15 of each year to April 15 of the following year".
25. The builder of a facility to which Section 4594-C of the Maine State Human Rights Act Title 5 MRSA refers, shall obtain a certification from a design professional that the plans commencing construction of the facility, the builder shall submit the certification the Division of Inspection Services.
26. Ventilation and access shall meet the requirements of Chapter 12 Sections 1210.0 and 1211.0 of the City's Building Code. (Crawl spaces & attics).
- *27. All electrical, plumbing and HVAC permits must be obtained by Master Licensed holders of their trade. No closing in of walls until all electrical (min. 72 hours notice) and plumbing inspections have been done.
28. All requirements must be met before a final Certificate of Occupancy is issued.
- *29. All building elements shall meet the fastening schedule as per Table 2305.2 of the City's Building Code (The BOCA National Building Code/1996).
- *30. Ventilation of spaces within a building shall be done in accordance with the City's Mechanical code (The BOCA National Mechanical Code/1993). (Chapter M-16)
31. Please read and implement the attached Land Use Zoning report requirements.
32. Boring, cutting and notching shall be done in accordance with Sections 2305.3, 2305.3.1, 2305.4.4 and 2305.5.1 of the City's Building Code.
33. Bridging shall comply with Section 2305.16.
- *34. Glass and glazing shall meet the requirements of Chapter 24 of the building code. (Safety Glazing Section 2406.0)
35. All signage, shall be done in accordance with Section 3102.0 signs of the City's Building Code, (The BOCA National Building Code/1999).

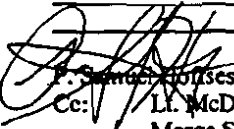
 L. McDougall, Building Inspector
 Cc: L. McDougall, PFD
 Marge Schmuckal, Zoning Administrator

FSH 1/2600

****This permit is herewith issued, on the basis of plans submitted and conditions placed on these plans, any deviations shall require a separate approval.**

...THIS PERMIT HAS BEEN ISSUED WITH THE UNDERSTANDING THAT ALL THE CONDITIONS OF THE APPROVAL SHALL BE COMPLETED. THEREFORE, BEFORE THE WORK IS COMPLETED A REVISED PLAN OR STATEMENT FROM THE PERMIT HOLDER SHALL BE SUBMITTED TO THIS OFFICE SHOWING OR EXPLAINING THAT THE CONDITIONS HAVE BEEN MET. IF THIS REQUIREMENT IS NOT RECEIVED YOUR CERTIFICATE OF OCCUPANCY SHALL BE WITHHELD.

******ALL PLANS THAT REQUIRE A PROFESSIONAL DESIGNER'S SEAL, (AS PER SECTION 114.0 OF THE BUILDING CODE) SHALL ALSO BE PRESENTED TO THIS DIVISION ON AUTO CAD LT. 2000, OR EQUIVALENT.**

*******CERTIFICATE OF OCCUPANCY FEE \$50.00**

THIS IS NOT A PERMIT/CONSTRUCTION CANNOT COMMENCE UNTIL THE PERMIT IS ISSUED

**Building or Use Permit Pre-Application
Attached Single Family Dwellings/Two-Family Dwelling
Multi-Family or Commercial Structures and Additions Thereto**

In the interest of processing your application in the quickest possible manner, please complete the information below for a Building or Use Permit.

NOTE** If you or the property owner owns real estate or personal property taxes or user charges on ANY PROPERTY within the City, payment arrangements must be made before permits of any kind are accepted.

Location/Address of Construction (include Portion of Building): 22 CARROLL St, Apt. 10,		
Total Square Footage of Proposed Structure: 1800	Square Footage of Lot: _____	
Tax Assessor's Chart, Block & Lot Number Chart: 067 Block: E Lot: 001	Owner: XX DINO & BARBARA GIAMATTI	Telephone: 799-0107
Owner's Address: 22 CARROLL St, Apt. 10 Portland 04102	Lessee/Buyer's Name (If Applicable): _____	Cost Of Work: \$65,000 Fee: \$414
Proposed Project Description: (Please be as specific as possible) New Kitchen - new bathroom - general renovation		
Contractor's Name, Address & Telephone: D.J.S. Construction, Scarborough, Me. 04074 883-0391		Rec'd By: [Signature]
Current Use: Residence	Proposed Use: Residence	

Separate permits are required for Internal & External Plumbing, HVAC and Electrical installation.

- All construction must be conducted in compliance with the 1996 B.O.C.A. Building Code as amended by Section 6-Art II.
- All plumbing must be conducted in compliance with the State of Maine Plumbing Code.
- All Electrical Installation must comply with the 1996 National Electrical Code as amended by Section 6-Art III.
- HVAC (Heating, Ventilation and Air Conditioning) Installation must comply with the 1993 BOCA Mechanical Code.

You must include the following with your application:

- 1) A Copy of Your Deed or Purchase and Sale Agreement
- 2) A Copy of your Construction Contract, if available
- 3) A Plot Plan/Site Plan

*** IF Available also
Submit Plans on
ADOBE OR CAD Format**

Minor or Major site plan review will be required for the above proposed projects. The attached checklist outlines the minimum standards for a site plan.

4) Building Plans

Unless exempted by State Law, construction documents must be designed by a registered design professional.

A complete set of construction drawings showing all of the following elements of construction:

- Cross Sections w/ Framing details (including porches, decks w/ railings, and accessory structures)
- Floor Plans & Elevations
- Window and door schedules
- Foundation plans with required drainage and dampproofing
- Electrical and plumbing layout. Mechanical drawings for any specialized equipment such as furnaces, chimneys, gas equipment, HVAC equipment (air handling) or other types of work that may require special review must be included.

Certification

I hereby certify that I am the Owner of record of the named property, or that the proposed work is authorized by the owner of record and that I have been authorized by owner to make this application as his/her authorized agent. I agree to conform to all applicable laws of this jurisdiction. In addition, if a permit for work described in this application is issued, I certify that the Code Official's authorized representative shall have the authority to enter all areas covered by this permit at any reasonable hour to enforce the provisions of the codes applicable to this permit.

Signature of applicant: **[Signature]**

Date: **9/13/00**

Building Permit Fee: \$30.00 for the 1st \$1000.00 cost plus \$6.00 per \$1,000.00 construction cost thereafter.

Additional Site review and related fees are attached on a separate addendum

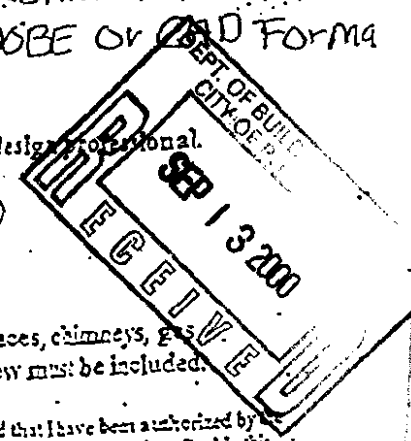

**19/13
2:00**

WARRANTY DEED
(Maine Statutory Short Form)

KNOW ALL PERSONS BY THESE PRESENTS, that I, **Douglas M. Green**, of Portland, County of Cumberland and State of Maine, for consideration paid, grant to **Dino Giamatti** and **Barbara Giamatti** both of Scarborough, County of Cumberland, State of Maine, with a mailing address of 10 Starbird Lane, Scarborough, ME 04074, with **WARRANTY COVENANTS**, the following described real estate:

That certain real estate located in Portland, County of Cumberland and State of Maine, being residential Unit numbered 10 and garage Unit numbered 6 at McLellan School Houses, which has been established in accordance with the Unit Ownership Act of Maine, Chapter 10, Title 33, Section 560 et seq. of the revised Statutes of Maine, 1964, as amended, all as more specifically described as McLellan School House Declaration dated December 29, 1982 and recorded in the Cumberland County Registry of Deeds in Book 5091, Page 176 and as delineated on the survey entitled "McLellan School Houses" dated December 15, 1982 and as delineated on the floor plans entitled McLellan School Houses dated December 29, 1982, said survey and floor plans being recorded in said Registry of Deeds in Unit Ownership file numbered 97; including within this conveyance the undivided interests appurtenant to said residential unit and said garage unit in the common areas and facilities and the use of certain condominium limited common areas and facilities all as more fully described in said Declaration and the survey and floor plans to which reference is made therein, being a nine and ten one-hundredth percent (9.10%) undivided interest appurtenant to the said residential unit and a thirty one-hundredth percent (0.30%) undivided interest appurtenant to the said garage unit for a total undivided interest of nine and forty one-hundredth percent (9.40%).

Said units are conveyed subject to and with the benefit of all of the terms, provisions, conditions, restrictions, easements, covenants, obligations, reservations and encumbrances contained or referred to in the Declaration, survey and floor plans as hereinbefore referred to, all of which are incorporated by reference herein as the same may be amended or modified from time to time by documents recorded at or filed in said Registry of Deeds, which provisions, together with any amendments or modifications thereto, shall constitute conveyances running with the land and shall bind any person having at any time any interest or estate in the Condominium Units, as if those provisions were raised and set forth herein. The Grantee, by the acceptance hereof, agrees to be bound by and to comply with all of terms and conditions of said McLellan School House Declaration, as the same may have been amended.

Being the same premises conveyed to the Grantor herein by Karen Marino by Warranty Deed dated April 13, 1994 and recorded in Cumberland County Registry of Deeds in Book 11388, Page 329.

WITNESS my hand and seal this 6th day of June, 2000.

WITNESS:

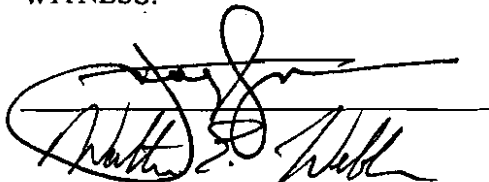

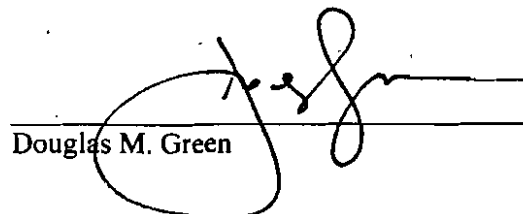
Douglas M. Green

MAINE REAL ESTATE TAX PAID

STATE OF MAINE
COUNTY OF CUMBERLAND, ss.

June 6, 2000

Then personally appeared the above named Douglas M. Green and acknowledged the foregoing instrument to be his free act and deed.

Before me,

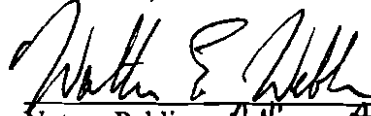

Notary Public At-Large At Law

Print Name: Walter E. Webber

My Commission Expires: _____

RECEIVED
RECORDED REGISTRY OF DEED

2000 JUN -6 PM 3: 23

CUMBERLAND COUNTY

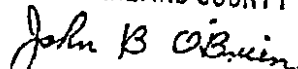

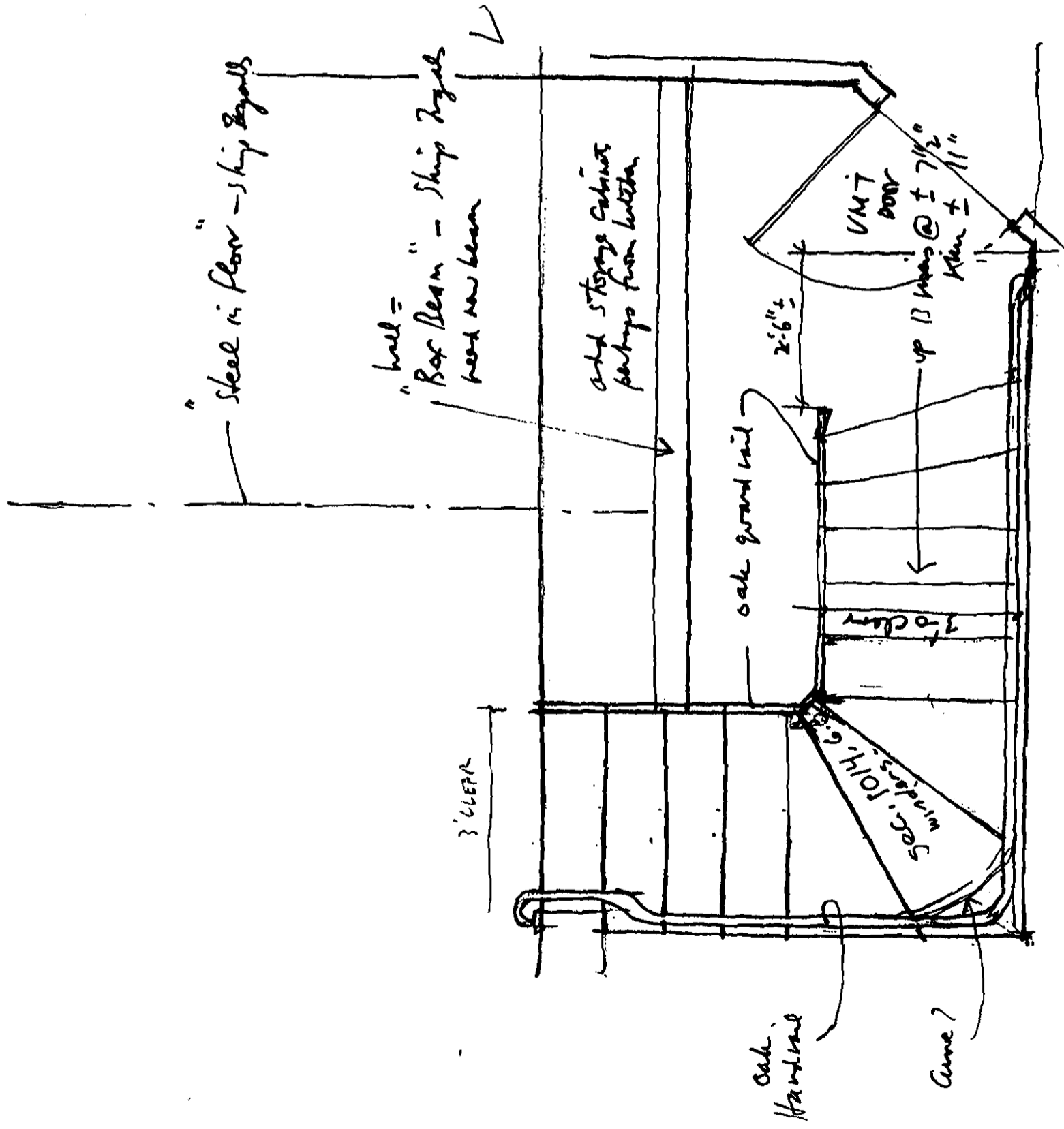

Note: The architect is not responsible for any structural issues. All new work must be done with the advice and guidance of a structural engineer. The contractor must check all dimensions. Those are only accurate to within 6" ±

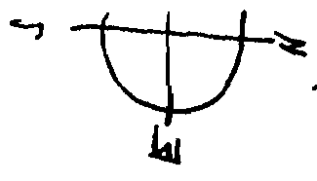

Proposed New Stair (shown at second floor)
 Granitelli Unit 10 22 Canall 8m
 1/2" = 1'-0" 6. 20. 2000

Sec. 10 1/4 φ
 7 3/4"
 10"

6.20.2000
 SW. MATHLET
 1/2" = 1'-0"

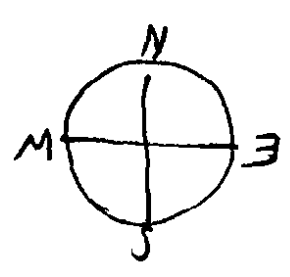

Grandpa's Unit 10
 Proposed water between
 Note: The Architect is not
 responsible for any structural
 issues. All new work must
 be done with the advice
 and guidance of a structural
 engineer

the space heater
 under (existing?)
 new fixtures

Dark hatching = New

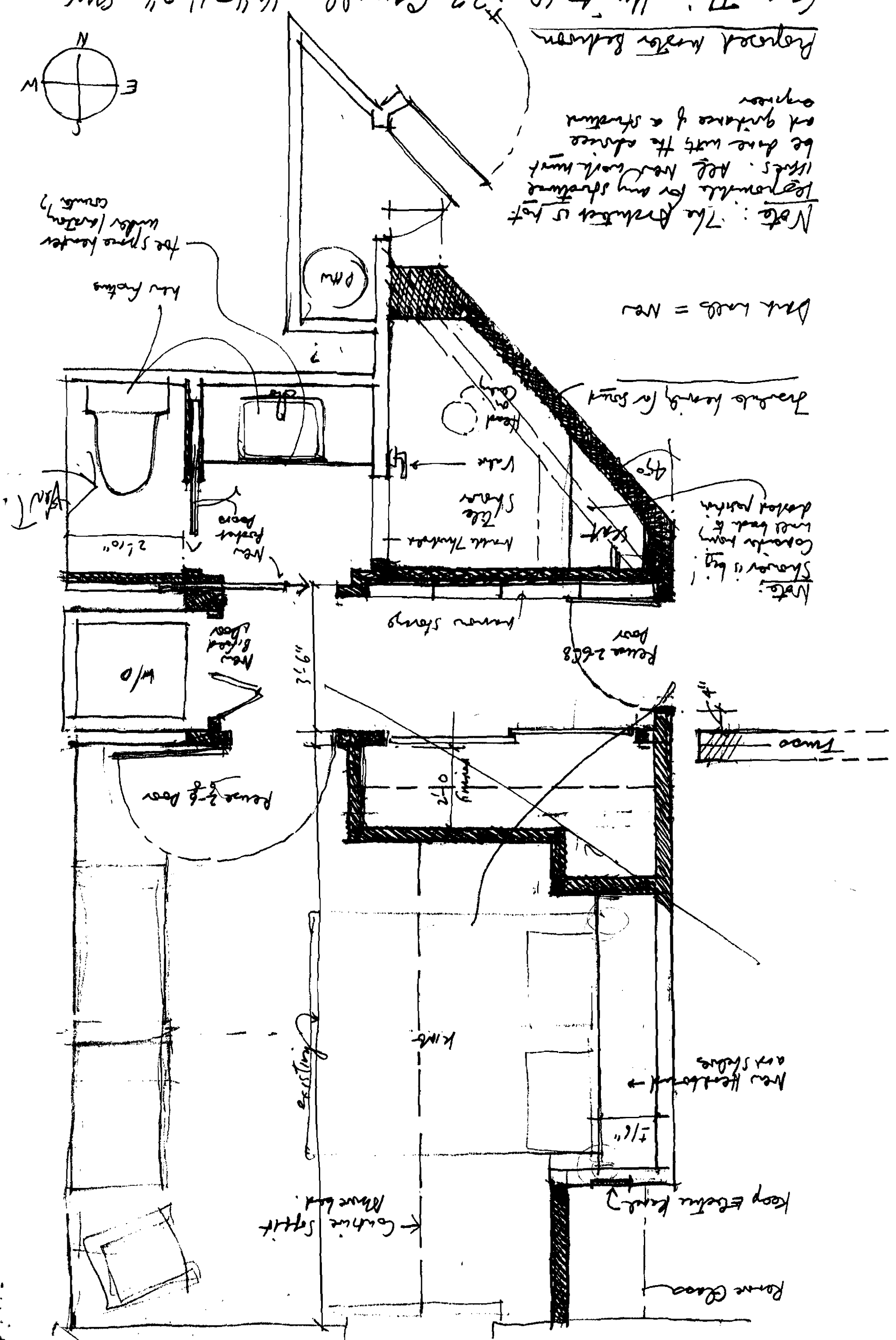

Note: Shower is big!
 Consider how
 well back to
 doctor position

Two

New Heatbank →

Keep Electric Panel?

Remove Glass

← Existing Split
 Remove bed.

KITCH

Existing

Remove 2688
 door

Remove storage

Make Threshold
 Tile
 Shower
 Valve
 Head (in
 Bath)

Transfer heavy for front

45°

2'-10"

New
 Pocket
 door

New
 8' food
 door

W/O

Remove 2-8 door

2'-0"

3'-6"

11"

7'-6"

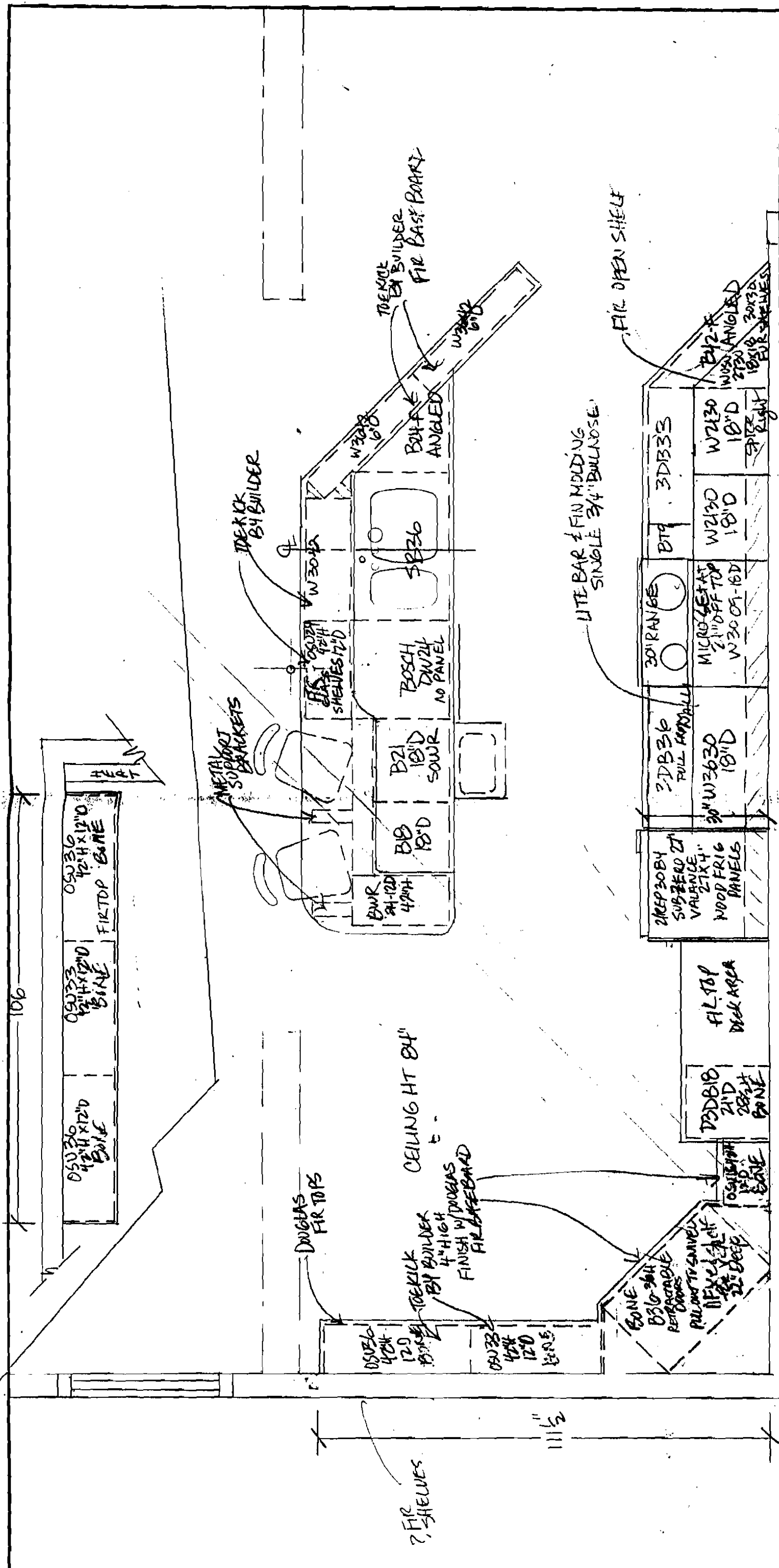

DRAWN BY AUDREY	
REVISED	
SCALE: 1/2" = 1'	APPROVED BY:
DATE: 1/25/00	→
BARBARA & DINO GIAMATTI	
CASTLE	
REMODEL-CONDO, PORTLAND	
DRAWING NUMBER 83667	

