

# PLANT SCHEDULE

McEnroe/Nuzzi Residence  
38 Neal Street, Portland, ME 04102

Designed by A. Murphy  
Gnome Landscapes, Design, Masonry & Maintenance 1/27/17

Key	Common Name	Botanical Name	Quantity	Size
1	Emerald Green Arborvitae	Thuja occidentalis 'Smaragd'	9	7' - 8'
2	Cleveland Ornamental Pear	Pyrus calleryana 'Cleveland'	1	2" - 2.5" Cal.
16	Transplant Existing Shrubs		4	Transplant
A	Divide and Transplant Existing Perennials		10	Transplant
B	Geranium 'Rozanne'	Geranium wallichianum 'Rozanne'	18	Container
C	Astilbe 'Snowdrift'	Astilbe 'Snowdrift'	5	Container
D	Ice Dance Sedge	Carex morrowii 'Ice Dance'	3	Container
E	Happy Returns Daylily	Hemerocallis 'Happy Returns'	3	Container
F	Shenandoah Red Switch Grass	Panicum virgatum 'Shenandoah'	2	Container
G	Sedum 'Autumn Joy'	Sedum 'Autumn Joy'	3	Container
H	Hosta 'Guacamole'	Hosta 'Guacamole'	2	Container
I	Hosta 'Blue Mammoth'	Hosta 'Blue Mammoth'	1	Container

Irregular Bluestone  
Set in Stonedust,  
Finish with Polymeric Sand

Remove 2 Arbs and 3 Stumps  
Remove Brick Trim Around Plant Beds

Remove Approx. 42' of Existing  
5' High Wood Fence and Posts,  
and 42' of 4' High Chain  
Link Fence and Posts on Left Side  
of Yard. Install approx. 84' of  
8' High Wooden Fence, Dropping  
to 4' High with 25' of the Sidewalk  
and Stopping Several Feet Before  
the Sidewalk.

Existing Climbing Hydrangea

New Fence with 3' Gate

Remove Approx. 475 Sq. Ft.  
of Asphalt, and Approx.  
150 Sq. Ft. of Existing Brick  
Walkway to Street.  
Remove 18" wide Plant Bed  
on Left Side of Driveway.  
Install Brick Driveway,  
Running Bond Pattern.

Remove Approx. 210 Sq. Ft.  
of Concrete Walkway,  
Install Approx. 525 Sq. Ft. Brick  
Walkway, Basket-Weave Pattern  
with Running Bond Border,  
In Left Side Yard and Back Yard.

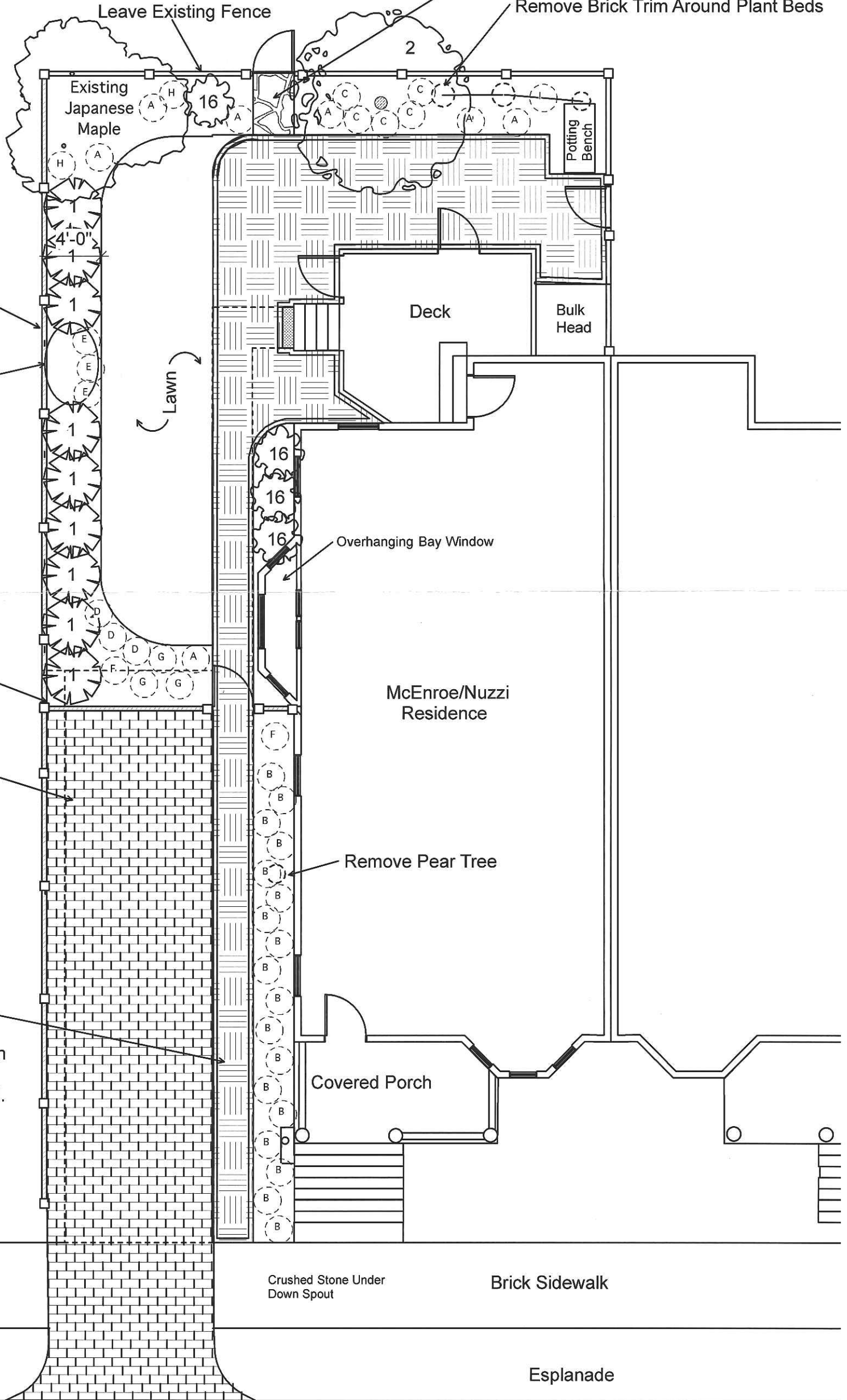

0 2' 8' 16' 24'

SCALE: 1/8" = 1'-0"

Neal Street