

114 Emery Street

- 59'5" -

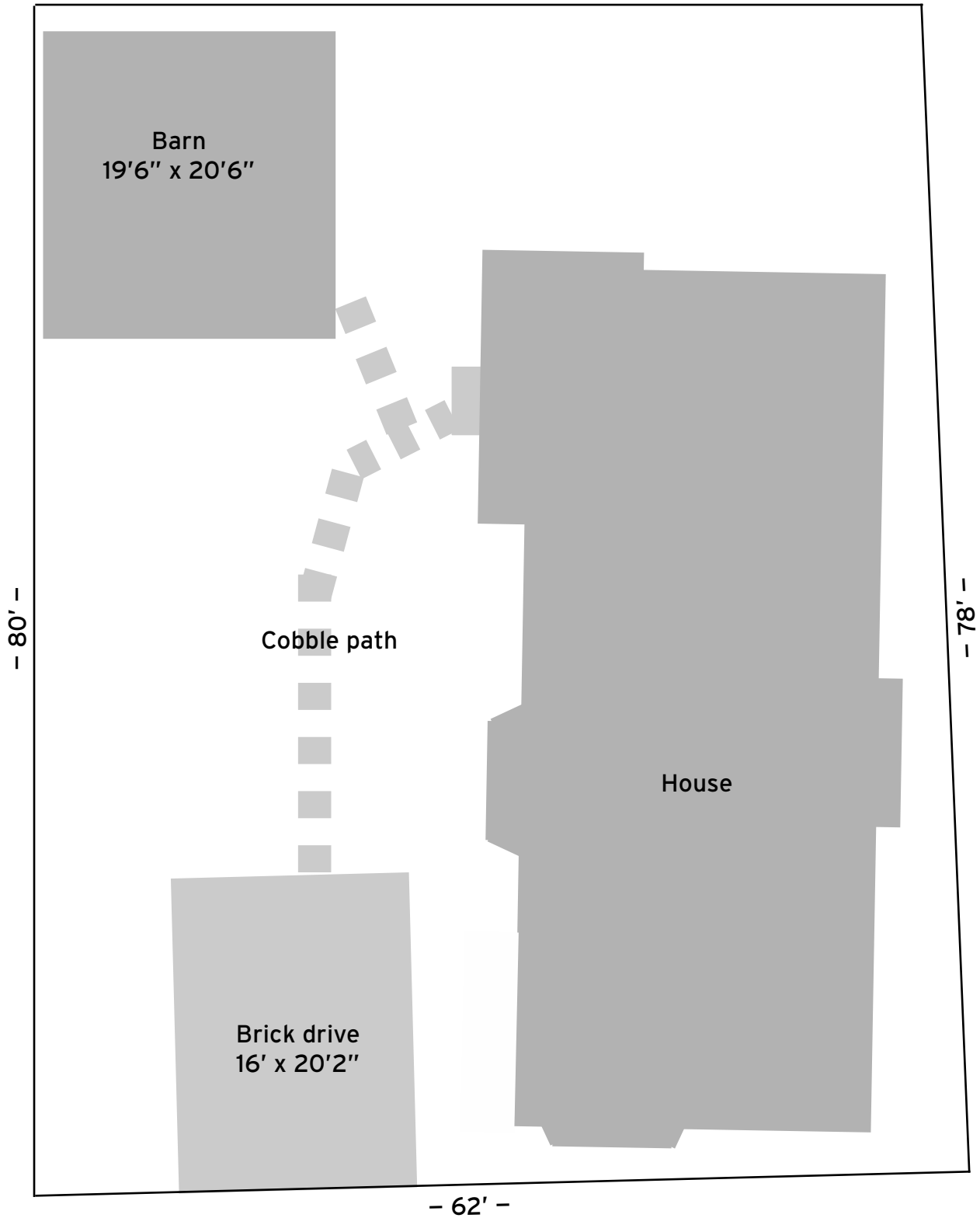

CITY OF PORTLAND
APPROVED SITE PLAN
Subject to Conditions of Approval
and Standard Conditions

DATE OF APPROVAL: **11-12-15**
PLANNER: **Barbara Barhydt**
PROJECT NO.: **2015-192**

114 Emery Street



Front of barn



Street view

114 Emery Street



From top of drive



Cobble walk



CITY OF PORTLAND
APPROVED SITE PLAN
Subject to Conditions of Approval
and Standard Conditions

DATE OF APPROVAL: **11-12-15**
PLANNER: **Barbara Barhydt**
PROJECT NO.: **2015-192**

114 Emery Street

Description of proposed work

The two-story, pre-1924 barn measures 19'6" x 20'6" and sits in the back left hand corner of the 114 Emery Street lot. The conversion will add a second story bath and bedroom and a first story kitchen and living area within the barn and will not change the footprint of the structure.

No major alterations are planned for the exterior, beyond replacement of old windows and extension of the walk to the entrance at the right side of the structure.



CITY OF PORTLAND
APPROVED SITE PLAN
Subject to Conditions of Approval
and Standard Conditions

11-12-15

DATE OF APPROVAL

PLANNER **Barbara Barhydt**

PROJECT NO. **2015-192**