

# 114 Emery Street

- 59'4" -

Barn sits approx 12" from WNW property line

Barn  
19'6" x 20'6"

Utility Trench  
4'W X 4'D x 40'

Barn sits at  
SW property line  
as defined by  
1950s era cyclone  
fence and approx.  
58'6" from front  
of lot

- 80' -

Cobble path

- 78' -

House

Brick drive  
16' x 20'2"

- 62' -

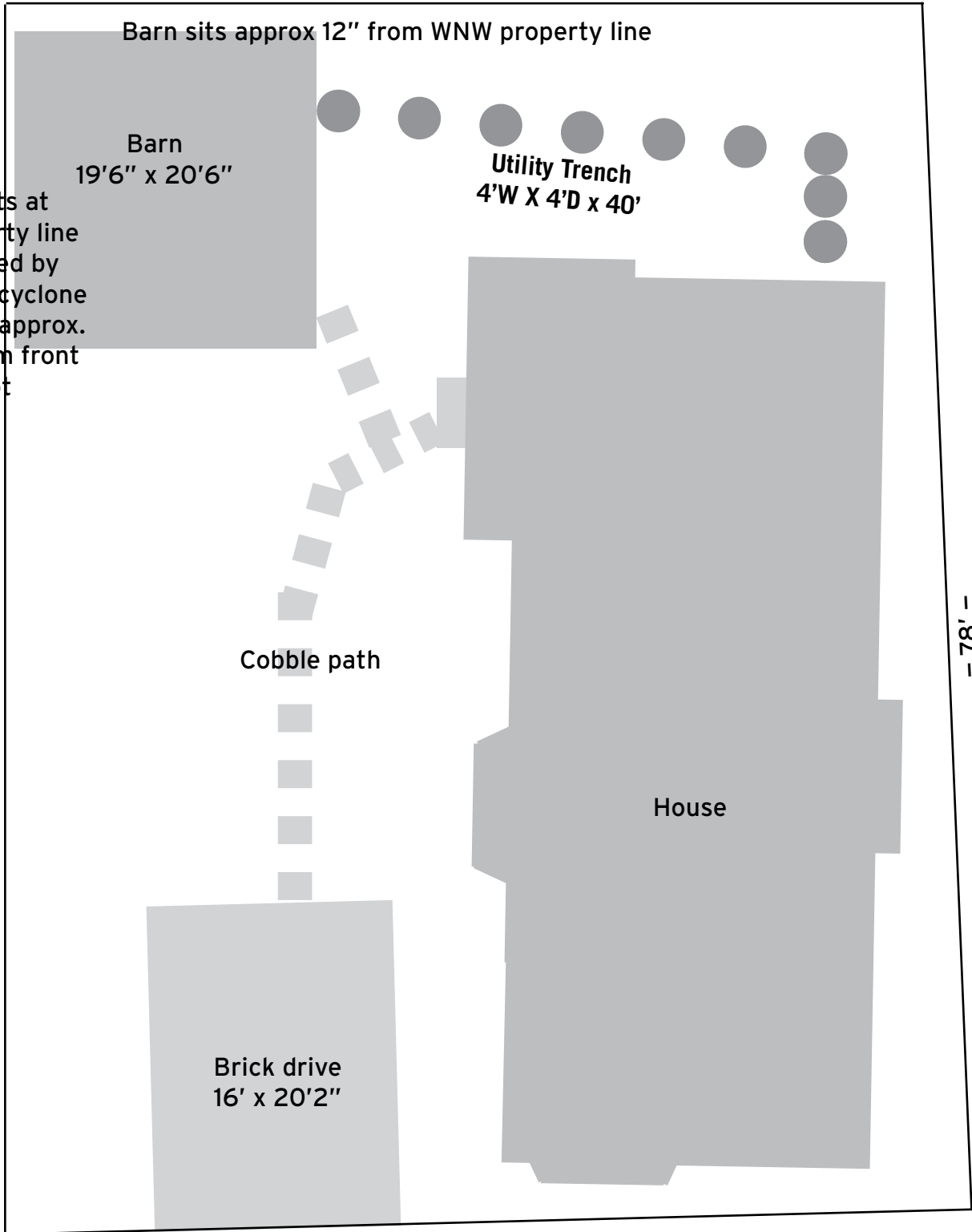

Kathryn + Rick Ackerman (owners)  
114 Emery Street  
Portland, Maine 04102  
207-775-2802/207-772-1061  
[buxtoncomm@gmail.com](mailto:buxtoncomm@gmail.com) / [rickpackermann@gmail.com](mailto:rickpackermann@gmail.com)

Additional notes about the barn windows:

During the pre-application process, we worked with the Rob Weiner of the Historic Preservation Program, and he has reviewed our plans for windows at the front of the structure. Our contractor is still researching window suppliers and we will review with the HP department prior to ordering.