

1.0 PARTITION SCHEDULE
REFER TO PARTITION GENERAL NOTES ALSO

1.1 'A' PARTITIONS -
8" STEEL STUDS EXTEND FROM FLOOR RUNNER TO RUNNER AT STRUCTURE ABOVE.
PROVIDE:
-ONE LAYER 1/2" PLYWOOD SUBSTRATE (SIDE LABELED 'P')
-ONE LAYER 5/8" TYPE 'X' BOARD ON CORRIDOR SIDE OF WALL - FULL HEIGHT TIGHT TO DECK ABOVE.
-SOUND ATTENUATION INSULATION.
-ONE LAYER 5/8" TYPE 'X' BOARD ON OPPOSITE SIDE OF WALL - FULL HEIGHT TIGHT TO DECK ABOVE.
ONE HOUR RATING
PROVIDE:
-1/2" PLYWOOD SUBSTRATE (BOTH SIDES OF WALL)
-ONE LAYER 5/8" TYPE 'X' GWB (BOTH SIDES OF WALL) - FULL HEIGHT TIGHT TO DECK ABOVE.
-SOUND ATTENUATION INSULATION.
-1" SOUND ISOLATION CLIP W/ 7/8" STL CHANNEL. LOCATE ON SIDE MARKED 'R'.
ONE HOUR RATING
PROVIDE:
-ACoustic FABRIC PANEL (AUDITORIUM SIDE OF WALL)
-ONE LAYER 5/8" TYPE 'X' BOARD ONE SIDE OF WALL.
ONE HOUR RATING
PROVIDE:
-1/2" PLYWOOD SUBSTRATE (BOTH SIDES OF WALL)
-ONE LAYER 3/8" HARDWOOD VENEER PLYWOOD PANELING.
-SOUND ATTENUATION INSULATION.

1.2 'B' PARTITIONS -
6" STEEL STUDS EXTEND FROM FLOOR RUNNER TO RUNNER AT STRUCTURE ABOVE.
PROVIDE:
-ONE LAYER 5/8" GWB BOTH SIDES OF WALL.
-SOUND ATTENUATION INSULATION.
ADD TO ASSEMBLIES NOTED 'R':
-1" SOUND ISOLATION CLIP W/ 7/8" STL CHANNEL. LOCATE ON SIDE MARKED 'R'.
PROVIDE:
-1/2" PLYWOOD SUBSTRATE BOTH SIDES OF WALL.
-ONE LAYER 5/8" GWB BOTH SIDES OF WALL.
-SOUND ATTENUATION INSULATION.
PROVIDE:
-CERAMIC TILE OVER BACKER BOARD ON BATHROOM SIDE OF WALL.
-ONE LAYER 1/2" PLYWOOD SUBSTRATE (SIDE LABELED 'P')
-SOUND ATTENUATION INSULATION.
-ONE LAYER 5/8" GWB ON OTHER SIDE OF WALL.

1.3 'B' PARTITIONS CONTINUED -
PROVIDE:
-1/2" PLYWOOD SUBSTRATE BOTH SIDES OF WALL.
-ONE LAYER 5/8" TYPE 'X' BOARD BOTH SIDES OF WALL.
-SOUND ATTENUATION INSULATION.
ADD TO ASSEMBLIES NOTED 'R':
-1" SOUND ISOLATION CLIP W/ 7/8" STL CHANNEL. LOCATE ON SIDE MARKED 'R'.
PROVIDE:
-ACoustic FABRIC PANEL (AUDITORIUM SIDE OF WALL)
-ONE LAYER 5/8" TYPE 'X' BOARD BOTH SIDES OF WALL.
-SOUND ATTENUATION INSULATION.
-ONE LAYER 1/2" PLYWOOD SUBSTRATE (SIDE LABELED 'P')
-SOUND ATTENUATION INSULATION.
-ONE LAYER 5/8" GWB (BOTH SIDES OF WALL).
-SOUND ATTENUATION INSULATION.

1.4 'B' PARTITIONS CONTINUED -
PROVIDE:
-CERAMIC TILE OVER 1/2" BACKER BOARD (BATHROOM SIDE OF WALL)
-1" SOUND ATTENUATION INSULATION.
-ONE LAYER 1/2" PLYWOOD SUBSTRATE (SIDE LABELED 'P')
-ONE LAYER 5/8" GWB BOTH SIDES OF WALL.
-SOUND ATTENUATION INSULATION.
-1" SOUND ISOLATION CLIP W/ 7/8" STL CHANNEL. LOCATE ON SIDE MARKED 'R'.
PROVIDE:
-ONE LAYER 1/2" PLYWOOD SUBSTRATE (SIDE LABELED 'P')
-ONE LAYER 5/8" GWB ON BOTH SIDES OF WALL.
PROVIDE:
-CERAMIC TILE OVER 1/2" BACKER BOARD ON BATHROOM SIDE OF WALL.
-SOUND ATTENUATION INSULATION.
-ONE LAYER 1/2" PLYWOOD SUBSTRATE (OTHER SIDE OF WALL)
-ONE LAYER 5/8" GWB ON OTHER SIDE OF WALL.
PROVIDE:
-ONE LAYER 3/8" HARDWOOD VENEER PLYWOOD PANELING.
-ONE LAYER 1/2" PLYWOOD SUBSTRATE (BOTH SIDES)
-ONE LAYER 5/8" GWB ON OTHER SIDE OF WALL.
PROVIDE:
-ONE LAYER 5/8" TYPE 'X' GWB (BOTH SIDES OF WALL)
-FULL HEIGHT TIGHT TO DECK ABOVE.
ONE HOUR RATING
PROVIDE:
-ONE LAYER 1/2" PLYWOOD SUBSTRATE (SIDE LABELED 'P')
-ONE LAYER 5/8" GWB (ONE SIDE OF WALL).

1.5 'D' PARTITIONS - OMITTED

1.6 'E' PARTITIONS -
PROVIDE:
-ONE LAYER 3/8" HARDWOOD VENEER PLYWOOD PANELING.
-ONE LAYER 1/2" PLYWOOD SUBSTRATE
-ONE LAYER 5/8" GWB TYPE 'X' (ON BOTH SIDES) - FULL HEIGHT TIGHT TO DECK ABOVE.
-6" STEEL STUDS EXTEND FROM FLOOR RUNNER TO RUNNER AT STRUCTURE ABOVE.
-SOUND ATTENUATION INSULATION.
-2 3/8" AIR SPACE.
-3 3/8" STEEL STUDS EXTEND FROM FLOOR RUNNER TO RUNNER AT STRUCTURE ABOVE.
-ONE LAYER 1/2" PLYWOOD SUBSTRATE
-ONE LAYER 5/8" GWB (CORRIDOR SIDE).
ONE HOUR RATING
PROVIDE:
-ONE LAYER 3/8" HARDWOOD VENEER PLYWOOD PANELING.
-ONE LAYER 1/2" PLYWOOD SUBSTRATE
-6" FURRING ABOVE PROSCENIUM (SEE A3.3)
-6" STEEL STUDS EXTEND FROM TOP OF PROSCENIUM TO RUNNER AT STRUCTURE ABOVE.
-ONE LAYER 5/8" PLYWOOD SUBSTRATE.

ONE HOUR RATED WALL:
"R"

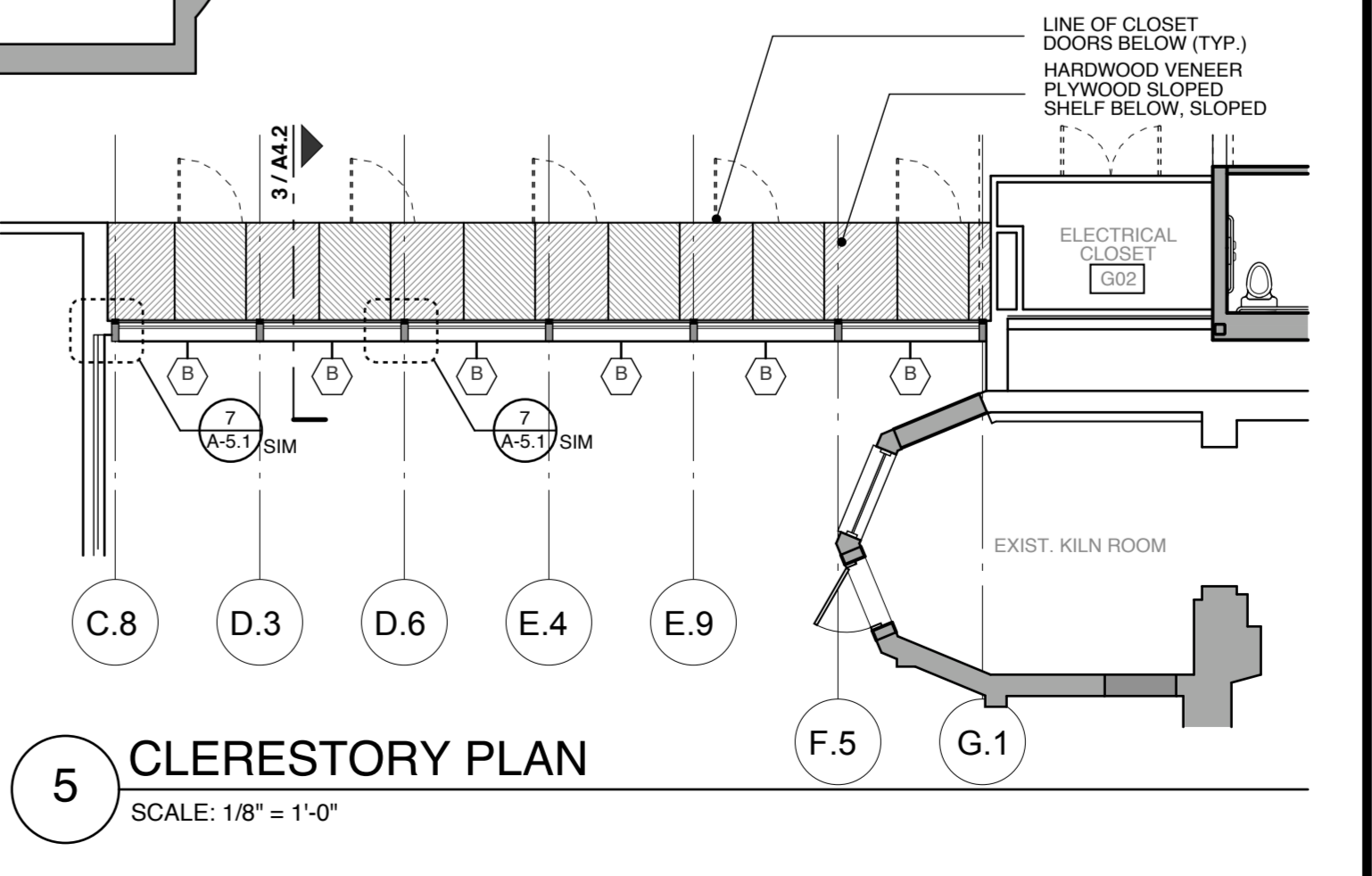
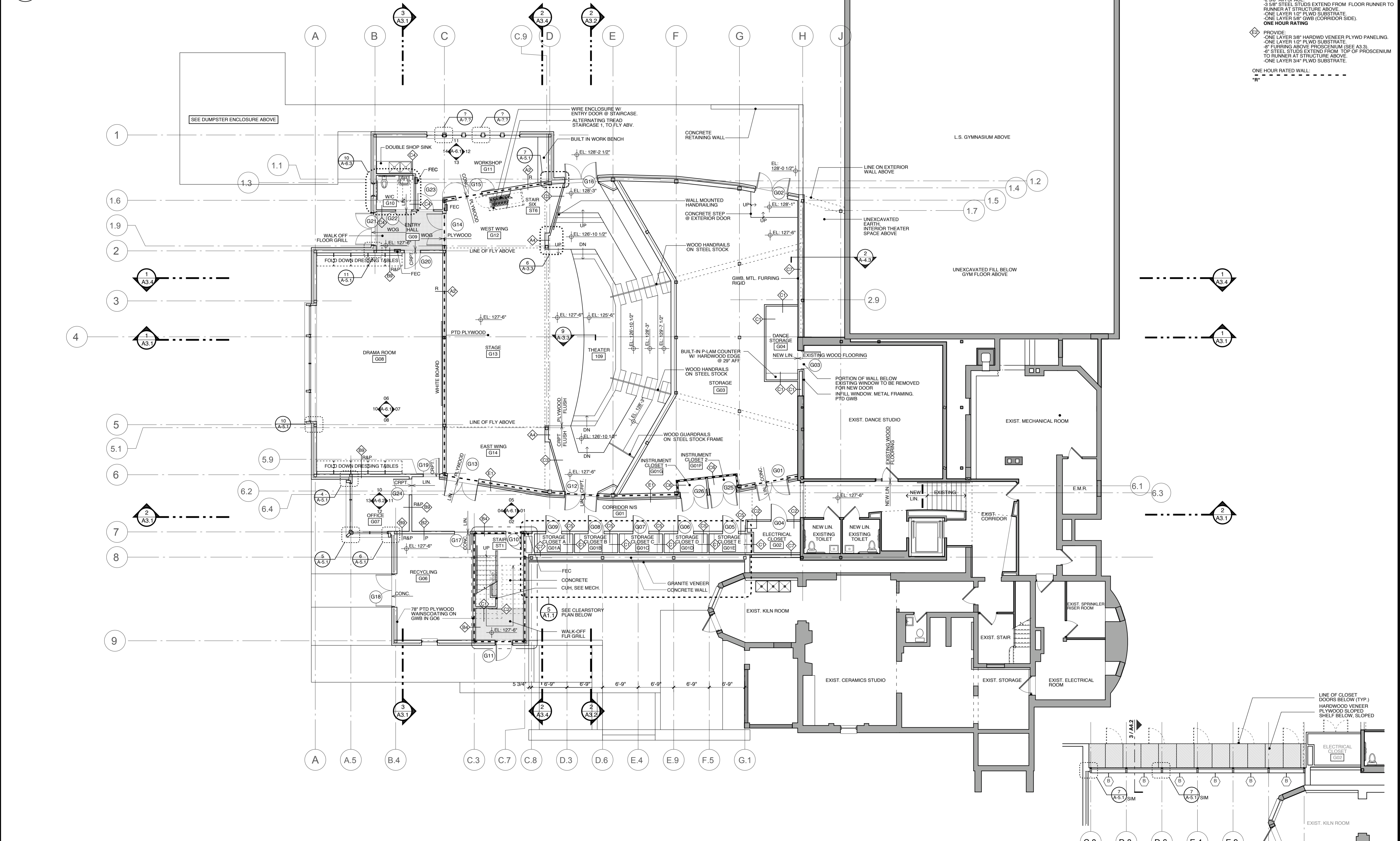

GENERAL PLAN NOTES

1. (280) 6" DIAMETER HOLES TO BE CUT INTO THEATER CARPET AND RISERS TO ACCOMMODATE DIFFUSERS.

SCOTT R. SIMONS ARCHITECTS
NO. 2034
STATE OF MAINE

SSA
Scott Simons Architects
75 York Street
Portland, Maine 04101
phone 207 772 4656
fax 207 828 4656

THIS DRAWING IS THE PROPERTY OF SCOTT SIMONS ARCHITECTS AND IS NOT TO BE COPIED OR REPRODUCED IN PART OR WHOLE.

PROJECT
WAYNFLETE ARTS CENTER PHASE TWO
ADDITION/ RENOVATION
360 SPRING STREET
PORTLAND, ME

TITLE
GROUND FLOOR PLAN

STATUS: ISSUED FOR BIDDING
CONSTRUCTION DOCUMENTS

DATE: 09.07.2007
REVISION / DATE:

PROJECT NO: 2003-0040.00
DRAWN BY:
2007 © Scott Simons Architects

DWG NO. **A-1.1**