

Renovations and Additions for

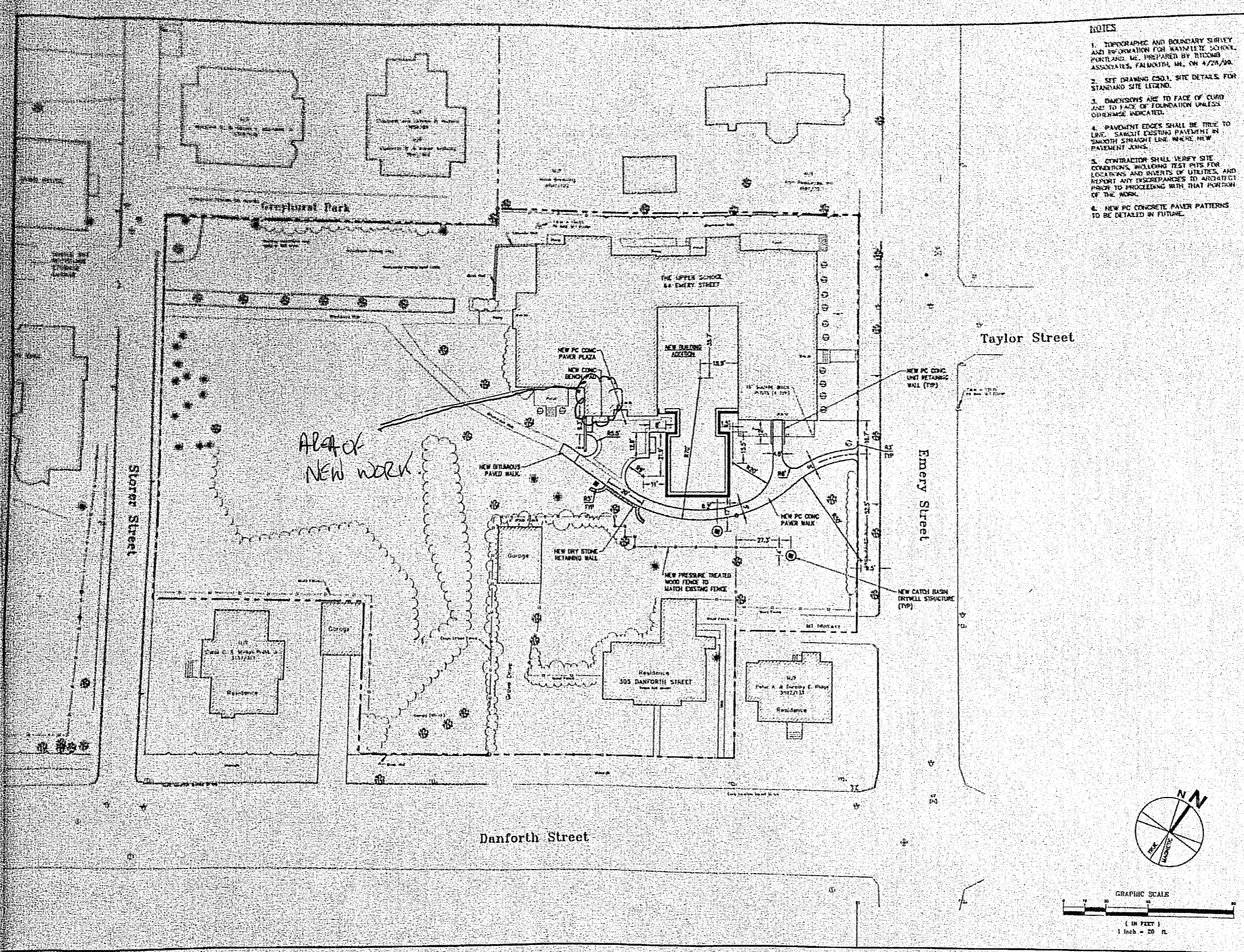

- NOTES**
1. TOPOGRAPHIC AND BOUNDARY SURVEY AND INFORMATION FOR WAYNFLETE SCHOOL, PORTLAND, ME, PREPARED BY BRIDGES ASSOCIATES, FAIRBANKS, ME, ON 4/28/98.
 2. SEE DRAWING CSD-1, SITE DETAILS FOR STANDARD SITE LEGEND.
 3. DIMENSIONS ARE TO FACE OF CURB AND TO FACE OF FOUNDATION UNLESS OTHERWISE INDICATED.
 4. PAVEMENT EDGES SHALL BE TRUE TO LINE. SMOOTH EXISTING PAVEMENT IN SMOOTH STRAIGHT LINE WHERE NEW PAVEMENT JOINS.
 5. CONTRACTOR SHALL VERIFY SITE CONDITIONS, INCLUDING TEST PITS FOR LOCATIONS AND DEPTHS OF UTILITIES, AND REPORT ANY DISCREPANCIES TO ARCHITECT PRIOR TO PROCEEDING WITH THAT PORTION OF THE WORK.
 6. NEW PC CONCRETE PAVEMENT PATTERNS TO BE DETAILED IN FUTURE.

HARRISMAN ASSOCIATES
 101 Adams Street, Suite 200
 Portland, Maine 04102
 Tel: 603-761-1111
 Fax: 603-761-1112
 E-mail: harr@harr.com
 Website: www.harr.com

Project No. **WAYNFLETE SCHOOL ADDITIONS & RENOVATIONS TO EMERY BUILDING**
 PORTLAND, MAINE

ME Project No. **93102**

Rev. 001

Submission Dates		Submission Type	
Date			
6/10/99		PRE-BID REVIEW	
SEP 1, 1999		ISSUED FOR BID	
Revision Dates		Revision Description	
No.	Date		

Drawing Status

Drawing Title
SITE LAYOUT PLAN

PK / PL: FLC Drawn By: RLJ

Drawing Number
C20.1