

TEMPORARY CHANGE OF OCCUPANCY CLASSIFICATION:
 1. EXISTING GYMNASIUM (A-3) = TEMPORARY CLASSROOM USE (E), GRADES 4-5
 2. EXISTING ART GALLERY (A-3) = TEMPORARY CLASSROOM USE (E), GRADES K-1
 3. EXISTING MUSIC ROOM (E) = TEMPORARY CLASSROOM USE (E), GRADES K-1

CODE SUMMARY

APPLICABLE CODES

PLEASE SEE CODE SUMMARY PROVIDED ON SHEET LS-1.2 FOR CODE SUMMARY OF EXISTING BUILDING.

TEMPORARY CHANGE OF OCCUPANCY FOLLOWS CODES LISTED BELOW:

Maine Uniform Building and Energy Code "MUBEC"
 Consists of the following applicable codes:

2009 International Building Code (IBC)
 2009 International Existing Building Code (IEBC)
 2011 National Electrical Code (NEC)

Portland City Code, Chapter 10: Fire Prevention and Protection

Fire/ Life Safety:

NFPA Life Safety Code as adopted by the State of Maine
 Including but not limited to:

2009 NFPA 001: Fire Code
 2009 NFPA 101: Life Safety Code

Accessibility:

2010 ADA Standards for Accessible Design

NOTE: All Codes shall include changes/amendments by the State of Maine

OCCUPANCY CLASSIFICATION
 (IEBC Sec 901.1, 912.4.2),(IBC Sec 302, 303, 304, 508.2),(NFPA 101)
 Educational E

REQUIRED OCCUPANCY SEPARATIONS
 (IBC Table 508.4), (NFPA)
 E TO E (None)

OCCUPANCY LOAD
 (IBC Table 1004.1.1), (NFPA 101 Table 7.3.1.2)
 Classroom 20 Net Sqft per Occupant

MEANS OF EGRESS
 (IBC Chapter 10, NFPA 101 Chapter 7, 14, 15)

EGRESS WIDTH PER OCCUPANT
 (IBC 1005.1)
 (IEBC Table 1301.6.11(1))

0.3 Inches per occupant for stairways
 0.2 Inches for other egress components

EXIT ACCESS
Common path of egress travel
 (IBC 1014.3),(IBC 1028.8)
 For Educational <100'

Corridor Width
 (IBC 1010.2), (NFPA 101 14.2.3.2)
 Not less than 44"
 Not less than 36" when less than 50 occupants
 Not less than 72" at educational exit access corridors,
 or corridors with the capacity of ≥100

Dead-End Corridor
 (IEBC 705.6)
 Dead-end corridors in occupancy E ≤50'
 Dead-end corridors in occupancy A-3 ≤20'
 (NFPA 101 14.2.6.3, Table A.7.6)
 Travel distance to exit: 200'

PLUMBING FIXTURE COUNT
 (IBC Table 2902.1)

| | | | |
|--------------------|-------|------------|------------|
| DRINKING FOUNTAIN | 1:100 | 2 REQUIRED | 2 PROVIDED |
| LAVATORIES (MIF) | 1:50 | 2 REQUIRED | 4 PROVIDED |
| WATER CLOSETS (MF) | 1:50 | 2 REQUIRED | 4 PROVIDED |
| SERVICE SINK | 1 EA | 1 REQUIRED | 1 PROVIDED |

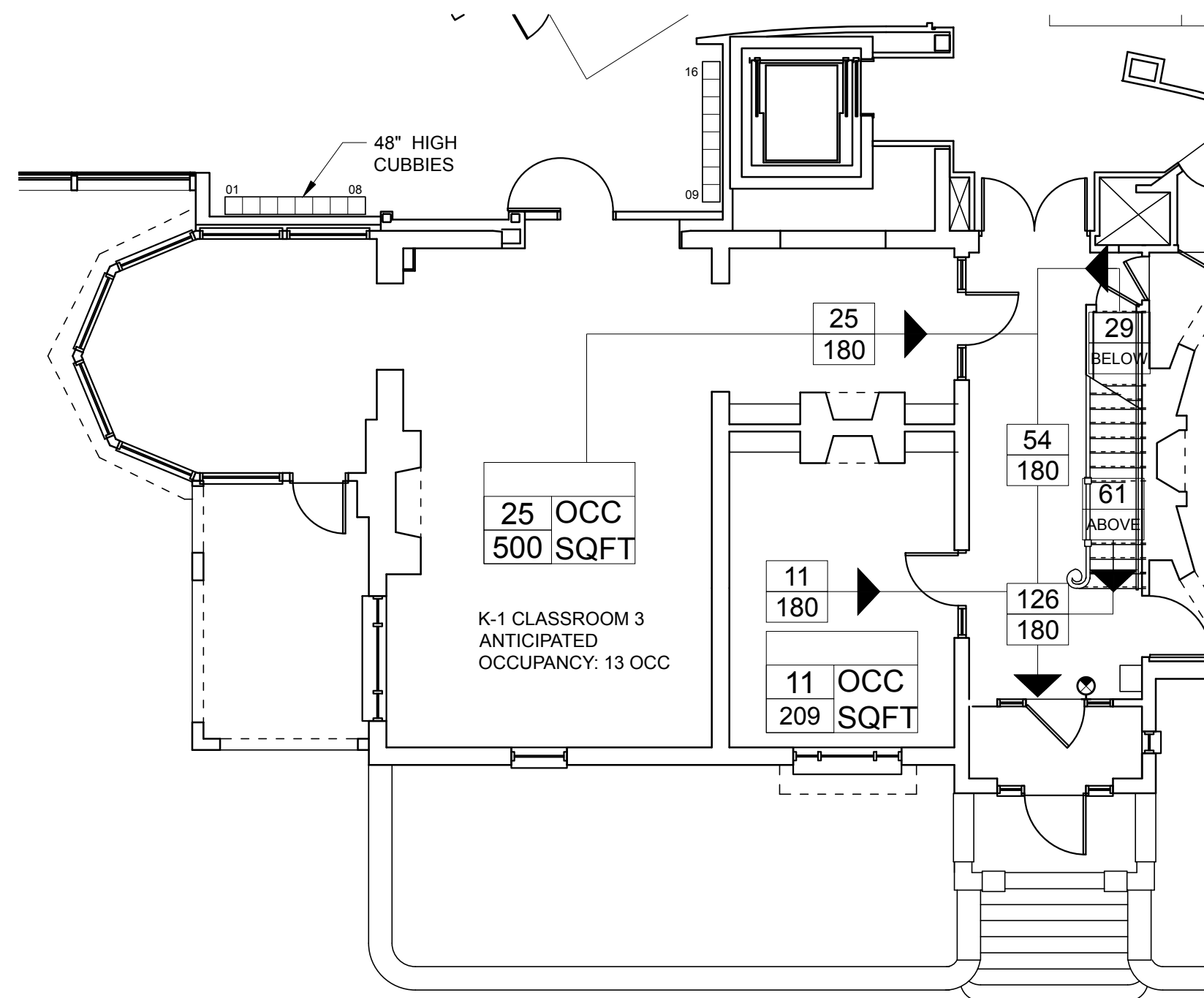

2 FIRST FLOOR PLAN - MUSIC ROOM
 SCALE: 1/8" = 1'-0"

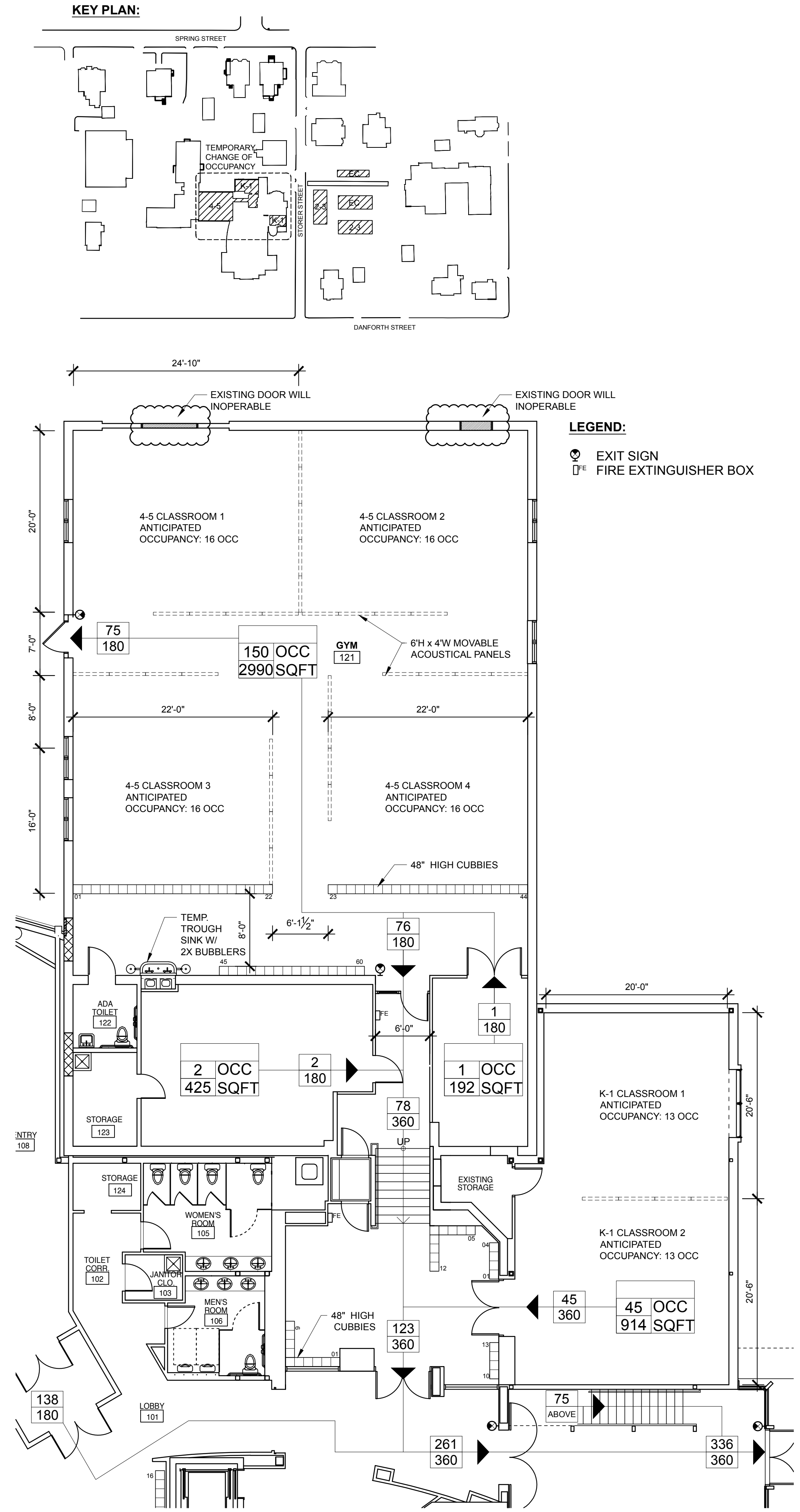

1 FIRST FLOOR PLAN - GYM AND GALLERY
 SCALE: 1/8" = 1'-0"

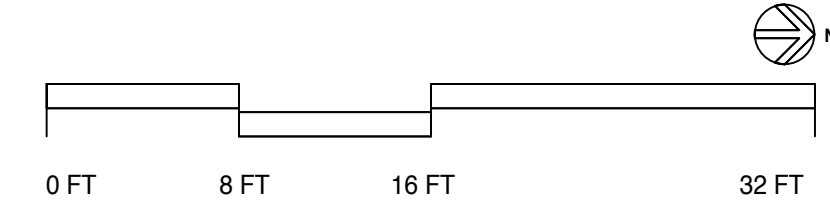

PROJECT NAME:
WAYNFLETE LOWER SCHOOL
 RELOCATION PLANS

WAYNFLETE SCHOOL
 360 SPRING STREET
 PORTLAND, MAINE 04102

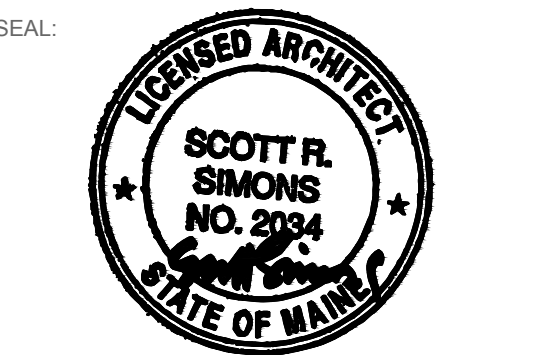

THIS DRAWING IS THE PROPERTY OF SCOTT SIMONS ARCHITECTS (SSA) AND IS NOT TO BE COPIED OR REPRODUCED IN PART OR WHOLE 2017 © SCOTT SIMONS ARCHITECTS, LLC

REVISION:

| | |
|---|------|
| 1 | DATE |
| 2 | DATE |
| 3 | DATE |
| 4 | DATE |
| 5 | DATE |
| 6 | DATE |

DATE OF ISSUE: 28 APRIL 2016
 PROJECT NUMBER: 2017-0090
 STATUS: PERMIT SET

TEMPORARY CLASSROOM PLANS + LIFE SAFETY UPDATE

G002C