

1 LANDSCAPING SITE PLAN
SCALE: 1/16" = 1'-0"

PLANT LIST						
KEY	QTY.	BOTANICAL NAME	COMMON NAME	SIZE	ROOT	NOTES
AR	1	ACER RUBRUM	RED MAPLE	4" CAL	B+B	
CF	1	CORNUS FLORIDA	FLOWERING DOGWOOD	#7	CONT.	FINAL LOCATION DETERMINED IN FIELD
EF	240	EUONYMUS FORTUNEII	WINTERCREEPER	2 GAL	CONT.	
RA	32	RHUS AROMATICA	FRAGRANT SUMAC	1 GAL	CONT.	
PQ	60	PARTHENOISSIS QUINQUE FOJIA	BOSTON IVY	2 YEAR POT	CONT.	
PP	121	PACHYSANDRA PROCUMBENS	JAPANESE SURGE	1 YEAR POT	CONT.	

PLANT LIST						
KEY	QTY.	BOTANICAL NAME	COMMON NAME	SIZE	ROOT	NOTES
FA	1	FRAXINUS AMERICANA	WHITE ASH	2-1/2"	B+B	

2 PLANT LIST

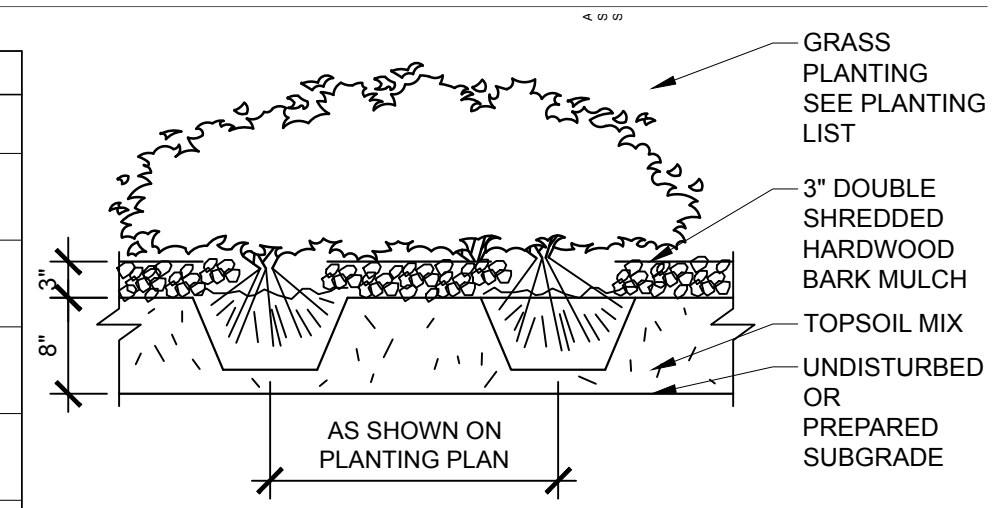

3 GROUND COVER DETAIL
SCALE: 3/4" = 1'-0"

General Tree & Shrub Information

Instructions for Woody Plants

1. Locate the point at which trunk flare begins.
2. Dig hole 2-3 times width of rootball and as deep as the rootball (no deeper). Measure from trunk flare to bottom of rootball.
3. If rootball is in a container, remove container and cut 4 or 5 shallow vertical slashes into rootball to break any patterns of circular growth. If rootball is in natural fiber burlap, and the plant is put in the planting hole, remove ropes and the top 1/3 of burlap. Do not try to remove the entire burlap or the wire basket. Top section of the wire basket can be cut, or bent, back when the plant is in the hole.
4. After plant is in hole, backfill with mix.
 - Soil Mix for Deciduous Trees & Shrubs and Needled Evergreens**
Add to a wheelbarrow full of existing soil in the following ratio:
2 shovelful of peat
1 shovelful of aged manure or compost
 - Mix for Broad-leaved Evergreens**
Add to a wheelbarrow full of existing soil in the following ratio:
3 to 4 shovelful peat
1 shovelful of aged manure or compost
5. Water thoroughly and deeply, 1-2 times each week depending on soil type, heat and drought conditions. Place hose at the base of the plant, allowing the water to trickle for 30 minutes, slowly soaking in.
6. Tamp soil lightly around rootball and leave ridge of soil around edge of hole to hold future waterings.
7. Use liquid root stimulator with initial watering and continue at 2 week intervals.
8. In windy sites, it is good to stake trees for 1st year, most likely for large caliper trees. The tree should be able to sway a little with the wind (this actually helps stimulate root growth), do not stake so tightly that the tree has no motion.
9. Apply mulch about 2" deep to retain moisture and discourage weed growth. Do not mulch within 2-3" of the main trunk area.



75 York Street
Portland, Maine 04101
simonsarchitects.com
207.772.4656

PROJECT NAME:
WAYNFLETE LOWER SCHOOL ADDITION & RENOVATIONS

WAYNFLETE SCHOOL
360 SPRING STREET
PORTLAND, MAINE 04102



THIS DRAWING IS THE PROPERTY OF SCOTT SIMONS ARCHITECTS (SSA) AND IS NOT TO BE COPIED OR REPRODUCED IN PART OR WHOLE 2016 © SCOTT SIMONS ARCHITECTS, LLC

REVISION:

1	DATE
2	DATE
3	DATE
4	DATE
5	DATE
6	DATE

DATE OF ISSUE: 12 JANUARY 2017
PROJECT NUMBER: 2013-0050
STATUS: 100% CONSTRUCTION DOCUMENTS ISSUED FOR BID

LANDSCAPE PLAN

L-100